

*Poster*  
*6-2-78*  
*[Signature]*

ACTION

*BZA 23-78* COMMITTEE *Divid* DATE *6-27-78*

M.A.P.C. \_\_\_\_\_

B.C.C./B. CO. C. \_\_\_\_\_

Case No. BZA 23-78 - Eugene Coombs et al., request a variance to increase the gross surface area of an on-site pole sign from 150 square feet to 199 square feet; and to increase the height from 30

Map No. 6047  
 Sec. 20  
 Twp. 27  
 Range 2E

BZA- 23-78  
 SCZ- \_\_\_\_\_  
 CU- \_\_\_\_\_  
 Filed \_\_\_\_\_

AREA DATA:  
 1. Acres: 1.48 ( 300 (IRREGULAR) ft. by 320 ft.)  
 2. Adjoining Zoning: E \_\_\_\_\_ S \_\_\_\_\_ W \_\_\_\_\_ N \_\_\_\_\_  
 3. Land Use: East SINGLE FAME MOTEL South KELLOGG  
 West PARKING LOT North Single Fam  
 4. Sketch Plan Land Use is for: \_\_\_\_\_  
 5. Present Land Use if for: MOTEL  
 6. Area (is) (is not) platted.

PHOTO DATA:  
 Taken by \_\_\_\_\_ Date \_\_\_\_\_ Time \_\_\_\_\_

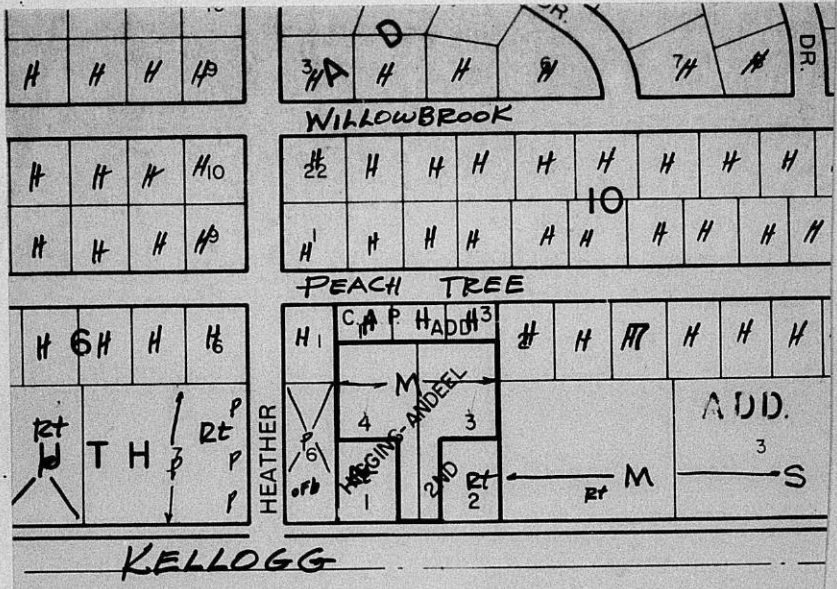

No. 2153C  
 Smeal  
 HASTINGS, MN - LOS ANGELES  
 LOGAN, OH - McNEEDOR, TX, U. S. A.

RESOLUTION NO. BZA 23-78

WHEREAS, Eugene Coombs, Harry Pollak, Lindy Andeel, John Jabara and Alfred A. Caro, 520 120 Building, Wichita, Kansas, request a variance as provided in Section 2.12.590.B, Code of the City of Wichita, to permit an increase in the gross surface area of an on-site pole sign from the permitted 150 square feet to 199 square feet; and to increase the height of the sign from the permitted 30 feet to 37 feet on property zoned the "LC" Light Commercial District and legally described as follows:

Lots 3 and 4, Higgins-Andeel Second Addition to Wichita, Sedgwick County, Kansas. Generally located on the north side of Kellogg in an area between Heather and Bonnie Brae (8220 East Kellogg).

WHEREAS, proper notice as required by ordinance and by the rules of the Board of Zoning Appeals has been given; and

WHEREAS, the Board of Zoning Appeals did, at the meeting of June 27, 1978, consider said application; and

WHEREAS, the Board of Zoning Appeals has proper jurisdiction to consider said request for a variance under the provisions of Section 2.12.590.B, Code of the City of Wichita; and

WHEREAS, the Board of Zoning Appeals has found that the variance does not arise from such condition which is unique to the property in question and which is not ordinarily found in the same zone or district; and is created by an action or actions of the property owner or the applicant inasmuch as the platting of subject property, by the very nature of the plat design, determined that the larger rear portion of subject property would be visually obscured by the two smaller front lots; and

WHEREAS, the Board of Zoning Appeals has found that the granting of the permit for the variance will adversely affect the rights of adjacent property owners or residents inasmuch as there are many commercial signs located in this immediate vicinity, all of which are undoubtedly designed and placed to draw maximum public attention to themselves. To grant this variance to this applicant may not be equitable to these surrounding commercial businesses who are vying for the public's attention; and

WHEREAS, the Board of Zoning Appeals has found that the strict application of the provisions of Title 28 (Zoning Ordinance) of which variance is requested, will not constitute unnecessary hardship upon the property owner represented in the application inasmuch as the applicants could redesign their existing sign and actually increase it in size slightly (by 11 square feet) if they believe the sign does not adequately advertise their business; and

WHEREAS, the Board of Zoning Appeals has found that the variance desired will not adversely affect the public health, safety, morals, order, convenience, prosperity or general welfare; and

WHEREAS, the Board of Zoning Appeals has found that the granting of the variance desired will be opposed to the general spirit and intent of Title 28 (Zoning Ordinance) inasmuch as a property frontage of over 250 feet would be required to permit a sign like the one proposed and this property has only 77 feet of frontage; and in the combined 300 foot frontage of this property and those on either side there are three separate signs; and

WHEREAS, each of the five conditions required by Section 2.12.590.B, Code of the City of Wichita, to be present before a variance can be granted has not been found to exist.

NOW, THEREFORE, BE IT RESOLVED by the Board of Zoning Appeals of the City of Wichita that this request for a variance to permit an increase in the gross surface area of an on-site pole sign from the permitted 150 square feet to 199 square feet; and to increase the height of the sign from the permitted 30 feet to 37 feet on property zoned the "LC" Light Commercial District and legally described as follows:

RESOLUTION NO. BZA 23-78

Page 2

Lots 3 and 4, Higgins-Andeel Second Addition to Wichita, Sedgwick County, Kansas. Generally located on the north side of Kellogg in an area between Heather and Bonnie Brae (8220 East Kellogg).

be denied.

ADOPTED AT WICHITA, KANSAS, this 27th day of June, 1978.

  
James Richardson, Chairman

ATTEST:

  
Larry Dobson, Assistant Secretary

July 6, 1978

Mr. Everett Fettis  
504 120 Building  
Wichita, Kansas 67202

Re: Case No. BZA 23-78  
Request for Variance

Dear Mr. Fettis:

Enclosed is a signed copy of the Resolution adopted by the Board of Zoning Appeals on June 27, 1978, in connection with your request to permit an increase in the gross surface area of an on-site pole sign from the permitted 150 square feet to 199 square feet, on property zoned the "LC" Light Commercial District, and generally located on the north side of Kellogg in an area between Heather and Bonnie Brae (8220 E. Kellogg).

This Resolution reflects the official action of the Board to deny your request. It is forwarded to you for your information and files.

If you have any questions concerning this matter, please call our office.

Sincerely yours,

  
Larry Dobson  
Assistant Secretary

LD:bh

cc: Eugene Coombs, Harry Pollak, Lindy Andeel, John Jabara,  
and Alfred Caro, 502, 120 Building, 67202  
Robert Feldner, Supt., Central Inspection  
Joe Donnelly, Housing and Zoning Administrator  
Don Gisick, City Clerk

June 28, 1978

Mr. Everett Pettis  
504 120 Building  
Wichita, Kansas 67202

Re: Case No. BZA 23-78  
Request for Variance

Dear Mr. Pettis:

At the regular meeting of the Board of Zoning Appeals on Tuesday, June 27, 1978, your request for a variance to permit an increase in the gross surface area of an on-site pole sign from the permitted 150 square feet to 199 square feet, on property zoned the "LC" Light Commercial District, and generally located on the north side of Kellogg in an area between Heather and Bonnie Brac (3220 E. Kellogg) was considered.

It was the action of the Board to deny your request.

A Resolution setting forth the official action of the Board is being prepared and you will be mailed a copy as soon as the signatures of the Chairman and Secretary have been obtained.

If you have any questions, please call our office.

Sincerely yours,

Larry Dobson  
Assistant Secretary

LD:hh

cc: Eugene Coombs, Harry Pollak, Lindy Andeal, John Jabara,  
and Alfred Caro, 502 120 Building, 67202  
Ed Dunn, 933 S. West, 67213  
Robert Faldner, Supt., Central Inspection  
Joe Donnelly, Housing and Zoning Administrator  
Don Gisick, City Clerk

**THE CITY OF WICHITA**

OFFICE OF CITIZEN PARTICIPATION

DATE June 23, 1978

TO Larry Dobson, Secretariat, Board of Zoning Appeals

FROM Bill Morris, CPO Administrative Aide

SUBJECT BZA 23-78 (North Side of Kellogg,  
Between Heather and Bonnie Brae)

On June 19, 1978, CPO Council "H" voted 5-0 to recommend denial of the captioned case.

The Council members felt that approval of BZA 23-78 would establish a harmful precedent regarding application of the sign ordinance on east Kellogg. In addition, Council "H" noted that representatives of the Bonnie Brae Citizen's Association were present to speak in opposition to the proposed variance.

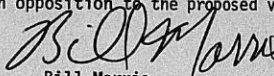

Bill Morris  
CPO Administrative Aide

BM:sm

Noted:



David Furnas  
Citizen Participation Coordinator

*Dobson*

LAW OFFICES  
EVERETT C. FETTIS  
120 SOUTH MARKET  
SUITE 504  
WICHITA, KANSAS 67202  
316-267-7251

MICHAEL G. QUINN  
KEITH M. CURFMAN  
OF COUNSEL

EVERETT C. FETTIS  
DAVID R. MCCLURE

21 June 1978

L. E. Dobson  
Metropolitan Area Planning  
455 North Main  
Wichita, Kansas 67202

RE: Wichita Inn  
8220 East Kellogg  
Wichita, Kansas

Dear Larry:

With regard to our application coming up Tuesday for the Wichita Inn for a sign variance, I think I told you when I filed we would not be seeking all that we were asking for. We will not be seeking to raise the height of the sign as we did last time and as we applied for. We will be seeking to increase the square footage area of the sign to a total of 199 square feet. What we wish to add to the sign is the word "Motel". I think we are allowed some increase up to 150 square feet, so we will actually seek to go above by 49 square feet.

I will be out of town Monday, and I understand you will not be back until Monday, hence this letter. I will be back hopefully Tuesday morning and will call you to see if we need to discuss this before we appear at the BZA.

Very truly yours,

  
EVERETT C. FETTIS

ECF/dbs



SECRETARY'S REPORT  
CASE NO. BZA 23-78

APPLICANT: Eugene Coombs, Harry Pollak, Lindy Andeel, John Jabara, and Alfred Caro, 502 120 Building, Wichita, Kansas.

AGENT: Everett Fettis, 504 120 Building, Wichita, Kansas.

REQUEST: Variance pursuant to Section 2.12.590.B, Code of the City of Wichita, to permit an increase in the gross surface area of an on-site pole sign from the permitted 150 square feet to 199 square feet; and to increase the height of the sign from the permitted 30 feet to 37 feet.

GENERAL LOCATION: North side of Kellogg in an area between Heather and Bonnie Brae (8220 E. Kellogg).

ZONING: Subject property is zoned the "LC" Light Commercial District as are those properties to the east, west and south. North is the "AA" Single Family Dwelling District.

LAND USE: Subject property is developed with a motel. South is Eastgate Shopping Center. East is a restaurant, a motel and single family residential. North is single family development. West is a restaurant and an office bldg.

JURISDICTION:

The Board has jurisdiction to consider the variance request under the provisions outlined in Section 2.12.590.B, Code of the City of Wichita. The Board may grant the request when all five of the following conditions are found to exist:

1. That the variance requested arises from such condition which is unique to the property in question and which is not ordinarily found in the same zone or district; and is not created by an action or actions of the property owner or the applicant.
2. That the granting of the permit for the variance will not adversely affect the rights of adjacent property owners or residents.
3. That the strict application of the provisions of Title 28 of which variance is requested will constitute unnecessary hardship upon the property owner represented in the application.
4. That the variance desired will not adversely affect the public health, safety, morals, order, convenience, prosperity, or general welfare; and

5. That granting the variance desired will not be opposed to the general spirit and intent of Title 28 (zoning ordinance).

COMMENTS BY THE SECRETARY:

The applicants are requesting a variance to increase the gross surface area of an existing on-site sign from the permitted 150 square feet to 199 square feet and also to increase the height of the sign from the permitted maximum of 30 feet to 37 feet.

This request is the same request that was denied by the Board of Zoning Appeals on February 28, 1978 (BZA 1-78). At the time of filing this present request, the applicant's agent indicated that he would be modifying the request to a lesser variance, but as of this writing, no modification has been submitted. In addition to said modification, the rationale presented in filing this new request was that there has been a change in the type of restaurant adjacent to the east that resulted in a smaller sign on that property. The previous sign was 143 square feet in size as compared to 64 square feet in the new sign; and it was reduced in height from 25 feet to 18 feet. If this change has any impact at all upon the visibility of the applicant's sign, it should make it more visible.

The existing sign on subject property contains 139 square feet and is 30 feet in height. The information submitted by the applicant does not change the opinion of the Secretary that any request for an increase in size or height of this sign over that permitted by ordinance should be denied. In reviewing the five conditions which the Board must find to exist in order to grant a variance the Secretary would not change any of them from the previous case (BZA 1-78). Minutes of the February 28, 1978 meeting referencing that case are attached for your review. The following commentary on the five conditions is the same as that found in the previous Secretary's Report:

UNIQUENESS:

It is the opinion of the Secretary that it is difficult to determine that the variance requested arises from a condition unique to this property, that was not created by actions of the property owners, inasmuch as the platting of subject property, by the very nature of the plat design, determined that the larger rear portion of subject property would be visually obscured by the two smaller front lots.

ADJACENT PROPERTY:

It is the opinion of the Secretary that it is difficult to determine what affect the granting of this variance would have on the rights of adjacent property owners inasmuch as there are many commercial signs located in this immediate vicinity, all of which are undoubtedly designed and placed to draw maximum public attention to themselves. To grant this variance to this applicant

may not be equitable to these surrounding commercial businesses who are vying for the public's attention.

HARDSHIP:

It is the opinion of the Secretary that it is difficult to determine that the strict application of the provisions of the zoning ordinance will constitute an unnecessary hardship upon the applicants simply because of the general nature of the development around their property which they contend obscures the sight of this business.

PUBLIC INTEREST:

It is the opinion of the Secretary that the granting of the variance desired may not adversely affect the public health, safety, morals, order, convenience, prosperity, or general welfare.

SPIRIT AND INTENT:

It is the opinion of the Secretary that the granting of the variance desired would be opposed to the general spirit and intent of the zoning ordinance inasmuch as the amount of lot frontage and the zoning classification are the major determining factors used to regulate the number, height and size of signs within this City. To permit a sign similar in size and height to the one proposed would require a property frontage of over 250 feet. Subject property frontage is only 77 feet. In the combined 300 foot frontage of subject property and the two adjacent properties there are three separate pole signs. To grant this variance for this small amount of frontage and in view of the close proximity of the two adjacent pole signs would, in the Secretary's opinion, be completely contrary to the spirit and intent of the ordinance.

With reference to the above condition of 'Hardship', the Secretary would also agree with the Board's comments expressed in Resolution BZA 1-78 stating that the applicants could redesign their existing sign and actually increase it in size slightly (by 11 square feet) if they believe the sign does not adequately advertise their business.

RECOMMENDATION:

It is the opinion of the Secretary that all of the conditions necessary to the granting of a variance cannot be found to exist and therefore, it is recommended that this request be denied.

-----

EXHIBIT

The attached variance is requested for the following reasons:

1. This property is located in the middle of substantial commercial development. It is surrounded by restaurants and other similar businesses, but this particular motel sets back from the street with parking in front and, consequently, is obstructed from view of traffic by virtue of those businesses that are closest to the street. Because of the development in the area, this appeal would be the only reasonable manner in which to construct the project.
2. The granting of the permit will not adversely effect the rights of adjacent property owners because of the general area and nature of the businesses in the neighborhood and the sign will not be that large.
3. The strict application of the provisions of Title 28 will constitute unnecessary hardship on the property owners because of the general nature of the development around the property which obscures the sight of this business.
4. Again, because of the general nature of the area, the variance will not effect the public health, safety, morals, order, convenience, prosperity or general welfare.
5. The general intent and spirit of the zoning ordinance will not be adversely effected because the zoning ordinance is written in such a manner as to allow exceptions to be granted where they are justified.

19 notices sent to agent and/or applicant and adjacent property owners  
1 notice to CPO  
10 notices to MAPC  
30 total notices sent on BZA 23-78

BOARD OF ZONING APPEALS  
Tenth Floor - City Hall  
455 North Main, Wichita, Kansas 67202

June 2, 1978

NOTICE TO ADJOINING PROPERTY OWNERS:

Case No. BZA 23-78

An application has been filed by Eugene Coombs, Harry Pollak, Lindy Andeel, John Jabara and Alfred A. Caro, 520 120 Building, Wichita, Kansas, requesting a variance to permit an increase in the gross surface area of an on-site pole sign from the permitted 150 square feet to 199 square feet; and to increase the height of the sign from the permitted 30 feet to 37 feet on property zoned the "LC" Light Commercial District and legally described as follows:

Lots 3 and 4, Higgins-Andeel Second Addition to Wichita, Sedgwick County, Kansas. Generally located on the north side of Kellogg in an area between Heather and Bonnie Brae (8220 East Kellogg).

This application has been assigned Case No. BZA 23-78 and will be considered by the Board of Zoning Appeals at its meeting on Tuesday, June 27, 1978, at 1:30 p.m., in the Board Room, First Floor, City Hall, 455 North Main, Wichita, Kansas, at which time you may appear if you so desire, either in person or by agent or attorney.

It should be noted that the Citizen Participation Organization Area Council may consider this case at its next meeting. Additional information about such a meeting may be obtained by calling the CPO Office, 268-4516.

Jack H. Galbraith  
Secretary

BOARD OF ZONING APPEALS

CASE NO. \_\_\_\_\_

CITY OF WICHITA, KANSAS

FILED \_\_\_\_\_

APPLICATION FOR VARIANCE

I. Name of Applicant Eugene Coombs, Harry Pollak, Lindy Andeel, John Jabara and Alfred A. Caro,

Mailing Address 502 120 Bldg., Wichita, Ks., 67202 phone 267-7251

Name of Authorized Agent Everett C. Fettis

Mailing Address 504 120 Bldg., Wichita, Ks., 67202 Phone 267-7251

Relationship of applicant to property is that of Owner.  
(Owner, Tenant, Lessee, Other)

II. The variance requested is the addition of sixty (60) square feet on the rotating sign of Wichita Inn. (increase gross surface area of on-site sign from 150 sq ft to 199 sq ft; and to increase height from 30' to 37' pole)

for property located 8220 East Kellogg, Wichita, Kansas, 67207.

and legally described as: Lots 3 and 4 W. B. Higgins-Andeel Second Addition to Wichita, Sedgwick County, Kansas;

in the City of Wichita; and which is presently zoned IC.

III. The applicant herein, or his authorized agent, acknowledges:

- a. That he has received an instruction sheet concerning the filing and hearing of this matter;
- b. That he has been advised of the fee requirements established by Section 2.12.580 of the Code of the City of Wichita (Ordinance No. 24-606); and that the appropriate fee is herewith tendered;
- c. That he has been advised of his right to bring action in the District Court of Sedgwick County to appeal the decision of the Board.
- d. That all documents are attached hereto as noted in paragraphs 2, 3, 4, and 5 of the instructions.

Applicant

Everett C. Fettis  
Authorized Agent Everett C. Fettis

OFFICE USE ONLY: Received in office of Secretary, Board of Zoning Appeals 4:25 (a.m. (p.m.)), 5:30 19 78 together with appropriate fee of \$50.00.

N. side of Kellogg between Heather & Bonnie Bruce

T9-402

(use abstract list from BZA 1-78)

Larry Dobson  
Signed

O W N E R S H I P   L I S T

| Lot | Addition           | Property Owner   |
|-----|--------------------|--|
| 1   | Higgins-Andeel 2nd | ✓ John Clark Stevens aka J. Clark<br>14214 Cascade Ct. 67230 |
| 2   | " " " " "          | ✓ James H. Stevens & Ann M.<br>702 N. Doreen 67206           |

Lots 3 & 4, Higgins-Andeel 2nd Addition, Wichita, Kansas, together with an easement for ingress and egress on the North 20 feet on Lot 6, Ruth Addition to Wichita, Sedgwick County, Kansas, and an easement for ingress and egress from driveways on Lots 1 and 2 in said Higgins-Andeel 2nd Addition, Wichita, Kansas, and rights as provided for in a document entitled Easement made and entered into the 13th day of October, 1975, by and between Harry B. Pollak and Sharley Pollak, his wife, Alfred A. Caro and Louise A. Caro, his wife, and Lindy Andeel, a single person, as parties of the first part, and Charles T. Schoenhofer and Peggy J. Schoenhofer, his wife, J. Clark Stevens and Annamarie J. Stevens, his wife, parties of the second part, and Hugh S. Stevens and Margaret Stevens, his wife, and James H. Stevens and Ann M. Stevens, his wife, parties of the third part, recorded October 14, 1975 in the office of the Register of Deeds of Sedgwick County, Kansas, on Film 161 Pages 1581 to 1584, inclusive.

✓ Harry B. Pollak, Alfred A. Caro  
John J. Jabara , Eugene G.  
Coombs, Lindy Andeel  
5900 E. Central 67208

The east 125 feet of Lot 7, Ruth Addition to the City of Wichita, Sedgwick County, Kansas, excepting and reserving unto the Grantor, her heirs and assigns, a perpetual easement and right of way in common with Grantee, its successors and assigns, for ingress and egress over, on, across, and under the north 25 feet of the aforescribed real property, and still further subject to a restriction on the Grantee, its successors and assigns, that no building shall be placed on the south 50 feet of the above described real estate.

✓ Maverick Development Co. Inc.  
250 N. Rock Road 67206

*not in 50  
not in C & D  
not in phone book*

|                 |                      |  |
|-----------------|----------------------|--|
| Lot 6, Block 10 | Bonnie Brae Addition | ✗ Donald Craig Middaugh &<br>Helen Coleen<br>address unknown   |
| Lot 5, Block 10 | " " " " "            | ✓ William D. Harrison &<br>Clarice N.<br>8226 Peach Tree 67207 |

| Lot  | Addition                                  | Property Owner  |
|--|---|---|
| Lot 4, Block 10  | Bonnie Brae                               | ✓ Jack Pearce<br>8220 Peach Tree 67207  |
| Lot 3, Block 10  | " " "                                     | ✓ Irwin V. Johnson &<br>Phyllis A.<br>8214 Peach Tree 67207                                       |
| Lot 2, Block 10  | " " "                                     | ✓ Lawrence E. Ree & Bonnie L.<br>8208 Peach Tree 67207  |
| Lot 1, Block 10  | " " "                                     | ✓ Robert Ripley Jr. & Lorraine P.<br>8202 Peach Tree 67207  |
| Lot 9, Block 5   | " " "                                     | ✓ James B. Crowe & Sharry L.<br>8126 Peach Tree 67207   |
| Lot 6, Block 6   | " " "                                     | ✓ Odetta C. Schnitzler<br>8127 Peach Tree 67207   |
| Lot 4, Block 7   | " " "                                     | ✓ Archie L. Stover - deceased<br>Marie H. Stover<br>8301 Peach Tree 67207                         |
| Lot 3, Block 7   | " " "                                     | ✓ Richard Alto Watson & Eva Vera<br>8223 Peach Tree 67207   |
| W 90' of Lot 1,<br>Block 7   | " " "                                     | ✓ Leonard William Radermacher &<br>La Donna<br>8201 Peach Tree 67207 <i>not in SD</i>             |
| E 100' of Lot 2,<br>Block 7  | " " "                                     | * Patricia Rea Dumler - add. unk.<br>* Harold R. Hall - 202 Lochinvar<br>67207 <i>not in SD</i>   |
| Lot 6 together with<br>an easement over the<br>N 20' for ingress &<br>egress | Ruth                                      | * F.I.G. Holding Company<br>address unknown <i>not in SD</i>                                      |
| Lot 4  | Ruth                                      | ✓ Larry Young, Executor of<br>Estate of Ralph E. Jett, dec.<br>6314 E. 15th<br>Tulsa, Okla. 74112 |
| Lot 1  | C.A.P.                                    | ✓ Bindy Andeel<br>5900 E. Central 67208   |
| Lot 2  | C.A.P.                                    | ✓ Rocco R. Barrese & Sandra<br>8213 Peach Tree 67207  |
| Lot 3  | C.A.P.                                    | ✓ Mary Ann Friedman<br>8219 Peach Tree 67207  |
| Lot 6, Block 1   | Eastmoor                                  | ✓ Levitt Jewelry Co. Inc.<br>7930 E. Harry 67207  |
| Lot 1, Block 1   | Replat of Block 1<br>Sunny-Brook Addition | ✓ Wm. Levitt<br>7930 E. Harry 67207   |

We hereby certify the foregoing to be a true and correct list of the property owners of:

200 foot radius of Lots 3 & 4, Higgins-  
Andeel 2nd Addition, Wichita, Kansas,  
Sedgwick County, Kansas.

as shown by the last deeds of record on file in the Office of the Register  
of Deeds of Sedgwick County, Kansas, on the 7th day of December, 1977 at  
7:00 o'clock A.M.

THE SECURITY ABSTRACT & TITLE COMPANY, INC.

By

*Marjorie Soble*

Vice President

Order No. 258935

FORM 223-0

PAYMENT NOTICE  
City of Wichita

| Bldg. | Use of Str.  | Code Eka   | Copies |
|-------|--------------|------------|--------|
| Elec  | Elev. Insp.  | Hse Moving | Lic.   |
| Mech  | Boiler Insp. | Pav. Cuts  | Cert.  |
| Plbg  | Exam Fees    | Sewer      | Elev.  |
| Signs | Plan         | Cement     | M.S.P. |

| DESCRIPTION        | AMOUNT    |
|--------------------|-----------|
| 2 BZA applications | \$ 100.00 |

NAME: Everett Fetters

ADDRESS: 504 120 Bldg. Wichita, Ks

FUND: 110-00-000-40071-000 DUE DATE: 02-00-000

COMMENTS:

DATE: BY:

WICHITA - SEDGWICK COUNTY



BOARD OF ZONING APPEALS  
CITY HALL - TENTH FLOOR  
456 NORTH MAIN STREET  
WICHITA, KANSAS 67202



Not Deliverable as Addressed  
No Forwarding Order on File  
WASHINGTON ST. STA.

Eugene Coombs, et al  
502 120 Building  
Wichita Ks. 67202

*BZF 405*



\*

This BZA. Case  
Has a Large Drawing  
On 35mm Microfilm

Roll # 1