

1-63

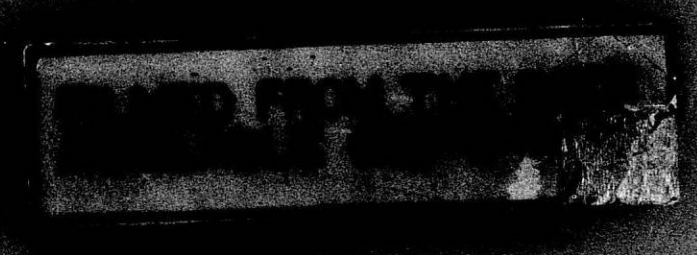

1-63

B2A 1-63

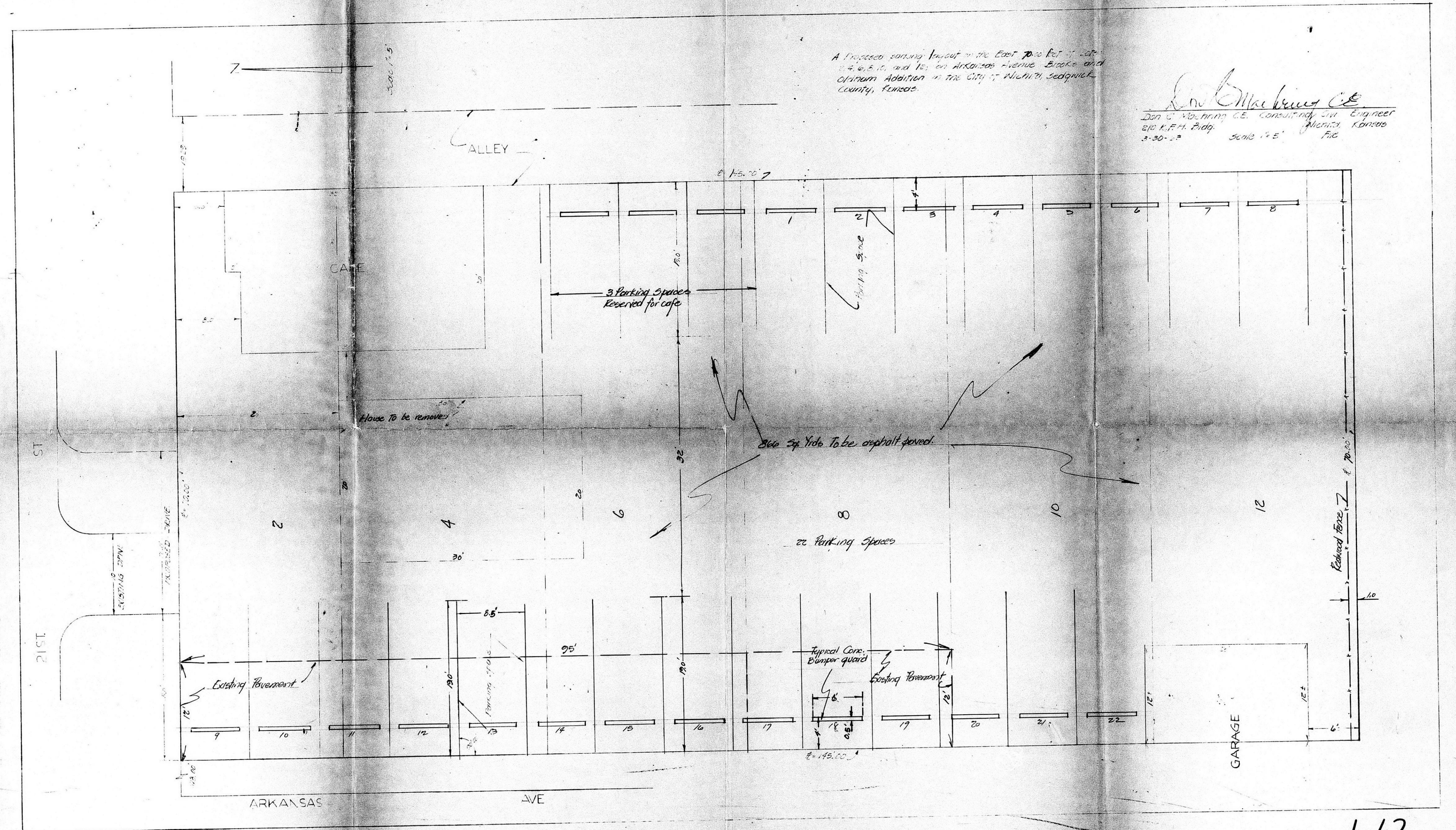

A proposed parking layout on the East side of 21st St. and 100' to Arkansas Avenue. Bumpers and optimum addition in the City of Wichita, Sedgwick County, Kansas.

*Don C. Worthington, C.E.*  
 Don C. Worthington, C.E., Consulting Civil Engineer  
 210 N. F. H. Bldg. Wichita, Kansas  
 3-30-63 Scale: 1" = 20' File

1-63

FILMED FROM THE BEST AVAILABLE COPY