

JANUARY 1970

201-870

OFFICE COPY

SELF-SERVICE CAR WASH FOR JIM GREEN

ROBERT E. SMITH  
ARCHITECT

BZA 1-70

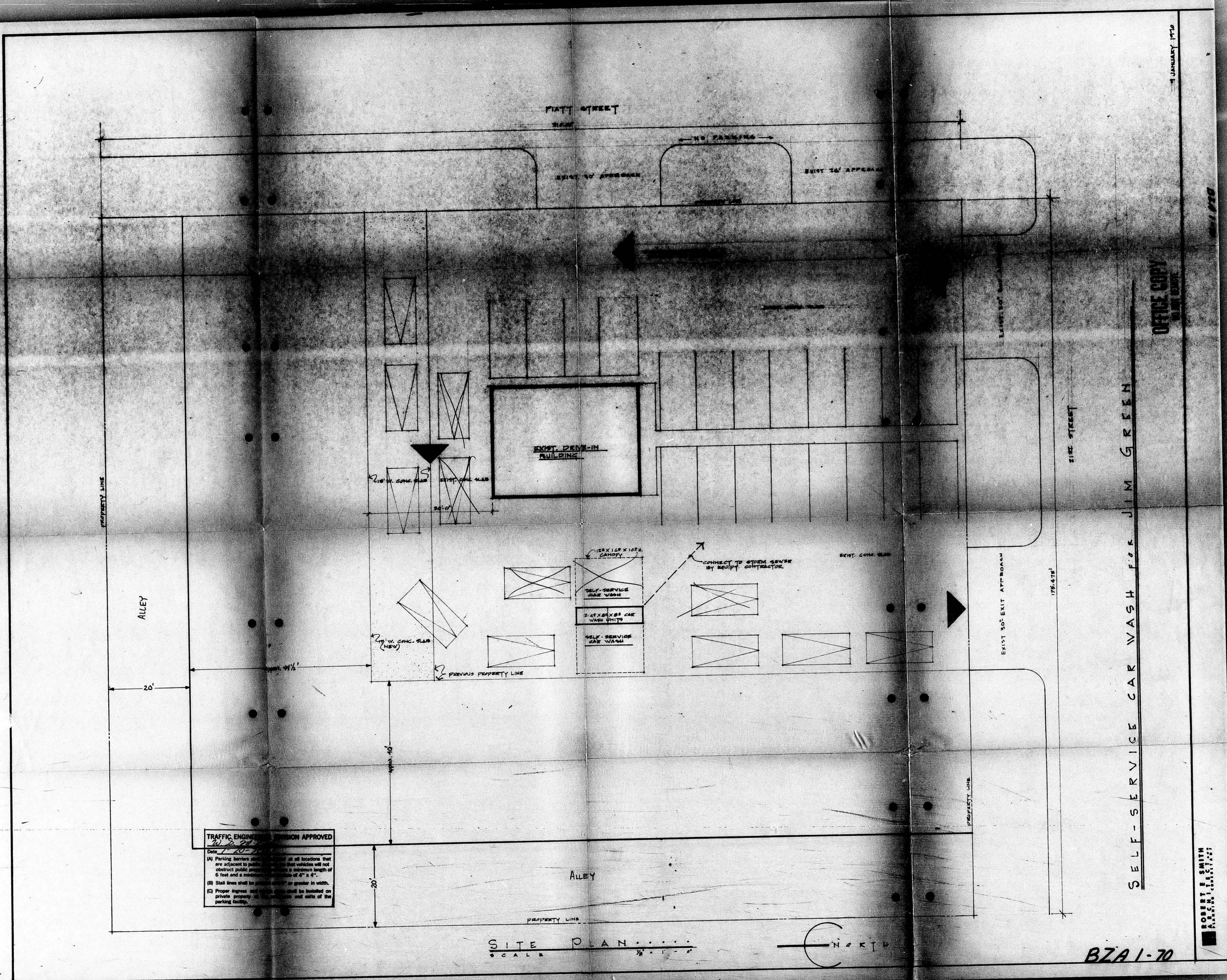

TRAFFIC ENGINEER'S PERMISSION APPROVED  
 Date 7-20-70

(A) Parking barriers shall be installed at all locations that are adjacent to public streets. These vehicles will not obstruct public passage and shall have a minimum length of 6 feet and a maximum height of 4' x 4".

(B) Stall lines shall be painted or staked at greater intervals.

(C) Proper ingress and egress shall be installed on private property at the entrance and exits of the parking facility.

SITE PLAN  
 SCALE 1/8" = 1'-0"

