

BZA 8-76

A GYMNASIUM WICHITA BAPTIST TABERNACLE

3RD STREET & CLEVELAND AVE. WICHITA, KANSAS 67214

PASTOR RAY MELUGIN ARCHITECT A.E. LATIMER

MARCH 17, 1976

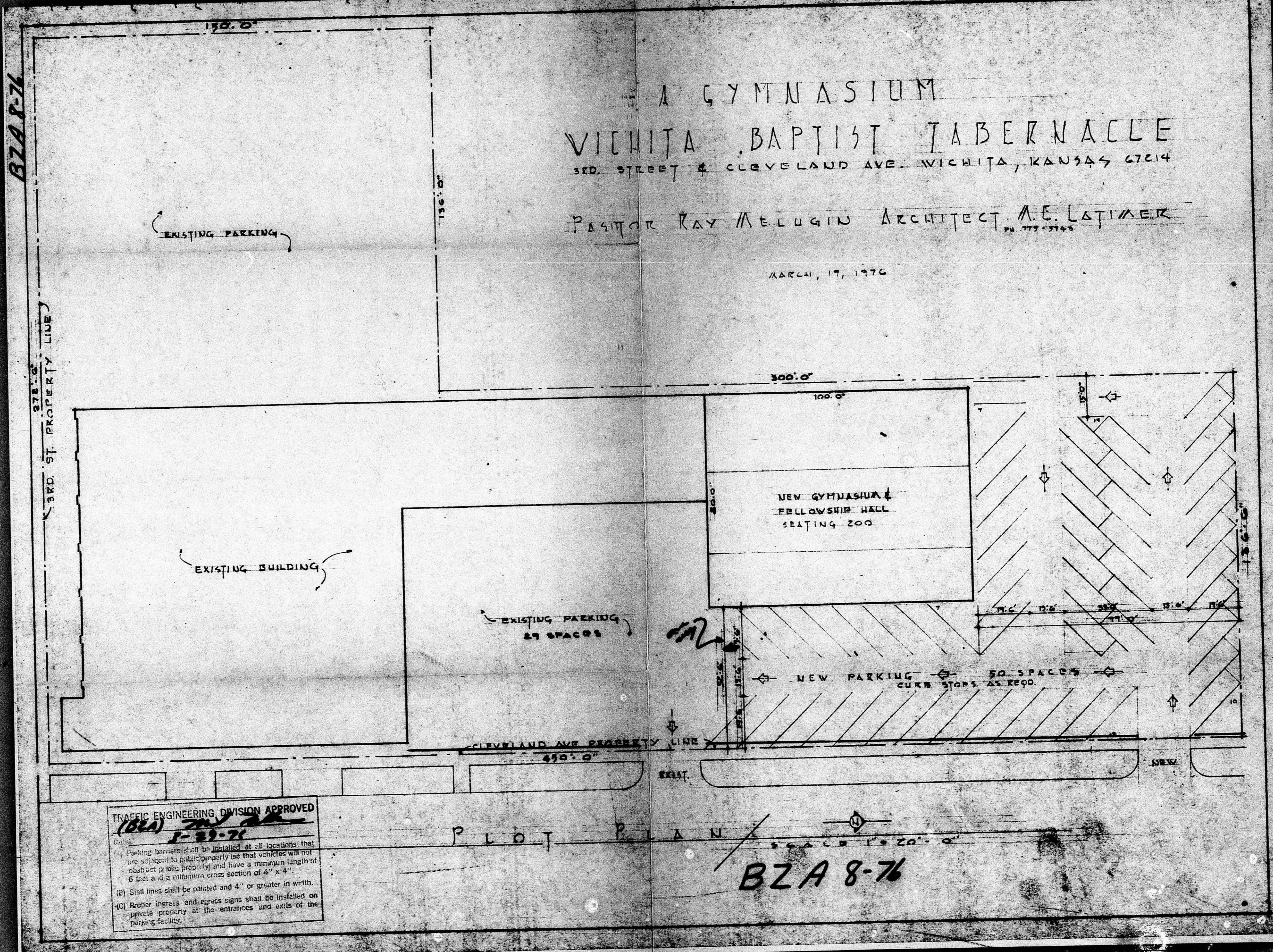

TRAFFIC ENGINEERING DIVISION APPROVED
 (1824) *[Signature]*
 F-83-76
 (A) Parking barriers shall be installed at all locations that are adjacent to public property (so that vehicles will not obstruct public property) and have a minimum length of 6 feet and a minimum cross section of 4" x 4".
 (B) Stair lines shall be painted and 4" or greater in width.
 (C) Recover ingress and egress signs shall be installed on private property at the entrances and exits of the parking facility.

P L O T P L A N
SCALE 1" = 20'-0"
BZA 8-76

