

SCHEME "A" (ORIGINAL PLAN REVISED TO INCL 24' APPROACH'S)

BZA 8-77

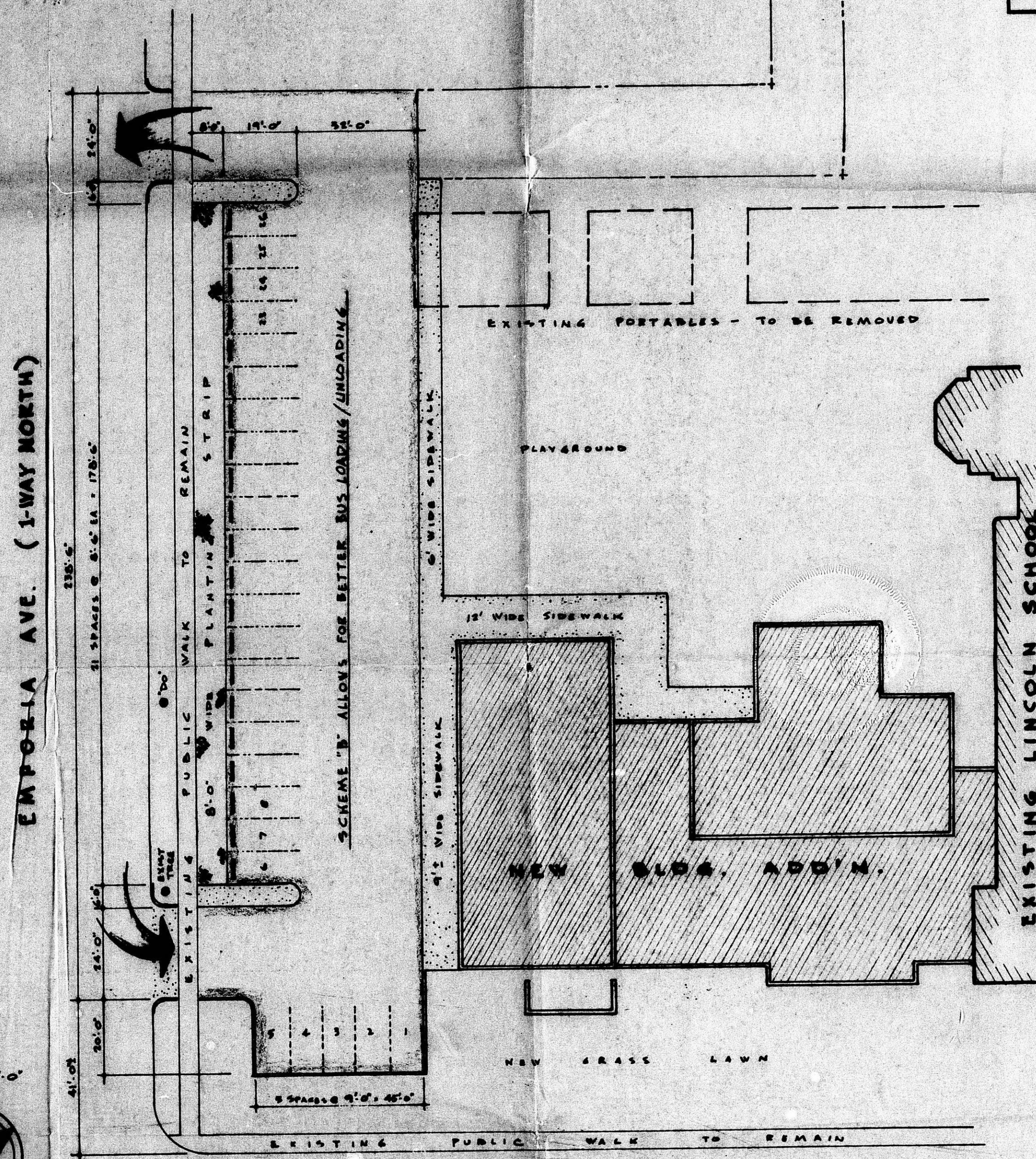

SCHEME "B" (NEW PLAN - POSSIBLE w/ NEW SHORTEN'D ADD'N.)

OFF-STREET PARKING PLANS (SCHEMES "A" & "B") FOR LINCOLN ELEMENTARY SCHOOL
 1210 SOUTH TOPEKA AVENUE WICHITA KANSAS 1 DECEMBER 1976

Blank rectangular boxes for sheet identification.

Robert E. Smith architect
 planning consultant
 Wichita Kansas

FILMED FROM THE BEST AVAILABLE COPY