

BUILDING AREAS		BASEMENT	
PHASE ONE	3904'	1902'	
PHASE TWO	4217'	1900'	
PROPOSED EXPANSION	15118'	4620'	
TOTAL	52719'	7480'	
PARKING REQ'D.	151 CARS	90 CARS	

SITE PLAN
1"=500'

TOTAL REQUIRED 161 CARS
PARKING PROVIDED 126 CARS
35

BZA 12-84

- GENERAL NOTES**
1. ALL CONSTRUCTION TO BE IN ACCORDANCE WITH THE SPECIFICATIONS AND CONDITIONS OF THE CONTRACT AND THE CITY OF SEATTLE.
 2. ALL UTILITIES TO BE DEPTH TO BE DETERMINED BY THE CONTRACTOR AND TO BE SHOWN ON THE SITE PLAN.
 3. ALL UTILITIES TO BE DEPTH TO BE DETERMINED BY THE CONTRACTOR AND TO BE SHOWN ON THE SITE PLAN.
 4. ALL UTILITIES TO BE DEPTH TO BE DETERMINED BY THE CONTRACTOR AND TO BE SHOWN ON THE SITE PLAN.
 5. ALL UTILITIES TO BE DEPTH TO BE DETERMINED BY THE CONTRACTOR AND TO BE SHOWN ON THE SITE PLAN.
 6. ALL UTILITIES TO BE DEPTH TO BE DETERMINED BY THE CONTRACTOR AND TO BE SHOWN ON THE SITE PLAN.
 7. ALL UTILITIES TO BE DEPTH TO BE DETERMINED BY THE CONTRACTOR AND TO BE SHOWN ON THE SITE PLAN.
 8. ALL UTILITIES TO BE DEPTH TO BE DETERMINED BY THE CONTRACTOR AND TO BE SHOWN ON THE SITE PLAN.
 9. ALL UTILITIES TO BE DEPTH TO BE DETERMINED BY THE CONTRACTOR AND TO BE SHOWN ON THE SITE PLAN.

- GENERAL NOTES - FOUNDATION**
1. FOOTINGS SHALL BEAR ON UNDISTURBED SOIL WITH A MINIMUM BEARING CAPACITY OF 2,000 P.S.F. IF CONDITIONS DO NOT SATISFY THESE REQUIREMENTS COORDINATE WITH THE ARCHITECT. CONTRACTOR SHALL FURNISH ALL NECESSARY ADJUSTMENTS TO THE FOUNDATION SOILS LABORATORY.
 2. ALL CONCRETE SHALL HAVE A MINIMUM COMPRESSIVE STRENGTH OF 3000 P.S.I. AT 28 DAYS.
 3. ALL REINFORCING STEEL SHALL BE A-101 OR A-101A.
 4. CONCRETE PROTECTION FOR REINFORCEMENT SHALL BE 1/2" CLEAR FOR BEAMS & COLUMNS, 2" CLEAR FOR FLOORS & WALLS, 1" CLEAR FOR ROOFING (T.P. UNLESS OTHERWISE SPECIFIED).
 5. REINFORCEMENT SHALL BE 4" THICK WITH #6 @ 18" ON CENTER UNLESS OTHERWISE NOTED.
 6. REINFORCEMENT SHALL BE CONTINUOUS AND LAPPED AT 40% DIAMETER (2'-0" MIN.) EXCEPT AS NOTED AND PROVIDE CORNER BARS OF SAME SIZE AND SPACING.
 7. ALL REINFORCEMENT SHALL BE A-101 OR A-101A.
 8. NO REINFORCEMENT TO BE PLACED IN ANY CORNER.
 9. CONSTRUCTION JOINTS TO BE VERTICAL UNLESS OTHERWISE NOTED. REINFORCING CONTINUOUS.

BZA 12-84

RENT A CENTER

MAX CRISTENSEN ARCHITECT

SCALE: 1"=500'

DATE: 12-84

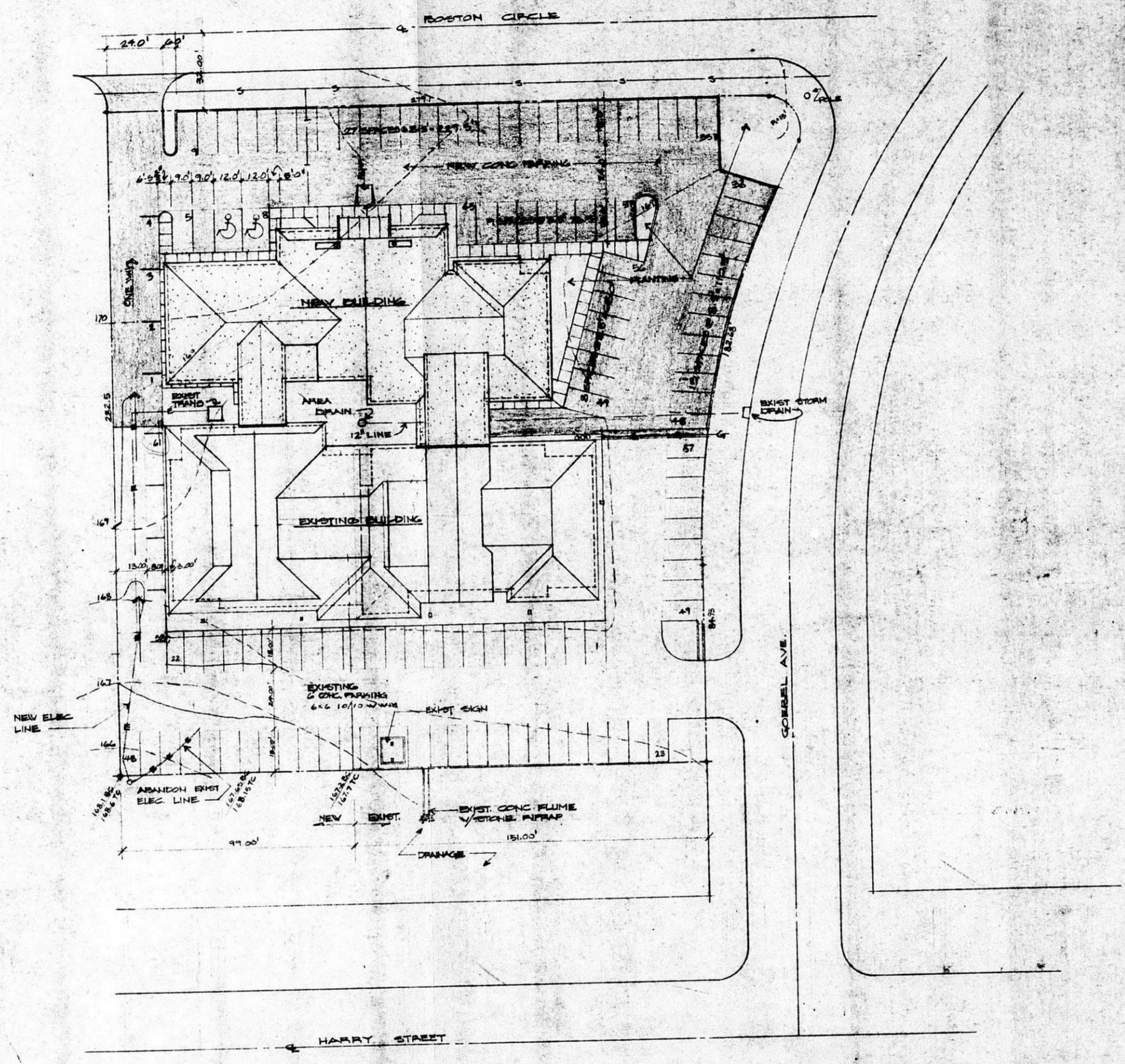

BUILDING AREAS		EASEMENT	
PHASE ONE	35047	1980'	
PHASE TWO	92177	1500'	
PROPOSED EXPANSION	15178'	7480'	
PARKING REQ'D.	151 CARS	30 CARS	

TOTAL REQUIRED 161 CARS
 PARKING PROVIDED 156 CARS

BZA 12-84

- GENERAL NOTES**
1. ALL CONSTRUCTION TO BE IN ACCORDANCE WITH THE LATEST EDITIONS OF THE CODES AND ALL OTHER APPLICABLE LOCAL, STATE AND FEDERAL CODES AND ORDINANCES.
 2. ALL STRUCTURAL STEEL SHALL BE FABRICATED IN ACCORDANCE WITH THE LATEST EDITIONS OF THE AISC SPECIFICATIONS FOR STRUCTURAL STEEL CONNECTIONS AND THE AISC SPECIFICATIONS FOR STRUCTURAL STEEL.
 3. ALL REINFORCING STEEL SHALL BE FABRICATED IN ACCORDANCE WITH THE LATEST EDITIONS OF THE ACI SPECIFICATIONS FOR REINFORCED CONCRETE AND THE ACI SPECIFICATIONS FOR STRUCTURAL CONCRETE.
 4. ALL REINFORCING STEEL SHALL BE FABRICATED IN ACCORDANCE WITH THE LATEST EDITIONS OF THE ACI SPECIFICATIONS FOR REINFORCED CONCRETE AND THE ACI SPECIFICATIONS FOR STRUCTURAL CONCRETE.
 5. ALL REINFORCING STEEL SHALL BE FABRICATED IN ACCORDANCE WITH THE LATEST EDITIONS OF THE ACI SPECIFICATIONS FOR REINFORCED CONCRETE AND THE ACI SPECIFICATIONS FOR STRUCTURAL CONCRETE.
 6. ALL REINFORCING STEEL SHALL BE FABRICATED IN ACCORDANCE WITH THE LATEST EDITIONS OF THE ACI SPECIFICATIONS FOR REINFORCED CONCRETE AND THE ACI SPECIFICATIONS FOR STRUCTURAL CONCRETE.
 7. ALL REINFORCING STEEL SHALL BE FABRICATED IN ACCORDANCE WITH THE LATEST EDITIONS OF THE ACI SPECIFICATIONS FOR REINFORCED CONCRETE AND THE ACI SPECIFICATIONS FOR STRUCTURAL CONCRETE.
 8. ALL REINFORCING STEEL SHALL BE FABRICATED IN ACCORDANCE WITH THE LATEST EDITIONS OF THE ACI SPECIFICATIONS FOR REINFORCED CONCRETE AND THE ACI SPECIFICATIONS FOR STRUCTURAL CONCRETE.
 9. ALL REINFORCING STEEL SHALL BE FABRICATED IN ACCORDANCE WITH THE LATEST EDITIONS OF THE ACI SPECIFICATIONS FOR REINFORCED CONCRETE AND THE ACI SPECIFICATIONS FOR STRUCTURAL CONCRETE.
- GENERAL NOTES - FOUNDATION**
1. FOOTINGS SHALL BEAR ON UNDISTURBED SOIL WITH A MINIMUM UNWEIGHTED AVERAGE CAPACITY OF 2,000 PSF. IF CONDITIONS DO NOT MEET THESE REQUIREMENTS, CONTRACTOR SHALL FURNISH ALL NECESSARY REINFORCEMENT WITH THE ARCHITECT'S APPROVAL.
 2. ALL CONCRETE SHALL HAVE A MINIMUM COMPRESSIVE STRENGTH OF 3000 PSI AT 28 DAYS.
 3. ALL REINFORCING STEEL SHALL MEET ASTM A615-GR 60.
 4. CONCRETE PROTECTION FOR REINFORCING STEEL SHALL BE 1/2" FOR SLAB, 1 1/2" CLEAR FOR BEAMS & COLUMNS, 2" CLEAR FOR FORMED EXPOSED SURFACES.
 5. REINFORCEMENT SHALL BE CONTINUOUS AND LAPPED AS SHOWN UNLESS OTHERWISE NOTED.
 6. ALL REINFORCING STEEL SHALL BE FABRICATED IN ACCORDANCE WITH THE LATEST EDITIONS OF THE ACI SPECIFICATIONS FOR REINFORCED CONCRETE AND THE ACI SPECIFICATIONS FOR STRUCTURAL CONCRETE.
 7. ALL REINFORCING STEEL SHALL MEET ASTM A-108 BAR A PER. OF
 8. ALL REINFORCING STEEL SHALL MEET ASTM A-108 BAR A PER. OF
 9. CONSTRUCTION JOINTS TO BE VERTICAL UNLESS OTHERWISE NOTED.

BZA 12-84

RENT A CENTER

MAX CRIGENSEN ARCHITECT

DATE: 12/12/84
 DRAWN: [Name]
 CHECKED: [Name]
 IN CHARGE: [Name]

FILMED FROM THE BEST AVAILABLE COPY