

BZA 13-67

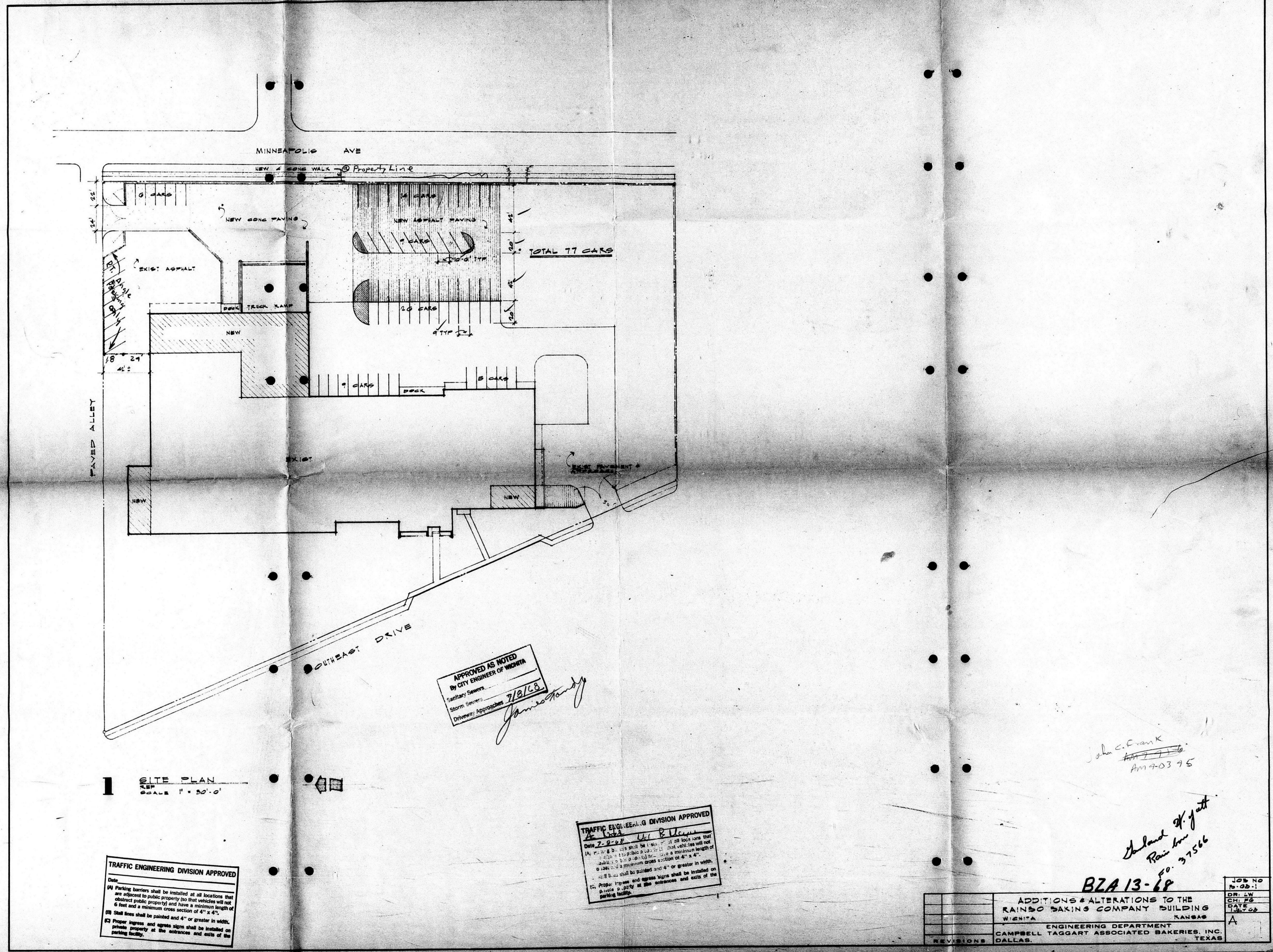

APPROVED AS NOTED
 BY CITY ENGINEER OF WICHITA
 Sanitary Sewers
 Storm Sewers
 Driveway Approaches 7/18/68
James Handy

I SITE PLAN
 REF. SCALE 1" = 50'-0"

TRAFFIC ENGINEERING DIVISION APPROVED
 Date
 (A) Parking barriers shall be installed at all locations that are adjacent to public property so that vehicles will not obstruct public property and have a minimum length of 6 feet and a minimum cross section of 4" x 4".
 (B) Street lines shall be painted and 4" or greater in width.
 (C) Proper signs and signs shall be installed on private property at the entrances and exits of the parking facility.

TRAFFIC ENGINEERING DIVISION APPROVED
 Date 7-22-68
 (A) All lock saws that are used to cut through concrete shall be used in a manner that will not damage the concrete surface.
 (B) All lock saws shall be used in a manner that will not damage the concrete surface.
 (C) Proper signs and signs shall be installed on private property at the entrances and exits of the parking facility.

John C. Frank
 Am 7-03-75

Richard H. Jett
 Rainso
 P.O. 37566
 BZA 13-68

REVISIONS	ADDITIONS & ALTERATIONS TO THE RAINSO BAKING COMPANY BUILDING WICHITA KANSAS	JOB NO. 75-05-1
	ENGINEERING DEPARTMENT CAMPBELL TAGGART ASSOCIATED BAKERIES, INC. DALLAS TEXAS	DATE 7-22-68
		BY A

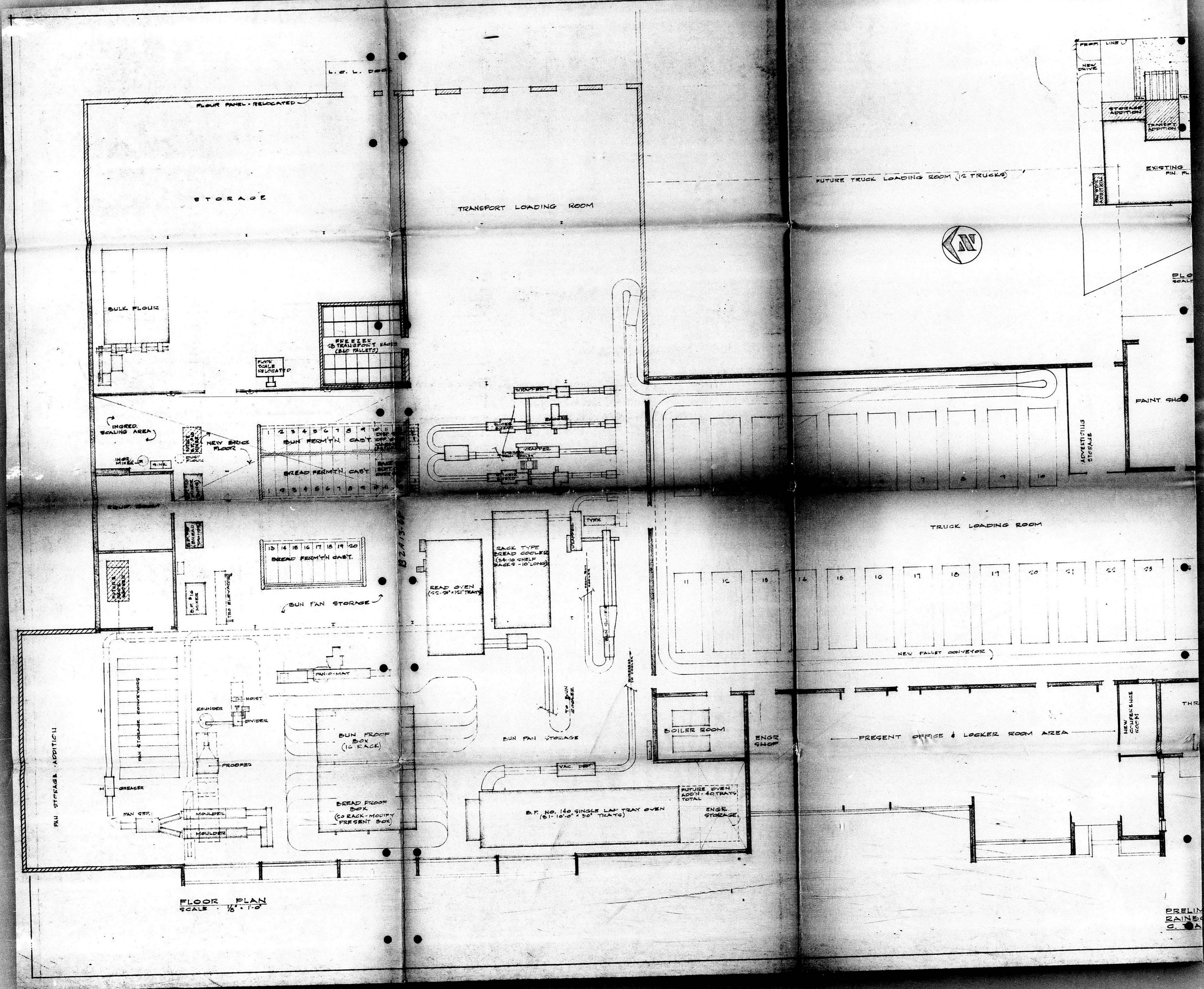

FLOOR PLAN
SCALE 1/8" = 1'-0"

PRELIM
BAINES
C. T. A.

