

MAP No. H-1  
 SEC. 35  
 TWP. 27  
 RANGE 1W  
 NHD \_\_\_\_\_

DATA SHEET

Jan 5-4-61  
 (CU) 188/11-48  
 FILED 3-23-61

APPLICATION DATA: FROM \_\_\_\_\_ TO \_\_\_\_\_  
 1. APPLICANT ELMER H. BOWMAN  
4824 W. PAWNEE WH 3-0211  
 2. AGENT NONE  
 3. LOCATION NORTH SIDE OF PAWNEE BETWEEN WEST ST.  
 AND FLOOD CONTROL PROJ. (ADDRESS) 4824 W. PAWNEE  
 4. PROPOSED USE MOBILE HOME COURT.

AREA DATA  
 1. ACRES 35<sup>±</sup> ( 2640 FT. BY 660 FT.)  
 2. ADJOINING ZONING: E R-1 S E W R-1 N R-1  
 3. LAND USE: EAST VACANT SOUTH VACANT  
 WEST 235W NORTH Barrow Pit  
 4. SKETCH PLAN LAND USE IS FOR Industrial  
 5. PRESENT LAND USE IS FOR Vacant & Barrow Pit, Single family  
 6. AREA is NOT PLATTED.  
 7. \_\_\_\_\_ ACRES OF PROPOSED ZONING WITHIN NEIGHBORHOOD UNIT.

PHOTO DATA:  
 TAKEN BY Mak DATE 4-18-61 TIME 2 PM

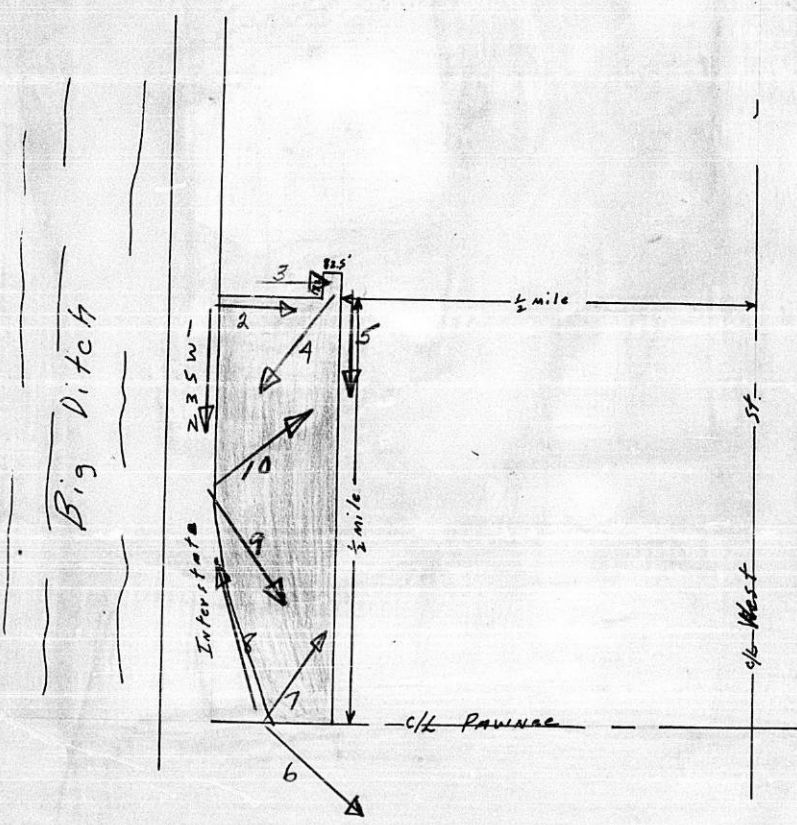

# WICHITA EAGLE AND BEACON PUBLISHING CO., INC.

## Affidavit of Publication

STATE OF KANSAS, }  
County of Sedgwick, } ss.

W. W. Watson, of lawful age, being first duly sworn, deposeseth and saith: That he is Record Clerk of The Wichita Eagle and Beacon, a daily newspaper published in the City of Wichita, County of Sedgwick, State of Kansas, and having a general circulation in said County and which said newspaper has been continuously and uninterruptedly published in said county during the period of one year immediately prior to the first publication of the notice hereinafter mentioned and that a notice of which a true copy is hereto attached was published in the regular and entire daily Evening issue of said The Wichita Eagle and Beacon for 1 consecutive issues - was, that the first publication of said notice was made as aforesaid on the 5 day of June, A.D., 1961

And affiant further says that.....he has personal knowledge of the statements above set forth and that they are true.

Subscribed and sworn to before me this 5 day of June, 1961

*W. W. Watson*  
Notary Public Sedgwick County, Kansas

MAR 21 1963

My Commission expires.....

*64-48*

(1961) Published in the Wichita Eagle and Beacon on June 5, 1961.

**COUNTY RESOLUTION**  
SEDGWICK COUNTY, KANSAS  
A RESOLUTION PERMITTING THE ESTABLISHMENT OF MOBILE HOME PARK AS A CONDITIONAL USE OF THE PROPERTY DESCRIBED AS FOLLOWS:

The E½ of the E¼ of the SW¼ of the East 1/4 of the south 1/4 of the NW¼ of Section 35, Township 20 South, Range 1 West.

SAID LANDS LOCATED WITHIN THE UNINCORPORATED CITY OF WICHITA, SEDGWICK COUNTY, KANSAS, UNDER THE PROVISIONS OF SECTION 11-2-1 AND SECTION 4-2-1 OF THE KANSAS ZONING RESOLUTION AS AMENDED.

APPROVED BY THE BOARD OF COUNTY COMMISSIONERS, SEDGWICK COUNTY, KANSAS, MARCH 21, 1963.

BE IT RESOLVED by the Board of County Commissioners of Sedgwick County, Kansas:

Section 1. That hereinafter on the 4th day of May, 1961, the Metropolitan Area Planning Commission after notice and public hearing as provided by law and under authority granted by Section 11-2 of the Sedgwick County Zoning Resolution as adopted March 2, 1962, recommended to the Board of County Commissioners that the application to establish a Mobile Home Park on the land hereinafter described be granted. Thereafter on the 11th day of May, 1961, the Board of County Commissioners considered said application and the recommendation of the Metropolitan Planning Commission and by a majority vote of the Board of County Commissioners, the Board of County Commissioners approved the conditional use of the lands hereinafter described:

1. The E½ of the E¼ of the SW¼ of the East 1/4 of the south 1/4 of the NW¼ of Section 35, Township 20 South, Range 1 West.

2. The area utilized for Mobile Home Park shall be separated from the adjacent property by a chain link fence.

3. The Conditional Use Permit shall be reviewed in five years by the Metropolitan Area Planning Commission in the same manner in which this application was heard. The applicant shall be responsible for supplying a new or updated site plan or other information for the reviewing project, with which notice may be given to adjacent property owners.

SECTION 11. That upon the taking effect of this resolution the above conditional use shall terminate upon the expiration of the term of the conditional use and be in force from and after its expiration.

Passed and adopted this 11th day of May, 1963.

W. W. Watson  
Record Clerk

Attest: W. O. Williams, County Clerk (1-1)