

ACTION

DATE

COMMITTEE		DATE
M.A.P.C.	<u>Denied</u>	<u>3-29-79</u>
B.C.C. B. CO. C.	<u>Denied</u>	<u>4-25-79</u>
Derby	<u>Approved</u>	<u>2-8-79</u>
Haysville	<u>Deferred to see if site could be relocated</u>	<u>2-22-79</u>
Haysville	<u>Denied</u>	<u>3-22-79</u>

Closed

*Posted
2-2-79*

CU-213 - Cable T. V. Construction,
Ltd. Requests Conditional Use
Permit to Establish a 200' Cable
TV Tower and Facilities on
Property zoned "R" - Rural Resi-
-

5537

Map No. BOOK 4
P-5-A
Sec. 9
Twp. 29S
Range 1E

DATA SHEET
(ZONING & CONDITIONAL USE)

Z-
SCZ-
CU- 213
Filed 1-26-79

- APPLICATION DATA: From _____ to _____
- Applicant: Cable T.V. Construction, Ltd.
Address 15 N. Highland, Chanute, Ks. 66720 Phone 316-431-4160
 - Agent: John Mark Scully - Vice-President
Address _____ Phone _____
 - General Location: 1/4 mile south & 1/4 mile west of the intersection of Hydraulic & 79th St. South Address _____
 - Proposed Use: to establish a 200' Cable TV Tower & Facilities in "R" zoning.

- AREA DATA:
- Acres: 1.0 (208 ft. by 208 ft.)
 - Adjoining Zoning: E "R" S "R" W "R" N "R"
 - Land Use: East FRUIT ORCHARD South Single family Orchard
West FRUIT ORCHARD North Orchard
 - Sketch Plan Land Use is for: _____
 - Present Land Use is for: FRUIT ORCHARD
 - Area (is) (is not) platted.

PROCEDURE DATA:

- Zoning Committee _____ by _____
- MAPC Meeting:

	Date	Action
DERBY P.C.	2-8-79	Approved
HAYSVILLE P.C.	2-22-79	Deferred to see if site could be relocated.
MAPC	3-28-79	Declined
Haysville	3-22-79	Denied

- Governing Body (~~Bd. City Commissioners~~ - Bd. County Commissioners)

Date	Action	Resolution
4-25-79	Denied	

NOTES: 3/2/79

Larry Sims, chairman Derby PC, advised that it would not be necessary for their Planning Commission to reconsider this case as to the amended location.

3-22-79 Haysville denied the request and reasons stated were that applicant had not considered a site location at the SW corner of the Orchard as requested; and tower height was uncertain.

5537

BOOK 4
Map No. P-5-A
Sec. 9
Twp. 29
Range 1E

DATA SHEET
(ZONING & CONDITIONAL USE)

Z- _____
SCZ- _____
CU- 213
Filed 1-26-79

- APPLICATION DATA: From _____ to _____
- Applicant: Cable T.V. Construction, Ltd. et al
Address 15 N. Highland, Chanute, Ks. 66720 Phone 6-431-4160
 - Agent: John Mark Scully - Vice-President
Address _____ Phone _____
 - General Location: 1/4 mile south & 1/4 mile west of the intersection of Hydraulic & 79th St. South. Address _____
 - Proposed Use: to establish a 200' Cable TV Tower & Facilities in "R" zoning.

- AREA DATA:
- Acres: 1.0 (208 ft. by 208 ft.)
 - Adjoining Zoning: E "R" S "R" W "R" N "R"
 - Land Use: East FRUIT ORCHARD South Single family
West FRUIT ORCHARD North Orchard
 - Sketch Plan Land Use is for: _____
 - Present Land Use is for: FRUIT ORCHARD
 - Area (is) (is not) platted.

PHOTO DATA:
Taken by _____ Date _____ Time _____

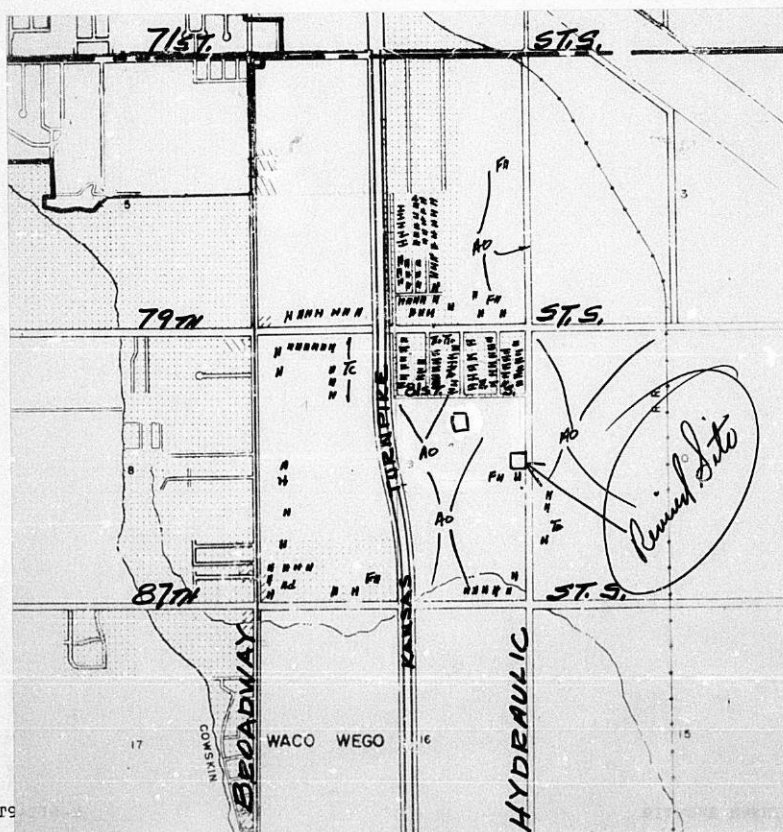

WICHITA-SEDGWICK COUNTY
METROPOLITAN AREA PLANNING COMMISSION
CITY HALL, TENTH FLOOR, 455 North Main Street
Wichita, Kansas 67202

March 15, 1979

NOTICE TO ADJOINING PROPERTY OWNERS:

NOTICE IS HEREBY GIVEN that on Thursday, March 22, 1979, at 8:00 p.m., the HAYSVILLE CITY PLANNING COMMISSION, City Hall, Haysville, Kansas, will consider the following item for purposes of making a recommendation to the Metropolitan Area Planning Commission and Board of County Commissioners.

CASE NO. CU-213

Conditional Use Request to Permit Establishment of
a Cable TV Tower and Facilities
in the "R" Rural Residential District

A tract in the S $\frac{1}{2}$ of the N.E. $\frac{1}{4}$ of Section 9, Twp. 29S, R1E of the 6th P.M., Sedgwick County, described as follows: Beginning at S.E. corner of the N.E. $\frac{1}{4}$ of the aforesaid section, thence West 208.71 feet, thence North 203.71 feet, thence South 203.71 feet, thence East 203.71 feet to the point of beginning. Generally located on the west side of Hydraulic 1/2 mile south of 79th Street South.

If this matter is not deferred for further hearing before the Haysville City Planning Commission, then as provided in the County Zoning Resolution, Section 14 - Administration sub-paragraph C, this item will be discussed and considered by the WICHITA-SEDGWICK COUNTY METROPOLITAN AREA PLANNING COMMISSION at their regular meeting beginning at 1:30 p.m., Thursday, March 29, 1979, in the City Commission Meeting Room, City Hall, First Floor, 455 North Main Street, Wichita, Kansas. All persons interested in said matter will be heard at this time concerning their views and wishes in the premises, and any protest against any of the provisions of the proposed Conditional Use will be considered as by law provided.

Additional information concerning this case and official protest procedures may be obtained from the Planning Department, 10th Floor, City Hall, or by calling 268-4421.

Robert A. Lakin
Secretary

WICHITA AIRPORT AUTHORITY

MID-CONTINENT AIRPORT WICHITA, KANSAS

*Edie
F. Bell
Cu 213*

TO: Jack H. Galbraith, Chief Planner

DATE: Feb. 5, 1979

FROM: H. Jay Setter, Director of Aviation

SUBJECT: CU-213 - TELEVISION TOWER CONSTRUCTION

This office has reviewed your memorandum of January 31, 1979, regarding the subject matter. It has been observed that the proposed 200' television tower to be constructed near 79th Street South and Hydraulic will have no effect upon air traffic at Wichita Mid-Continent Airport due to its distance from the airport.

Regarding the possible effect on other airports in the immediate area, it is suggested that you contact Mr. Benny J. Kirk, Operations, Procedures and Airspace Branch, FAA, Kansas City, Missouri, telephone (816) 374-3408. The FAA has the responsibility of determining the possible effect of proposed obstructions to airports in the immediate area.

H. Jay Setter
Director of Aviation

HJS:BFB:dn

cc: Floyd J. Roedell
Bailis F. Bell

Attach.



RECOMMENDATION FROM METROPOLITAN AREA PLANNING COMMISSION TO
BOARD OF COUNTY COMMISSIONERS

REQUEST FOR CONDITIONAL USE PERMIT

CASE NO. CU-213

CONSIDERED BY DCPC: 2-8-79
CONSIDERED BY HCPC: 3-22-79
CONSIDERED BY MAPC: 3-29-79

REQUEST FOR: Conditional Use
Permit

REASON FOR REQUEST (AS PROVIDED BY APPLICANT):

"To establish a 200' CATV tower, earth receiver station, and
12' x 15' head-end building to serve the towns of Derby and
Haysville with cable television."

GENERAL LOCATION: West side of Hydraulic 1/2 mile south of 79th
Street South.

LEGAL DESCRIPTION:

(See excerpt from Planning Commission minutes of
March 29, 1979)

APPLICANT: Cable T.V. Construction, Ltd., et al, 15 N. Highland,
Chanute, Ks.

COUNSEL FOR APPLICANT: John M. Scully, Vice President.

PROTESTORS (LIST COUNSEL) IF ANY: Don Moehring, Engineer, 433 South
Hydraulic.

SURROUNDING ZONING: North, East, South and West, "R".

LAND USE: Existing, North, East and West, Orchard; South, Single Family.

PLANNING COMMISSION RECOMMENDATION:

That this Conditional Use Permit ~~not be approved.~~ Bayouth moved, Bell
seconded and it carried with a vote of 6 in favor (Bayouth, Bell, Barrier,
May, Taylor and Jones), and 2 opposed (Cole and Hennessy). Savina and
Taylor were absent.

NOTE: A recommendation of denial by the Planning Commission requires
a unanimous vote of the County Commission in order to approve the
application.

ACTION: 1. Approve the recommendation of the Metropolitan Area Planning
Commission and deny the application; or
2. Take such action as the County Commission deems appropriate.

Bay
Bok

EXCERPT FROM PLANNING COMMISSION MINUTES OF MARCH 29, 1979:

18. Case No. CU-213 - Cable T.V. Construction, Ltd. requests a Conditional Use Permit for a tract in the S $\frac{1}{4}$ of the N.E. $\frac{1}{4}$ of Section 9, Twp. 29S, R1E of the 6th P.M., Sedgwick County, described as follows: Beginning at S.E. corner of the N.E. $\frac{1}{4}$ of the aforesaid section, thence West 208.71 feet, thence North 208.71 feet, thence South 208.71 feet, thence East 208.71 feet to the point of beginning. Generally located on the west side of Hydraulic 1/2 mile south of 79th Street South.

GALBRAITH showed slides of the area and surrounding area and reviewed the following staff report:

COMMENTS

1. The applicant is requesting a Conditional Use Permit to construct a cable TV tower 200 feet in height, earth receiver station and head-end building on a tract of land 208 x 208 feet, on the west side of Hydraulic one-half mile south of 79th Street South. Hydraulic is an FAS road and provides for only 25 feet of half-street right-of-way whereas 60 feet is required.
2. The Board of County Commissioners may, by special permit and subject to such restrictions as it deems necessary, permit a television transmitting facility in the "R" Rural Residential District as a conditional use.
3. Subject property lies within 50,000 feet of the established McConnell Air Force Base reference point and, therefore, is subject to certain height restrictions set forth in Section 28.08.050 of the City of Wichita Airport zoning code. Section 28.02.140 states, in part, that "no material change shall be made in the use of the land, and no structure shall be erected, or otherwise established in any zone hereby created, unless a permit therefore shall have been applied for and granted, except that a permit shall not be required for any structure less than twenty-five feet in height".
4. Upon receiving this application, the Planning Department contacted the Federal Aviation Agency requesting their evaluation and comments as to the location of the television tower on this site as related to air traffic in the area. At this time, a reply to the foregoing letter has not been received.
5. If it is determined by the Planning Commission that the use proposed is proper for the area, it is recommended that it be approved subject to the following:
 - a. The applicant obtaining an airport zoning permit from the Central Inspection Division of the City of Wichita so that the tower heights can be accurately determined.
 - b. The applicant obtaining approval from the Federal Aviation Administration and complying with all conditions of approval.
 - c. Dedication by separate instrument the necessary street right-of-way to provide for 60 feet of half-street right-of-way on Hydraulic prior to the publication of the resolution effectuating the conditional use and within one year.

GALBRAITH stated that at the first meeting of the Derby Planning Commission they approved the application that was not precisely where the site is located now. He said that this case is in the area of influence of Haysville, and when

it was considered by the Haysville Planning Commission, there were several people in attendance who were concerned about the actual location being where Lulu might someday come through the area. The action of the Haysville Planning Commission was to request that the applicant attempt to relocate the site elsewhere. They particularly mentioned the southwest corner of the 80 acres abutting the Kansas Turnpike. The application was readvertised, and the Haysville Planning Commission reconsidered the case. Their action was to recommend that the application not be approved. Their reason was that the tower height had not been pinned down precisely, and that the applicant had not considered their suggestion that he locate southwest. GALBRAITH said that the applicant advised that they had considered that location, but the owner of the land did not agree with that location.

JOHN M. SCULLY, Attorney and Vice-President of Cable T.V. Construction, Ltd., stated that they were not the company that was building the Wichita cable T.V. system. He said that the reason for the site they have selected was because it can look at the Andover tower which is 368 feet in height. Because of the weather they have not had the opportunity to send a man up the Andover tower. He said that if from the top of the Andover tower they could look at this site and look at ground level, then in fact the proposed tower would be no higher than a telephone pole. In order to have the height for their tower, they applied to the FCC for 200 feet. McConnell did register objection because the tower of that height would be in their radar sweep, so they reduced it to 176 feet at their request and the FAA approved it. SCULLY said that they could not go to the east of this site because that was a McConnell approach area. He said that by locating the tower between Derby and Haysville, they could serve both towns from one site and save several hundred thousands of dollars to their company. He requested serious consideration be given to approving this site, because without this particular site they would have to undergo several thousand dollars worth of reengineering and redesign.

JONES asked if the tower would have to be a certain distance from Derby and Haysville.

SCULLY stated that the only other place the tower could go from this point would be to either establish a tower for Derby on the east, and a tower for Haysville wherever they could get a location, which would be costly.

JONES asked how far the tower was from the existing house south of this site. GALBRAITH said the house is adjacent to the site.

CHAIRMAN GREIDER asked what were the thoughts of the Zoning Committee on this site.

JONES said that there was a lot of territory between Derby and Haysville without putting the tower right next to a new housing addition, especially next to an existing house. He felt the character of the neighborhood should be taken into consideration.

DON MOEHFING, engineer, speaking for the owner of the 80 acres to the south, and the owner of the single family residence to the south, stated that they were present at the time the initial hearing was made at Haysville, and at that time, the tower site was located in the middle of the 80 acre tract. Their initial concern was that they were in the process of platting the 80 acres abutting to the south. They did not feel they could complain much more than the complaint from the existing residences to the north, because if they asked that the tower be moved farther away it would get closer to them. He said to erect a 200 foot tower next door to a house, the owner could not help but feel this would affect his property value, particularly for the sacrifice of an acre of peaches. He said that he was sure that if there was some positive way to limit the height of the tower, maybe mounted on a large power pole, it would not be

nearly as objectionable, and would not affect property values.

MOTION: That the Planning Commission recommend to the County Commission that this Conditional Use Permit not be approved. Bayouth moved, Bell seconded and it carried with a vote of 6 in favor (Bayouth, Bell, Barrier, May, Taylor and Jones), and 2 opposed (Cole and Hennessy). Savina and Taylor were absent.

RESOLUTION

CASE NO. CU-213

A RESOLUTION PERMITTING A CABLE TV TOWER AND FACILITIES OPERATION IN THE "R" RURAL RESIDENTIAL DISTRICT ON CERTAIN LANDS LOCATED WITHIN THE UNINCORPORATED TERRITORY LYING WITHIN THREE MILES OF EITHER THE CITY OF WICHITA, THE CITY OF HAYSVILLE, THE CITY OF DERBY, THE CITY OF MULVANE, THE CITY OF VALLEY CENTER, THE CITY OF GODDARD, AND THAT PORTION OF THE AREA WITHIN THREE MILES OF THE CITY OF CHENEY AS ESTABLISHED BY THE BOARD OF COUNTY COMMISSIONERS ON OCTOBER 3, 1973, ALL IN SEDGWICK COUNTY, KANSAS, UNDER THE AUTHORITY GRANTED BY SECTION 3.A.8.1 AND SECTION 11.E OF THE ZONING RESOLUTION ADOPTED BY THE BOARD OF COUNTY COMMISSIONERS OF SEDGWICK COUNTY, KANSAS, ON MARCH 3, 1958, AND SUBSEQUENT AMENDMENTS THERETO.

BE IT RESOLVED BY THE BOARD OF COMMISSIONERS OF SEDGWICK COUNTY, KANSAS:

SECTION I. That after receiving a recommendation from Wichita-Sedgwick County Metropolitan Area Planning Commission and after said Planning Commission has given proper notice and held a public hearing as provided by law, and under authority granted by Section 3.A.8.1 and Section 11.E of the Zoning Resolution, as amended, a Conditional Use Permit to allow a cable TV tower and facilities operation in the "R" Rural Residential District is hereby approved on the lands legally described as follows:

S $\frac{1}{2}$ of the N.E. $\frac{1}{4}$ of Section 9, Twp. 29S, R1E of the 6th P.M., Sedgwick County, described as follows: Beginning at S.E. corner of the N.E. $\frac{1}{4}$ of the aforesaid section, thence West 208.71 feet, thence North 208.71 feet, thence South 208.71 feet, thence East 208.71 feet to the point of beginning. Generally located on the west side of Hydraulic $\frac{1}{2}$ mile south of 79th Street South.

SUBJECT TO THE FOLLOWING:

- a. The tower height shall not exceed 176 feet.
- b. The applicant obtaining an airport zoning permit from the Central Inspection Division of the City of Wichita so that the tower heights can be accurately determined.
- c. The applicant obtaining approval from the Federal Aviation Administration and complying with all conditions of approval.
- d. Dedication by separate instrument the necessary street right-of-way to provide for 60 feet of half-street right-of-way on Hydraulic prior to the publication of the resolution effectuating the conditional use and within one year.

SECTION II. That upon the taking effect of this Resolution, the notation of such Conditional Use approval shall be entered in the Official Zoning atlas on file in the Office of the County Zoning Administrator and in the Office of the Wichita-Sedgwick County Metropolitan Area Planning Department.

SECTION III. That this Resolution shall take effect and be in force from and after its adoption and publication in the Official County Paper.

PASSED AND ADOPTED by the Board of County Commissioners
at Wichita, Kansas, this ____ day of _____, 19____.

_____, Chairman
Tom Scott

_____, Commissioner
Donald Gragg

_____, Commissioner
Everett Patrick

ATTEST:

Dorothy K. White, County Clerk

(SEAL)

Approved as to form by County Counselor

Theodore H. Hill, County Counselor

April 2, 1979

John M. Scully, Vice President
Cable T.V. Construction, Ltd.
15 N. Highland
Chanute, Kansas 66720

Re: CU-213 - Conditional Use
Permit - west side of
Hydraulic 1/2 mile south
of 79th St. South

Dear Mr. Scully:

At its regular meeting of March 29, 1979, the Metropolitan Area Planning Commission considered the above-captioned zone change request. The action of the Commission was to recommend that this Conditional Use Permit not be approved.

During the discussion, you mentioned having received a letter from the F.A.A. approving the site subject to certain conditions. Would you please send us a copy of that letter for our files.

This matter will be forwarded to the Board of County Commissioners for their consideration at 9:00 a.m., on Wednesday, April 25, 1979, in Room 320, Sedgwick County Courthouse.

If you have any questions, please contact our office.

Sincerely yours,

Jack H. Galbraith
Chief Planner

JHG:bbc

cc: Syd Werbin, County Zoning Officer
Larry Sims, Chmn., Derby Planning Commission,
820 English Ct., Derby 67037
Bill Hancock, Chmn., Haysville Planning Commission,
1500 E. 79th St. South, Wichita 67233

CU-213 - 5 "Notice to Adjoining Property Owners" mailed 3/16/79
for the MAPC meeting for 3-29-79 & HAYSVILLE 3-22-79.

13 - mailed NOTICE, STAFF REPORT & REFERRAL SHEETS

1 Applicant
12 HAYSVILLE P.C. (including Sect., Grover McLure, etc.)

18 TOTAL

WICHITA-SEDGWICK COUNTY
METROPOLITAN AREA PLANNING COMMISSION
CITY HALL, TENTH FLOOR, 455 North Main Street
Wichita, Kansas 67202

March 15, 1979

NOTICE TO ADJOINING PROPERTY OWNERS:

NOTICE IS HEREBY GIVEN that on Thursday, March 22, 1979, at 8:00 p.m., the HAYSVILLE CITY PLANNING COMMISSION, City Hall, Haysville, Kansas, will consider the following item for purposes of making a recommendation to the Metropolitan Area Planning Commission and Board of County Commissioners.

CASE NO. CU-213

Conditional Use Request to Permit Establishment of
a Cable TV Tower and Facilities
in the "R" Rural Residential District

A tract in the S $\frac{1}{2}$ of the N.E. $\frac{1}{4}$ of Section 9, Twp. 29S, R1E of the 6th P.M., Sedgwick County, described as follows: Beginning at S.E. corner of the N.E. $\frac{1}{4}$ of the aforesaid section, thence West 208.71 feet, thence North 208.71 feet, thence South 208.71 feet, thence East 208.71 feet to the point of beginning. Generally located on the west side of Hydraulic 1/2 mile south of 79th Street South.

If this matter is not deferred for further hearing before the Haysville City Planning Commission, then as provided in the County Zoning Resolution, Section 14 - Administration sub-paragraph C, this item will be discussed and considered by the WICHITA-SEDGWICK COUNTY METROPOLITAN AREA PLANNING COMMISSION at their regular meeting beginning at 1:30 p.m., Thursday, March 29, 1979, in the City Commission Meeting Room, City Hall, First Floor, 455 North Main Street, Wichita, Kansas. All persons interested in said matter will be heard at this time concerning their views and wishes in the premises, and any protest against any of the provisions of the proposed Conditional Use will be considered as by law provided.

Additional information concerning this case and official protest procedures may be obtained from the Planning Department, 10th Floor, City Hall, or by calling 268-4421.

Robert A. Lakin
Secretary

26

John Mark Scully
Attorney at Law

P. O. BOX 776 — 15 NORTH HIGHLAND
CHANUTE, KANSAS 66720
March 1, 1979

AREA CODE 316
OFFICE 431-4160



Mr. Jack Galbraith, Chief Planner
Metropolitan Area Planning Department
City Hall- Tenth Floor
455 North Main Street
Wichita, Kansas 67202

Re: Case No. CU-213

Dear Jack,

Please amend the legal description of the tower site in the above captioned case to read as follows:

A tract in the S½ of the N.E.¼ of Section 9, Twp.29S, R1E of the 6th P.M., Sedgwick County, described as follows: Beginning at S.E. corner of the N.E.¼ of the aforesaid section, thence West 208.71 feet, thence North 208.71 feet, thence South 208.71 feet, thence East 208.71 feet to the point of beginning.

I am having my secretary call the description over to Security Abstract & Title Company with a request that they forward to you a certification of the names of all the property owners lying within 1,000 feet of this description.

Many thanks for your help.

Sincerely,

John M. Scully
John M. Scully
Vice President

JMS/vr

OWNERSHIP LIST

Tract	Property Owner
The SE $\frac{1}{4}$ of Section 9-29-1E except the south 1456 feet thereof, and except the north 90 feet of the east 220 feet, and except that portion taken for the Kansas Turnpike row	✓ Howard D. Mahoney and Barbara Jean Mahoney 8429 South Hydraulic 67233
The North 90 feet of the East 220 feet of the SE $\frac{1}{4}$ of Section 9-29-1E	✓ Ronald L. Wolf 8401 South Hydraulic 67233
The South half of the NE $\frac{1}{4}$ of Section 9-29-1E except that part of the SW $\frac{1}{4}$ of the NE $\frac{1}{4}$ taken for Kansas Turnpike and except a tract beg. at a point 230 feet south of the NE corner of the south half of the NE $\frac{1}{4}$ of said Section 9; thence south along the east line of said NE $\frac{1}{4}$, 294 feet; thence west parallel with the north line of the south half of said NE $\frac{1}{4}$, 362 feet; thence north parallel with the east line of said NE $\frac{1}{4}$, 294 feet; thence east 362 feet to the place of beginning	✓ Robert F. Batson and Nina D. Batson 8321 South Hydraulic 67233
The West half of the SW $\frac{1}{4}$ of Section 10-29-1E except the South 511.1 feet of the west 460 feet of the NW $\frac{1}{4}$ of the SW $\frac{1}{4}$ said Section 10	✓ Martin M. Meyer and Frances M. Meyer 5335 South Hydraulic 67216
The West half of the NW $\frac{1}{4}$ of Section 10-29-1E	✓ Butts Farms Inc. Rt. 2, Mulvane, Kansas 67110

Use this list for mailing
of new notices on amended
application area. *gbs*

We hereby certify the foregoing to be a true and correct list of the property owners of:

A 417 foot radius of: a tract in the south half of the NE $\frac{1}{4}$ of Section 9-29-1E, beginning at the SE corner of said NE $\frac{1}{4}$ Section 9; thence west 208.71 feet, thence north 208.71 feet, thence east 208.71 feet, thence south 208.71 feet to the point of beginning

as shown by the last deeds of record on file in the Office of the Register of Deeds of Sedgwick County, Kansas, on the 2nd day of March, 1979 at 7:00 o'clock A.M.

THE SECURITY ABSTRACT & TITLE CO., INC.

By

Mary Gable

Vice President

Order No. 274184
wh

February 23, 1979

John Mark Scully, Vice-President
Cable T.V. Construction, Ltd.
15 N. Highland
Chanute, Kansas 66720

Re: Case No. CU-213

Dear Mr. Scully:

I hope you recovered from the long meeting and your daughter was better when you returned home.

As a result of Haysville's action to defer your request so that you could determine if you could lease another piece of property that will not interfere with the extension of Lulu, and that might be located further to the south and west, it will be necessary for you to provide us a revised legal description if a new site is selected. We will have to readvertise and again mail out notices. We would need a revised abstract ownership list of all property owners and their mailing addresses within 1000 feet of the revised legal.

If you select a new location, we will need the revised legal and ownership list by March 6th if you want to have Haysville reconsider the case at their meeting of March 22, 1979.

If you have any questions, please call.

Sincerely,

Jack H. Galbraith
Chief Planner

JHG:el

Derby 2-8-79
Approved the tower height at
the requested location.

Hopville 2-22-79
Deferred for the applicant to
attempt to move the tower
location off of the line for
extending ~~North~~ and to
attempt to relocate further
south and west.

Hopville 3-22-79

WICHITA-SEDGWICK COUNTY
METROPOLITAN AREA PLANNING DEPARTMENT

DCPC HEARING DATE: 2-8-79
HCPC HEARING DATE: 2-22-79
MAPC HEARING DATE: 3-1-79

Case No. CU-213 Request: Conditional Use Permit
to establish a Cable
TV Transmitting Facility
in "R" Rural Residential

Location: Approximately 1/4 mile south and 1/4 mile west of
the intersection of 79th Street South and Hydraulic

Reason: To establish a 200' CATV tower, earth receive station,
and 12' x 15' head-end building to serve the towns of
Derby and Haysville with cable television.

Acres: 1.8 Size: 280' x 280'

	<u>Land Use</u>	<u>Zoning</u>
Existing	Orchard & Undeveloped	"R"
North	Orchard & Undeveloped	"R"
East	Orchard	"R"
South	Orchard	"R"
West	Orchard	"R"

Platted: No History: None

COMMENTS:

1. The applicant is requesting a Conditional Use Permit to construct a cable TV tower 200 feet in height, earth receiver station and head-end building on a tract of land 280 x 280 feet, in an area approximately 1/4 mile south and 1/4 mile west of the intersection of 79th Street South and Hydraulic.
2. The Board of County Commissioners may, by special permit and subject to such restrictions as it deems necessary, permit a television transmitting facility in the "R" Rural Residential District as a conditional use.

Case No. CU-213
MAPC AGENDA
3-1-79
Page 2

3. Subject property lies within 50,000 feet of the established McConnell Air Force Base reference point and, therefore, is subject to certain height restrictions set forth in Section 28.08.050 of the City of Wichita Airport zoning code. Section 28.02.140 states, in part, that "no material change shall be made in the use of the land, and no structure shall be erected, altered or otherwise established in any zone hereby created, unless a permit therefore shall have been applied for and granted, except that a permit shall not be required for any structure less than twenty-five feet in height".
4. Upon receiving this application, the Planning Department contacted the Federal Aviation Agency requesting their evaluation and comments as to the location of the television tower on this site as related to air traffic in the area. At this time, a reply to the foregoing letter has not been received.
5. In viewing an aerial photograph of the general area, it appears that subject property does not have direct access to a public street. The applicant should be prepared to discuss how access to the site from a public street will be provided.
6. If it is determined by the Planning Commission that the use proposed is proper for the area, it is recommended that it be approved subject to the following:
 - a. The applicant obtaining an airport zoning permit from the Central Inspection Division of the City of Wichita so that the tower heights can be accurately determined.
 - b. The applicant obtaining approval from the Federal Aviation Administration and complying with all conditions of approval.

WICHITA AIRPORT AUTHORITY

MID-CONTINENT AIRPORT WICHITA, KANSAS

TO: Jack H. Galbraith, Chief Planner

DATE: Feb. 5, 1979

FROM: H. Jay Setter, Director of Aviation

SUBJECT: CU-213 - TELEVISION TOWER CONSTRUCTION

This office has reviewed your memorandum of January 31, 1979, regarding the subject matter. It has been observed that the proposed 200' television tower to be constructed near 79th Street South and Hydraulic will have no effect upon air traffic at Wichita Mid-Continent Airport due to its distance from the airport.

Regarding the possible effect on other airports in the immediate area, it is suggested that you contact Mr. Penny J. Kirk, Operations, Procedures and Airspace Branch, FAA, Kansas City, Missouri, telephone (816) 374-3408. The FAA has the responsibility of determining the possible effect of proposed obstructions to airports in the immediate area.

H. Jay Setter
Director of Aviation

HJS:BFB:dn

cc: Floyd J. Roedell
Bailis F. Bell

Attach.



WICHITA-SEDGWICK COUNTY

DATE

January 31, 1979

METROPOLITAN AREA PLANNING DEPARTMENT

TO H. Jay Setter, Director of Aviation
FROM Jack H. Galbraith, Chief Planner
SUBJECT CU-213 - Television Tower Construction

Our office has received an application for a Conditional Use Permit under the "R" Rural Residential District of the County Zoning Regulations. The applicant, Cable T.V. Construction, Ltd., is proposing to construct a television tower 200 feet high, earth receiver station and head-end building on a tract of land 280 X 280 feet, in an area approximately 1/4 mile south and 1/4 mile west of the intersection of 79th Street South and Hydraulic.

Consideration of this request is scheduled for the Derby City Planning Commission meeting of February 8, 1979, the Haysville City Planning Commission meeting of February 22, 1979, and the Metropolitan Area Planning Commission on March 1, 1979. We would appreciate your comments as to the location of this proposed tower and what conflicts, if any, on air traffic in the area.

We would appreciate your comments at the earliest possible date so that they may be presented to the various planning commissions. Your assistance in this matter is appreciated.

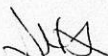
Jack H. Galbraith
Chief Planner

JHG:GLS:el

COPIES FURNISHED TO

✓

✓

RECEIVED

FEB 2 1979

Mid-Cont. Airpo: :

CU 213
1 appx.
37 on mass adv.
1 Ma. Ruler
1 B. Bickley
10 Derby P.C. Sect.

9 Haysville P.C.
1 Sect.
1 Outside Agent
1 Grover McLure

CU-213 - 37 "Notice to Property Owners" mailed 2/6/79 for the
Derby P.C. meeting 2-8-79;
the Haysville P.C. meeting 2-22-79; and
the MAPC meeting for 3-1-79

THE FOLLOWING RECEIVED NOTICE, STAFF REPORT & REFERRAL SHEETS

1 Applicant
9 Derby P.C.
1 Secretary
1 Grover McLure
1 C. Bickley Foster

9 Haysville P.C.
1 Sect.
1 Outside Agent
1 Grover McLure

WICHITA-SEDGWICK COUNTY
METROPOLITAN AREA PLANNING COMMISSION
CITY HALL, TENTH FLOOR, 455 North Main Street
Wichita, Kansas 67202

February 2, 1979

NOTICE TO ADJOINING PROPERTY OWNERS:

NOTICE IS HEREBY GIVEN that on Thursday, February 3, 1979, at 7:00 p.m., the DERBY CITY PLANNING COMMISSION, City Hall, Derby, Kansas, will consider the following item for purposes of making a recommendation to the Metropolitan Area Planning Commission and Board of County Commissioners.

CASE NO. CU-213

Conditional Use Request to Permit Establishment of
a 200' Cable TV Tower and Facilities
in the "R" Rural Residential District

A tract in the S $\frac{1}{2}$ of the N.E. $\frac{1}{4}$ of Section 9, Twp. 29S, R1E of the 6th P.M., Sedgwick County, described as follows: beginning at a point 1210 ft. west and 280 feet south of the N.E. corner of said South $\frac{1}{2}$ of said N.E. $\frac{1}{4}$; thence South 280 feet, thence West 230 feet, thence North 280 feet, thence East to place of beginning. Generally located 1/4 mile south and 1/4 mile west of the intersection of Hydraulic and 79th St. South.

This matter will also appear on the agenda for the regular meeting of the HAYSVILLE CITY PLANNING COMMISSION at 8:00 p.m., Thursday, February 22, 1979, Haysville City Hall, Haysville, Kansas, for purposes of making a recommendation to the Metropolitan Area Planning Commission and Board of County Commissioners.

If this matter is not deferred for further hearings before either the Derby City Planning Commission or the Haysville City Planning Commission, then as provided in the County Zoning Resolution, Section 14-Administration sub-paragraph C, this item will be discussed and considered by the WICHITA-SEDGWICK COUNTY METROPOLITAN AREA PLANNING COMMISSION at their regular meeting beginning at 1:30 p.m., Thursday, March 1, 1979, in the City Commission Meeting Room, City Hall, First Floor, 455 North Main Street, Wichita, Kansas. All persons interested in said matter will be heard at this time concerning their views and wishes in the premises, and any protest against any of the provisions of the proposed Conditional Use will be considered as by law provided.

Additional information concerning this case and official protest procedures may be obtained from the Planning Department, 10th Floor, City Hall, or by calling 268-4421.

Robert A. Lakin
Secretary

January 31, 1979

H. Jay Setter, Director of Aviation

Jack H. Galbraith, Chief Planner

CU-213 - Television Tower Construction

Our office has received an application for a Conditional Use Permit under the "R" Rural Residential District of the County Zoning Regulations. The applicant, Cable T.V. Construction, Ltd., is proposing to construct a television tower 200 feet high, earth receiver station and head-end building on a tract of land 280 X 280 feet, in an area approximately 1/4 mile south and 1/4 mile west of the intersection of 79th Street South and Hydraulic.

Consideration of this request is scheduled for the Derby City Planning Commission meeting of February 8, 1979, the Haysville City Planning Commission meeting of February 22, 1979, and the Metropolitan Area Planning Commission on March 1, 1979. We would appreciate your comments as to the location of this proposed tower and what conflicts, if any, on air traffic in the area.

We would appreciate your comments at the earliest possible date so that they may be presented to the various planning commissions. Your assistance in this matter is appreciated.

Jack H. Galbraith
Chief Planner

JHG:GLS:el

20-213

January 31, 1979

Captain De Fend
Public Information Officer
McConnell Air Force Base
Wichita, Kansas 67221

Dear Captain De Fend:

Our office has received an application for a Conditional Use Permit under the "R" Rural Residential District of the County Zoning Regulations. The applicant, Cable T.V. Construction, Ltd., is proposing to construct a television tower 200 feet high, earth receiver station and head-end building on a tract of land 280 X 280 feet, in an area approximately 1/4 mile south and 1/4 mile west of the intersection of 79th Street South and Hydraulic.

Consideration of this request is scheduled for the Derby City Planning Commission meeting of February 8, 1979, the Haysville City Planning Commission meeting of February 22, 1979, and the Metropolitan Area Planning Commission on March 1, 1979. We would appreciate your comments as to the location of this proposed tower and what conflicts, if any, on air traffic in the area.

We would appreciate your comments at the earliest possible date so that they may be presented to the various planning commissions. Your assistance in this matter is appreciated.

Sincerely,

Jack H. Galbraith
Chief Planner

JHG:GLS:el

January 31, 1979

Ms. Wanda Squib
The Daily Reporter
201 South Baltimore
Derby, Kansas 67037

Re: SCZ-0416
✓CU-213 and
CU-214

Dear Ms. Squib:

Please publish the enclosed official notices one time in the Daily Reporter, at the earliest possible date.

I would appreciate a copy of the papers in which these notices appear.

Sincerely,

G. Lynn Shirkey
Junior Planner

GLS:el
Enclosures

CU 213

January 31, 1979

Robert I. Gale
Air Traffic Division
601 East 12th Street
Kansas City, Missouri 67106

Dear Mr. Gale:

Our office has received an application for a Conditional Use Permit under the "R" Rural Residential District of the County Zoning Regulations. The applicant, Cable T.V. Construction, Ltd., is proposing to construct a television tower 200 feet high, earth receiver station and head-end building on the following described property:

A tract in the S $\frac{1}{2}$ of the N.E. $\frac{1}{4}$ of Section 9, Twp. 27S, R1E of the 6th P.M., Sedgwick County, described as follows: beginning at a point 1210 ft. west and 280 feet south of the N.E. corner of said South $\frac{1}{2}$ of said N.E. $\frac{1}{4}$; thence South 280 feet, thence West 280 feet, thence North 280 feet, thence East to place of beginning.

This property lies in an area approximately 1/4 mile south and 1/4 mile west of the intersection of 79th Street South and Hydraulic and is outlined in red on the enclosed aerial photograph.

Consideration of this request is scheduled for the Derby City Planning Commission meeting of February 8, 1979, the Haysville City Planning Commission meeting of February 22, 1979, and the Metropolitan Area Planning Commission on March 1, 1979. We would appreciate your evaluation and comments as to the location of this proposed tower and what conflicts, if any, on air traffic in the area.

We would appreciate your comments at the earliest possible date so that they may be presented to the various planning commissions. Your assistance in this matter is appreciated.

Sincerely,

Jack H. Galbraith
Chief Planner

JHG:GLS:e1

APPLICATION FOR APPROVAL OF CONDITIONAL USE PERMIT
FOR PROPERTY LOCATED WITHIN THE JURISDICTION
OF THE BOARD OF COUNTY COMMISSIONERS OF
SEDGWICK COUNTY, KANSAS

20213

Bank 4
9-29-16
P. 5-A
N
E
S
W
R

This is an application for a Conditional Use Permit. The form must be completed and filed at the Planning Department, Tenth Floor, City Hall, 455 North Main Street, Wichita, Kansas, in accordance with directions on the accompanying instruction sheet. AN INCOMPLETE APPLICATION CANNOT BE ACCEPTED.

I. Name of applicant or applicants and/or their agent or agents. All owners of all property requested to be considered in this application must be listed in this item.

A. APPLICANT Cable T.V. Construction, Ltd.
ADDRESS 15 N. Highland, Chanute, KS 66720 PHONE 316-431-4160
AGENT John Mark Scully--Vice-president
ADDRESS same PHONE same

B. APPLICANT above
ADDRESS PHONE
AGENT
ADDRESS PHONE

C. APPLICANT above
ADDRESS PHONE
AGENT
ADDRESS PHONE

(Use separate sheet if necessary for names of additional applicants).

II. The applicant proposes to establish a 200' CATV tower and facilities (use)

on property legally described as Lot(s) _____
_____, Block(s) _____ of the _____

See description attached (Exhibit A) _____ Addition.
See plot description attached (Exhibit B)
(If appropriate, metes and bounds description may be provided in the space below or on an attached sheet).

I I I. THIS PROPERTY IS LOCATED AT (ADDRESS) 8321 S. Hydraulic - Sedwick
County

THE GENERAL LOCATION IS (USE APPROPRIATE SECTION)

A. AT THE _____ CORNER OF _____ AND _____

B. Generally located 1/4 mile ~~west~~ ^{OR south} and 1/4 mile west of the
ON THE West SIDE OF Hydraulic (AVENUE)
intersection of Hydraulic & 79th Street South
STREET BETWEEN 79th ~~and 80th~~ South (AVENUE) STREET AND
83rd South (AVENUE) STREET

I V. THE PROPERTY INCLUDED IN THIS APPLICATION IS ZONED "R"
(ZONING DISTRICT CLASSIFICATION).

V. I REQUEST THIS CONDITIONAL USE PERMIT FOR THE FOLLOWING REASONS:

To establish a 200' CATV tower, earth receive station, and 12' x 15'
head-end building to serve the towns of Derby and Haysville with cable
television.

V I. I (WE), THE APPLICANT(S), ACKNOWLEDGE RECEIPT OF THE INSTRU-
CTION SHEET EXPLAINING THE METHOD OF SUBMITTING THIS APPLICATION.
I (WE) REALIZE THAT THIS APPLICATION CANNOT BE PROCESSED UNLESS
IT IS COMPLETELY FILLED IN; IS ACCOMPANIED BY A CURRENT ABSTRACTOR
CERTIFICATE AS REQUIRED IN THE INSTRUCTION SHEET; AND IS ACCOMPANIED
BY THE APPROPRIATE FEE. I (WE) FURTHER CERTIFY THAT THE ABOVE AND
FOREGOING INFORMATION IS TRUE AND CORRECT TO THE BEST OF MY (OUR)
KNOWLEDGE. I (WE) ACKNOWLEDGE THAT THE BOARD OF COUNTY COMMISSIONERS
SHALL HAVE AUTHORITY TO IMPOSE SUCH CONDITIONS AS IT DEEMS NECESSARY
IN ORDER TO SERVE THE PUBLIC INTEREST AND WELFARE.

NOTE: AT LEAST ONE OWNER MUST SIGN THIS APPLICATION. OTHER
OWNERS MAY BE REPRESENTED BY AN AGENT OR AGENTS.

Batson Orchards Cable T.V. Construction, Ltd.
BY Robert F. Batson -Owner BY John M. Muelberg -Vice-president
AUTHORIZED AGENT (IF ANY) AUTHORIZED AGENT (IF ANY)

BY _____ BY _____
AUTHORIZED AGENT (IF ANY) AUTHORIZED AGENT (IF ANY)

BY _____ BY _____
AUTHORIZED AGENT (IF ANY) AUTHORIZED AGENT (IF ANY)

V I I. OFFICE USE ONLY

This application was received at the Planning Department at 3:15
(AM, PM) on January 26, 1979 (day, month, year). It has been checked
and found to be complete and accompanied by required documents and
the appropriate fee of \$ 70.00.

E. Lynn Shirley Nar
J. Planner Tit

EXHIBIT A

25
th
Ki
th
Se
Zi
Ne
Si
re
o:
R:
Fr

A tract in the $5\frac{1}{2}$ of the N.E. $\frac{1}{4}$
of Section 9, Twp. 29 S, R1E of
the 6th P.M., Sedgwick County,
described as follows: beginning
at a point 1210 ft. west and
280 feet south of ^{the N.E. corner of} said south $\frac{1}{2}$
of said NE $\frac{1}{4}$; thence south 280
feet, thence west 280 ft., thence
north 280 ft., thence east to
place of beginning.

Use for legal

ship
except
or
outh of
said
er
f of said
e of
of beginning
Company,
on in favor
ject to
478 of
ation

XCL
1211

The South Half of the Northeast Quarter of Section 9, Town 19 South, Range 1 East of the Sixth P.M., Sedgwick County, Kansas, except that part of the Southwest Quarter of the Northeast Quarter taken for Kansas Turnpike, and except a tract beginning at a point 230 feet South of the Northeast corner of the South Half of the Northeast Quarter of said Section 9; thence South along the East line of said Northeast Quarter 294 feet; thence West parallel with the North line of the South Half of said Northeast Quarter 362 feet; thence North parallel with the East line of said Northeast Quarter, 294 feet; thence East 362 feet to the place of beginning subject to Right-Of-Way Easement in favor of Kansas Gas and Electric Company, recorded in Book 36 of Misc. Page 27, also subject to Road Dedication in favor of Sedgwick County recorded in Book 380 of Misc., page 21; also subject to Right-Of-Way Easement in favor of Sedgwick County, recorded in Book 478 of Misc. page 551; this conveyance included all rights in the Appropriation For Beneficial Use of Water recorded in Book 453 of Misc. Page 560.

EXHIBIT B

HAYSVILLE TRUNK

79TH ST.

DERBY TRUNK

LULU

VICTORIA

HYDRAULIC

N

1,332'

81ST ST. 1,330'

PRIVATE ROAD

1,210'

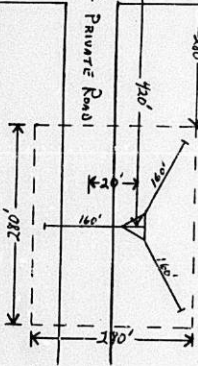

OWNERSHIP LIST

Lot	Addition	Property Owner
lot 1, Block 1	Kirby Gardens	Howard Dale Jones and Bonnie L. Jones 8055 South Santa Fe 67233
lot 2, Block 1	Same	Lillie H. Wohlford 8010 South Santa Fe 67233
lot 3, Block 1	Same	William J. Alexander and Mary K. Alexander 8018 South Santa Fe 67233
lot 4, Block 1	Same	William M. Powers and Pearl G. Powers 8028 South Santa Fe 67233
lot 5, Block 1	Same	Charles O. Roach and Maryann M. Roach 560 West Shore Drive 67209
lot 6, Block 1	Same	Bob D. Mullins and Ethel C. 8100 South Santa Fe 67233
lot 7, Block 1	Same	Vicki Sue Prins and Richard A. Burris 205 N. Westview Drive Derby, Kansas 67047
lots 8 and 9, Block 1	Same	Lloyd E. Shartzter and Barbara L. Shartzter 6404 South Hoover Road 67231
lot 10, Block 1	Same	Daniel J. Schulte 8140 South Santa Fe 67233
lot 11, Block 1	Same	Raymond R. Finch and Agnes L. Finch 845 N. Woodlawn Derby, Kansas 67047
lot 12, Block 1	Same	Ellis LaGree & Margie LaGree 8160 South Santa Fe 67233
lot 13, Block 1	Same	Truman Jennings and Linda L. Jennings 8163 South Mead 67233
lot 14, Block 1	Same	Ed Heckworth and Bonnie 8153 South Mead 67233
lot 15, Block 1	Same	Everett E. Gorgen & Helen M. 8141 South Mead 67233
lot 16, Block 1	Same	Judith R. Reedy Address Unknown

Lot	Addition	Property Owner
lot 17, Block 1	Kirby Gardens	Daniel Beeman and Marland L. Beeman 8018 South Mead 67233
lots 18 & 19, Block 1	Same	Robert D. Emerson and Ella M. Emerson 8101 South Mead 67233
lot 20, Block 1	Same	Dale C. Fletcher and Betty L. Fletcher 3941 N. Clarence 67233
lot 21, Block 1	Same	John H. Uglow and Reba 8027 South Mead 67233
lot 22, Block 1	Same	Raymond L. Davis 8017 South Mead 67233
lot 23, Block 1	Same	Virgil A. Thompson & Patsy Address Unknown
lot 24, Block 1	Same	Charles E. Houston Jr. and Jenny Louretta Wright Address Unknown
lot 1, Block 2	Same	Kenneth E. Briggs 9309 West 9th St. 67212
lot 2, Block 2	Same	John E. Collins and Margaret M. Collins 8010 South Mead 67233
lot 3, Block 2	Same	Daniel Beeman and Marilyn 8018 South Mead 67233
lot 4, Block 2	Same	Same
lot 5, Block 2	Same	M. E. Croney & Patricia 8034 South Mead 67233
lot 6, Block 2	Same	Ronald J. Miller & Linda 8044 S. Mead 67233
lot 7, Block 2	Same	Harold I. Power and Eunice 8116 South Mead 67233
lot 8, Block 2	Same	Harold I. Power and Eunice M. Power 8116 South Mead 67233
lot 9, Block 2	Same	Harold I. Power & Eunice 8116 South Mead 67233
lot 10, Block 2	Same	June Thompson Address Unknown
lot 11, Block 2	Same	Garry W. Horsley & Linda E. 8144 South Mead 67233

Lot	Addition	Property Owner
lot 12, Block 2	Kirby Gardens	Jack Adrian and Elsie Address Unknown
lot 13, Block 2	Same	George E. Totman and Marian D. Totman 8164 South Mead 67233

The South half of the NE $\frac{1}{4}$ of Section 9-29-1E except that part of the SW $\frac{1}{4}$ of the NE $\frac{1}{4}$ taken for Kansas Turnpike and except a tract beginning at a point 230 feet south of the NE corner of the south half of the NE $\frac{1}{4}$ of said Section 9; thence south along the east line of said NE $\frac{1}{4}$, 294 feet; thence west parallel with the north line of the south half of said NE $\frac{1}{4}$, 362 feet; thence north parallel with the east line of said NE $\frac{1}{4}$, 294 feet; thence east 362 feet to the place of beginning, subject to row easement to K.G. & E., misc. 36, page 27.

Robert F. Batson and
Nina D. Batson
8321 South Hydraulic
67233

The south half of the NW $\frac{1}{4}$ of Section 9-29-1E except a tract beginning at a point 350 feet North of the SW corner of the south half of the NW $\frac{1}{4}$ of said Section 9, thence 300 feet north, 450 feet east, 300 feet south and 450 feet west to place of beginning

Michael G. Hunter and
Judith H. Hunter
Lenora Schauner
Address Unknown

A tract of land in the south half of the NW $\frac{1}{4}$ of Section 9-29-1E, described as follows: Beg. at a point at the NE corner of SE $\frac{1}{4}$ of NW $\frac{1}{4}$, said Section 9, thence west 116.4 feet more or less to a point on the east row line of Kansas Turnpike, thence SEly 1117.3 feet more or less to a point on the east line of said SE $\frac{1}{4}$ of NW $\frac{1}{4}$ said Section 9, thence north 1111.2 feet more or less along said east line to point of beginning

Travis G. Sharp
8210 South Washington
67233

A tract of land in the NE $\frac{1}{4}$ of NW $\frac{1}{4}$ of Section 9-29-1E, described as: Beg. at a point at NE corner of NW $\frac{1}{4}$ Section 9, thence south 1322.06 feet more or less to Se corner NE $\frac{1}{4}$ NW $\frac{1}{4}$ Section 9, thence west 116.4 feet to a point on east row line of the Kansas Turnpike, thence northerly along said east row line 1323.03 feet more or less to a point on north line of NE $\frac{1}{4}$ NW $\frac{1}{4}$ said Section 9, thence east 139.37 feet to point of beginning

Travis G. Sharp
8210 South Washington
67233

The North 1336.0 feet of the east half of the SW $\frac{1}{4}$ of Section 9-29-1E, lying west of the westerly row of the Kansas Turnpike

Kenneth Batzelle and
Charlotte Batzelle
8554 South St. Francis
67233

Tract

Property Owner

The SE $\frac{1}{4}$ of Section 9-29-1E, except the south 1456 feet thereof, and except the south 255 feet of the north 435 feet of the east 890 feet thereof and except the north 90 feet of the east 220 feet thereof, and except that part taken for the Kansas Turnpike row

✓ Howard D. Mahoney
Barbara Jean Mahoney
8429 South Hydraulic
67233

The south 255 feet of the north 435 feet of the east 890 feet of the SE $\frac{1}{4}$ of Section 9-29-1E subject to road easement on east 30 feet

✓ Howard D. Mahoney and
Barbara Jean Mahoney
8429 South Hydraulic 67233

The west one-half of the SW $\frac{1}{4}$ and the NE $\frac{1}{4}$ of the SW $\frac{1}{4}$ of Section 10-29-1E, except the West 440 feet of the North 198 feet of the SW $\frac{1}{4}$ of the SW $\frac{1}{4}$ and except the South 511.1 feet of the west 460 feet of the NW $\frac{1}{4}$ of the SW $\frac{1}{4}$

✓ Martin M. Meyer and
Frances M. Meyer
5335 South Hydraulic
67216

The West half of the NW $\frac{1}{4}$ of Section 10-29-1E

~~Butts Farms Inc.~~
Rt. 2, Mulvane, Kansas
67110

Beginning 230 feet South of the NE corner of the south half of the NE $\frac{1}{4}$ of Section 9-29-1E, thence South 294 feet, West 362 feet, North 294 feet, East 362 feet to beginning

✓ Robert F. Batson and
Nina D. Batson
8321 South Hydraulic
67233

The South 133 feet of the North 893 feet of the East 332.5 feet of the West 997.5 feet of the NE $\frac{1}{4}$ of Section 9-29-1E, subject to road easement on the West 30 feet thereof.

✓ J. Melvin Martindale and
Winifred Martindale
8112 Laura
67233

The south 133 feet of the north 627 feet of the NE $\frac{1}{4}$ of the NE $\frac{1}{4}$ of Section 9-29-1E except the East 997.5 feet and except west 30 feet for road

✓ H. E. Fullerton and
Phyllis Ann Fullerton
8052 Lulu 67233

The NW $\frac{1}{4}$ of the NE $\frac{1}{4}$ of Section 9-29-1E except the North 1159 feet and except the west 997.5 feet and also except 30 feet off south and east side for street

✓ Lorenia Reed and
Joe B. Reed
Rt. 1, Rose Hill, Kansas
67233

The south 66 $\frac{1}{2}$ feet of the North 760 feet of the East 332.5 feet of the West 665 feet of the NE $\frac{1}{4}$ of Section 9-29-1E, subject to road easement on the East 30 feet thereof.

✓ Johnny F. Conger and
Esther D. Conger
8107 Laura 67233

The North 66.5 feet of the South 133 feet of the North 760 feet of the East 332.5 feet of the West 665 feet of the NE $\frac{1}{4}$ of Section 9-29-1E, subject to road easement on East 30 feet

✓ Billie Gean Woods and
Ruth Beatrice Woods
8101 Laura 67233

The South 266 feet of the North 494 feet of the East half of the NE $\frac{1}{4}$ of Section 9-29-1E except the East 997.5 feet, subject to road easement on west 30 feet

✓ Paul Knabe and Izora Knabe
8040 Lulu 67233

✓ Present: Lorenia Reed: 1913 N. Chautauque, 67233

Tract

Property Owner

The south 133 feet of the North 1026 feet of the East 332.5 feet of the West 997.5 feet of the NE $\frac{1}{4}$ of Section 9-29-1E

X Luella Kay Martindale
- Address Unknown *nonfound*

The West 332.5 feet of the north half of the NE $\frac{1}{4}$ of Section 9-29-1E except the west 30 feet and except the south 30 feet and except the north 1159 feet

✓ Bennie David Dunnavent and
Gracie Belle Dunnavent
8150 South Washington
67233

The South 133 feet of the North 1159 feet of the West 332.5 feet of the NE $\frac{1}{4}$ of Section 9, Twp 29S, R1E, subject to road easement on West 30 feet thereof

✓ Darrell A. Kleinsorge
Phillis J. Kleinsorge
8140 South Washington
67233

The South 133 feet of the North 1026 feet of the West 332.5 feet of the East 997.5 feet of the NE $\frac{1}{4}$ of Section 9-29-1E subject to road easement on East 30 feet

✓ Harold W. Happy and Mary E.
8125 Victoria 67233

The East 332.5 feet of the West 665 feet of the north half of the NE $\frac{1}{4}$ of Section 9-29-1E except the North 1159 feet, subject to road easement on the East 30 feet and the South 30 feet

✓ Alvin C. Stevens and
Rita Mae Stevens
8151 Laura 67233

The south 133 feet of the north 760 feet of the west half of the NE $\frac{1}{4}$ of Section 9-29-1E except the West 997.5 feet and subject to a road easement on the east 30 feet

✓ Rheta Maxine Sumpter
Raymond E. Sumpter
Carolyn S. Duhon
8101 Lulu 67233

The South 133 feet of the North 893 feet of the East 332.5 feet of the West 665 feet of the NE $\frac{1}{4}$ of Section 9-29-1E subject to road on east 30 ft

✓ Virgil M. Finck and
Alberta L. Finck
8111 Laura 67233

The South 133 feet of the North 1026 feet of the west half of the NE $\frac{1}{4}$ of Section 9-29-1E except the West 997.5 feet, subject to road easement on the East 30 feet

✓ Henry W. Bergen and
Delores J. Bergen
Rt. 5, Newton, Kansas

The east 151.25 feet of the west 332.5 feet of the east 665 feet of the north half of the NE $\frac{1}{4}$ of Section 9-29-1E, except the north 1159 feet thereof

✓ Donald W. Bedell and
Freida M. Bedell
1626 East 81st St. South
67233

The West 181.25 feet of the East 665 feet of the North half of the NE $\frac{1}{4}$ of Section 9-29-1E except the North 1159 feet and except the West 30 feet and South 30 feet for road

✓ Norman Ray Kimrey and
Patricia A. Kimrey
8152 Victoria 67233

The South 133 feet of the North 494 feet of the East 332.5 feet of the West 997.5 feet of the NW $\frac{1}{4}$ of the NE $\frac{1}{4}$ of Section 9-29-1E, subject to road on West 30 feet

✓ Wilbur M. Gifford and
Emma M. Gifford
8040 Laura 67233

Tract

Property Owner

The South 133 feet of the North 361 feet of the west half of the NE $\frac{1}{4}$ of Section 9-29-1E except the West 997.5 feet, subject to road on East 30 feet

~~Raymond W. Fields and Verna P. Fields~~
8027 Lulu 67233

The South 133 feet of the North 760 feet of the West 332.5 feet of the East 997.5 feet of the NE $\frac{1}{4}$ of Section 9-29-1E, subject to road easement on the East 30 feet ✓

Jimmy R. Gass and Susan M.
8101 Victoria 67233

The South 133 feet of the North 1026 feet of the West 332.5 feet of the East 665 feet of the NE $\frac{1}{4}$ of Section 9-29-1E, subject to road easement on the West 30 feet thereof ✓

Harve Hamilton & Betty
8126 South Victoria 67233

The South 133 feet of the North 1159 feet of the East 332.5 feet of the West 997.5 feet of the NE $\frac{1}{4}$ of Section 9-29-1E, subject to road on the West 30 feet ✓

Floyd E. Carter and Zettie O. Carter
8140 Laura 67233

The West 302.5 feet of the East 997.5 feet of the South 133 feet of the North 361 feet of the NE $\frac{1}{4}$ of the NE $\frac{1}{4}$ of Section 9-29-1E

~~William M. Ehart~~
8025 Victoria 67233

The East 332.5 feet of the NE $\frac{1}{4}$ of the NE $\frac{1}{4}$ of Section 9-29-1E except the North 1159 feet, subject to road easement on the East 40 feet and South 30 feet ✓

Bob J. Templin and Nancy A. Templin
8151 South Hydraulic 67233

The South 133 feet of the North 361 feet of the West 332.5 feet of the East 665 feet of the NE $\frac{1}{4}$ of Section 9-29-1E, subject to road easement on the West 30 feet ✓

~~F. B. David & Martha L.~~
2122 South Wichita 67213

The South 133 feet of the North 627 feet of the West 332.5 feet of the NE $\frac{1}{4}$ of Section 9-29-1E, subject to road on the west 30 feet ✓

Hugh P. Murphy and Kathryn I. Murphy
8052 South Washington 67233

The South 133 feet of the North 760 feet of the East 302.5 feet of the West 997.5 feet of the NE $\frac{1}{4}$ of Section 9-29-1E, subject to road easement on the west 30 feet

Floyd A. Dean and Lila W.
8100 Laura 67233

The South 133 feet of the north 627 feet of the East 302.5 feet of the West 997.5 feet of the NE $\frac{1}{4}$ of Section 9-29-1E, subject to road on West 30 feet

~~Carroll D. Ghan and Ellen I.~~
8052 Laura 67233

The South 133 feet of the North 1026 feet of the West 332.5 feet of the NE $\frac{1}{4}$ of Section 9-29-1E, subject to road easement on the West 30 feet ✓

Eldon C. Butler and Claudette Butler 832 IRVING ST.
-Address Unknown 67213

The South 133 feet of the North 760 feet of the East half of the NE $\frac{1}{4}$ of Section 9-29-1E except the East 997.5 feet, subject to road easement on the West 30 feet X

Gerald D. Hood & Marion J.
-Address Unknown
none found

Tract

Property Owner

The South 133 feet of the North 1159 feet of the East 332.5 feet of the West 665 feet of the NE $\frac{1}{4}$ of Section 9-29-1E except the east 30 feet for road ✓

Larry D. Stewart and Sharon M. Stewart
8129 Laura 67233

The South 133 feet of the North 893 feet of the West half of the NE $\frac{1}{4}$ of Section 9-29-1E except the West 997.5 feet thereof, subject to road easement on the East 30 feet thereof ✓

Bonnie Wigginton and Vivian M. Shaw
8111 South Lulu 67233

The South 133 feet of the North 760 feet of the West 332.5 feet of the NE $\frac{1}{4}$ of Section 9-29-1E

~~C. L. Bailey~~
8100 South Washington
67233

The South 133 feet of the North 893 feet of the West 332.5 feet of the East 997.5 feet of Section 9-29-1E, subject to road easement on the East 30 feet D

Kenneth E. Gifford
8111 Victoria 67233

The South 133 feet of the North 494 feet of the West 332.5 feet of the NE $\frac{1}{4}$ of Section 9-29-1E, subject to road easement on the East 30 feet

~~Hugh Murphy and Kathryn I.~~
8052 South Washington
67233

The South half of the South 133 feet of the North 627 feet of the West 332.5 feet of the East 665 feet of the NE $\frac{1}{4}$ of Section 9-29-1E subject to the road row on the West 30 feet

~~Gail J. Kreutzer and Janet V. Kreutzer~~
8056 Victoria 67233

The South 133 feet of the North 627 feet of the West 332.5 feet of the East 665 feet of the NE $\frac{1}{4}$ of Section 9-29-1E, except the South half thereof

~~George L. McIntire and Arzella Z. McIntire~~
8048 Victoria 67233

The South 133 feet of the North 1159 feet of the West 332.5 feet of the East 997.5 feet of the NE $\frac{1}{4}$ of Section 9-29-1E, subject to road easement on the East 30 feet X

Lyndal L. Reed and Velma L. Reed ✓
~~Address Unknown~~ *nonfound*

The South 133 feet of the North 760 feet of the West 332.5 feet of the East 665 feet of the NE $\frac{1}{4}$ of Section 9-29-1E, subject to road easement on the West 30 feet

~~Travis C. Thomas and Barbara J. Thomas~~
8100 Victoria 67233

The South 133 feet of the North 893 feet of the East Half of the NE $\frac{1}{4}$ except the East 997.5 feet, in Section 9-29-1E ✓

Meredith R. Barney and Mary Jo Barney
8112 Lulu 67233

The South 133 feet of the North 1026 feet of the east half of the NE $\frac{1}{4}$ of Section 9-29-1E, except the east 997.5 feet thereof and subject to road easement on the west 30 feet thereof ✓

Harvey R. Graber and Mary R. Graber
8134 Lulu 67233

Tract

Property Owner

The NE $\frac{1}{4}$ of the NE $\frac{1}{4}$ of Section 9-29-1E except the East 1149 feet thereof and except the North 1159 feet thereof, subject to road easement on the south 30 feet and the west 30 feet thereof ✓

Phyllis J. Foster
8152 Lulu 67233

The South 133 feet of the West 332.5 feet of the East 665 feet of the North 494 feet of the NE $\frac{1}{4}$ of Section 9-29-1E except the west 30 feet for road

~~Carl D. Gifford and
Verna J. Gifford~~
8040 Victoria 67233

The South 133 feet of the North 627 feet of the East 332.5 feet of the NE $\frac{1}{4}$ of Section 9-29-1E, subject to 40 foot road easement on East

~~Kenneth Daniels and
Maxine Daniels~~
8051 South Hydraulic
67233

The South 133 feet of the North 893 feet of the West 332.5 feet of the NE $\frac{1}{4}$ of Section 9-29-1E, except the West 30 feet

~~Bob Oliphant and Lova J.~~
Address Unknown

The South 133 feet of the North 893 feet of the West 332.5 feet of the East 665 feet of the NE $\frac{1}{4}$ of the NE $\frac{1}{4}$ of Section 9-29-1E, subject to road easement on the West 30 feet thereof ✓

Kenneth E. Gifford and
Barbara J. Gifford
8111 Victoria Street 67233

The South 133 feet of the North 361 feet of the East 332.5 feet of the West 997.5 feet of the NE $\frac{1}{4}$ of Section 9-29-1E, subject to road easement on the West 30 feet

~~Robert E. Elsworth and
Joan D. Elsworth~~
8036 Laura 67233

The North 133 feet of the South 266 feet of the North 627 feet of the West 332.5 feet of the East 997.5 feet of the NE $\frac{1}{4}$ of Section 9-29-1E, subject to public road on the East 30 feet thereof

~~Jack Galloway and
Mary L. Galloway~~
8045 Victoria 67233

The South 133 feet of the South 266 feet of the North 627 feet of the West 332.5 feet of the East 997.5 feet of the NE $\frac{1}{4}$ of Section 9-29-1E, subject to road easement on the East 30 feet thereof.

~~Melvin L. Moore and
Norma L. Moore~~
8055 Victoria 67233

The South 266 feet of the North 626 feet of the West Half of the NE $\frac{1}{4}$ of Section 9-29-1E, except the West 997.5 feet, subject to road easement on East 30 feet ✓

L. J. Shoffner Sr. and
Elizabeth E. Shoffner
8051 South Lulu 67233

The South 133 feet of the North 361 feet of the West 332.5 feet of the NE $\frac{1}{4}$ of Section 9-29-1E, subject to road easement on West 30 ft

~~Isadore Ontiveros and
Alice Ontiveros~~
Address Unknown

The South 133 feet of the North 1159 feet of the West 332.5 feet of the East 665 feet of the NE $\frac{1}{4}$ of Section 9-29-1E, subject to road easement on West 30 feet ✓

Edward Henry Bosley and
Trixie Bosley
1758 South Vine 67213

Tract

Property Owner

The East 332.5 feet of the West 997.5 feet of the NW $\frac{1}{4}$ of the NE $\frac{1}{4}$ of Section 9-29-1E, except the North 1159 feet subject to road easement on west 30 feet and South 30 feet

✓ Harold G. Taylor and Myrtle A. Taylor
1330 East 81st St. South
67233

The South 133 feet of the North 760 feet of the East 332.5 feet of the NE $\frac{1}{4}$ of Section 9-29-1E

~~William J. Scott and Valeta D. Scott~~
8101 South Hydraulic 67233

The South 133 feet of the North 1159 feet of the East 332.5 feet of the NE $\frac{1}{4}$ of Section 9-29-1E, subject to road easement on the East 40 feet

✓ Ray Landreth
8139 South Hydraulic
67233

The South 133 feet of the North 1026 feet of the East 332.5 feet of the NE $\frac{1}{4}$ of Section 9-29-1E, subject to road easement on the East 40 feet

~~Ray Landreth~~
8139 South Hydraulic
67233

The South 133 feet of the North 893 feet of the East 332.5 feet of the NE $\frac{1}{4}$ of Section 9-29-1E, subject to road easement on the East 40 feet

~~Bob G. Shepherd and Betty J. Shepherd~~
8111 South Hydraulic 67233

The West 332.5 feet of the East 997.5 feet of the North half of the NE $\frac{1}{4}$ of Section 9-29-1E, except the North 1159 feet thereof and except the West 151.25 feet thereof

✓ Carol R. Jones
8151 Victoria 67233

The West 151.25 feet of the East 997.5 feet of the North half of the NE $\frac{1}{4}$ of Section 9-29-1E, except the North 1159 feet and subject to road easement on the South 30 ft.

Kenneth E. Standley and Ina Mae Standley
8025 South Hydraulic
67233
1408 E. Flat Smith.

The South 133 feet of the North 494 feet of the East 332.5 feet of the NE $\frac{1}{4}$ of Section 9-29-1E, subject to road easement on the East 40 feet thereof

✓ Kenneth Morgan Wait and Rosella Louise Wait
8025 South Hydraulic
67233

The East 332.5 feet of the West 665 feet of the North 627 feet of the NE $\frac{1}{4}$ of Section 9-29-1E, subject to road easement on the North 40 feet and the East 30 feet

~~Floyd E. Farha, deceased~~
Naomi Farha
157 South Edgemoor 67218

The North 361 feet of the East 332.5 feet of the NE $\frac{1}{4}$ of Section 9-29-1E, subject to road easement on the North 40 feet thereof and subject to road easement on the East 40 feet thereof

~~Kenneth Morgan Wait~~
8025 South Hydraulic
67233

The South 133 feet of the North 1159 feet of the East half of the NE $\frac{1}{4}$ of Section 9-29-1E except the East 997.5 feet, subject to road easement on the West 30 feet

✓ John W. Curley and Ethel L.
8140 Lulu 67233

We hereby certify the foregoing to be a true and correct list of the property owners of:

A 1000 foot radius of: The South Half of the NE $\frac{1}{4}$ of Section 9-29-1E, except that part of the SW $\frac{1}{4}$ of the NE $\frac{1}{4}$ taken for Kansas Turnpike and except a tract beginning at a point 230 feet South of the NE corner of the South Half of the NE $\frac{1}{4}$ of said Section 9; thence South along the East line of said NE $\frac{1}{4}$, 294 feet; thence West parallel with the North line of the South Half of said NE $\frac{1}{4}$, 362 feet; thence North parallel with the East line of said NE $\frac{1}{4}$, 294 feet; thence East 362 feet to the place of beginning

as shown by the last deeds of record on file in the Office of the Register of Deeds of Sedgwick County, Kansas, on the 19th day of January, 1979 at 7:00 o'clock A.M.

THE SECURITY ABSTRACT & TITLE CO., INC.

By

Mary Gable

Vice President

Order No. 273095

wh

REFERRAL FROM WICHITA-SEDGWICK COUNTY METROPOLITAN AREA PLANNING COMMISSION
TO HAYSVILLE CITY PLANNING COMMISSION.

CASE No. CU-213 To BE HEARD BY THE M. A. P. C. ON 3-29-79

REQUEST FOR approval of Conditional Use Permit

REASON FOR REQUEST (AS PROVIDED BY PETITIONER):

"To establish a 200 foot CATV tower, earth receiver station,
and 12' x 15' head-end building to serve the towns of Derby
and Haysville with cable television."

LOCATION OF PROPERTY: West side of Hydraulic, 1/2 mile south of
79th Street South.

LEGAL DESCRIPTION OF PROPERTY:

A tract in the S $\frac{1}{2}$ of the N.E. $\frac{1}{4}$ of Section 9, Twp. 29S, R1E of the
6th P.M., Sedgwick County, described as follows: Beginning at S.E.
corner of the N.E. $\frac{1}{4}$ of the aforesaid section; thence West 208.71 feet,
thence North 208.71 feet; thence South 208.71 feet; thence East 208.71
feet to the point of beginning.

APPLICANT: Cable T.V. Construction, Ltd., et al
ADDRESS: 15 N. Highland, Chanute, Ks.

AGENT FOR APPLICANT: John Mark Scully, Vice-President.
SURROUNDING LAND USE:

- North - Orchard
- East - Orchard
- South - Single Family
- West - Orchard

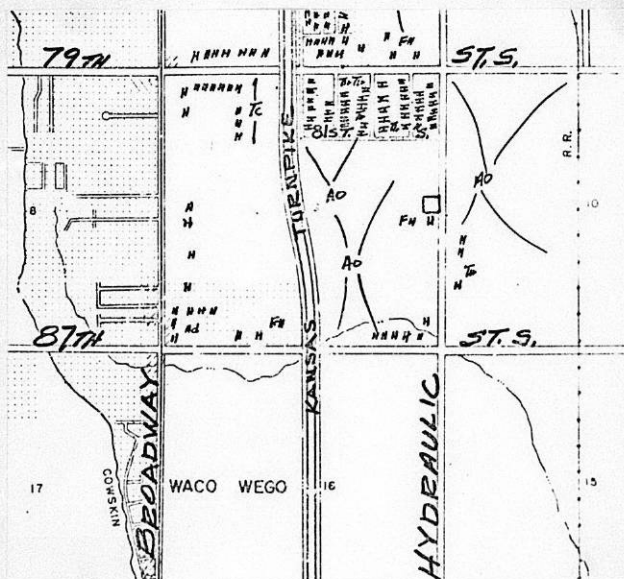

RECOMMENDATION OR COMMENTS BY H. C. P. C. :

IMPORTANT MESSAGE

FOR Jack
 DATE 2-8-79 TIME 2:23 A.M.
 P.M.

WHILE YOU WERE AWAY
Captain DeFuria
 OF McCormell
 PHONE No. 681-5781

TELEPHONED	PLEASE CALL	<input checked="" type="checkbox"/>
CALLED TO SEE YOU	WILL CALL AGAIN	
WANTS TO SEE YOU	RETURNED YOUR CALL	

MESSAGE _____

SIGNED [Signature]

FORM 000-017

IMPORTANT MESSAGE

FOR Jack
 DATE 2-9-79 TIME 9:10 A.M.
 P.M.

WHILE YOU WERE AWAY
Shackton
 OF McCormell AFB
 PHONE No. 681-6771
4320

TELEPHONED	PLEASE CALL	<input checked="" type="checkbox"/>
CALLED TO SEE YOU	WILL CALL AGAIN	
WANTS TO SEE YOU	RETURNED YOUR CALL	

MESSAGE _____

SIGNED [Signature]

FORM 000-017

IMPORTANT MESSAGE

FOR Jack
 DATE 2-9-79 TIME 10:30 A.M.
 P.M.

WHILE YOU WERE AWAY
Benny Kerk
 OF F.A.A. Kansas City
 PHONE No. _____

TELEPHONED	PLEASE CALL	
CALLED TO SEE YOU	WILL CALL AGAIN	
WANTS TO SEE YOU	RETURNED YOUR CALL	

MESSAGE Re: Proposed 200' TV Cable Case; it was a problem to McCormell Air Force Base. However, the proponent has agreed to lower it to 176' and the council is satisfied.

SIGNED [Signature]

FORM 000-017

IMPORTANT MESSAGE

FOR Jack
 DATE 2-9-79 TIME 10:48 A.M.
 P.M.

WHILE YOU WERE AWAY
John Bully
 OF Chanute
 PHONE No. (316) 431-4160

TELEPHONED	PLEASE CALL	<input checked="" type="checkbox"/>
CALLED TO SEE YOU	WILL CALL AGAIN	
WANTS TO SEE YOU	RETURNED YOUR CALL	

MESSAGE Re: CU 213

SIGNED [Signature]

FORM 000-017

DERBY CITY PLANNING COMMISSION

FEBRUARY 8, 1979 7:00 P.M.

A G E N D A



Gov. Fair has resigned
Mrs. Mary Ann Maggs

CALL: BILL BURRESS
TATE BUTLER
RON FANGMANN
LILLIAN GARDNER
JOHN LAUBER, JR.
L.O. PAYNE
DOLAN PELLEY
LARRY SIMS, CHAIRMAN
BILL SMITH

HEARING: CU 213, CONDITIONAL USE PERMIT
200' CABLE TV TOWER & RELATED FACILITIES
ZONING: "R" RURAL RESIDENTIAL
LOCATION: 1/4 MILE SOUTH & 1/4 MILE WEST
OF INTERSECTION OF HYDRAULIC & 79TH. ST. SO.
APPLICANT: CABLE TV CONSTRUCTION LIMITED

CU 213 CONSIDERATION & DECISION

HEARING: CU 214, CONDITIONAL USE PERMIT
SAND PIT EXTRACTION OPERATION
EAST SIDE OF HYDRAULIC, 1/4 MILE NORTH OF
79TH. ST. SO.
APPLICANT: FAIRFIELD POLO ASSOC.

SCZ 0416, REQUEST FOR REZONE
FROM "R" RURAL RESIDENTIAL TO "E" LIGHT INDUSTRIAL
EAST SIDE OF HYDRAULIC, 1/4 MILE NORTH OF
79TH. ST. SO.
APPLICANT: FAIRFIELD POLO ASSOC.

CU 214 CONSIDERATION & DECISION
SCZ 0416 CONSIDERATION & DECISION

BUSINESS: MINUTES, JANUARY 18, 1979

REQUEST FOR REPLAT
DERBY HILLS EAST, TRACT B
DON HARTER

FINAL PLAT
G & C NICKELL ADDITION

COMMITTEE REPORTS

CITY COUNCIL REPORT, FEB. 6, 1979

MISC. MATTERS

ADJOURNMENT

FORM 29

PAYMENT NOTICE
City of Wichita

Bldg.	Use of Str.	Code Bks	Copies
Elec	Elev. Insp.	Has Moving	Lic.
Mech	Boiler Insp.	Pav. Cuts	Cert.
Plbg	Exam Fees	Sewer	Elev.
Signs	Plan Rev. (P.W.)	Cement	M.S.P.
<u>Planning</u>			

DESCRIPTION	AMOUNT
<i>Additional fees</i>	<i>7.00</i>

NAME *TV Construction Ltd.*

ADDRESS *255 S. Hill St. Wichita, Kan.*

FUND *755-411-71-00* DUE DATE *1/26/77*

COMMENTS

DATE *1/26/77* BY *[Signature]*

00213

WICHITA - SEDGWICK COUNTY
W.S.C.

METROPOLITAN AREA PLANNING
 DEPARTMENT
 CITY HALL - TENTH FLOOR
 453 NORTH MAIN STREET
 WICHITA, KANSAS 67202

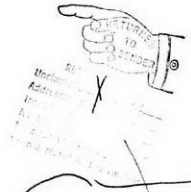

Eddie



LORENIA & JOE B. REED
 RT. 1
 ROSE HILL, KS. 67133

Wagon Field

Ready present 2-9-77 to: Lorenia 1913 N. Chautauqua 67214 per phone book

Important! Notice of Meeting Enclosed