

D-0131 - Dedication from Clarence W. & Mary Dorothy Rucas for additional R/W on NS Haskell beg. 132' E of CL of Elizabeth E 66'

POSTED
7-6-59

964

ACTION

		DATE
COMMITTEE	<u>Accept</u>	<u>2-30</u>
M.A.P.C.	<u>"</u>	<u>8/6</u>
B.C.C. / B.C.C.	<u>"</u>	<u>8/18</u>

VACATION OR DEDICATION
CHECK LIST

CASE NO. D-0131 RECEIVED 7-1-59 BY B

S/D ACTION 7-30-59 App MAP NO. H-3

MAPC ACTION 8-6-59 App

BCC ACTION _____

ORDINANCE NO. _____ CONSIDERED BY BCC _____ PUBLISHED _____

Case Number D-0131 Map Number H-3 Change requested _____

Meeting Date 7-30-59 Date Pictures taken _____ Planner _____

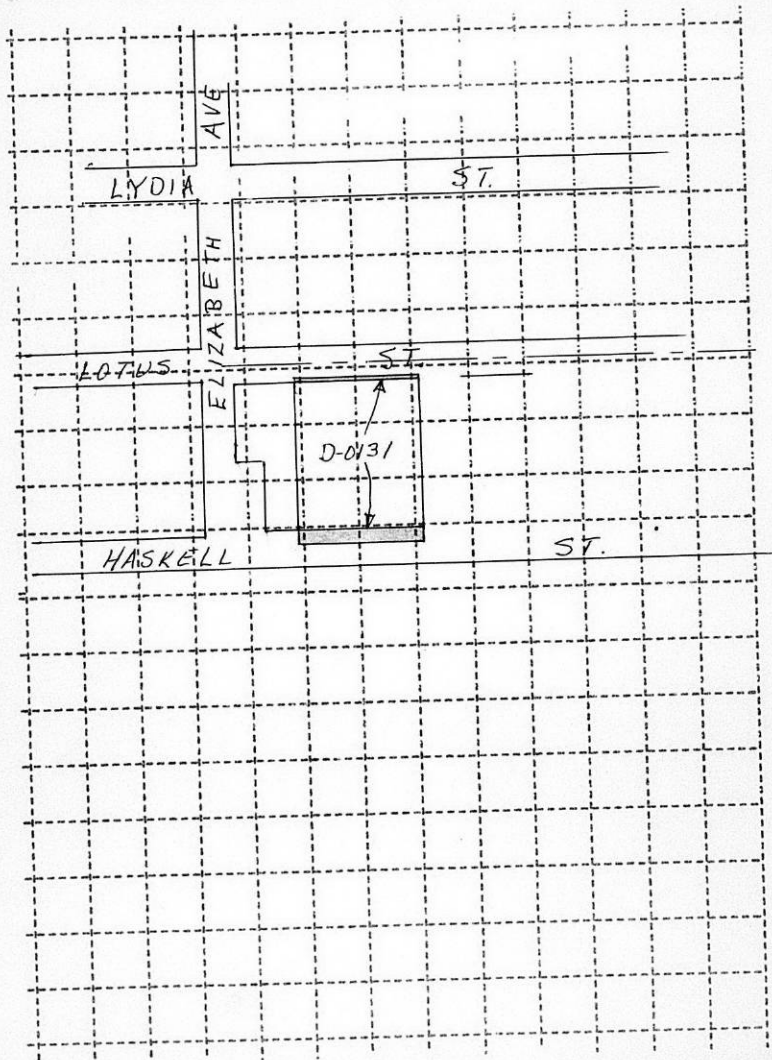

Recd
8-18-59

August 12, 1959

Board of City Commissioners
City Building
Wichita, Kansas

Gentlemen:

Re: D-0131, D-0133, and D-0134,
Dedications for portion of
Haskell Street in the area
between Elizabeth and Seneca

At the regular meeting of the Metropolitan Area Planning Commission held on August 6, 1959, the above dedications were considered. These dedications are more specifically described as follows:

D-0131 - Dedication from Mary Dorothy and Clarence W. Rucas for the north 10 feet of the south 30 feet of the west 66 feet of a tract beginning 40 rods north and 58 rods west of the southeast corner of the SE $\frac{1}{4}$ of Section 31, Township 27 South, Range 1 East, thence west 14 rods; thence north 20 rods; thence east 14 rods; thence south 20 rods to beginning;

D-0133 - Dedication from Richard L. and Nora Geraldine Satterfield for north 10 feet of the south 30 feet of the west 132 feet of a tract beginning 600 feet north and 561 feet west of the southeast corner of the SE $\frac{1}{4}$ of Section 31, Township 27 South, Range 1 East, thence north 330 feet, thence west 300 feet, thence south 330 feet, thence east to point of beginning, except the north 170 feet;

D-0134 - Dedication from Ellis and Naomi Ladine Hawkins for the south 10 feet of a tract beginning 680 feet north and 50 feet west of the southeast corner of the SE $\frac{1}{4}$ of Section 31, Township 27 South, Range 1 East, thence north 102 feet; thence west 379 feet, thence south 102 feet, thence east to beginning.

It was moved, seconded and carried unanimously that the Planning Commission recommend to the Board of City Commissioners that the above dedications be approved.

Respectfully submitted,

L. L. Little
Director of Planning

LLL:LRE:ber