

D-0147 -Dedication from Lester  
Matlock for right-of-way for Young  
from Central north to NL of Elm

INFO RECEIVED  
1-24-62  
72

VACATION OR DEDICATION  
CHECK LIST

CASE NO. D-0147 RECEIVED Aug. 17 BY DW

S/D ACTION September 10 MAP NO. E-1

MAFC ACTION \_\_\_\_\_

BCC ACTION \_\_\_\_\_

ORDINANCE NO. \_\_\_\_\_ CONSIDERED BY BCC \_\_\_\_\_ PUBLISHED \_\_\_\_\_

Case Number D-0147 Map Number E-1 Change requested \_\_\_\_\_ to \_\_\_\_\_  
S/D Meeting Date 9-10-59 Date pictures taken \_\_\_\_\_ Planner \_\_\_\_\_

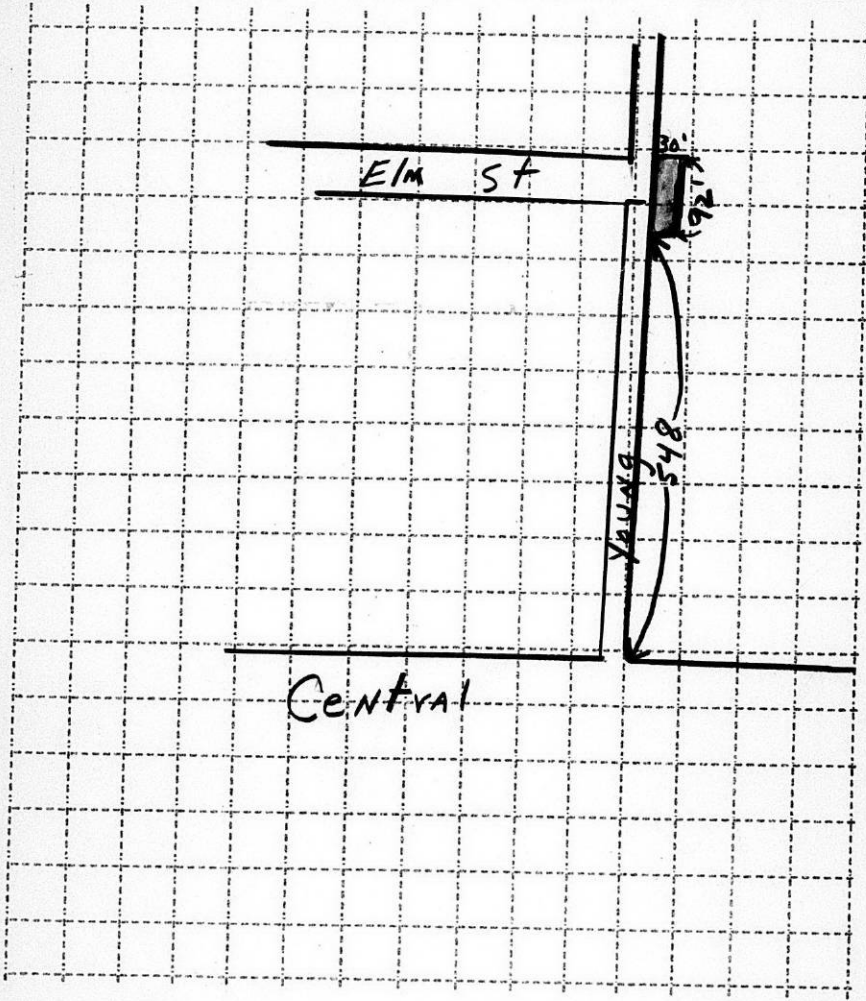

CC  
APP  
10-6-59

September 30, 1959

Board of City Commissioners  
City Building  
Wichita, Kansas

Gentlemen:

Re: D-0147 - Dedication for  
portion of Young Street in  
an area north of Central

At the regular meeting of the Metropolitan Area Planning Commission held on September 17, 1959, the above dedication was considered. This dedication is legally described as the west 30 feet of the south 92.44 feet of Lot 2, Dougherty Place Addition and the west 30 feet of Lot 1, Dougherty Place Addition.

The following action was taken:

It was moved, seconded and carried unanimously that the Planning Commission recommend to the Board of City Commissioners that this dedication be approved.

Respectfully submitted,

L. L. Little  
Director of Planning

LLL:LRE:ber  
Attachment