

D-0170 - RUTH SPINNER STONE OFFERS
DEDICATION OF S $\frac{1}{2}$ OF 15TH, MCCOMAS
TO WESTRIDGE

*Posted
5-10-60*

ACTION

	DATE
SIDCOMMITTEE	<u>5-27-60</u>
M.A.P.C.	<u>6-16-60</u>
B.C.C. BOARD	<u>6-28-60</u>

Closed

DEDICATION REPORT AND PROGRESS

CASE No. D - 0170

MAP No. D-2
 SEC. No. 12
 TWP. No. 27
 RANGE 1-W

I. OFFER TO DEDICATE: THE SOUTH 1/2 OF 15TH. STREET.
 GENERALLY LOCATED: 15TH. STREET BETWEEN MCCOMAS AND WESTRIDGE.

LEGALLY DESCRIBED AS:

THE SOUTH 1/2 OF 15TH. STREET FROM THE EAST RIGHT-OF-WAY LINE OF MCCOMAS AVE. TO THE CENTERLINE OF WESTRIDGE, WHICH IS THE N. 30' OF THE E. 665' OF THE N. 7 ACRES OF THE SW 1/4 OF SEC. 12, TWP. 27S, RANGE 1-W.

DEDICATED BY: RUTH SPOONER STONE
 AGENT: _____
 ADDRESS: _____ PHONE _____
 PURPOSE OF DEDICATION:

TO COMPLETE THE DEDICATION OF 15TH. STREET BETWEEN WEST STREET AND SHERIDAN AVE,

II. SKETCH.

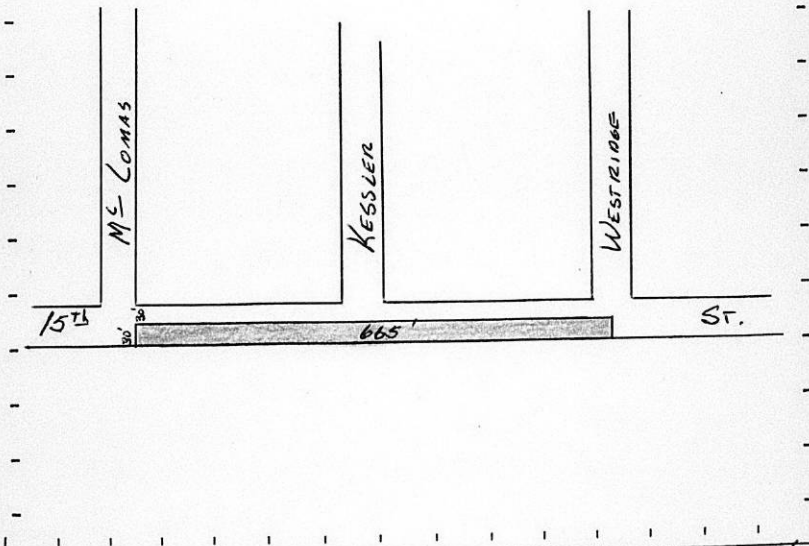

III. OFFER RECEIVED 5-6-60 *B.C.C. ACTION 6-28-60 Accept.
 POSTED TO ATLAS 5-10-60
 *S/D COMM. ACTION 5-26-60 Accept PLACED ON RECORD _____
 *M.A.P.C. ACTION 6-16-60 Accept CITY CLERKS No. _____

JUNE 21, 1960

BOARD OF CITY COMMISSIONERS
CITY BUILDING
WICHITA, KANSAS

GENTLEMEN:

RE: D-0170 - DEDICATION FOR
S $\frac{1}{2}$ OF 15TH STREET BETWEEN
MCCOMAS AND WEBTRIDGE

AT THE REGULAR MEETING OF THE METROPOLITAN AREA PLANNING
COMMISSION HELD ON JUNE 16, 1960 THE ABOVE DEDICATION WAS
CONSIDERED. THIS DEDICATION IS LEGALLY DESCRIBED AS THE
NORTH 30 FEET OF THE EAST 665 FEET OF THE NORTH 7 ACRES
OF THE SOUTHWEST QUARTER OF SECTION 12, TOWNSHIP 27
SOUTH, RANGE 1 WEST.

IT WAS MOVED, SECONDED AND CARRIED UNANIMOUSLY THAT THE
PLANNING COMMISSION RECOMMEND TO THE BOARD OF CITY COM-
MISSIONERS THAT THIS DEDICATION BE ACCEPTED.

RESPECTFULLY SUBMITTED,

L. L. LITTLE
SECRETARY

LLL:RAL:BER

ATTACHMENT

DEDICATION

KNOW ALL MEN BY THESE PRESENTS:

That for and in consideration of the sum of One Dollar (\$1.00) and other good and valuable considerations, the receipt of which is hereby acknowledged, the undersigned, _____

being the owner of the following described real estate in Sedgwick County, Kansas, to wit:

The north thirty (30) feet of the east six hundred sixty-five (665) feet of the north seven (7) acres of the Southwest Quarter of the Southwest Quarter of Section 12, Township 27, South, Range 2 West.

do hereby dedicate the above described real estate to the public for street purposes.

Executed this _____ day of _____, 19 ____.

Submitted to the Wichita - Sedgwick County Metropolitan Area Planning Commission and the Board of Commissioners of the City of Wichita, Kansas, and approved by said Board of Commissioners of the City of Wichita, Kansas.

Ruth Spooner Stone

STATE OF KANSAS }
SEDGWICK COUNTY } SS

BE IT REMEMBERED, that on this _____ day of _____, 19____, before me a Notary Public in and for the said County and State came _____

to me personally known to be the same person who executed the foregoing instrument and duly acknowledged the execution of the same.

IN WITNESS WHEREOF, I have hereunto subscribed my name and affixed by official seal, the day and year last above written.

Notary Public
Vern L. Forney

My Commission Expires: _____

