

D-0177 - Dedication from K.T. & Gladys Wiedemann for 10' of R/W for S. Service Rd. of Kellogg - between Longfellow Lane and Rock Road.

*Revised
7-16-60*

ACTION

	DATE
S/D COMMITTEE	<u>7-28-60</u>
M.A.P.C.	<u>8-4-60</u>
B.C.C. 8-20-60	<u>8-16-60</u>

Closed

DEDICATION REPORT AND PROGRESS

MAP No. G-9
 SEC. No. 30
 TWP. No. 27
 RANGE 2E

CASE No. D - 0177

- I. OFFER TO DEDICATE: 10' of R/W for South Service Road for Kellogg
 GENERALLY LOCATED: South side of Kellogg between Longfellow Lane and Rock Road.

LEGALLY DESCRIBED AS:

A tract of land described as commencing at a point 10' N of the NE corner of Lot 2, Kellogg Crest Addition to the City of Wichita, thence E along the existing R/W line of U.S. highway 54 to a point 150' W of the E line of Section 30, Township 27 South, Range 2 East, thence to the right with an angle of 45° to a point 10' S of the existing S R/W line of U.S. Highway 54, thence W parallel with and 10' S of the existing S R/W line of U.S. Highway 54 to the NE corner of Lot 2, Kellogg Crest Add. to City of Wichita, thence N 10' to the point of Beginning, Sedgwick County, Kansas.

DEDICATED BY: K.T. and Gladys H. G. Wiedemann
 AGENT: None
 ADDRESS: none PHONE none
 PURPOSE OF DEDICATION: _____

Street purposes

II. SKETCH.

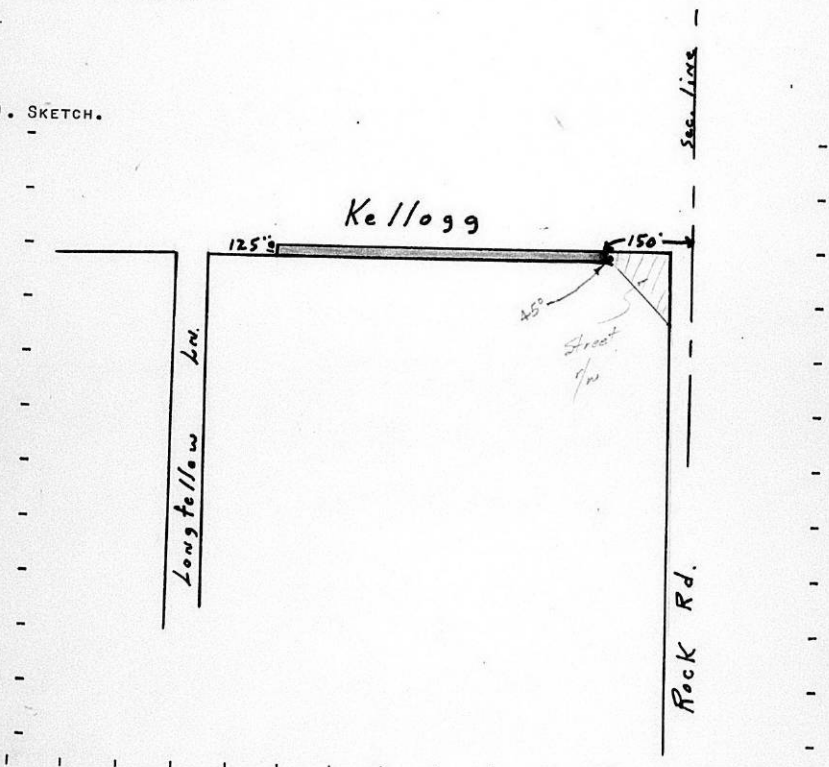

III. OFFER RECEIVED July 14, 1960
 POSTED TO ATLAS 7-15-60
 *S/D COMM. ACTION 7-28-60 *Accept*
 *M.A.P.C. ACTION 8-4-60 *Accept*

*B.C.C. ACTION 8-16-60 *Accept*
 PLACED ON RECORD _____
 CITY CLERKS No. _____

Dedication # D-0271

SLP Committee 7-28-60

NAPC 7-9-60 approve

BCC - 8-16-60 approve

attached attached r. d.
copy of dedication

SHEET #19

DEDICATION REPORT AND PROGRESS

CASE No. D - 0177

MAP No. 0-9
SEC. No. 30
TWP. No. 27
RANGE 25

I. OFFER TO DEDICATE: 10' of R/W for South Service Road for Kellogg
GENERALLY LOCATED: South side of Kellogg between Longfellow Lane and Rock Road.

LEGALLY DESCRIBED AS:

A tract of land described as commencing at a point 10' N of the NE corner of Lot 2, Kellogg Crest Addition to the City of Wichita, thence E along the existing R/W line of U.S. highway 54 to a point 150' W of the E line of Section 30, Township 27 South, Range 2 East, thence to the right with an angle of 45° to a point 10' S of the existing S.R/W line of U.S. Highway 54, thence W parallel with and 10' S of the existing S.R/W line of U.S. Highway 54 to the NE corner of Lot 2, Kellogg Crest Add. to City of Wichita, thence N 10' to the point of Beginning, Sedgwick County, Kansas.

DEDICATED BY: V. T. and Gladys H. C. Wiedemann

AGENT: None

ADDRESS: None PHONE None

PURPOSE OF DEDICATION:

Street purposes

II. SKETCH.

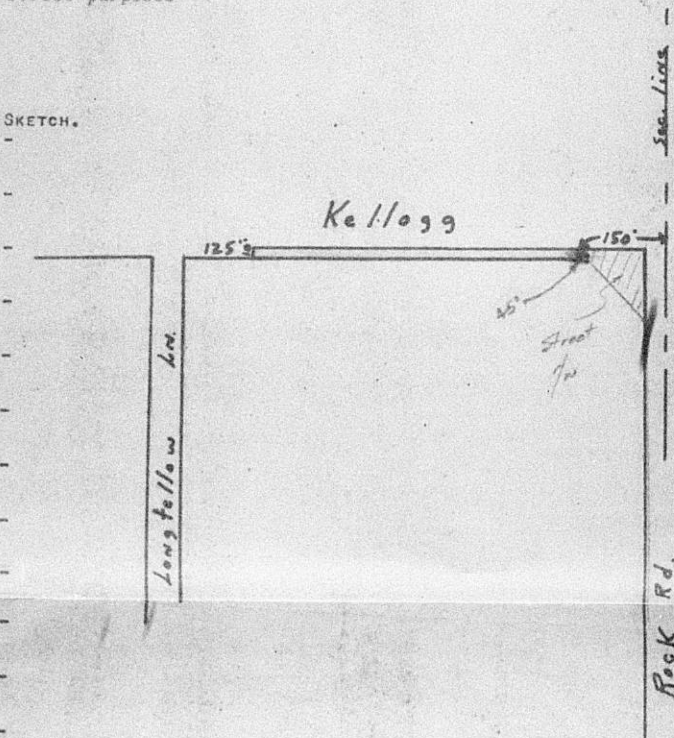

III. OFFER RECEIVED July 14, 1960
POSTED TO ATLAS 7-15-60
*S/D COMM. ACTION 7-28-60
*M.A.P.C. ACTION _____

*B.C.C. ACTION _____
PLACED ON RECORD _____
CITY CLERKS No. _____

DEDICATION

KNOW ALL MEN BY THESE PRESENTS:

That for and in consideration of the sum of One Dollar (\$1.00) and other good and valuable considerations, the receipt of which is hereby acknowledged, the undersigned, K. T. Wiedemann and Gladys H. G. Wiedemann

being the owner s of the following described real estate in Sedgwick County, Kansas, to wit:

A tract of land described as commencing at a point 10 feet North of the Northeast corner of Lot 2, Kellogg Crest Addition to the city of Wichita, thence East along the existing right of way line of U.S. Highway 54 to a point 150 feet West of the East line of Section 30, Township 27 South, Range 2 East, thence to the right with an angle of 45 degrees to a point 10 feet South of the existing South right of way line of U.S. Highway 54, thence Westparallel with and 10 feet South of the existing South right of way line of U.S. Highway 54 to the Northeast corner of Lot 2, Kellogg Crest Addition to the city of Wichita, thence North 10 feet to the point of beginning, Sedgwick County, Kansas

do hereby dedicate the above described real estate to the public for street purposes.

Executed this day of June, 19 60.

K. T. Wiedemann

Gladys H. G. Wiedemann

STATE OF KANSAS)
SEDGWICK COUNTY) SS

BE IT REMEMBERED, that on this day of June, 1960, before me a Notary Public in and for the said County and State

came K. T. Wiedemann and Gladys H. G. Wiedemann

to me personally known to be the same persons s who executed the foregoing instrument and duly acknowledged the execution of the same.

IN WITNESS WHEREOF, I have hereunto subscribed my name and affixed by official seal, the day and year last above written.

Notary Public

PAULINE ARNETT

My commission expires Feb. 25, 1963

My Commission Expires:



PHONE AN 2-8211 • 104 SOUTH MAIN STREET • WICHITA 2, KANSAS

WICHITA-SEDDWICK COUNTY

**METROPOLITAN AREA
PLANNING
COMMISSION**



August 10, 1960

BOARD OF CITY COMMISSIONERS
CITY BUILDING
WICHITA, KANSAS

GENTLEMEN:

SUBJECT: D-0177 - DEDICATION
FOR 10' OF R/W FOR SOUTH SER-
VICE ROAD OF KELLOGG, BETWEEN
LONGFELLOW LANE AND ROCK ROAD.

AT THE REGULAR MEETING OF THE METROPOLITAN AREA PLAN-
NING COMMISSION HELD ON AUGUST 4, 1960, THE ABOVE DEDICA-
TION, BEING MORE SPECIFICALLY DESCRIBED AS A TRACT OF LAND
COMMENCING AT A POINT 10 FEET NORTH OF THE NORTHEAST CORNER
OF LOT 2, KELLOGG CREST ADDITION TO THE CITY OF WICHITA;
THENCE EAST ALONG THE EXISTING R/W LINE OF U.S. HIGHWAY 54
TO A POINT 150 FEET WEST OF THE EAST LINE OF SECTION 30,
TOWNSHIP 27 SOUTH, RANGE 2 EAST; THENCE TO THE RIGHT WITH AN
ANGLE OF 45° TO A POINT 10 FEET SOUTH OF THE EXISTING SOUTH
R/W LINE OF U.S. HIGHWAY 54; THENCE WEST PARALLEL WITH AND
10 FEET SOUTH OF THE EXISTING SOUTH R/W LINE OF U.S. HIGHWAY
54 TO THE NORTHEAST CORNER OF LOT 2, KELLOGG CREST ADDITION
TO THE CITY OF WICHITA; THENCE NORTH 10 FEET TO THE POINT OF
BEGINNING, SEDGWICK COUNTY, KANSAS, WAS CONSIDERED AND THE
FOLLOWING ACTION TAKEN:

IT WAS MOVED, SECONDED AND CARRIED
UNANIMOUSLY THAT THE PLANNING COM-
MISSION RECOMMEND TO THE BOARD OF
CITY COMMISSIONERS THAT THIS DEDI-
CATION BE ACCEPTED.

RESPECTFULLY SUBMITTED,

L. L. LITTLE
DIRECTOR OF PLANNING

LLL:BR

DEDICATION

KNOW ALL MEN BY THESE PRESENTS:

That for and in consideration of the sum of One Dollar (\$1.00) and other good and valuable considerations, the receipt of which is hereby acknowledged, the undersigned, K. T. Wiedemann and Gladys H. G. Wiedemann

being the owner s of the following described real estate in Sedgwick County, Kansas, to wit:

A tract of land described as commencing at a point 10 feet North of the Northeast corner of Lot 2, Kellogg Crest Addition to the city of Wichita, thence East along the existing right of way line of U.S. Highway 54 to a point 150 feet West of the East line of Section 30, Township 27 South, Range 2 East, thence to the right with an angle of 45 degrees to a point 10 feet South of the existing South right of way line of U.S. Highway 54, thence Westparallel with and 10 feet South of the existing South right of way line of U.S. Highway 54 to the Northeast corner of Lot 2, Kellogg Crest Addition to the city of Wichita, thence North 10 feet to the point of beginning, Sedgwick County, Kansas

do hereby dedicate the above described real estate to the public for street purposes.

Executed this 28th day of June, 19 60.

K. T. Wiedemann
K. T. Wiedemann

Gladys H. G. Wiedemann
Gladys H. G. Wiedemann

STATE OF KANSAS }
SEDGWICK COUNTY } SS

BE IT REMEMBERED, that on this 28th day of June, 1960, before me a Notary Public in and for the said County and State came K. T. Wiedemann and Gladys H. G. Wiedemann

to me personally known to be the same person s who executed the foregoing instrument and duly acknowledged the execution of the same.

IN WITNESS WHEREOF, I have hereunto subscribed my name and affixed by official seal, the day and year last above written.

Pauline Arnett
Notary Public

PAULINE ARNETT

My commission expires Feb. 25, 1953

My Commission Expires: _____