

ACTION

	DATE
S/D COMMITTEE	<u>4-22-61</u>
M.A.P.C.	<u>5-4-61</u>
B.C.C. / <del>B.C.C.</del>	<u>5-16-61</u>

*Claw*

D-0199 - LAWRENCE, INC. OFFERS DEDICATION OF STREET RIGHT-OF-WAY ON N SIDE OF 25TH ST. NORTH BETWEEN BELMONT AND PERSHING.

920 P  
1-13-61

# ACTION

		DATE
S/D COMMITTEE	<u>Accepted</u>	<u>4-22-61</u>
M.A.P.C.	<u>Accepted</u>	<u>5-4-61</u>
B.C.C./B.C.C.P.	<u>Accepted</u>	<u>5-16-61</u>

Closed

D-0199 - LAWRENCE, INC. OFFERS DEED-  
CATION OF STREET RIGHT-OF-WAY ON N  
SIDE OF 25TH ST., NORTH BETWEEN  
BELMONT AND PERSHING.

## DEDICATION REPORT AND PROGRESS

MAP No. C-7  
 SEC. No. 2  
 TWP. No. 27  
 RANGE 1E

CASE No. D - 0199

- I. OFFER TO DEDICATE: A PORTION OF LOT, BLOCK 1, GREENBRIAR MANOR  
 GENERALLY LOCATED: ON N SIDE OF 25TH ST. NORTH BETWEEN BELMONT AND PERSHING.

## LEGALLY DESCRIBED AS:

BEGINNING AT THE SOUTHEAST CORNER OF LOT 2, BLOCK 1, GREENBRIAR MANOR; THENCE WEST TO THE SOUTHWEST CORNER OF SAID LOT 2; THENCE NORTH ALONG THE WEST LINE OF SAID LOT 2 A DISTANCE OF TEN (10) FEET; THENCE SOUTHEASTERLY TO THE POINT OF BEGINNING.

DEDICATED BY: LAWRENCE, INC.  
 AGENT: ROBERT J. LAWRENCE, PRESIDENT  
 ADDRESS: \_\_\_\_\_ PHONE \_\_\_\_\_  
 PURPOSE OF DEDICATION: \_\_\_\_\_

FOR STREET PURPOSES.

## II. SKETCH.

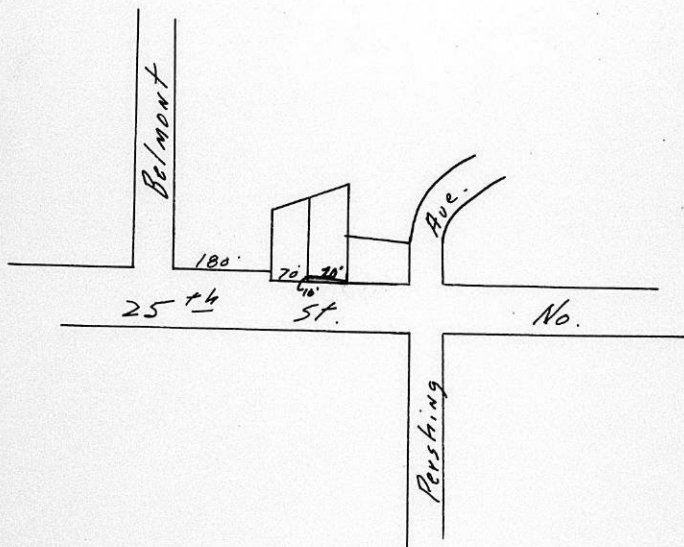

III. OFFER RECEIVED 4-10-61  
 POSTED TO ATLAS 4-13-61  
 \*S/D COMM. ACTION 4-27-61 Accept  
 \*M.A.P.C. ACTION 5-4-61 Accept

\*B.C.C. ACTION 5-16-61 Accept  
 PLACED ON RECORD \_\_\_\_\_  
 CITY CLERKS No. \_\_\_\_\_

PHONE AM 2-8211 • 104 SOUTH MAIN STREET • WICHITA 2, KANSAS

*Cham*

WICHITA-SEDDWICK COUNTY

**METROPOLITAN AREA  
PLANNING  
COMMISSION**

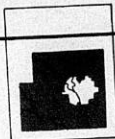

MAY 11, 1961

BOARD OF CITY COMMISSIONERS  
CITY BUILDING  
WICHITA, KANSAS

GENTLEMEN:

RE: D-0199 - DEDICATION OF A  
PORTION OF 25TH STREET NORTH  
BETWEEN BELMONT AND PERSHING

AT THE REGULAR MEETING OF THE METROPOLITAN AREA PLANNING COMMISSION HELD ON MAY 4, 1961, THE ABOVE DEDICATION WAS CONSIDERED. THIS DEDICATION IS LEGALLY DESCRIBED AS BEGINNING AT THE SOUTHEAST CORNER OF LOT 2, BLOCK 1, GREENBRIAR MANOR; THENCE WEST TO THE SOUTHWEST CORNER OF SAID LOT 2; THENCE NORTH ALONG THE WEST LINE OF SAID LOT 2 A DISTANCE OF 10 FEET; THENCE SOUTHEASTERLY TO THE POINT OF BEGINNING.

IT WAS MOVED, SECONDED AND CARRIED UNANIMOUSLY THAT THE PLANNING COMMISSION RECOMMEND TO THE BOARD OF CITY COMMISSIONERS THAT THIS DEDICATION BE ACCEPTED.

RESPECTFULLY SUBMITTED,

L. L. LITTLE  
SECRETARY

LLL:RAL:BER

ATTACHMENT

*File*

MAY 11, 1961

BOARD OF CITY COMMISSIONERS  
CITY BUILDING  
WICHITA, KANSAS

GENTLEMEN:

RE: D-0199 - DEDICATION OF A  
PORTION OF 25TH STREET NORTH  
BETWEEN BELMONT AND PERSHING

AT THE REGULAR MEETING OF THE METROPOLITAN AREA PLANNING COMMISSION HELD ON MAY 4, 1961, THE ABOVE DEDICATION WAS CONSIDERED. THIS DEDICATION IS LEGALLY DESCRIBED AS BEGINNING AT THE SOUTHEAST CORNER OF LOT 2, BLOCK 1, GREENBRIAR MANOR; THENCE WEST TO THE SOUTHWEST CORNER OF SAID LOT 2; THENCE NORTH ALONG THE WEST LINE OF SAID LOT 2 A DISTANCE OF 10 FEET; THENCE SOUTHEASTERLY TO THE POINT OF BEGINNING.

IT WAS MOVED, SECONDED AND CARRIED UNANIMOUSLY THAT THE PLANNING COMMISSION RECOMMEND TO THE BOARD OF CITY COMMISSIONERS THAT THIS DEDICATION BE ACCEPTED.

RESPECTFULLY SUBMITTED,

L. L. LITTLE  
SECRETARY

LLL:RAL:BER

ATTACHMENT

WICHITA-SEDGWICK COUNTY

**METROPOLITAN AREA  
PLANNING  
COMMISSION**



MAY 11, 1961

BOARD OF CITY COMMISSIONERS  
CITY BUILDING  
WICHITA, KANSAS

GENTLEMEN:

RES. D-0199 - DEDICATION OF A  
PORTION OF 25TH STREET NORTH  
BETWEEN BELMONT AND PERSHING

AT THE REGULAR MEETING OF THE METROPOLITAN AREA PLANNING  
COMMISSION HELD ON MAY 4, 1961, THE ABOVE DEDICATION WAS  
CONSIDERED. THIS DEDICATION IS LEGALLY DESCRIBED AS  
BEGINNING AT THE SOUTHEAST CORNER OF LOT 2, BLOCK 1, GREEN-  
BRIAR MANOR; THENCE WEST TO THE SOUTHWEST CORNER OF SAID LOT  
2; THENCE NORTH ALONG THE WEST LINE OF SAID LOT 2 A DISTANCE  
OF 10 FEET; THENCE SOUTHEASTERLY TO THE POINT OF BEGINNING.

IT WAS MOVED, SECONDED AND CARRIED UNANIMOUSLY THAT THE  
PLANNING COMMISSION RECOMMEND TO THE BOARD OF CITY COMMISSIONERS  
THAT THIS DEDICATION BE ACCEPTED.

RESPECTFULLY SUBMITTED,

*L. L. Little*  
L. L. LITTLE  
SECRETARY

LLL:RALTBER

ATTACHMENT

DEDICATION

KNOW ALL MEN BY THESE PRESENTS:

That for and in consideration of the sum of One Dollar (\$1.00) and other good and valuable considerations, the receipt of which is hereby acknowledged, the undersigned, Lawrence, Inc., acting by its President, Robert J. Lawrence

being the owner of the following described real estate in Sedgwick County, Kansas, to wit:

Beginning at the southeast corner of Lot 2, Block 1, Greentree Manor, thence west to the southwest corner of said Lot 2, thence north along the east line of said Lot 2, a distance of ten (10) feet thence southeasterly to the point of beginning.

do hereby dedicate the above described real estate to the public for street purposes.

Executed this 7th day of April, 1961

Submitted to the Wichita - Sedgwick County Metropolitan Area Planning Commission and the Board of Commissioners of the City of Wichita, Kansas, and approved by said Board of Commissioners of the City of Wichita, Kansas,

this 19

City Clerk

LAWRENCE, INC.

By

Robert J. Lawrence, President

Frances L. Lawrence, Secretary

STATE OF KANSAS)  
SEDGWICK COUNTY) SS

BE IT REMEMBERED, that on this 7th day of April 1961, before me a Notary Public in and for the said County and State

came Robert J. Lawrence, President and Frances L. Lawrence, Secretary of Lawrence, Inc.

to me personally known to be the same person as who executed the foregoing instrument and duly acknowledged the execution of the same.

IN WITNESS WHEREOF, I have hereunto subscribed my name and affixed by official seal, the day and year last above written.

Notary Public Mary E. Kane

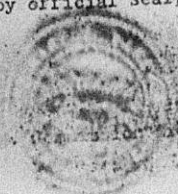

Witness: June 6, 1961.