

3-2-62

D-0211 - ROSE M. BRUCE OFFERS DEDICATION OF PORTION OF S $\frac{1}{2}$ OF 9TH STREET LOCATED E OF EDGEMOOR

ACTION

S/D	COMMITTEE	DATE
	<u>Accept</u>	<u>3-8-62</u>
	M.A.P.C.	<u>3-15-62</u>
	B.C.C./B. CO. C.	<u>4-9-62</u>

Closed

DEDICATION REPORT AND PROGRESS

MAP No. E-8
 SEC. No. 13
 TWP. No. 27
 RANGE 15

CASE No. D - 0211

I. OFFER TO DEDICATE: PORTION OF S $\frac{1}{2}$ OF 9TH STREET
 GENERALLY LOCATED: EAST OF EDGEMOOR

LEGALLY DESCRIBED AS:

THE N 40 FEET OF THE W $\frac{1}{2}$ OF THE SE $\frac{1}{4}$ OF SECTION 13, TOWNSHIP 27 SOUTH,
 RANGE 1 EAST OF THE 6TH P.M., EXCEPT THE W 175 FEET AND THE E 90 FEET
 OF THE W 250 FEET OF THE E $\frac{1}{2}$ OF THE W $\frac{1}{2}$ OF SECTION 13, TOWNSHIP 27 SOUTH,
 RANGE 1 EAST.

the southeast quarter

DEDICATED BY: ROSE M. BRUCE
 AGENT: _____
 ADDRESS: _____ PHONE _____
 PURPOSE OF DEDICATION: _____
 FOR STREET PURPOSES

II. SKETCH.

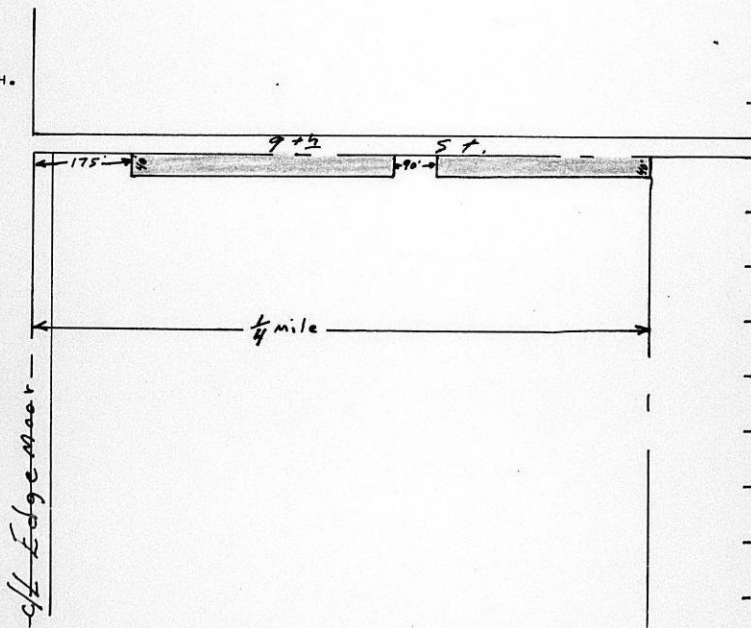

III. OFFER RECEIVED 3-1-62 *B.C.C. ACTION A-3-62 Accept
 POSTED TO ATLAS 3-2-62
 *S/D COMM. ACTION 3-28-62 Accept PLACED ON RECORD _____
 *M.A.P.C. ACTION 3-15-62 Accept CITY CLERKS No. _____

MARCH 19, 1962

BOARD OF CITY COMMISSIONERS
CITY BUILDING
WICHITA, KANSAS

GENTLEMEN:

RE: D-0211 - DEDICATION FOR
S $\frac{1}{2}$ OF 9TH STREET IN AN
AREA EAST OF EDGEHOOR

AT THE REGULAR MEETING OF THE METROPOLITAN AREA PLANNING COMMISSION HELD ON MARCH 15, 1962, THE ABOVE DEDICATION FROM ROSE M. BRUCE, FOR PROPERTY LEGALLY DESCRIBED AS THE NORTH 40 FEET OF THE W $\frac{1}{2}$ OF THE SE $\frac{1}{4}$ OF SECTION 13, TOWNSHIP 27 SOUTH, RANGE 1 EAST OF 6TH P.M. EXCEPT THE WEST 175 FEET AND THE EAST 90 FEET OF THE WEST 250 FEET OF THE E $\frac{1}{2}$ OF THE W $\frac{1}{2}$ OF THE SE $\frac{1}{4}$ OF SECTION 13, TOWNSHIP 27 SOUTH, RANGE 1 EAST, WAS CONSIDERED.

IT WAS MOVED, SECONDED AND CARRIED UNANIMOUSLY THAT THE PLANNING COMMISSION RECOMMEND TO THE BOARD OF CITY COMMISSIONERS THAT THIS DEDICATION BE ACCEPTED.

RESPECTFULLY SUBMITTED,

L. L. LITTLE
DIRECTOR OF PLANNING

LLL:RAL:BER

ATTACHMENT

SE 1/4 Sec 13 27S R1E
5/4 7th Edgemoore to 1/4 Mile

D E D I C A T I O N

KNOW ALL MEN BY THESE PRESENTS:

That for and in consideration of the sum of One-Dollar (\$1.00) and other good and valuable considerations, the receipt of which is hereby acknowledged, the undersigned, Rose M. Bruce

being the owner of the following described real estate in Sedgwick County, Kansas, to wit:

The north forty (40) feet of the west half of the Southeast Quarter of Section 13, Township 27, South, Range 1, East of the 6th P. M., except the west one hundred seventy-five (175) feet and the east ninety (90) feet of the west two hundred fifty (250) feet of the east half of the west half of the Southeast Quarter of Section 13, Township 27, South, Range 1, East;

do hereby dedicate the above described real estate to the public for street purposes.

Executed this 28th day of February, 19 62.

STATE OF KANSAS)
SEDGWICK COUNTY) SS

1962 I HEREBY REMEMBERED, that on this 28th day of February before me a Notary Public in and for the said County and State came Rose M. Bruce

to me personally known to be the same person who executed the foregoing instrument and duly acknowledged the execution of the same.

IN WITNESS WHEREOF, I have hereunto subscribed my name and affixed by official seal, the day and year last above written.

Notary Public

My Commission Expires: _____