

**ACTION**

	DATE
S/S. COMMITTEE	<u>6-28-62</u>
M.A.P.C.	<u>7-5-62</u>
B.C.C. / B. GO. C.	<u>7-17-62</u>

*Closed -*

P-0218 - DEDICATION FOR W. DORIS IN  
AN AREA BETWEEN CENTRAL & MURDOCK &  
S 1/2 MURDOCK FROM DORIS WEST. E.H.  
& LUCILLE HEADGEPATH

Posted  
6-18-62

### ACTION

		DATE
S/D. COMMITTEE	<u>Accept</u>	6-28-62
M.A.P.C.	<u>Accept</u>	7-5-62
B.C.C./ <del>B. CO. C.</del>	<u>Accept</u>	7-17-62

Closed -

218 DEPARTMENT OF DORIS IN  
AREA BETWEEN CENTRAL & MURDOCK &  
S. MURDOCK FROM DORIS WEST. E.H.  
& LUCILLE HEADBATH

DEDICATION REPORT AND PROGRESS

MAP No. E-1  
 SEC. No. 14  
 TWP. No. 27S  
 RANGE 1W

CASE No. D - 0218

I. OFFER TO DEDICATE:  
 GENERALLY LOCATED: W $\frac{1}{2}$  DORIS IN AN AREA BETWEEN CENTRAL AND MURDOCK  
S $\frac{1}{2}$  MURDOCK IN AN AREA FROM DORIS WEST 135'

LEGALLY DESCRIBED AS:

THE EAST 30 FEET AND THE NORTH 30 FEET OF THE EAST 5 ACRES OF THE SW $\frac{1}{4}$  OF SW $\frac{1}{4}$  OF SECTION 14, TOWNSHIP 27 SOUTH, RANGE 1 WEST, EXCEPT THE SOUTH 264 FEET.

DEDICATED BY: E. H. AND LUCILLE HEADGEPATH  
 AGENT: \_\_\_\_\_  
 ADDRESS: \_\_\_\_\_ PHONE \_\_\_\_\_  
 PURPOSE OF DEDICATION: STREET PURPOSES

II. SKETCH.

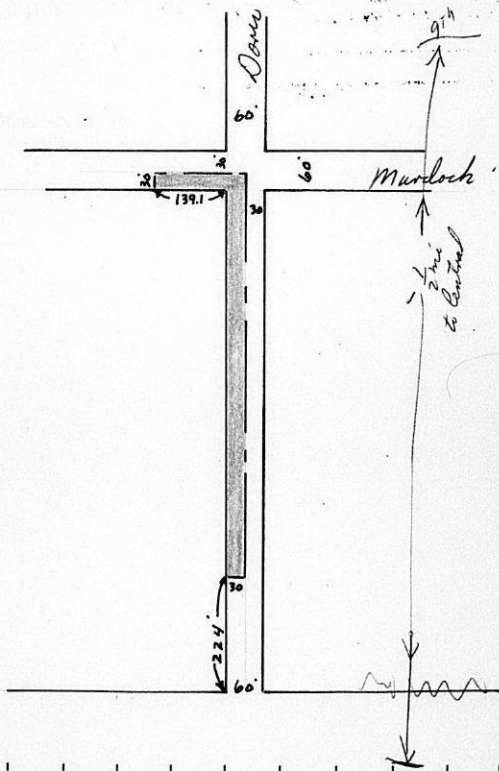

III. OFFER RECEIVED 6-18-62 \*B.C.C. ACTION 7-17-62 Accept  
 POSTED TO ATLAS 6-18-62  
 \*S/D COMM. ACTION 6-28-62 PLACED ON RECORD \_\_\_\_\_  
 \*M.A.P.C. ACTION 7-3-62 Accept CITY CLERKS NO. \_\_\_\_\_

JULY 9, 1962

BOARD OF CITY COMMISSIONERS  
CITY BUILDING  
WICHITA, KANSAS

GENTLEMEN:

SUBJECT: D-0218

AT ITS REGULAR MEETING ON JULY 5, 1962, THE METROPOLITAN AREA  
PLANNING COMMISSION CONSIDERED THE OFFER OF A DEDICATION FOR  
THE W $\frac{1}{2}$  OF DORIS BETWEEN CENTRAL AND MURDOCK AND THE S $\frac{1}{2}$  OF  
MURDOCK FROM DORIS WEST, AND HAS RECOMMENDED THAT THE BOARD  
OF CITY COMMISSIONERS ACCEPT THE OFFERED DEDICATION.

RESPECTFULLY SUBMITTED,

L. L. LITTLE, SECRETARY

LLL/CDM:MM

ATTACHMENT: 1

DEDICATION

KNOW ALL MEN BY THESE PRESENTS:

That for and in consideration of the sum of One Dollar (\$1.00) and other good and valuable considerations, the receipt of which is hereby acknowledged, the undersigned,

E. H. Heedgpath

being the owner of the following described real estate in Sedgwick County, Kansas, to wit:

The east thirty (30) feet and the north thirty (30) feet of the east five (5) acres of the southwest quarter of the Southwest Quarter of Section 14, Township 27, South, Range 1, West, except the south two hundred sixty-four (264) feet.

do hereby dedicate the above described real estate to the public for street purposes.

Executed this 15th day of June, 19 62.

Submitted to the Wichita - Sedgwick County Metropolitan Area Planning Commission and the Board of Commissioners of the City of Wichita, Kansas, and approved by said Board of Commissioners of the City of Wichita, Kansas,

on 15 19 62.

City Clerk

E. H. Heedgpath

Lucille Heedgpath

STATE OF KANSAS)  
SEDGWICK COUNTY) SS

BE IT REMEMBERED, that on this 15th day of June, 19 62, before me a Notary Public in and for the said County and State

appeared E. H. Heedgpath and Lucille Heedgpath of

to me personally known to be the same person who executed the foregoing instrument and duly acknowledged the execution of the same.

IN WITNESS WHEREOF, I have hereunto subscribed my name and affixed by official seal, the day and year last above written.

John H. Epperson  
Notary Public

John H. Epperson

My Commission Expires: Oct 30, 65