

D-0269 - Dedication from Elsie A.
Carr for tracts lying S of Harry
and on both sides of Maize Road

B.C.C./B. C.C. C.

S/W Comm *Deary* 10-8-64

Cloud 10-16-64

POSTED
8-31-64

ACTION

S/D COMMITTEE ^{DATE} *defer 2 wks 9-~~24~~-64*
defer 2 wks 9-24-64
M.A.P.C. *withdrawn by applicant 10-15-64*

B.C.C./B. CO. C. _____

S/D Comm *Deny* 10-8-64

Closed 10-16-64

D-0269 - Dedication from Elsie A.
Garr for tracts lying S of Harry
and on both sides of Maize Road

DEDICATION REPORT AND PROGRESS

MAP No. H-2-W & H-1-W
 Sec. No. 31 & 32
 TWP. No. 27S
 RANGE 1W

CASE No. D - 0269

I. OFFER TO DEDICATE: _____
 GENERALLY LOCATED: Iying S of Harry on both sides of Maize Road

LEGALLY DESCRIBED AS:

- (1) The S 40' of the E $\frac{1}{2}$ of the NE $\frac{1}{4}$, Section 31, Township 27 South, R1W
- (2) The E 40' of the SE $\frac{1}{4}$ of the NE $\frac{1}{4}$, Section 31, Township 27 South, R1W
- (3) The S 40' of the W $\frac{1}{2}$ of the NW $\frac{1}{4}$, Section 32, Township 27 South, R1W
- (4) The W 40' of the SW $\frac{1}{4}$ of the NW $\frac{1}{4}$, Section 32, Township 27 South, R1W

DEDICATED BY: Elsie A. Carr
 AGENT: None
 ADDRESS: 10121 W. Harry, R. R. 8 PHONE _____
 PURPOSE OF DEDICATION: _____

Road purposes

II. SKETCH.

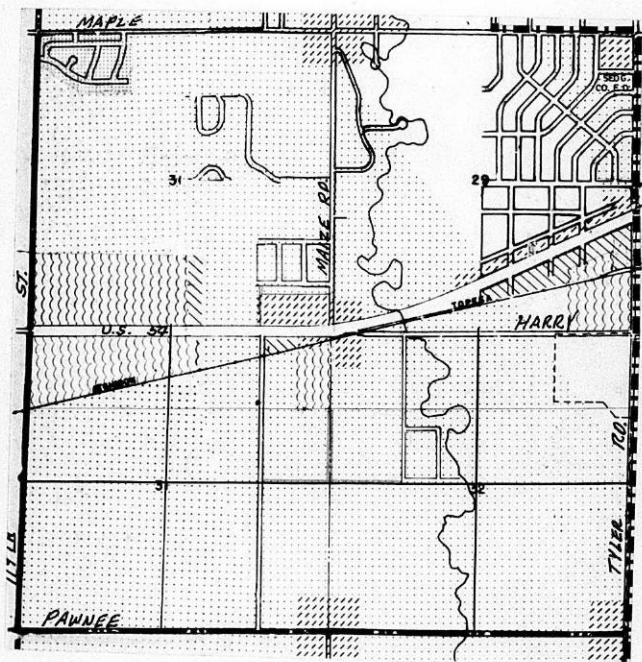

III. OFFER RECEIVED 8-28-64 *B.C.C. ACTION _____
 POSTED TO ATLAS _____
 *S/D COMM. ACTION 9-8-64 defer PLACED ON RECORD _____
9-24-64 defer 10-8-64 deny CITY CLERKS No. _____
 *M.A.P.C. ACTION 10-15-64
withdrawn by applicant

October 16, 1964

Mrs. Elsie A. Carr
10121 west Harry
Wichita, Kansas

Subject: D-0269 - Dedication for road
purposes generally located south of
Harry on both sides of Maize Road

Dear Mrs. Carr:

This is to advise you that, at your request, the above-captioned offer of dedication has been withdrawn from further consideration by the Planning Commission.

Enclosed herewith are the dedication forms which you submitted to this office. This case is now closed and has been placed in our closed files.

If we can be of any assistance to you in the future, please let us know.

Sincerely,

Jack H. Galbraith
Senior Planner

JHG:JWH:bgs

Enclosure

cc: W. R. Fleck, Park Department

Wichita, Kans.

Oct. 12, 1964

Metropolitan Area Planning
Commission,

Dear Sirs:

I am writing in regard to.

Subject: D-8269.

I wish to withdraw the
dedication on said subject
and have it closed out.

Thank you.

Respectively.

Mrs Elsie A. Carr.



October 9, 1964

Mrs. Elsie A. Carr
10121 West Harry
Wichita, Kansas

Subject: D-0269 - Dedication for road
purposes generally located south of
Harry on both sides of Maize Road

Dear Mrs. Carr:

At its regular meeting on October 8, 1964, the Subdivision Committee of the Metropolitan Area Planning Commission considered the above-captioned offer of dedication. The Subdivision Committee recommended that this offer of dedication not be accepted inasmuch as they had no indication as to how the areas adjacent to the dedication would be developed.

This case will be forwarded to the Metropolitan Area Planning Commission for its consideration on October 15, 1964.

If you have any questions concerning this matter, please call.

Sincerely,

Jack H. Galbraith
Senior Planner

JHG:JWH:bgs

cc: W. R. Fleck, Park Department

September 25, 1964

Elsie A. Carr
10121 West Harry
Wichita, Kansas

Subject: D-0269 - Dedication for road
purposes generally located south of
Harry on both sides of Maize Road

Dear Mrs. Carr:

At its regular meeting on September 24, 1964, the Subdivision Committee of the Metropolitan Area Planning Commission considered the above-captioned offer of dedication. The Committee deferred this case for two weeks to allow the Park Department to submit a report as to whether or not the street dedications should be accepted.

This case will be re-scheduled for hearing by the Subdivision Committee at its next regular meeting on October 8, 1964.

If you have any questions concerning this matter, please call.

Sincerely,

Jack H. Galbraith
Senior Planner

JHG:JWH:bgs

cc: W. R. Fleck, Park Department

September 9, 1964

Elsie A. Carr
10121 West Harry
Wichita, Kansas

Subject: D0269 - Dedication for road
purposes generally located south of
Harry on both sides of Maize Road

Dear Mrs. Carr:

At its meeting on September 8, 1964, the Subdivision Committee of the Metropolitan Area Planning Commission considered the above-captioned dedication. The Committee deferred this case for two weeks to allow the applicant sufficient time to submit a sketch showing how this area is to be developed and why these dedications should be accepted.

This case will be re-scheduled for hearing by the Subdivision Committee at its next regular meeting on September 24, 1964.

If you have any questions concerning this matter, please call.

Sincerely,

Jack H. Galbraith
Senior Planner

JHG:JWH:bgs

D-2219

DEDICATION

KNOW ALL MEN BY THESE PRESENTS:

That for and in consideration of the sum of One Dollar (\$1.00) and other good and valuable considerations, the receipt of which is hereby acknowledged, the undersigned, Eloise A. Carr

being the owner of the following described real estate in Sedgwick County, Kansas, to wit:

The south 40 feet of the east 1/2 of the NE 1/4 Sec. 31 T27S R1W of the 6th. P.M.

do hereby dedicate the above described real estate to the public for Road purposes.

Executed this 25th day of August 1964.

Eloise A. Carr

STATE OF KANSAS)
SEDGWICK COUNTY) ss

BE IT REMEMBERED, that on this 25th day of August, 1964, came Eloise A. Carr

to me personally known to be the same person who executed the foregoing instrument and duly acknowledged the execution of the same.

IN WITNESS WHEREOF, I have hereunto subscribed my name and my official seal, the day and year last above written.

Submitted to the Wichita-Sedgwick County Metropolitan Area Planning Commission and the Board of Commissioners of the City of Wichita, Kansas, and approved by said Board of Commissioners of the City of Wichita, Kansas,

this _____

City Clerk



Beulah K. McFadden
Notary Public

My Commission Expires: 2-13-66

D E D I C A T I O N

KNOW ALL MEN BY THESE PRESENTS:

That for and in consideration of the sum of One Dollar (\$1.00) and other good and valuable considerations, the receipt of which is hereby acknowledged, the undersigned, Elsie A. Carr

being the owner of the following described real estate in Sedgwick County, Kansas, to wit:

The west 40 feet of the S.W. 1/4 of the N.W. 1/4 Sec. 32
T27S R1W of the 6th. P.M.

do es hereby dedicate the above described real estate to the public for
road purposes.

Executed this 25th day of August 19 64.

Elsie A. Carr

STATE OF KANSAS)
SEDGWICK COUNTY) ss

BE IT REMEMBERED, that on this 25th day of August, 1964.
came Elsie A. Carr

to me personally known to be the same person who executed the foregoing instrument and duly acknowledged the execution of the same.

IN WITNESS WHEREOF, I have hereunto subscribed my name and affixed my official seal, the day and year last above written.



Beulah K. M. Fadden
Notary Public

My Commission Expires: 2-13-64

Submitted to the Wichita-Sedgwick County Metropolitan Area Planning Commission and the Board of Commissioners of the City of Wichita, Kansas, and approved by said Board of Commissioners of the City of Wichita, Kansas,
this _____
City Clerk

DEDICATION

KNOW ALL MEN BY THESE PRESENTS:

That for and in consideration of the sum of One Dollar (\$1.00) and other good and valuable considerations, the receipt of which is hereby acknowledged, the undersigned, Elsie A. Carr

being the owner of the following described real estate in Sedgwick County, Kansas, to wit:

The east 40 feet of the S.E. 1/4 of the N.E. 1/4 Sec 31 T27S R1W of the 6th. P.M.

do as hereby dedicate the above described real estate to the public for road purposes.

Executed this 25th day of August 19 64

Elsie A Carr

STATE OF KANSAS)
SEDGWICK COUNTY) ss

BE IT REMEMBERED, that on this 25th day of August, 1964,
came Elsie A. Carr

to me personally known to be the same person who executed the foregoing instrument and duly acknowledged the execution of the same.

IN WITNESS WHEREOF, I have hereunto subscribed my name and affixed my official seal, the day and year last above written.



Leulal K. McFadden
Notary Public

My Commission Expires: 2-13-66

Submitted to the Wichita-Sedgwick County Metropolitan Area Planning Commission and the Board of Commissioners of the City of Wichita, Kansas, and approved by said Board of Commissioners of the City of Wichita, Kansas,

this _____

City Clerk

DEDICATION

KNOW ALL MEN BY THESE PRESENTS:

That for and in consideration of the sum of One Dollar (\$1.00) and other good and valuable considerations, the receipt of which is hereby acknowledged, the undersigned, Elsie A. Carr

being the owner of the following described real estate in Sedgwick County, Kansas, to wit:

The south 40 feet of the West 1/2 of the NW 1/4 Sec. 32 T27S R1W of the 6th. P.M.

do ^{ss} hereby dedicate the above described real estate to the public for _____ purposes.

Executed this 25th day of August 19 64.

Elsie A. Carr

STATE OF KANSAS)
SEDGWICK COUNTY)^{ss}

BE IT REMEMBERED, that on this 25th day of August 1964,
came Elsie A. Carr

to me personally known to be the same person who executed the foregoing instrument and duly acknowledged the execution of the same.

IN WITNESS WHEREOF, I have hereunto subscribed my name and affixed my official seal, the day and year last above written.

Submitted to the Wichita-Sedgwick County Metropolitan Area Planning Commission and the Board of Commissioners of the City of Wichita, Kansas, and approved by said Board of Commissioners of the City of Wichita, Kansas,
this _____
City Clerk



Bulah K. McJadden
Notary Public

My Commission Expires: 2-13-66

AFTER FIVE DAYS RETURN TO

Mrs. Leticia Carr
1612 W. Harvey, P. 48
Subiacha, Kansas 67209

D-0269



Mr. Herald Young
2944 S. Washington,
Subiacha,
Kansas 67216