

D-0321 - Dedication from Wichita Collegiate School for the W₂ of Governor Road, north of 13th Street

Revised
6-21-66

ACTION

DATE

SAC COMMITTEE Accept 6-30-66

M.A.P.C. Accept 7-7-66

B.C.C. ~~COFC~~ Accepted 7-19-66

Closed 7-19-66

DEDICATION REPORT AND PROGRESS

MAP No. 5949
 SEC. No. 7
 TWP. No. 27
 RANGE 25

CASE No. D - 0321

I. OFFER TO DEDICATE: W¹/₄ of Gouverneur Road
 GENERALLY LOCATED: north of 13th Street

LEGALLY DESCRIBED AS: The E 40' of the following tract: Beg. at a point 668.2' S & 80' W of the NE corner of said SW¹/₄; th Nely along a curve to the left having a radius of 110' a distance of 90.54', more or less, to a point on the E line of said SW¹/₄; thence S along said E line a distance of 336'; th NWly along a curve to the left having a radius of 110' a distance of 89.43' to a point 928.2' S and 80' W of the NE corner of said SW¹/₄; th N to point of beginning.

DEDICATED BY: Wichita Collegiate School
 AGENT: _____
 ADDRESS: 9115 East 13th Street PHONE MU 4-0263
 PURPOSE OF DEDICATION: _____

Street purposes

II. SKETCH.

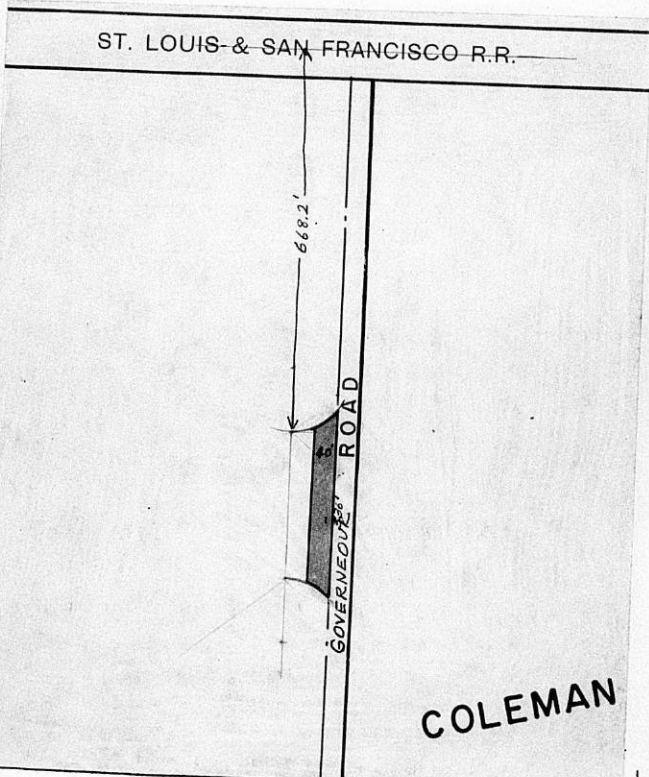

III. OFFER RECEIVED 6-24-66
 POSTED TO ATLAS 6-26-66
 *S/D COMM. ACTION 6-30-66 *Accept*
 *M.A.P.C. ACTION 7-7-66 *Accept*

*B.C.C. ACTION 7-19-66 *Accepted*
 PLACED ON RECORD _____
 CITY CLERKS No. _____

Dedication of: Street right-of-way

MAPC Case No. D-321

Dedicated by: Wichita Collegiate School

Approved by MAPC: 7-7-66

General Location: W $\frac{1}{2}$ of Gouverneur Road north of 13th Street

Reason for Acceptance: To provide full width right-of-way

City Manager's Recommendation: Accept the Dedication and instruct
the City Clerk to file with the Register of Deeds.
Form T9-325

July 7, 1966

Wichita Collegiate School
9115 East 13th Street
Wichita, Kansas

Subject: D-0321 - Dedication for the W $\frac{1}{2}$ of Govern-
our Road, north of 13th Street

Gentlemen:

At its regular meeting on July 7, 1966, the Metropolitan Area Planning Commission considered the above-captioned offer of dedication. The action of the Planning Commission was to recommend that this offer of dedication be accepted.

This matter will be forwarded to the Board of City Commissioners for their consideration on July 19, 1966, at 9:00 a.m.

If you have any questions concerning this matter, please call.

Sincerely,

Jack H. Galbraith
Senior Planner

JHG:bgs

July 5, 1966

Wichita Collegiate School
9115 East 13th Street
Wichita, Kansas

Subject: D-0321 - Dedication of a
portion of Gouverneur Road.

Gentlemen:

This is to advise you that the Subdivision Committee of the Metropolitan Area Planning Commission, at its regular meeting on June 30, 1966, considered the above-captioned offer of dedication. The action of the Subdivision Committee was to recommend that this dedication be accepted.

The recommendation of the Subdivision Committee that this dedication be accepted will be forwarded to the Metropolitan Area Planning Commission for their consideration at their next regular meeting on July 7, 1966.

Sincerely yours,

Jack H. Galbraith
Senior Planner

JHG:sa

Portion of West Half of
Government Road north of 13th

DEDICATION

KNOW ALL MEN BY THESE PRESENTS:

That for and in consideration of the sum of One Dollar (\$1.00) and other good and valuable considerations, the receipt of which is hereby acknowledged, the undersigned, WICHITA COLLEGIATE SCHOOL

being the owner of the following described real estate in Sedgwick County, Kansas, to wit:

The east forty (40) feet of the following described tract:

Beginning at a point six hundred sixty-eight and two-tenths (668.2) feet south and eighty (80) feet west of the northeast corner of said Southwest Quarter; thence northeasterly along a curve to the left having a radius of one hundred ten (110) feet a distance of ninety and fifty-four hundredths (90.54) feet, more or less, to a point on the east line of said Southwest Quarter; thence south along said east line a distance of three hundred thirty-six (336) feet; thence northwesterly along a curve to the left having a radius of one hundred ten (110) feet a distance of eighty-nine and forty-three hundredths (89.43) feet to a point nine hundred twenty-eight and two-tenths (928.2) feet south and eighty (80) feet west of the northeast corner of said Southwest Quarter; thence north to the point of beginning;

do as hereby dedicate the above described real estate to the public for street purposes.

Executed this 22 day of June, 19 66

Submitted to the Wichita - Sedgwick County Metropolitan Area Planning Commission and the Board of Commissioners of the City of Wichita, Kansas, and approved by said Board of Commissioners of the City of Wichita, Kansas,

this _____ 19 _____

City Clerk



Dorothy Brunson

STATE OF KANSAS }
SEDGWICK COUNTY) SS

BE IT REMEMBERED, that on this 22nd day of June, 19 66, before me a Notary Public in and for the said County and State

came Robert D. Love and Dorothy Brunson

to me personally known to be the same persons who executed the foregoing instrument and duly acknowledged the execution of the same.

IN WITNESS WHEREOF, I have hereunto subscribed my name and affixed my official seal, the day and year last above written.



Notary Public

My Commission Expires: _____