

D-0358 - Dedication from Abbott Laboratories of 20' additional half-street R/W for the west side of Ridge Road 1/4 mile south of 63rd St. So.

Passo  
6-28-67

# ACTION

DATE

COMMITTEE *No hearing necessary*

M.A.P.C. *No hearing necessary*

B.C.C. ~~RECEIVED~~ *Accepted* 7-5-67

*Closed 7-5-67*

DEDICATION REPORT AND PROGRESS

MAP No. N-OW-A  
SEC. No. 33  
TWP. No. 28S  
RANGE 1W

CASE No. D -0358

I. OFFER TO DEDICATE: 20' additional half-street R/W for the west side of  
GENERALLY LOCATED: Ridge Road, 1/4 mile south of 63rd Street South

LEGALLY DESCRIBED AS:

DEDICATED BY: Abbott Laboratories  
AGENT: Bill Abbott  
ADDRESS: P. O. Box 754 67201 PHONE \_\_\_\_\_  
PURPOSE OF DEDICATION:

Required in connection with Case No. SCZ-0205

II. SKETCH.

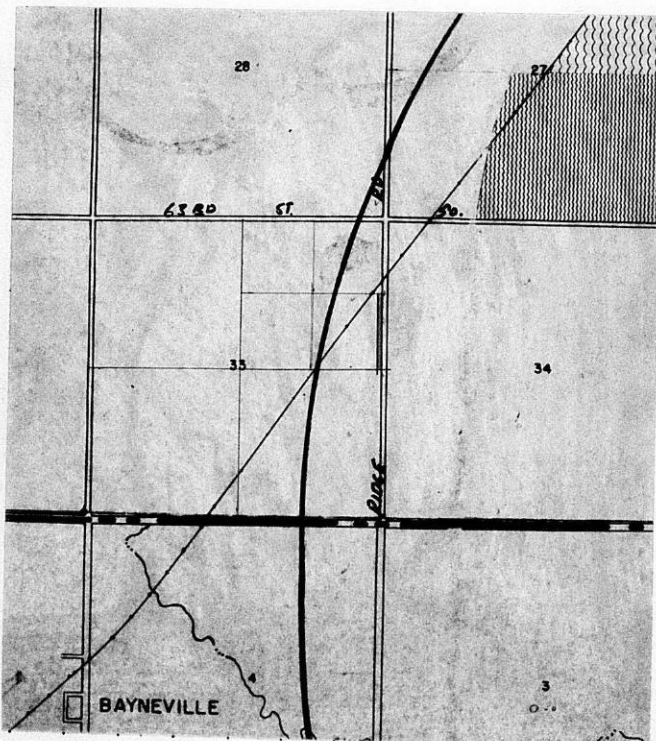

III. FILED 6-23-67  
POSTED TO ATLAS  
S/D COMM. ACTION No hearing necessary  
M.A.P.C. ACTION No hearing necessary

B.C.C. ACTION 7-5-67 *Accepted*  
PLACED ON RECORD  
CITY CLERKS No. \_\_\_\_\_

Dedication of: street right-of-way

MAPC Case No. D-0358

Dedicated by: Abbott Laboratories

Approved by MAPC: N/A

General Location: 20' additional half-street right-of-way for the west side  
of Ridge Road, 1/4 mile south of 63rd Street South

Reason for Acceptance: Required in connection with zoning

City Manager's Recommendation: Accept the Dedication and instruct  
the City Clerk to file with the Register of Deeds.

D E D I C A T I O N

KNOW ALL MEN BY THESE PRESENTS:

That for and in consideration of the sum of One Dollar (\$1.00) and other good and valuable considerations, the receipt of which is hereby acknowledged, the undersigned, Abbott Laboratories

being the owner of the following described real estate in Sedgwick County, Kansas, to wit:

Beginning at a point 30 feet west of the northeast corner of the SE $\frac{1}{4}$  of the NE $\frac{1}{4}$  of Section 33, Township 28 South, Range 1 West of the 6th P.M.; thence south parallel to the east line of said SE $\frac{1}{4}$  of the NE $\frac{1}{4}$  to the south line of the NE $\frac{1}{4}$  of Section 33, Township 28 South, Range 1 West; thence west 20 feet; thence north to a point 20 feet west of the point of beginning; thence east to the point of beginning

do~~es~~ hereby dedicate the above described real estate to the public for

Street purposes.

Executed this 15th day of June 19 67.

ATTEST

Abbott Laboratories

[Signature]  
Secretary  
Illinois  
STATE OF KANSAS )  
SEDGWICK COUNTY ) ss  
Lake

By: [Signature]

BE IT REMEMBERED, that on this 15th day of June, 1967

came James W. Milnes, Vice President of Abbott Laboratories

to me personally known to be the same person who executed the foregoing instrument and duly acknowledged the execution of the same.

IN WITNESS WHEREOF, I have hereunto subscribed my name and affixed my official seal, the day and year last above written.

Submitted to the Wichita-Sedgwick County Metropolitan Area Planning Commission and the Board of Commissioners of the City of Wichita, Kansas, and approved by said Board of Commissioners of the City of Wichita, Kansas,  
this \_\_\_\_\_  
City Clerk

[Signature]  
Notary Public

My Commission Expires: 2-6-71

Book 603  
Page 83