

D-0611 - Leisure Living Ventures
dedicates for utility easement
on the north side of 13th St. in
an area west of Rock Road.

POSTED
10-18-74

ACTION

	DATE
S/D COMMITTEE	11-7-74
M.A.P.C.	11-14-74
B.C.C. / REDACTED	11-26-74

DEDICATION REPORT AND PROGRESS

MAP No. 5949
SEC. No. 7
TWP. No. 27S
RANGE 2E

CASE No. D - 0611

I. OFFER TO DEDICATE: utility easement
GENERALLY LOCATED: On the north side of 13th Street in an area west of Rock Road

LEGALLY DESCRIBED AS:

The west 5.00 ft. of Lot 38, the east 5.00 ft. of Lot 45, the north 5.00 ft. of Lot 49, the west 5.00 ft. of Lot 70, the east 5.00 ft. of Lots 77 and 78, the south 5.00 ft. of Lot 83, the west 15.00 ft. of Lots 83, 84 and 85, the north 5.00 ft. of Lot 85, the north 5.00 ft. of Lot 93, the west 5.00 ft. of Lot 99 and the west 5.00 ft. of Lots 113 and 114.

DEDICATED BY: Leisure Living Ventures First Add. to City of Wichita, Kansas.

AGENT: Leisure Living Ventures by Norwin Development Corp.

ADDRESS: _____ PHONE _____

PURPOSE OF DEDICATION: _____

utility easement

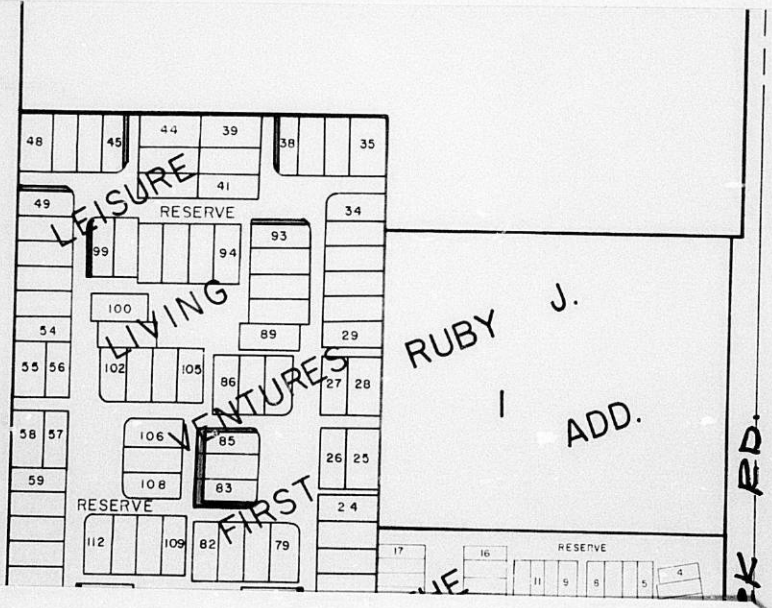

III. FILED 10-7-74
POSTED TO ATLAS yes
S/D COMM. ACTION 11-7-74 accepted
M.A.P.C. ACTION 11-14-74 accepted

B.C.C. ACTION 11-26-74 accept
PLACED ON RECORD _____
CITY CLERKS No. _____

MAP No. 5949
SEC. No. 7
TWP. No. 27S
RANGE 2E

1. OFFER TO DEDICATE: utility easement
GENERALLY LOCATED: On the north side of 13th Street in an area west of Rock Road

LEGALLY DESCRIBED AS:

The west 5.00 ft. of Lot 38, the east 5.00 ft. of Lot 45, the north 5.00 ft. of Lot 49, the west 5.00 ft. of Lot 70, the east 5.00 ft. of Lots 77 and 78, the south 5.00 ft. of Lot 83, the west 15.00 ft. of Lots 83, 84 and 85, the north 5.00 ft. of Lot 85, the north 5.00 ft. of Lot 93, the west 5.00 ft. of Lot 99 and the west 5.00 ft. of Lots 113 and 114, all in Leisure Living Ventures First Add. to City of Wichita, Kansas.

DEDICATED BY: Leisure Living Ventures First Add. to City of Wichita, Kansas.

AGENT: Leisure Living Ventures by Norwin Development Corp.

ADDRESS: _____ PHONE _____

PURPOSE OF DEDICATION: _____

utility easement

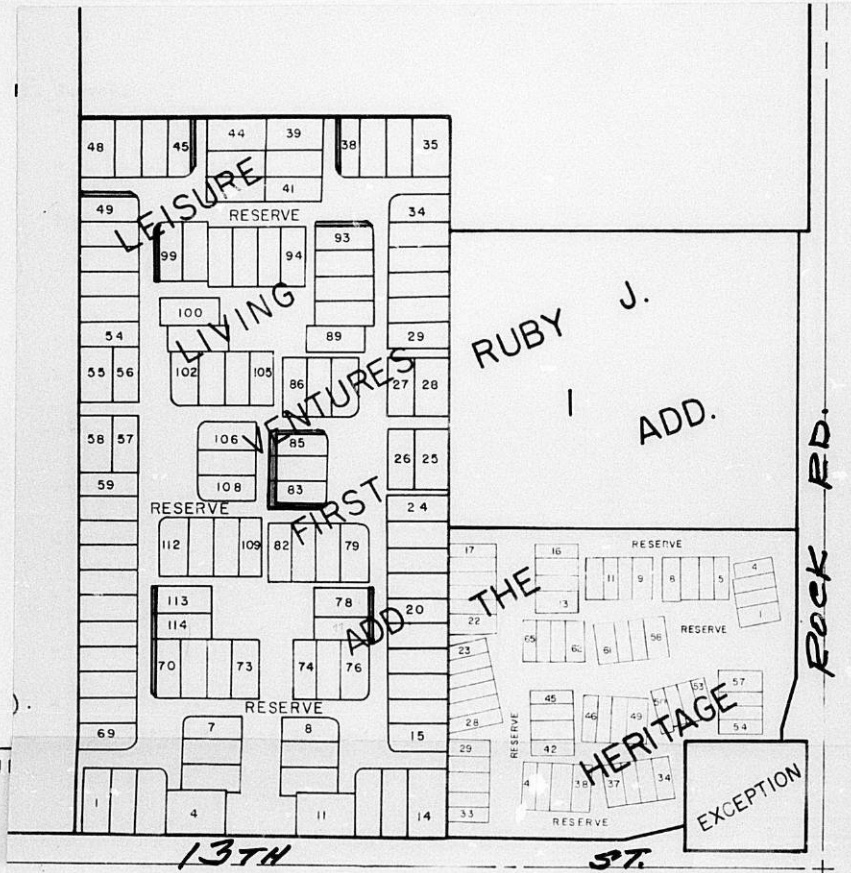

MAPC CASE NO. D-0611 Dedication of utility easement

Dedicated by: Leisure Living Ventures by
Norwin Development Corp.
Generally located on the north side of 13th Street
in an area west of Rock Road

This dedication is given for the following reason: utility easement

ACTION: Accept the dedication and instruct the City Clerk to
file with the Register of Deeds.

T9-325



ARCHITECTS - ENGINEERS
VAN DOREN - HAZARD - STALLINGS
250 ROCKBOROUGH BUILDING, 260 NORTH ROCK ROAD WICHITA, KANSAS 67206
TELEPHONE 316 686-7303

August 26, 1974

Re: Leisure Living Ventures
First Addition
Easement Dedications
Our Job No. 4-073-007 A0

Wichita-Sedgwick County
Metropolitan Area Planning Dept.
104 South Main Street
City Building Annex
Wichita, Kansas 67202

Attn: Mr. Curtis Newby

Dear Mr. Newby:

Submitted herewith are additional easement dedications
within Leisure Living Ventures First Addition.

These easements were requested by the Gas Service
Company for the construction of gas lines within the project.

Very truly yours,

John E. Lundblade

John E. Lundblade

JEL:et



EASEMENT

THIS EASEMENT MADE THIS 21st DAY OF August, 1974, BY AND BETWEEN Leisure Living Ventures by Norwin Development Corporation OF THE FIRST PART AND THE CITY OF WICHITA, OF THE SECOND PART.

WITNESSETH: THAT THE SAID FIRST PARTIES, IN CONSIDERATION OF THE SUM OF ONE DOLLAR (\$1.00) AND OTHER VALUABLE CONSIDERATION, THE RECEIPT WHEREOF IS HEREBY ACKNOWLEDGED, DO HEREBY GRANT AND CONVEY UNTO THE SAID SECOND PARTY A PERPETUAL RIGHT-OF-WAY AND EASEMENT FOR THE PURPOSE OF CONSTRUCTING, MAINTAINING, AND REPAIRING SEWER AND ALL OTHER PUBLIC UTILITIES, OVER, ALONG AND UNDER THE FOLLOWING DESCRIBED REAL ESTATE SITUATED IN SEDGWICK COUNTY, KANSAS, TOWIT:

The west 5.00 feet of Lot 38, the east 5.00 feet of Lot 45, the north 5.00 feet of Lot 49, the west 5.00 feet of Lot 70, the east 5.00 feet of Lots 77 and 78, the south 5.00 feet of Lot 83, the west 15.00 feet of Lots 83, 84 and 85, the north 5.00 feet of Lot 85, the north 5.00 feet of Lot 93, the west 5.00 feet of Lot 99 and the west 5.00 feet of Lots 113 and 114, all in Leisure Living Ventures First Addition to the City of Wichita, Kansas.

AND SAID SECOND PARTY IS HEREBY GRANTED THE RIGHT TO ENTER UPON SAID PREMISES AT ANY TIME FOR THE PURPOSE OF CONSTRUCTING, OPERATING, MAINTAINING, AND REPAIRING SUCH SEWER AND ALL OTHER PUBLIC UTILITIES.

IN WITNESS WHEREOF: THE SAID FIRST PARTIES HAVE SIGNED THESE PRESENTS THE DAY AND YEAR FIRST WRITTEN.



LEISURE LIVING VENTURES by Norwin Development Corp. N. Lee Aronfeld, President

STATE OF KANSAS) SEDGWICK COUNTY) SS

PERSONALLY APPEARED BEFORE ME A NOTARY PUBLIC IN AND FOR THE COUNTY AND STATE AFORESAID N. Lee Aronfeld

TO ME PERSONNALLY KNOWN TO BE THE SAME PERSON WHO EXECUTED THE FORE-GOING INSTRUMENT OF WRITING AND SAID PERSON DULY ACKNOWLEDGED THE EXECUTION THEREOF.

DATED AT WICHITA, KANSAS, THIS 22nd DAY OF August, 1974.

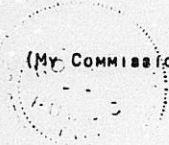

(My Commission Expires April 24, 1978)

Notary Public