

D-0639 - Board of Park Commissioners dedicates drainage r-o-w at SE corner 9th and Edgemoor

*ROUTED
9-19-75*

ACTION

DATE

COMMITTEE

N/A

M.A.P.C.

N/A

~~B.C.C./B~~

Completed

9-2-75

MAP No. 5848
 MAP No. 5948
 SEC. No. 18
 TWP. No. 27
 RANGE 2E

DEDICATION REPORT AND PROGRESS

CASE No. D - 0639

I. OFFER TO DEDICATE: Drainage right of way
 GENERALLY LOCATED: SE corner 9th and Edgemoor

LEGALLY DESCRIBED AS:

The south 20 feet of the north 340 feet of the east
 313 feet of the SE Quarter, Sec. 13, Twp. 27S, R1E of
 the 6th P.M.

DEDICATED BY: Board of Park Commissioners
 AGENT: G. H. Weckel
 ADDRESS: 104 S. Main PHONE _____
 PURPOSE OF DEDICATION: _____

II. SKETCH.

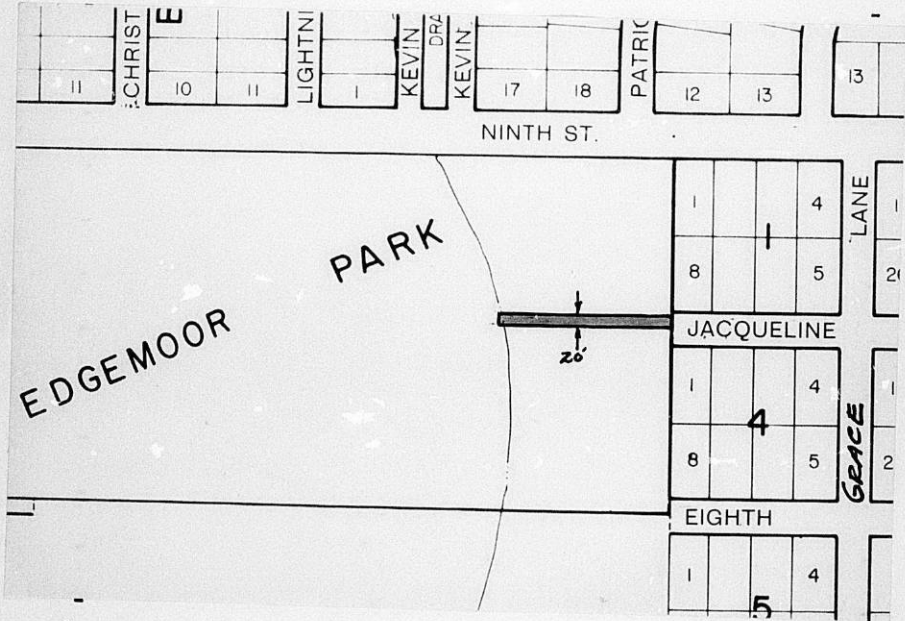

III. FILED 6-9-75
 POSTED TO ATLAS YES
 S/D COMM. ACTION _____
 M.A.P.C. ACTION _____
 B.C.C. ACTION 9-2-75
 PLACED ON RECORD _____
 CITY CLERKS No. _____

DRAINAGE EASEMENT

THIS EASEMENT made this 25th day of August, 1975,
by and between BOARD OF PARK COMMISSIONERS, City of Wichita, of the first part
and the City of Wichita on the second part.

WITNESSETH: That the said first party, in consideration of the sum
of One Dollar (\$1.00) and other valuable consideration, the receipt whereof is
hereby acknowledged, do hereby grant and convey unto the said second party a perpetual
right-of-way and easement for the purpose of constructing, maintaining, and repairing
drainage system according to the plans and specifications now on file in the office
of the City Engineer of the City of Wichita, Kansas, over, along and under the following
described real estate situated in Sedgwick County, Kansas; to wit:

The south twenty (20) feet of the north three hundred forty (340) feet of the
east three hundred thirteen (313) feet of the west half of the Southeast Quarter,
Section 13, Township 22-South, Range 1 East of the 6th P.M.

And said second party is hereby granted the right to enter upon said premises
at any time for the purpose of constructing, operating, maintaining, and repairing
such drainage system.

IN WITNESS WHEREOF: The said first party has signed these presents
the _____ day of _____ 1975.



BOARD OF PARK COMMISSIONERS
CITY OF WICHITA, KANSAS

[Signature]
Clerk

[Signature]
First Vice President

STATE OF KANSAS }
SEDGWICK COUNTY } SS

Personally appeared before me, a notary public, in and for the County and
State aforesaid Mrs. Nancy Woodard, First Vice-President, Board of Park Commissioners,
to me personally known to be the same person who executed the foregoing
instrument of writing and said person duly acknowledged the execution thereof.

Dated at Wichita, Kansas, this 25th day of August, 1975.

[Signature]
Notary Public

My Commission Expires February 17, 1978



THE CITY OF WICHITA
OFFICE OF Park Board

DATE August 26, 1975

TO Curtis L. Newby, Junior Planner, City Planning Dept.

FROM Thomas P. Allen, Jr., Director of Parks

SUBJECT Corrected Drainage Easement
- Edgemoor Park Branch
Library Addition

Following up on the memorandum, dated August 13, 1975, received from Mr. Darrell R. Brewer, Right-of-Way and Estimating Engineer for the City Engineering Department, we attach hereto an executed copy of the Drainage Easement with the corrected description for the Edgemoor Park Branch Library Addition.

This corrected Drainage Easement was presented to the Board of Park Commissioners at its regular meeting held yesterday, August 25, and approved. It supersedes the Drainage Easement approved by the Park Board on June 9, 1975.

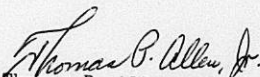
--Thomas P. Allen, Jr.
Director of Parks

TPA:WB
Att.

cc: Darrell R. Brewer
Right-of-Way and
Estimating Engineer
City Engr. Dept.

Terry L. Pardo
Park Board Engineer



DRAINAGE EASEMENT

THIS EASEMENT made this 9th day of June, 1975, by and between BOARD OF PARK COMMISSIONERS, City of Wichita, Kansas of the first part and the City of Wichita on the second part.

WITNESSETH: That the said first party, in consideration of the sum of One Dollar (\$1.00) and other valuable consideration, the receipt whereof is hereby acknowledged, do hereby grant and convey unto the said second party a perpetual right-of-way and easement for the purpose of constructing, maintaining, and repairing drainage system according to the plans and specifications now on file in the office of the City Engineer of the City of Wichita, Kansas, over, along and under the following described real estate situated in Sedgwick County, Kansas; to wit:

The south twenty (20) feet of the north three hundred forty (340) feet of the east three hundred thirteen (313) feet of the Southeast Quarter, Section 13, Township 27 South, Range 1 East of the 6th R.M.

And said second party is hereby granted the right to enter upon said premises at any time for the purpose of constructing, operating, maintaining, and repairing such drainage system.

IN WITNESS WHEREOF: The said first party has signed these presents the day and year first written.

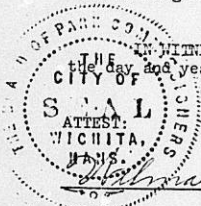

William Burble
Clerk

BOARD OF PARK COMMISSIONERS
CITY OF WICHITA, KANSAS

By: G. H. Weckel
President

STATE OF KANSAS }
SEDGWICK COUNTY } SS

Personally appeared before me, a notary public, in and for the County and State aforesaid G. H. Weckel, President, Board of Park Commissioners, Wichita, Kansas, to me personally known to be the same person who executed the foregoing instrument of writing and said person duly acknowledged the execution thereof.

Dated at Wichita, Kansas, this 9th day of June, 1975.

Gale E. Pennock
Notary Public

My Commission Expires My commission expires Feb. 17, 1978

