

ACTION

S/D	COMMITTEE	DATE
	<u>accept</u>	<u>8-21-75</u>
	M.A.P.C. <u>accept</u>	<u>8-28-75</u>
	B.C.C. AB <u>C. Cluept</u>	<u>9-9-75</u>

D-0643 - Hazel Tanksley
Dedicates drainage easement
generally located on the south-
east corner of 61st St. north
and Hoover Road.

5154
MAP No. Y-1-D
SEC. No. 14-NW 1/4
TWP. No. T-26-S
RANGE 1-W

DEDICATION REPORT AND PROGRESS

CASE No. D - 0643

- I. OFFER TO DEDICATE: perpetual r-o-w of drainage easement
GENERALLY LOCATED: southeast corner of 61st Street north and Hoover Road.

LEGALLY DESCRIBED AS:

See application

DEDICATED BY: Hazel Tanksley

AGENT:

ADDRESS:

PHONE

PURPOSE OF DEDICATION:

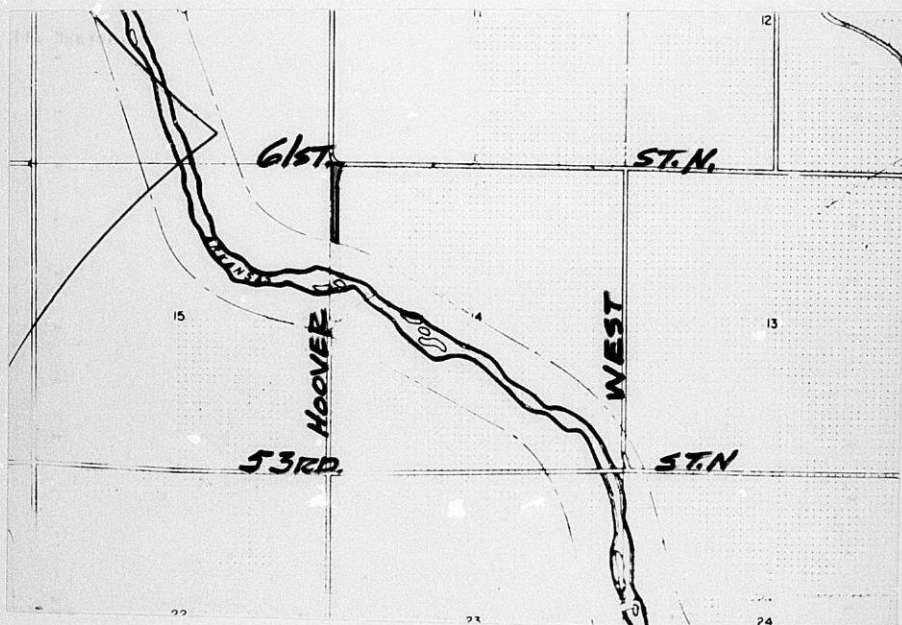

III. FILED

POSTED TO ATLAS YES

S/D COMM. ACTION accepted 8-21-75

M.A.P.C. ACTION accept 8-28-75

B.C.C. ACTION 9-9-75 Accepted

PLACED ON RECORD

CITY CLERKS No.

MAPC CASE NO. D-0643 Dedication of Drainage easement

Dedicated by: Hazel Tanksley

Generally Southeast corner of 61st Street
 North and Hoover Road.

This dedication is given for the following reason:
 perpetual right-of-way of drainage easement

ACTION: Accept the dedication and instruct the City Clerk to
 file with the Register of Deeds.

T9-325

DRAINAGE EASEMENT

THIS EASEMENT made this _____ day of _____, 19____,
by and between _____
of the first part and the City of Wichita of the second part.

WITNESSETH: That the said first part _____, in consideration
of the sum of One Dollar (\$1.00) and other valuable consideration,
the receipt whereof is hereby acknowledged, the undersigned

_____ being the owner of the following
described real estate in Sedgewick County, Kansas to wit:

A tract of land in the NW 1/4 of Section 14, T-26-S, R-1-W of the 6th P.M., Sedgewick County
Kansas described as follows: Beginning at the SW corner of the NW 1/4 of Section 14, thence
S00°28' W along the west line of said NW 1/4, a distance of 135.00 ft. to the north
right-of-way line of the Arkansas River Levees; thence S61°51' E along said right-of-way line
a distance of 80.72 feet; thence N00°28' E parallel to and 80 feet normaly distant from
the west line of said NW 1/4, a distance of 220.37 feet; thence N03°47'47" E a distance of
220.37 feet; thence N89°10'10" E a distance of 91.80 feet; thence N62°20'10" E a distance
of 141.90 feet to a point on the north line of said NW 1/4; thence N89°10'10" W along
said north line, a distance of 112.00 feet to the NE corner of said NW 1/4, and point
of beginning; said tract containing 2.72 acres, more or less.

do hereby grant and convey unto the said second party a
perpetual right-of-way and easement for the purpose of construct-
ing, maintaining, and repairing drainage system according to the
plans and specifications now on file in the City-County Flood
Control Office of the City of Wichita.

And said second party is hereby granted the right to enter
upon said premises at any time for the purpose of constructing,
operating, maintaining, and repairing such drainage system.

IN WITNESS WHEREOF: The said first part _____ has signed
these presents the day and year first written.

STATE OF KANSAS) ss
SEDGWICK COUNTY)

Personally appeared before me a notary public in and for the
County and State aforesaid _____

to me personally known to be the same person _____ who executed the
foregoing instrument of writing and said person _____ duly acknowledged
the execution thereof.

Dated at Wichita, Kansas, this _____ day of _____, 19____.



Notary Public
(M. E. Mitchell)

My Commission expires _____