

POSTED
12-23-75

ACTION

DATE

COMMITTEE

M.A.P.C.

~~B.C.C.~~ ~~7B-60-67~~

12-23-75

Chang-Teel

D-0666 - Earl M. Sayler, etal
dedicates Abutter's Access Rights
generally located on the south
side of Brunswick Lane and the
east side of Northwest Parkway

DEDICATION REPORT AND PROGRESS

MAP No. 4949
SEC. No. 9
TWP. No. 27S
RANGE 1W

CASE No. D - 0666

I. OFFER TO DEDICATE: Abutter's Access Rights
GENERALLY LOCATED: on the south side of Brunswick Lane and the east side of Northwest Parkway.

LEGALLY DESCRIBED AS:

Lots 1, 2, 3 and 4, Block X, Westridge Village Addition, Sedgwick County, Kansas

DEDICATED BY: Earl M. and Carmelita M. Sayler

AGENT: _____

ADDRESS: _____

PHONE _____

PURPOSE OF DEDICATION: _____

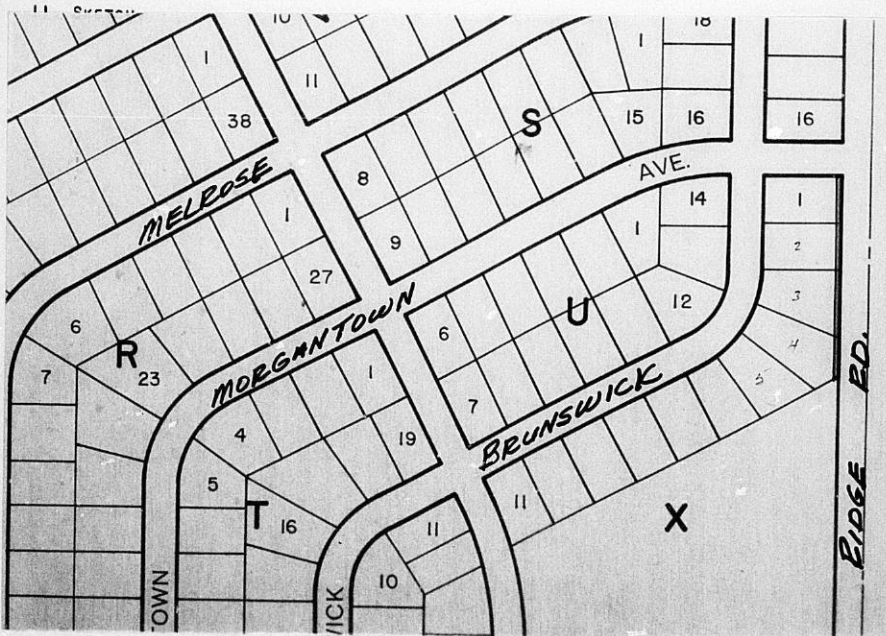

III. FILED 12-18-75
POSTED TO ATLAS _____
S/D COMM. ACTION N/A YES
M.A.P.C. ACTION N/A

B.C.C. ACTION Accepted 1-13-75
PLACED ON RECORD _____
CITY CLERKS No. _____

MAPC CASE NO. D-0666 Dedication of Abutter's Access Rights

Dedicated by: Earl M. & Carmelita M. Sayler

Generally on the south side of Brunswick Lane and the east side of Northwest Parkway.

This dedication is given for the following reason: Requirement of zone case approval.

ACTION: Accept the dedication and instruct the City Clerk to file with the Register of Deeds.

T9-325

D-0666
map 4949
9
273
105

DEDICATION OF ABUTTER'S ACCESS RIGHTS

KNOW ALL MEN BY THESE PRESENTS:

That for and in consideration of the sum of One Dollar (\$1.00) and other good and valuable considerations, the receipt of which is hereby acknowledged, the undersigned, Earl M. Sayler and Carmelita M. Sayler, his wife, being the owners of the following described real estate in Sedgwick County, Kansas, to-wit:

Lots 1, 2, 3 and 4, Block X, Westridge Village Addition, Sedgwick County, Kansas.

do hereby transfer and convey to the City of Wichita, Kansas, all abutter's rights of access, ingress and egress to said property from or to Ridge Road over and across the east line of Lots 1, 2, 3 and 4, Block X, Westridge Village Addition; to have and to hold the same forever. It being understood that this conveyance is a covenant running with the land and prohibits all subsequent owners thereof and all members of the public from entering upon said Lots 1, 2, 3 and 4, Block X, Westridge Village Addition, from Ridge Road.

EXECUTED this 20 day of November, 19 75.

Earl M. Sayler
Carmelita M. Sayler

State of Kansas
Sedgwick County ss:

BE IT REMEMBERED that on this 20 day of November, 19 75, before me a notary public in and for the said County and State, came Earl M. Sayler and Carmelita M. Sayler, his wife, to me personally known to be the same persons who executed the foregoing instrument and duly acknowledged the execution of the same.

IN WITNESS WHEREOF, I have hereunto subscribed my name and affixed my official seal, the day and year last above written.

Carl O. Beall
Notary Public

My Commission Expires:
April 14, 1978