

*POSTED
4-5-76
[Signature]*

D-0678 - Harold J. Gregg, et al
Dedicates easement of Sewer &
public utilities - northwest
corner Perry & 32nd St. North

ACTION

	DATE
S/D COMMITTEE	<u>4-8-76</u>
M.A.P.C.	<u>4-15-76</u>
B.C.C./ B.C.C.	<u>5-4-76</u>

accept

Approved

accept

DEDICATION REPORT AND PROGRESS

MAP No. 5351
 SEC. No. 31
 TWP. No. 27
 RANGE 1E

CASE No. D - 0678

I. OFFER TO DEDICATE: Easement of sewer and public utilities
 GENERALLY LOCATED: northwest corner Perry and 32nd St. North

LEGALLY DESCRIBED AS:

DEDICATED BY: Harold J. Gregg and I. Ann Gregg
 AGENT: _____
 ADDRESS: _____ PHONE _____
 PURPOSE OF DEDICATION:

II. SKETCH

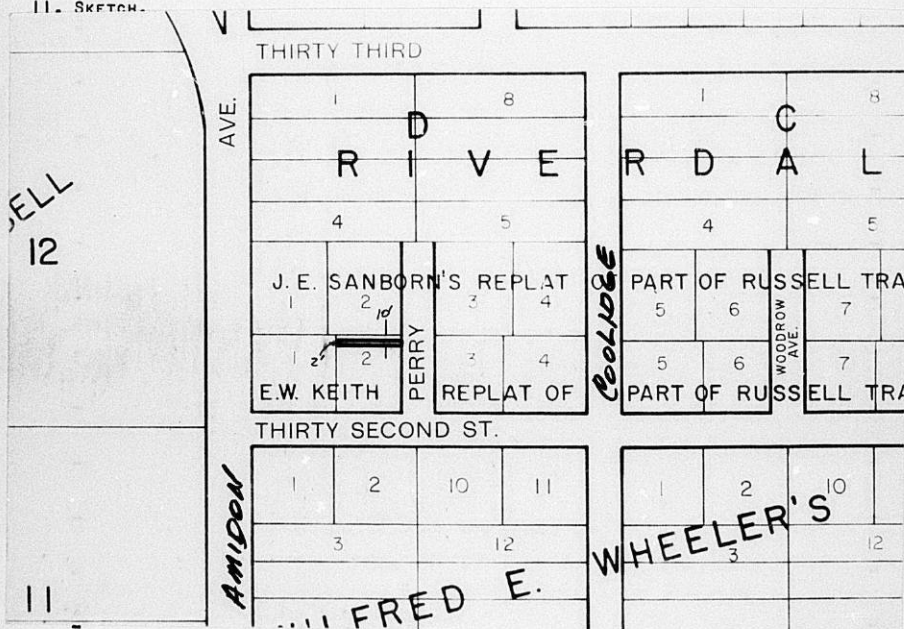

III. FILED 3-23-76
 POSTED TO ATLAS 4-1-76
 S/D COMM. ACTION 4-8-76 *accept*
 M.A.P.C. ACTION 4-15-76 *Approved*

B.C.C. ACTION 5/4/76 *accept*
 PLACED ON RECORD _____
 CITY CLERKS No. _____

MAPC CASE NO.

D-0678

Dedication of

easement of sewer and
public utilities

Dedicated by:

Harold J. and I. Ann Gregg

Generally

located at northwest corner of
Perry and 32nd Street North

This dedication is given for the following reason:

Required in lot split approval.

ACTION:

Accept the dedication and instruct the City Clerk to
file with the Register of Deeds.

T9-325

5317
31
27
16

D-0678

EASEMENT

THIS EASEMENT MADE THIS 22 DAY OF March, 1976,
BY AND BETWEEN Harold J. Gregg and T. Ann Gregg
OF THE FIRST PART AND THE CITY OF WICHITA, OF THE SECOND PART.

WITNESSETH: THAT THE SAID FIRST PART we, IN CONSIDERATION OF THE
SUM OF ONE DOLLAR (\$1.00) AND OTHER VALUABLE CONSIDERATION, THE RECEIPT
WHEREOF IS HEREBY ACKNOWLEDGED, DO HEREBY GRANT AND CONVEY UNTO THE SAID
SECOND PARTY A PERPETUAL RIGHT-OF-WAY AND EASEMENT FOR THE PURPOSE OF
CONSTRUCTING, MAINTAINING, AND REPAIRING SEWER AND ALL OTHER PUBLIC UTIL-
ITIES, OVER, ALONG AND UNDER THE FOLLOWING DESCRIBED REAL ESTATE SITUATED
IN SEDGWICK COUNTY, KANSAS, TOWIT:

The South 2' of North 10 ft of Lot 2, E. W. Keith
Replat of Part of Russell Tracts, Sedgwick County,
Kansas.

N.W. Cor. Perry - 32nd St. N.

AND SAID SECOND PARTY IS HEREBY GRANTED THE RIGHT TO ENTER UPON
SAID PREMISES AT ANY TIME FOR THE PURPOSE OF CONSTRUCTING, OPERATING,
MAINTAINING, AND REPAIRING SUCH SEWER AND ALL OTHER PUBLIC UTILITIES.

IN WITNESS WHEREOF: THE SAID FIRST PART we have SIGNED THESE
PRESENTS THE DAY AND YEAR FIRST WRITTEN.

Harold J. Gregg
T. Ann Gregg

STATE OF KANSAS)
SEDGWICK COUNTY) SS

PERSONALLY APPEARED BEFORE ME A NOTARY PUBLIC IN AND FOR THE COUNTY
AND STATE AFORESAID Harold J. & T. Ann Gregg

TO ME PERSONNALLY KNOWN TO BE THE SAME PERSON _____ WHO EXECUTED THE FORE-
GOING INSTRUMENT OF WRITING AND SAID PERSON _____ DULY ACKNOWLEDGED THE EXE-
CUTION THEREOF.

DATED AT WICHITA, KANSAS, THIS 22 DAY OF March, 1976.

E. Mullan
NOTARY PUBLIC

(MY COMMISSION EXPIRES June 5, 1976)