

D-0682 - Gardner Land Inc. -  
Dedicates street r-o-w - generally  
located on the East side of  
Amidon in an area north of 21st

# ACTION

POSTED  
4-1-76  
H

COMMITTEE \_\_\_\_\_ DATE \_\_\_\_\_

M.A.P.C. \_\_\_\_\_

B.C.C./B. CO. C. Accepted 4-6-76  
with DP-76

D-0682 - Gardner Land Inc. -  
Dedicates street r-o-w - generally  
located on the East side of  
Amdon in an area north of 21st

DEDICATION REPORT AND PROGRESS

MAP No. 5350  
SEC. No. 6  
TWP. No. 27  
RANGE 1E

CASE No. D - 0682

I. OFFER TO DEDICATE: street right of way  
GENERALLY LOCATED: East side of Amidon in an area north of 21st St.

LEGALLY DESCRIBED AS: \_\_\_\_\_

DEDICATED BY: Gardner Land Incorporated  
AGENT: \_\_\_\_\_  
ADDRESS: \_\_\_\_\_ PHONE \_\_\_\_\_  
PURPOSE OF DEDICATION: \_\_\_\_\_

II. SKETCH.

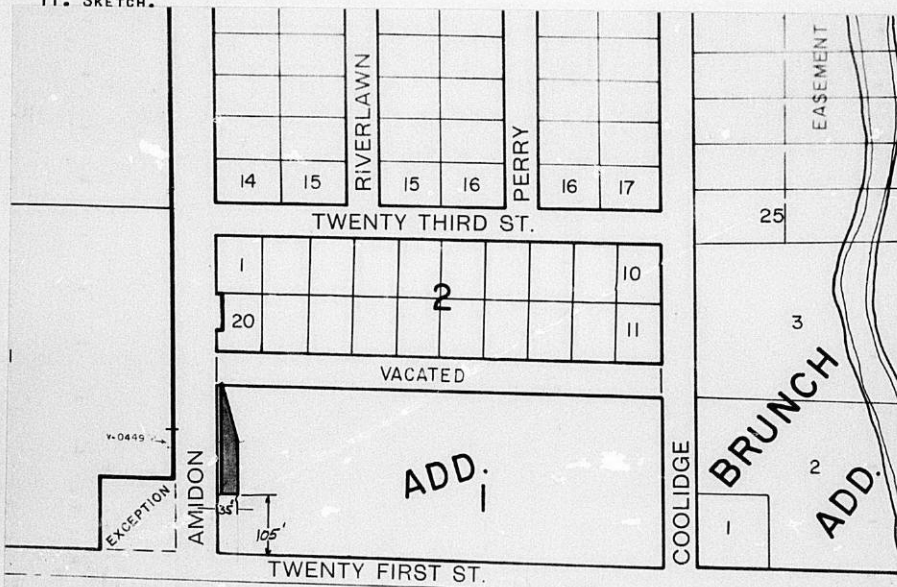

III. FILED <u>3-31-76</u>	B.C.C. ACTION <u>4-6-76</u> <i>Accepted</i>
POSTED TO ATLAS _____	PLACED ON RECORD <u>DP-76</u>
S/D COMM. ACTION _____	CITY CLERKS No. _____
M.A.P.C. ACTION _____	_____

5350  
6  
27  
15

2

D-0682

CONTINGENT DEDICATION

WHEREAS, Gardner Land Incorporated being the owner of Block 1 and Lots 11 through 20 Block 2 and the vacated 22nd Street right-of-way lying adjacent to the above described property all in Gardners Riverlawn Addition; and

WHEREAS, the City of Wichita is requesting that a portion of said property be dedicated to the public for street right-of-way purposes; and

WHEREAS, it is the intention of the owner to dedicate to the public the said requested portion of said property for street purposes in connection with the Commercial Community Unit Plan for the above described property more commonly located at the Northeast Corner of 21st and Amidon, Wichita, Kansas, and that said dedication shall become effective upon the legislative determination of public need by the Board of City Commissioners:

NOW, THEREFORE, Gardner Land Incorporated being the legal owner of the aforesaid property does hereby dedicate to the public for street purposes the following described property:

Beginning at a point thirty-five (35) ft. east and one hundred five (105) ft. north of the Southwest Corner Block 1, Gardners Riverlawn Addition; thence north parallel to and thirty-five (35) ft. east of the west line of said Block 1 a distance of ninety-five (95) ft.; thence northwesterly to a point on the north line of said Block 1 said point being ten (10) ft. east of the Northwest Corner of said Block 1; thence south parallel to and ten (10) ft. east of the west line of said Block 1 to a point one hundred five (105) ft. north and ten (10) ft. east of the Southwest Corner of said Block 1; thence east parallel to the south line of said Block 1 to the point of beginning.

*East side of Amidon in an area north of 21st St*  
The right of the public and the City of Wichita to use, maintain, excavate, fill, pave, or install utilities or to make similar use of said dedicated street right-of-way shall become effective upon the legislative determination of public need by the Board of City Commissioners as hereinabove provided.

It is the intent of the grantors herein that this shall be a covenant running with the land and shall be binding upon the heirs, assigns and successor and upon all subsequent owners of any part or parcel of said property covered by this dedication.

Executed at Wichita, Sedgwick County, Kansas, this 31 day of March, 1976.

GARDNER LAND INCORPORATED

By [Signature]

STATE OF KANSAS)  
SEDGWICK COUNTY) SS

BE IT REMEMBERED, that on this 31 day of March, 1976, before me a Notary Public in and for the said County and State came

F. W. Weirick, President of Gardner Land Incorporated

to me personally known to be the same person who executed the foregoing instrument and duly acknowledged the execution of the same.

IN WITNESS WHEREOF, I have hereunto subscribed my name and affixed my official seal, the day and year last above written.

[Signature]  
Notary Public

My Commission expires April 30 1977