

D-0685 - Leon Robinson, etal  
dedicates Utility Easement - east  
of Minneapolis in an area south  
of 47th Street South

# ACTION

*POSTED*

*4-19-76*

		DATE
S/D COMMITTEE	<u><i>accept</i></u>	<u><i>5-6-76</i></u>
M.A.P.C.	<u><i>Accepted</i></u>	<u><i>5-13-76</i></u>
B.C.C./B. CO. C.	<u><i>Accepted</i></u>	<u><i>6-1/76</i></u>

D-0685 - Leon Robinson, et al  
dedicates Utility Easement - east  
of Minneapolis in an area south  
of 47th Street South

DEDICATION REPORT AND PROGRESS

MAP No. 5641  
SEC. No. 22  
TWP. No. 28  
RANGE 14

CASE No. D - 0685

1. OFFER TO DEDICATE: Utility Easement  
GENERALLY LOCATED: east of Minneapolis in an area south of 47th St. South.

LEGALLY DESCRIBED AS:

DEDICATED BY: Leon and Pauline Robinson  
AGENT: \_\_\_\_\_  
ADDRESS: \_\_\_\_\_ PHONE \_\_\_\_\_  
PURPOSE OF DEDICATION: \_\_\_\_\_

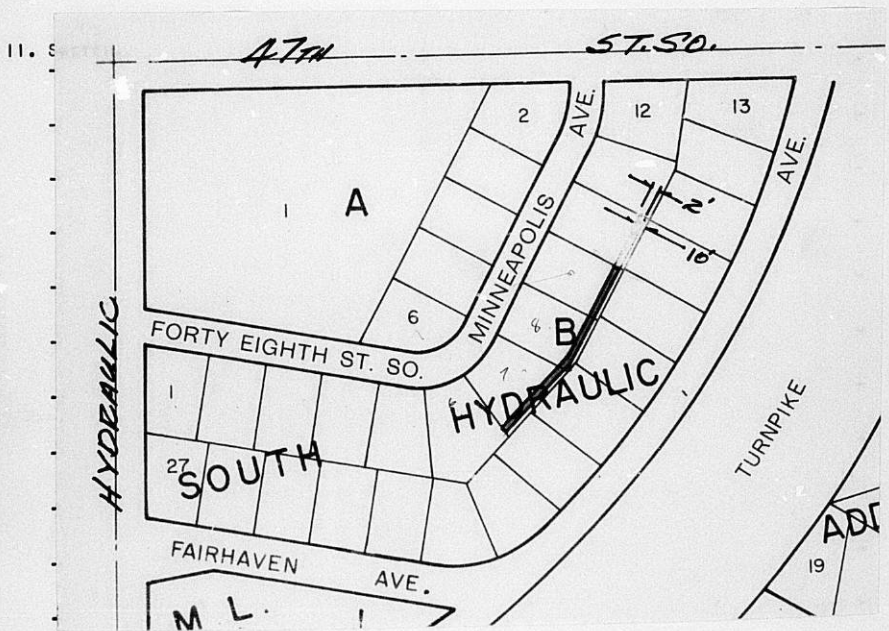

FILED <u>4-15-76</u>	B.C.C. ACTION <u>4/17/76 Accepted</u>
POSTED TO ATLAS	PLACED ON RECORD _____
S/D COMM. ACTION <u>5-6-76</u> <u>accept</u>	CITY CLERKS No. _____
M.A.P.C. ACTION <u>5-13-76</u> <u>Accepted</u>	

MAPC CASE NO. D-0685      Dedication of utility easement

Dedicated by:    Leon and Pauline Robinson

Generally      located east of Minneapolis in an  
                         area south of 47th Street South

This dedication is given for the following reason:

ACTION:            Accept the dedication and instruct the City Clerk to  
                         file with the Register of Deeds.

T9-325

5641  
22  
28  
14

D-0685

EASEMENT

THIS EASEMENT MADE THIS 9<sup>th</sup> DAY OF April, 1976,  
BY AND BETWEEN Leon & Pauline Robinson  
OF THE FIRST PART AND THE CITY OF WICHITA, OF THE SECOND PART.

WITNESSETH: THAT THE SAID FIRST PARTIES, IN CONSIDERATION OF THE SUM OF ONE DOLLAR (\$1.00) AND OTHER VALUABLE CONSIDERATION, THE RECEIPT WHEREOF IS HEREBY ACKNOWLEDGED, DO HEREBY GRANT AND CONVEY UNTO THE SAID SECOND PARTY A PERPETUAL RIGHT-OF-WAY AND EASEMENT FOR THE PURPOSE OF CONSTRUCTING, MAINTAINING, AND REPAIRING SEWER AND ALL OTHER PUBLIC UTILITIES, OVER, ALONG AND UNDER THE FOLLOWING DESCRIBED REAL ESTATE SITUATED IN SEDGWICK COUNTY, KANSAS, TOWIT:

*West two feet of the east ten feet of  
lots 7-8-9 of South Hydraulic Park 2<sup>nd</sup>  
addition (Block B) Wichita, Sedgwick  
County, Kansas*

"AA"

AND SAID SECOND PARTY IS HEREBY GRANTED THE RIGHT TO ENTER UPON SAID PREMISES AT ANY TIME FOR THE PURPOSE OF CONSTRUCTING, OPERATING, MAINTAINING, AND REPAIRING SUCH SEWER AND ALL OTHER PUBLIC UTILITIES.

IN WITNESS WHEREOF: THE SAID FIRST PARTIES HAVE SIGNED THESE PRESENTS THE DAY AND YEAR FIRST WRITTEN.

Leon Robinson  
Pauline Robinson

STATE OF KANSAS )  
SEDGWICK COUNTY) SS

PERSONALLY APPEARED BEFORE ME A NOTARY PUBLIC IN AND FOR THE COUNTY AND STATE AFORESAID Leon and Pauline Robinson

TO ME PERSONALLY KNOWN TO BE THE SAME PERSONS WHO EXECUTED THE FOREGOING INSTRUMENT OF WRITING AND SAID PERSONS DULY ACKNOWLEDGED THE EXECUTION THEREOF.

DATED AT WICHITA, KANSAS, THIS 14 DAY OF April, 1976.  
RICHARD OWEN  
NOTARY PUBLIC  
SEDGWICK COUNTY, KANSAS  
MY APPT. EXP. 11-4-77  
(My Commission Expires \_\_\_\_\_)  
Richard Owen  
NOTARY PUBLIC