

D-0726 - Wichita Land Company
Dedicates sanitary sewer pump
station - generally located at the
northwest corner of 21st St. No.

POSTED
9-27-76
[Signature]

ACTION

	DATE
S/D COMMITTEE	<u>accept</u> 10-7-76
M.A.P.C.	<u>Accept</u> 10-24-76
B.C.C./ D.C.C.	<u>Accept</u> 11-9-76

DEDICATION REPORT AND PROGRESS

MAP No. 5950
 SEC. No. 6
 TWP. No. 27S
 RANGE 2E

CASE No. D - 0726

I. OFFER TO DEDICATE: Sanitary Sewer Pump Station
 GENERALLY LOCATED: northwest corner of 21st St. North and Rock Road.

LEGALLY DESCRIBED AS:

DEDICATED BY: Wichita Land Company
 AGENT: _____
 ADDRESS: _____ PHONE _____
 PURPOSE OF DEDICATION: _____

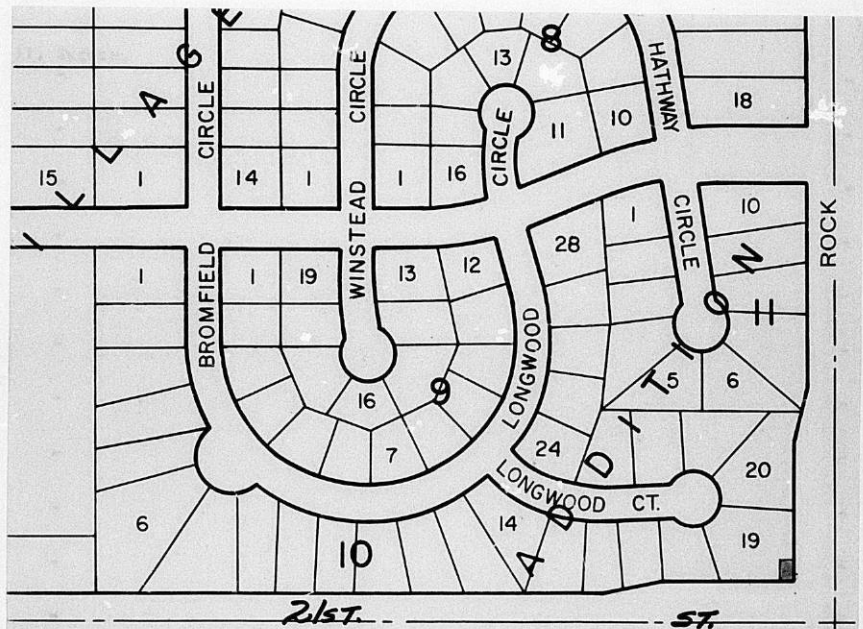

III. FILED 9-23-76
 POSTED TO ATLAS _____
 S/D COMM. ACTION 10-7-76 *accept*
 M.A.P.C. ACTION 10-14-76 *accept*
 B.C.C. ACTION 11-9-76 *Accept*
 PLACED ON RECORD _____
 CITY CLERKS No. _____

MAPC CASE NO. D-072 Dedication of sanitary sewer pump station

Dedicated by: Wichita Land Company

Generally located at the northwest corner of 21st Street
North and Rock Road

This dedication is given for the following reason:

ACTION: Accept the dedication and instruct the City Clerk to
file with the Register of Deeds.

BILL RECORDING FEE TO:

5950
6
275
2E

DEDICATION

D-0726

KNOW ALL MEN BY THESE PRESENTS:

That for and in consideration of the sum of One Dollar (\$1.00) and other good and valuable considerations, the receipt of which is hereby acknowledged, the undersigned, WICHITA LAND COMPANY

being the owner of the following described real estate in Sedgwick County, Kansas, to wit:

A parcel of land located in the S.E. one-quarter of the S.E. one-quarter of Section 6, Township 27 South, Range 2 East of the 6th P.M. described as follows: *n. W. cor. 21st & Rock Rd.*

Beginning at the northwest corner of 21st Street North and Rock Road; thence along the north right-of-way line of 21st Street North bearing S 89° 12' 25" W, 20.00 feet; thence parallel with west right-of-way line of Rock Road N 1° 01' 02" W, 35.00 feet; thence parallel with the north line of 21st Street North N 89° 12' 25" E, 20.00 feet to a point on the west right-of-way line of Rock Road; thence south along said west line S 1° 01' 02" E, 35.00 feet to the point of beginning. Containing .016 acres, more or less.

do hereby dedicate the above described real estate to the public for sanitary sewer pump station purposes.

Executed this 21 day of Sept, 1976.

Philip M. Snodgrass
Pres.
Wichita Land Co.

STATE OF KANSAS)
SEDGWICK COUNTY)^{SS}

BE IT REMEMBERED, that on this 21st day of September, 1976
came Philip M. Snodgrass

to me personally known to be the same person who executed the foregoing instrument and duly acknowledged the execution of the same.

IN WITNESS WHEREOF, I have hereunto subscribed my name and affixed my official seal, the day and year last above written.

Submitted to the Wichita-Sedgwick County Metropolitan Area Planning Commission and the Board of Commissioners of the City of Wichita, Kansas, and approved by said Board of Commissioners of the City of Wichita, Kansas,

this _____,

City Clerk

Marilynn C. Parr
Notary Public

My Commission Expires: March 20, 1978