

D-0753 - Ritchie Bros. Construction Co., dedicates street r-o-w S.E. Corner Central & Ridge Rd.

*posted  
2-24-77  
[Signature]*

# ACTION

DATE

COMMITTEE \_\_\_\_\_

M.A.P.C. \_\_\_\_\_

B.C.C./B. CO. C. accept 11-2-76

DEDICATION REPORT AND PROGRESS

MAP No. 5047  
SEC. No. 22  
TWP. No. 27S  
RANGE 1W

CASE No. D - 0753

I. OFFER TO DEDICATE: Street R-0-W  
GENERALLY LOCATED: southeast corner Central and Ridge Road

LEGALLY DESCRIBED AS:

DEDICATED BY: E.D., H.D., and J.P. Ritchie, d/b/a Ritchie Brothers Con-  
AGENT: struction Co.  
ADDRESS: \_\_\_\_\_ PHONE \_\_\_\_\_  
PURPOSE OF DEDICATION:

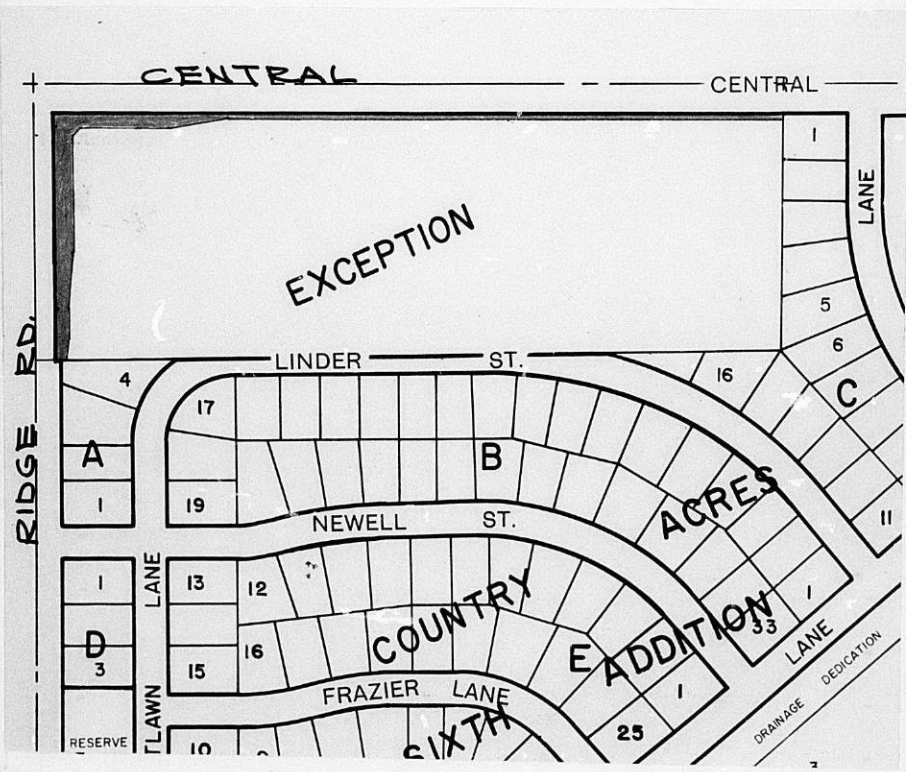

III. FILED 2-14-77 \_\_\_\_\_ B.C.C. ACTION 11-2-76 approve  
 POSTED TO ATLAS \_\_\_\_\_  
 S/D COMM. ACTION \_\_\_\_\_ PLACED ON RECORD \_\_\_\_\_  
 CITY CLERK No. \_\_\_\_\_  
 M.A.P.C. ACTION \_\_\_\_\_

5047  
22  
275  
1W

DEDICATION

Tr. 25  
D-0753

BY MEN BY THESE PRESENTS:

That for and in consideration of the sum of One Dollar (\$1.00) and other good and valuable considerations, the receipt of which is hereby acknowledged, the undersigned, E.D. RITCHIE, H.D. RITCHIE, AND J.P. RITCHIE, D/B/A RITCHIE BROTHERS CONSTRUCTION CO.

being the owner S of the following described real estate in Sedgwick County, Kansas, to wit:

Beginning at the Northwest corner of Section 22, T 27 S, R 1 W of the 6th P.M.; thence East along the North line of said Section 22 to the Northeast corner of the N.W. 1/4, of the N.W. 1/4 of said Section 22; thence South along the East line of the N.W. 1/4 of the N.W. 1/4 of said Section 22 a distance of 60 feet; thence West parallel to and 60 feet from the North line of said Section 22 to a point 350 feet East and 60 feet South of the Northwest corner of said Section 22; thence Southwesterly to a point 250 feet East and 75 feet South of the Northwest corner of said Section 22; thence West parallel to and 75 feet from the North line of said Section 22, to a point 90.40 feet East and 75 feet South of the Northwest corner of said Section 22; thence Southwesterly to a point 90.40 feet South and 75 feet East of the Northwest corner of said Section 22; thence South parallel to and 75 feet from the West line of said Section 22 to a point 300.15 feet South and 75 feet East of the Northwest corner of said Section 22; thence Southwesterly to a point 400 feet South and 65 feet East of the Northwest corner of said Section 22; thence South parallel to and 65 feet from the West line of said Section 22 to a point 455 feet South and 65 feet East of the Northwest corner of said Section 22; thence Southwesterly to a point in the North line of Block A, Country Acres 6th Addition, said point also being 500.15 feet South and 60 feet East of the Northwest corner of said Section 22; thence West along the North line of Block A extended West to a point in the West line of said Section 22; thence North along the West line of Section 22 to the point of beginning. Except the North 50 feet and the West 40 feet thereof for street purposes. The above description containing 30,229 square feet more or less.

The north 10 feet of Lot 1, Block C, Country Acres Sixth Addition, Sedgwick County, Kansas. Containing 1200.0 square feet more or less.

The West 10.0 feet of Lots 1, 2, 3, and 4; Block A; Country Acres Sixth Addition, Sedgwick County, Kansas. Containing 2942.8 square feet more or less.

do hereby dedicate the above described real estate to the public for street purposes.

Executed this 6TH day of OCTOBER, 1976.

Original Compared With Record

ENTERED ON TRANSFER RECORD  
NOV 10 1976  
GEORGE PERCE COUNTY CLERK  
APPROVED BY BOARD OF COMMISSIONERS  
NOV 2 1976  
STATE OF KANSAS SEDGWICK COUNTY  
FILED FOR RECORD AT  
NOV 10 1976  
3 03187  
BETTE F. MCCARTY REGISTER OF DEEDS

RITCHIE BROTHERS CONSTRUCTION CO,  
Ritchie Brothers Construction Co.  
E. D. Ritchie  
H. D. Ritchie  
J. P. Ritchie

STATE OF KANSAS)  
SEDGWICK COUNTY) SS

BE IT REMEMBERED, that on this 6TH day of OCTOBER, 1976, before me a Notary Public in and for the said County and State came E.D. RITCHIE, H.D. RITCHIE, AND J.P. RITCHIE D/B/A RITCHIE BROTHERS CONSTRUCTION CO

to me personally known to be the same person S who executed the foregoing

SE. Cor Central + Bldg. Rd.

5.00 City Clerk

instrument and duly acknowledged the execution of the same.

IN WITNESS WHEREOF, I have hereunto subscribed my name and affixed by official seal, the day and year last above written.

  
Notary Public  
R. K. ESHELMAN



Commission Expires: 6-28-77