

D-0777 - Kenneth R. Swenson, et al
dedicates Abutter's Access Rights-
Northeast corner W. Central and
Woodchuck Lane.

POSTED
7-28-77
[Signature]

ACTION

DATE

COMMITTEE

M.A.P.C.

B.C.C./B-GO-C

Accepted

8-2-77

MAP No. 4948
SEC. No. 16
TWP. No. 27S
RANGE 1W

DEDICATION REPORT AND PROGRESS

CASE No. D - 0777
(Associated Z-1938)

I. OFFER TO DEDICATE: ABUTER'S ACCESS RIGHTS
GENERALLY LOCATED: Northeast corner of W. Central and Woodchuck Lane

LEGALLY DESCRIBED AS: _____

DEDICATED BY: Kenneth R. Swenson, et al
AGENT: _____
ADDRESS: _____ PHONE _____
PURPOSE OF DEDICATION: _____

II. SKETCH.

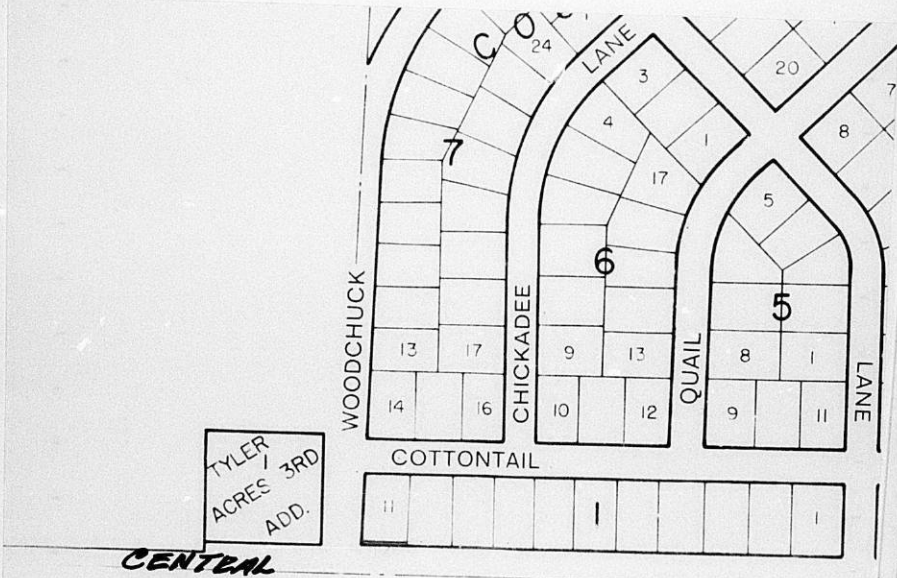

III. FILED 7-25-77
POSTED TO ATLAS _____
S/D COMM. ACTION _____
M.A.P.C. ACTION _____

B.C.C. ACTION 8-2-77 *Completed*
PLACED ON RECORD _____
CITY CLERKS No. _____

4948
16
278
105

DEDICATION OF ABUTTER'S ACCESS RIGHTS

D-0777
(assn. Z-1938)

KNOW ALL MEN BY THESE PRESENTS:

That for an in consideration of the sum of One Dollar (\$1.00) and other good and valuable considerations; the receipt of which is hereby acknowledged, the undersigned Kenneth R. Swenson and Leora P. Swenson, his wife, being the owners of the follow described real estate in Sedgwick County, Kansas, to-wit:

Lot 11, Block 1, Country Acres, Sedgwick County, Kansas,

NE Cor W. Central Woodchuck Fr

do hereby transfer and convey to the City of Wichita, Kansas, all abutter's rights of access, ingress and egress to said property from or to Central Avenue over and across the south line of Lot 11, Block 1, County Acres; to have and to hold the same forever. It being understood that this conveyance is a covenant running with the land and prohibits all subsequent owners thereof and all members of the public from entering upon said Lot 11, Block 1, Country Acres, from Central Avenue.

EXECUTED this 16 day of June, 1977.

Kenneth R. Swenson
Leora P. Swenson

AA Young

State of Kansas
Sedgwick County ss:

BE IT REMEMBERED that on this 16th day of June, 1977, before me a notary public in and for the said County and State, came Kenneth R. Swenson and Leora P. Swenson, his wife, to me personally known to be the same persons who executed the foregoing instrument and duly acknowledged the execution of the same.

IN WITNESS WHEREOF, I have hereunto subscribed my name and affixed my official seal, the day and year last above written.

Glen L. Lawman
Notary Public

My Commission Expires:

