

Pos 100
9-9-77

ACTION

COMMITTEE _____ DATE _____

M.A.P.C. _____

B.C.C./B. CO.-G. Refer 2 weeks 9-13-77

Bcc Community Case 7-27-77
2-1935 returned
to MARE

Bcc 2-1935 Denial 1-31-75

Alto

D-0783 - V. L. Brotherton, et al-
dedicates Abutter's Access Control
south side of Central, in an area
west of Hillcrest Ave.

MAP No. 5847
 SEC. No. 24
 TWP. No. 27
 RANGE 1E

DEDICATION REPORT AND PROGRESS

CAPE No. D - 0783
 Associated Z-1935

I. OFFER TO DEDICATE: Abutter's Access Control
 GENERALLY LOCATED: South side of Central, in an area west of Hillcrest Ave

LEGALLY DESCRIBED AS:

DEDICATED BY: V. L. Brotherton, et al
 AGENT: _____
 ADDRESS: _____ PHONE _____
 PURPOSE OF DEDICATION: _____

Required as a condition of Z-1935

II. SKETCH.

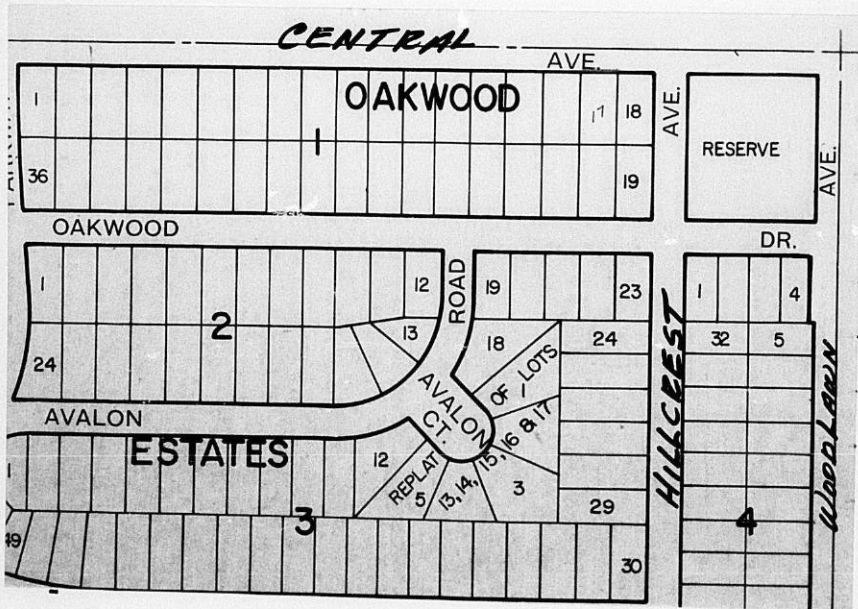

III. FILED 8-31-77
 POSTED TO ATLAS _____
 S/D COMM. ACTION _____
 M.A.P.C. ACTION _____

B.C.C. ACTION 9-13-77 *D. Anderson*
9-27-77 *R. Brown*
 PLACED ON RECORD _____
 CITY CLERKS No. _____

BCC 1-31-78 Z-1935 David

5847
24
27
15

D-0783

DEDICATION
OF
ABUTTER'S ACCESS CONTROL

(Assoc 2-1935)

KNOW ALL MEN BY THESE PRESENTS:

That for and in consideration of the sum of One Dollar (\$1.00) and other good and valuable consideration, the receipt of which is hereby acknowledged, the undersigned V. L. and P. Elaine Brotherton, Husband and Wife, being the owners of the hereinafter described real estate in Sedgwick County, Kansas, does hereby transfer and convey to the City of Wichita all abutter's rights of access, ingress and egress, from, to or upon Central, EXCEPT FOR ONE OPENING adjacent to

the north line of Lot 17, Block 1, Oakwood Estates Second Addition to Wichita, Sedgwick County, Kansas, *at S. side of center in manner west of street and*

to have and to hold the same forever, it being understood that this conveyance is a covenant running with the land.

EXECUTED THIS 29th DAY OF AUGUST, 1977.

V. L. Brotherton

P. Elaine Brotherton

STATE OF KANSAS)
) ss.
SEDGWICK COUNTY)

BE IT REMEMBERED that on this 29th day of AUGUST, 1977, before me, a Notary Public in and for the County and State aforesaid, came P. Elaine and V.L. Brotherton, known personally to me and to be the same person(s) who executed the foregoing instrument and duly acknowledged the execution of same.

IN WITNESS WHEREOF, I have hereunto subscribed my name and affixed my official seal, the day and year last above written.

William E. Carpenter
NOTARY PUBLIC

My Commission Expires:
3rd of March 1979