

*Postcard*  
*9-23-77*  
*[Signature]*

# ACTION

DATE

COMMITTEE \_\_\_\_\_

M.A.P.C. \_\_\_\_\_

B.C.C./B. CO. C. *Appropriate* 10-11-77

D-0789 - Builders, Inc., et al  
Dedicate drainage r-o-w - in an  
area east of Oliver & north of  
Harry.

DEDICATION REPORT AND PROGRESS

MAP No. 5846  
 SEC. No. 25  
 TWP. No. 27S  
 RANGE 1E

CASE No. D - 0789  
 (Associated DP-60)

I. OFFER TO DEDICATE: Drainage r-o-w  
 GENERALLY LOCATED: in an area east of Oliver and North of Harry

LEGALLY DESCRIBED AS: \_\_\_\_\_

DEDICATED BY: Builders, Inc., a Kansas Corporation  
 AGENT: \_\_\_\_\_  
 ADDRESS: \_\_\_\_\_ PHONE \_\_\_\_\_  
 PURPOSE OF DEDICATION: \_\_\_\_\_

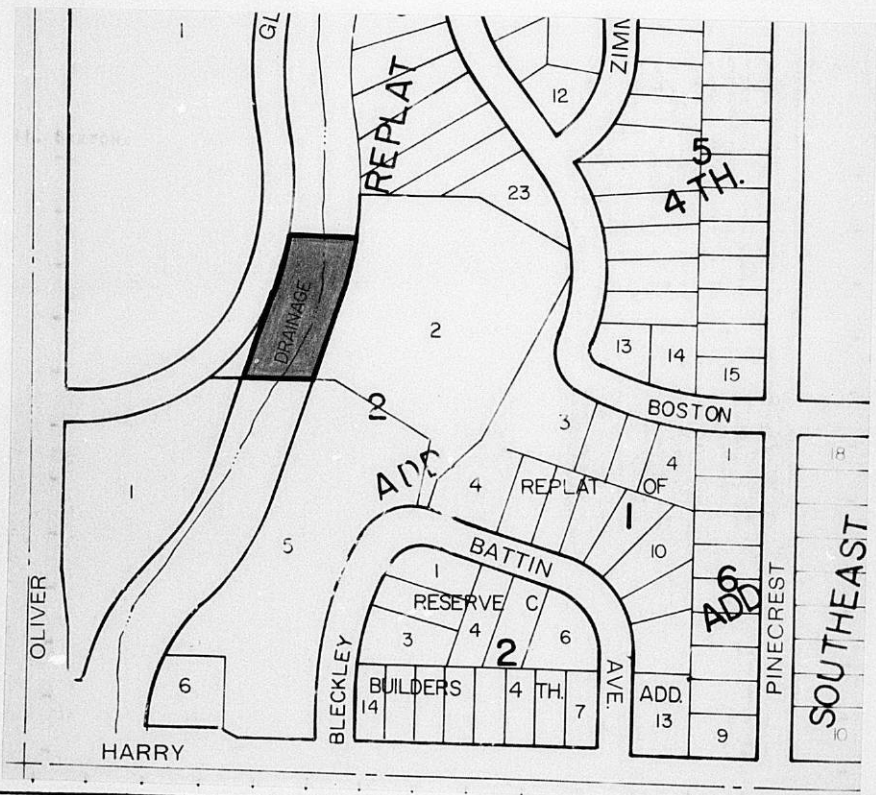

III. FILED 9-19-77 B.C.C. ACTION 10-11-77 Accepted  
 POSTED TO ATLAS \_\_\_\_\_ PLACED ON RECORD \_\_\_\_\_  
 S/D COMM. ACTION \_\_\_\_\_ CITY CLERK'S No. \_\_\_\_\_  
 H.A.P.C. ACTION \_\_\_\_\_

*Associated with DP-60*

D E D I C A T I O N

KNOW ALL MEN BY THESE PRESENTS:

That for and in consideration of the sum of One Dollar (\$1.00) and other good and valuable considerations, the receipt of which is hereby acknowledged, the undersigned, Builders, Inc., a Kansas corporation

being the owner of the following described real estate in Sedgwick County, Kansas, to wit:  
A portion of Lot 2, Block 2, Parklane Addition, Wichita, Kansas, described as beginning at the northwesterly corner of said Lot 2, which corner falls on the east line of Glendale Avenue as platted in Replat of Part of Builders Fourth Addition, Wichita, Kansas; thence southerly along the east line of Glendale Avenue, along a curve having a radius of 523.14 feet, through a central angle of 7°-34'-30", a distance of 69.16 feet to the P.T. of said curve; thence southerly along tangent to said curve and said tangent extended 209.31 feet to the south line of said Lot 2; thence east with an angle to the left of 106° 50' along said south line 125.37 feet; thence northeasterly with an angle to the left of 73°-10', a distance of 173.0 feet to the P.C. of a curve to the left having a radius of 643.14 feet; thence along said curve and through a central angle of 7°-34'-30" a distance of 85.03 feet; thence westerly along a line radial to said curve 120 feet to the place of beginning. *Except the north 60 feet thereof.*

do es hereby dedicate the above described real estate to the public for Drainage Right-of-Way purposes.

Executed this \_\_\_\_\_ day of \_\_\_\_\_ 19 \_\_\_\_.

STATE OF KANSAS )  
SEDGWICK COUNTY ) ss

BE IT REMEMBERED, that on this \_\_\_\_\_ day of \_\_\_\_\_, came \_\_\_\_\_

to me personally known to be the same person who executed the foregoing instrument and duly acknowledged the execution of the same.

IN WITNESS WHEREOF, I have hereunto subscribed my name and affixed my official seal, the day and year last above written.

Submitted to the Wichita-Sedgwick County Metropolitan Area Planning Commission and the Board of Commissioners of the City of Wichita, Kansas, and approved by said Board of Commissioners of the City of Wichita, Kansas,

this \_\_\_\_\_

City Clerk

Notary Public

My Commission Expires: \_\_\_\_\_

DEDICATION

KNOW ALL MEN BY THESE PRESENTS:

That for and in consideration of the sum of One Dollar (\$1.00) and other good and valuable considerations, the receipt of which is hereby acknowledged, the undersigned, Builders, Inc., a Kansas corporation

being the owner of the following described real estate in Sedgwick County, Kansas, To-wit: A portion of Lot 2, Block 2, Parklane Addition, Wichita, Kansas, described as beginning at the northwesterly corner of said Lot 2, which corner falls on the east line of Glendale Avenue as platted in Replat of Part of Builders Fourth Addition, Wichita, Kansas; thence southerly along the east line of Glendale Avenue, along a curve having a radius of 523.14 feet, through a central angle of 70-34'-30", a distance of 69.16 feet to the P.T. of said curve; thence southerly along tangent to said curve and said tangent extended 209.31 feet to the south line of said Lot 2; thence east with an angle to the left of 106°50' along said south line 125.37 feet; thence northeasterly with an angle to the left of 73°10', a distance of 173.0 feet to the P.C. of a curve to the left having a radius of 643.14 feet; thence along said curve and through a central angle of 70-34'30" a distance of 85.03 feet; thence westerly along a line radial to said curve 120 feet to the place of beginning. Except the north 60 feet thereof.

*This not included 8-28-77*

does hereby dedicate the above described real estate to the public for drainage right-of-way purposes.

Executed this 15th day of September 19 77.

BUILDERS, INC.

By Floyd M. Baird  
Floyd M. Baird  
Executive Vice President

STATE OF KANSAS )  
SEDGWICK COUNTY ) ss

BE IT REMEMBERED, that on this 15th day of September, 1977,  
came Floyd M. Baird, Executive Vice President of Builders, Inc.,  
a Kansas corporation,

to me personally known to be the same person who executed the foregoing instrument and duly acknowledged the execution of the same. as the agent, deed of said corporation and in the capacity aforesaid.  
IN WITNESS WHEREOF, I have hereunto subscribed my name and affixed my official seal, the day and year last above written.



Mary Heggen  
Notary Public

My Commission Expires: 10-17-80

Submitted to the Wichita-Sedgwick County Metropolitan Area Planning Commission and the Board of Commissioners of the City of Wichita, Kansas, and approved by said Board of Commissioners of the City of Wichita, Kansas,

this \_\_\_\_\_,  
\_\_\_\_\_  
City Clerk

map 5846  
3  
275

DEDICATION

D-0789

(Assoc DP-60)

WE KNOW ALL MEN BY THESE PRESENTS:

That for and in consideration of the sum of One Dollar (\$1.00) and other good and valuable considerations, the receipt of which is hereby acknowledged, the undersigned, Builders, Inc., a Kansas corporation

an area east of Blair + north of Harry

being the owner of the following described real estate in Sedgwick County, Kansas, to-wit: A portion of Lot 2, Block 2, Parklane Addition, Wichita, Kansas, described as beginning at the northwesterly corner of said Lot 2, which corner falls on the east line of Glendale Avenue as platted in Replat of Part of Builders Fourth Addition, Wichita, Kansas; thence southerly along the east line of Glendale Avenue, along a curve having a radius of 523.14 feet, through a central angle of 70-34'-30", a distance of 69.16 feet to the P.T. of said curve; thence southerly along tangent to said curve and said tangent extended 209.31 feet to the south line of said Lot 2; thence east with an angle to the left of 106°50' along said south line 125.37 feet; thence northeasterly with an angle to the left of 73°11', a distance of 173.0 feet to the P.C. of a curve to the left having a radius of 643.14 feet; thence along said curve and through a central angle of 70-34'30" a distance of 85.03 feet; thence westerly along a line radial to said curve 120 feet to the place of beginning. Except the north 60 feet thereof.

does hereby dedicate the above described real estate to the public for drainage right-of-way purposes.

Executed this 15th day of September 19 77.

BUILDERS, INC.

By Floyd M. Baird  
Floyd M. Baird  
Executive Vice President

STATE OF KANSAS )  
SEDGWICK COUNTY ) ss

BE IT REMEMBERED, that on this 15th day of September, 1977,  
came Floyd M. Baird, Executive Vice President of Builders, Inc.,  
a Kansas corporation,

to me personally known to be the same person who executed the foregoing instrument and duly acknowledged the execution of the same, as the act and deed of said corporation and in the capacity aforesaid.  
IN WITNESS WHEREOF, I have hereunto subscribed my name and affixed my official seal, the day and year last above written.



Mary Ann  
Notary Public

My Commission Expires: 10-17-80

Submitted to the Wichita-Sedgwick County Metropolitan Area Planning Commission and the Board of Commissioners of the City of Wichita, Kansas, and approved by said Board of Commissioners of the City of Wichita, Kansas,

this \_\_\_\_\_

City Clerk