

D-0790 - Builders, Inc., et al  
Dedicate Street r-o-w - in an  
area east of Oliver & north of  
Harry.

*POSTED  
9-23-77*

**ACTION**

DATE

COMMITTEE \_\_\_\_\_

M.A.P.C. \_\_\_\_\_

B.C.C./B. GO. C. *Approved* \_\_\_\_\_ *10-11-77*

DEDICATION REPORT AND PROGRESS

MAP No. 5846  
SEC. No. 25  
TWP. No. 27S  
RANGE 1E

CASE No. D - 0790  
(Associated DP-60)

I. OFFER TO DEDICATE: Street r-o-w  
GENERALLY LOCATED: in an area east of Oliver and north of Harry

LEGALLY DESCRIBED AS:

DEDICATED BY: Builders, Inc., a Kansas Corporation  
AGENT: \_\_\_\_\_  
ADDRESS: \_\_\_\_\_ PHONE \_\_\_\_\_  
PURPOSE OF DEDICATION: \_\_\_\_\_

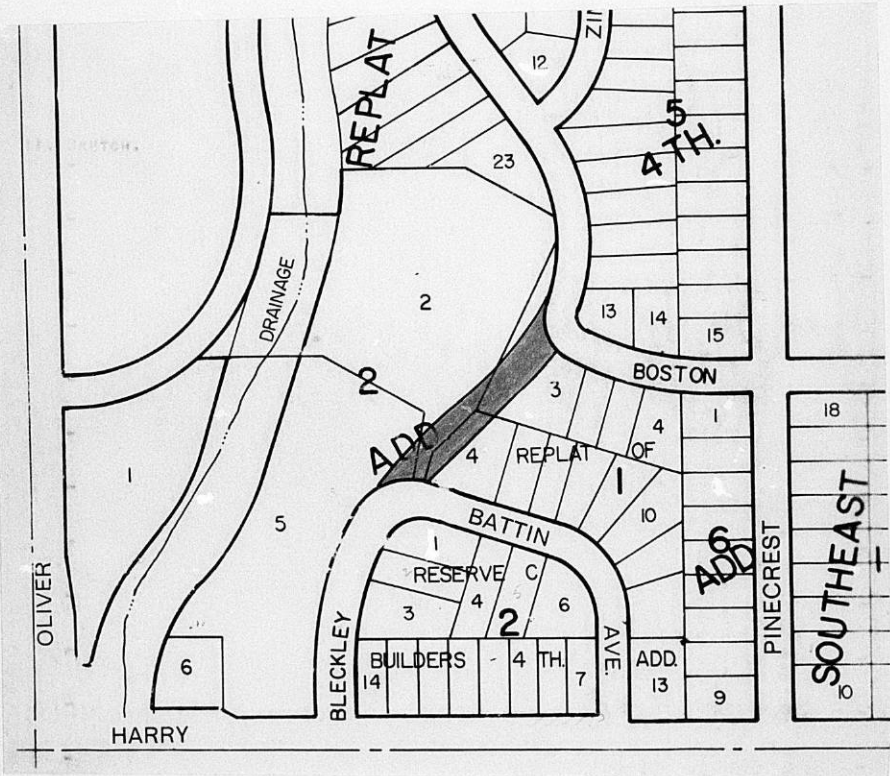

III. FILED <u>9-19-77</u>	B.C.C. ACTION <u>20-11-77</u> <i>Approved</i>
POSTED TO ATLAS _____	PLACED ON RECORD _____
S/D COMM. ACTION _____	CITY CLERKS No. _____
M.A.P.C. ACTION _____	_____

*Associated with DP-60*

DEDICATION

KNOW ALL MEN BY THESE PRESENTS:

That for and in consideration of the sum of One Dollar (\$1.00) and other good and valuable considerations, the receipt of which is hereby acknowledged, the undersigned, BUILDERS, INC. a Kansas Corporation

being the owner of the following described real estate in Sedgwick County, Kansas, to wit:

Part of Lots 2-3-4 and 5, Block 2, Parklane Addition, Wichita, Kansas, being the 60 foot utility easement and described as follows: Commencing at the northeasterly corner of said Lot 3; thence northwesterly along the northerly line of said Lot 3, 49.18 feet for a place of beginning; thence continuing along said northerly line being a curve to the right having a radius of 106.54 feet, a distance of 105.87 feet to the P.C. of a curve; thence southerly along a curve to the right having a radius of 289.92 feet, a distance of 148.54 feet to the point of tangency of said curve; thence southwesterly along tangent of said curve and parallel with northwesterly line of said Lot 4, 214.83 feet to the P.C. of a curve to the left having a radius of 537.47 feet; thence along said curve 124.66 feet to the northwesterly line of Bleckley Drive; thence northeasterly along Bleckley Drive and Battin Avenue, 97.21 feet; thence northeasterly along a curve to the right having a radius of 477.47 feet a distance of 39.03 feet to the point of tangency of said curve; thence northeasterly along tangent of said curve and parallel with the northwesterly line of said Lot 4, 214.83 feet to the P.C. of a curve to the left having a radius of 349.92 feet; thence northerly along said curve, 88.99 feet to the place of beginning.

do es hereby dedicate the above described real estate to the public for street purposes.

Executed this 15th day of September 19 77.

BUILDERS, INC.

By: Floyd M. Baird Executive Vice President

STATE OF KANSAS ) SEDGWICK COUNTY ) ss

BE IT REMEMBERED, that on this 15th day of September,

came Floyd M. Baird, Executive Vice President of Builders, Inc. a Kansas Corporation

to me personally known to be the same person who executed the foregoing instrument and duly acknowledged the execution of the same, as the act and deed of said corporation and in the capacity aforesaid.

IN WITNESS WHEREOF, I have hereunto subscribed my name and affixed my official seal, the day and year last above written.



Mary Helen Green Notary Public

My Commission Expires: 10-17-80

Submitted to the Wichita-Sedgwick County Metropolitan Area Planning Commission and the Board of Commissioners of the City of Wichita, Kansas, and approved by said Board of Commissioners of the City of Wichita, Kansas,

this \_\_\_\_\_

City Clerk

KNOW ALL MEN BY THESE PRESENTS: D-0790  
Case DR60  
MAP 5846  
25  
275  
1E  
That for and in consideration of the sum of One Dollar (\$1.00) and other good and valuable considerations, the receipt of which is hereby acknowledged, the undersigned, BUILDERS, INC. a Kansas Corporation

being the owner of the following described real estate in Sedgwick County, Kansas, to wit:  
Part of Lots 2-3-4 and 5, Block 2, Parklane Addition, Wichita, Kansas, being the 60 foot utility easement and described as follows: Commencing at the northeasterly corner of said Lot 3; thence northwesterly along the northerly line of said Lot 3, 49.18 feet for a place of beginning; thence continuing along said northerly line being a curve to the right having a radius of 106.54 feet, a distance of 105.87 feet to the P.C. of a curve; thence southerly along a curve to the right having a radius of 289.92 feet, a distance of 148.54 feet to the point of tangency of said curve; thence southwesterly along tangent of said curve and parallel with northwesterly line of said Lot 4, 214.83 feet to the P.C. of a curve to the left having a radius of 537.47 feet; thence along said curve 124.66 feet to the northwesterly line of Bleckley Drive; thence northeasterly along Bleckley Drive and Battin Avenue, 97.21 feet; thence northeasterly along a curve to the right having a radius of 477.47 feet a distance of 39.03 feet to the point of tangency of said curve; thence northeasterly along tangent of said curve and parallel with the northwesterly line of said Lot 4, 214.83 feet to the P.C. of a curve to the left having a radius of 349.92 feet; thence northerly along said curve, 88.99 feet to the place of beginning.

*an area east of Blvd. north of Harry*

do es hereby dedicate the above described real estate to the public for \_\_\_\_\_ street \_\_\_\_\_ purposes.

Executed this 15th day of September 19 77.

BUILDERS, INC.  
By: Floyd M. Baird  
Floyd M. Baird  
Executive Vice President

STATE OF KANSAS )  
SEDGWICK COUNTY ) ss

BE IT REMEMBERED, that on this 15th day of September,  
came Floyd M. Baird, Executive Vice President of Builders, Inc. a Kansas Corporation

to me personally known to be the same person who executed the foregoing instrument and duly acknowledged the execution of the same, as the act and deed of said corporation and in the capacity aforesaid.  
IN WITNESS WHEREOF, I have hereunto subscribed my name and affixed my official seal, the day and year last above written.

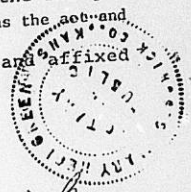

Submitted to the Wichita-Sedgwick County Metropolitan Area Planning Commission and the Board of Commissioners of the City of Wichita, Kansas, and approved by said Board of Commissioners of the City of Wichita, Kansas,

Mary Helen Green  
Notary Public

My Commission Expires: 10-17-80

this \_\_\_\_\_  
\_\_\_\_\_  
City Clerk