

D-0806- C.F. & Juanita McClelland  
dedicate Street r-o-w- southeast  
corner of Bebe & Walker.

*POSTED*  
*1-17-78*

ACTION

DATE

COMMITTEE \_\_\_\_\_

M.A.P.C. \_\_\_\_\_

B.C.C./B. CO. C. *referred to*  
*1-31-78* 1-17-78

*Bcc* *Approved* 4-4-78

MAP No. 5146  
 SEC. No. 26  
 TWP. No. 27  
 RANGE 1W

DEDICATION REPORT AND PROGRESS

CASE No. D - 0806

(Assoc. Z-2003)

I. OFFER TO DEDICATE: Street r-o-w  
 GENERALLY LOCATED: Southeast corner of Bebe & Walker

LEGALLY DESCRIBED AS: \_\_\_\_\_

DEDICATED BY: C. F. & Juanita McClelland  
 AGENT: \_\_\_\_\_  
 ADDRESS: \_\_\_\_\_ PHONE \_\_\_\_\_  
 PURPOSE OF DEDICATION: \_\_\_\_\_

II. SKETCH.

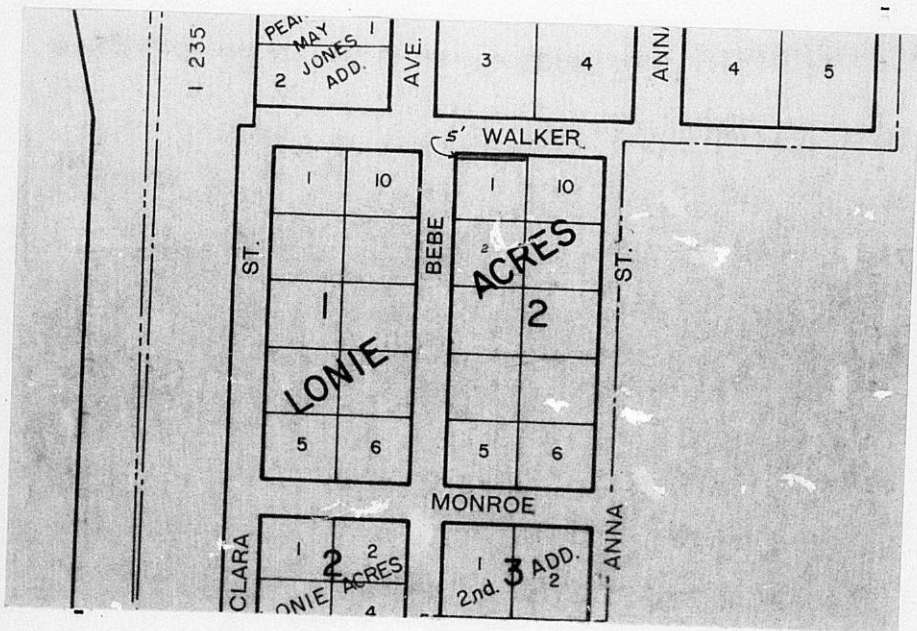

iii. FILED 1-6-78  
 POSTED TO ATLAS \_\_\_\_\_  
 S/D COMM. ACTION \_\_\_\_\_  
 M.A.P.C. ACTION \_\_\_\_\_

B.C.C. ACTION 1-17-78 *defer to 1/31/78*  
 PLACED ON RECORD *see 4-28 approved*  
 CITY CLERK'S No. \_\_\_\_\_

5146  
26  
27  
1W

DEDICATION

D-0806  
2-2003

KNOW ALL MEN BY THESE PRESENTS:

That for and in consideration of the sum of One Dollar (\$1.00) and other good and valuable considerations, the receipt of which is hereby acknowledged, the undersigned, C. F. and Juanita McClelland

being the owners of the following described real estate in Sedgwick County, Kansas, to wit:

North five feet of Lot 1, Block 2, Lonie Acres, Sedgwick County, Kansas.

*SE. cor. Beber + Walker*

do        hereby dedicate the above described real estate to the public for street purposes.

Executed this 2nd day of JANUARY 19 78.

C. F. McClelland  
Juanita McClelland

STATE OF KANSAS )  
SEDGWICK COUNTY ) ss

BE IT REMEMBERED, that on this 2nd day of January, 1978

came C. F. and Juanita McClelland

to me personally known to be the same persons who executed the foregoing instrument and duly acknowledged the execution of the same.

IN WITNESS WHEREOF, I have hereunto subscribed my name and affixed my official seal, the day and year last above written.

Submitted to the Wichita-Sedgwick County Metropolitan Area Planning Commission and the Board of Commissioners of the City of Wichita, Kansas, and approved by said Board of Commissioners of the City of Wichita, Kansas,  
this \_\_\_\_\_,  
\_\_\_\_\_  
City Clerk

Phyllis C. White  
Notary Public

My Commission Expires: 12-2-79

PHYLLIS C. WHITE  
NOTARY PUBLIC  
Sedgwick County, Kansas  
My Appt. Exp. 12-2-79