

D-0848 - Larry Lusk, et al grants
Street R-O-W - on the east side of
Wilson Dr., between 71st St. South
and Harrall St.

10-1-78
10-3-78
10-21

ACTION

DATE

COMMITTEE _____

M.A.P.C. _____

~~B.C.C.~~ / B.I.C.O. C. *Completed* _____ *11-1-78*

5838

Book 4

MAP No. 0-8-D
SEC. No. 1
TWP. No. 29
RANGE 1E

DEDICATION REPORT AND PROGRESS

CASE No. D - 0848

(SCZ-0401)

I. OFFER TO DEDICATE: Street r-o-w
GENERALLY LOCATED: on the east side of Nelson Drive, between 71st St. South and Harrall St.

LEGALLY DESCRIBED AS:

DEDICATED BY: Larry Lusk, et al
AGENT: _____
ADDRESS: _____
PURPOSE OF DEDICATION: _____ PHONE _____

II. SKETCH.

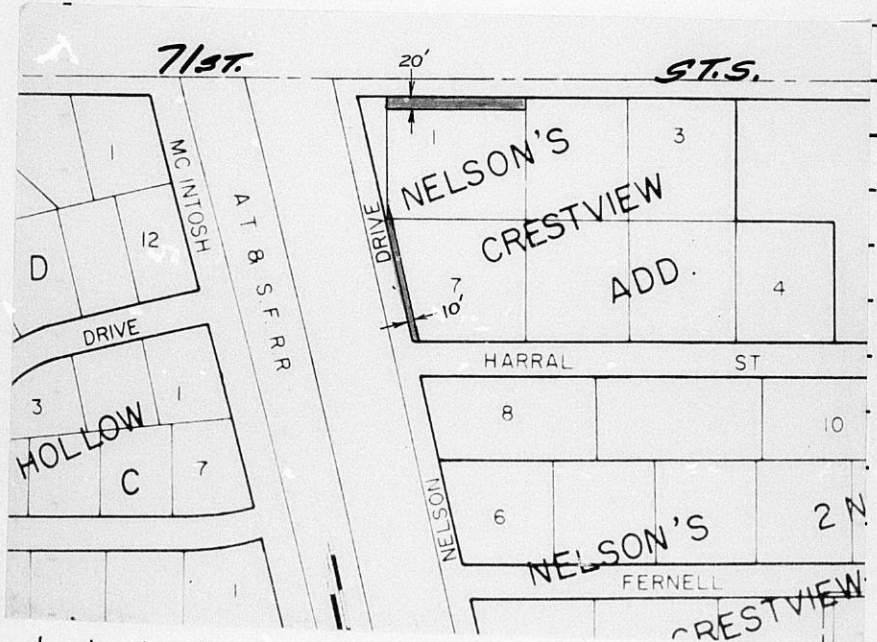

III. FILED 10-2-78
POSTED TO ATLAS _____
S/D COMM. ACTION _____
M.A.P.C. ACTION _____

B&C.C. ACTION 11-1-78 Accepted
PLACED ON RECORD _____
CITY CLERKS No. _____

November 9, 1978

Donald C. Gsick, City Clerk

G. Lynn Shirkey, Junior Planner

✓ D-0848 - Street Dedication; and
SCZ-0401 - Zone change "R-1" to "LC"

Attached is a dedication of street right-of-way which was accepted by the Board of County Commissioners at their meeting of November 1, 1978, as a condition of zone change approval for a tract of land lying outside of Wichita's three-mile ring.

Please file with the Register of Deeds and advise our office of the filing date so that the resolution effectuating the zone change may be published.

Charge the filing cost to the Planning Department, account number 755-68-360-50000-295-000-000.

G. Lynn Shirkey
Junior Planner

GLS:el

Att.

DEDICATION

KNOW ALL MEN BY THESE PRESENTS:

That for and in consideration of the sum of One Dollar (\$1.00) and other good and valuable considerations, the receipt of which is hereby acknowledged, the undersigned, Larry Lusk and Marilyn J. Lusk

being the owner_s of the following described real estate in Sedgwick County, Kansas, to wit:

West 10 feet and north 20 feet of Lot 7 and Lot 1, Nelson's Crestview Addition, except a triangular tract of ground beginning at the NW corner of said Lot 1; thence SEly along the W line of said lot; being the east line of said Nelson Drive as platted; to SW corner of said Lot, thence N to point on N line, 50' E to point of beginning; thence west along said north line, 50' to place of beginning deeded to the State of Kansas, for highway.

do hereby dedicate the above described real estate to the public for street purposes.

Executed this _____ day of _____ October 1978.

[Signature]
Marilyn J. Lusk

STATE OF KANSAS)
SEDGWICK COUNTY) ss

BE IT REMEMBERED, that on this 10th day of October,
came Larry Lusk and Marilyn J. Lusk

to me personally known to be the same person_s who executed the foregoing instrument and duly acknowledged the execution of the same.

IN WITNESS WHEREOF, I have hereunto subscribed my name and affixed my official seal, the day and year last above written.

~~Submitted to the Wichita-Sedgwick County Metropolitan Area Planning Commission and the Board of Commissioners of the City of Wichita, Kansas, and approved by said Board of Commissioners of the City of Wichita, Kansas,
this _____
City Clerk~~

Judith Ann Seal
Notary Public
JUDITH ANN SEAL
STATE NOTARY PUBLIC
SEDGWICK COUNTY, KANSAS
MY APPT. EXP. 2/28/81
My Commission Expires



Book 4
0-8-D

1
29
1E

DEDICATION

D-0848

(Assoc. SCZ-04 01)

KNOW ALL MEN BY THESE PRESENTS:

That for and in consideration of the sum of One Dollar (\$1.00) and other good and valuable considerations, the receipt of which is hereby

acknowledged, the undersigned, Larry Lusk and Marilyn J. Lusk

being the owner_s of the following described real estate in Sedgwick County, Kansas, to wit:

West 10 feet and north 20 feet of Lot 7 and Lot 1, Nelson's Crestview Addition, except a triangular tract of ground beginning at the NW corner of said Lot 1; thence SEly along the W line of said lot; being the east line of said Nelson Drive as platted; to SW corner of said Lot, thence N to point on N line, 50' E to point of beginning; thence west along said north line, 50' to place of beginning deeded to the State of Kansas, for highway.

do _____ hereby dedicate the above described real estate to the public for _____ street _____ purposes.

Executed this _____ day of _____ October _____ 1978 .

STATE OF KANSAS)
SEDGWICK COUNTY)^{ss}

BE IT REMEMBERED, that on this _____ day of _____ October _____, came Larry Lusk and Marilyn J. Lusk

to me personally known to be the same person_s who executed the foregoing instrument and duly acknowledged the execution of the same.

IN WITNESS WHEREOF, I have hereunto subscribed my name and affixed my official seal, the day and year last above written.

Submitted to the Wichita-Sedgwick County Metropolitan Area Planning Commission and the Board of Commissioners of the City of Wichita, Kansas, and approved by said Board of Commissioners of the City of Wichita, Kansas,

this _____, _____

City Clerk

Notary Public

My Commission Expires: _____

Larry Lusk
5001 E. 71st So.
Derby, Ks.
67037



Wichita - Sedg. County
Metropolitan Planning Dept.
(10th Floor)
455 N. Main St.
Wichita, Ks. 67202