

D-0863 - Dennis R. Niedens, Etux
& John J. Baba, Etux, dedicate
Additional Utility Easements
generally located between Gordon
and Edwards, in an area north of
10th Street

POSTED
12-28-78

ACTION

DATE

12-28-78

S/D COMMITTEE

accept

M.A.P.C.

1-4-79

accept

B.C.C./B. CO. C.

1-16-79

Approved

MAP No. 5248
 SEC. No. 13
 TWP. No. 27
 RANGE 1W

DEDICATION REPORT AND PROGRESS
 CASE No. D - 0863
 (Associated L/S-0378)

I. OFFER TO DEDICATE: Additional utility easements
 GENERALLY LOCATED: between Gordon and Edwards, in an area north of 10th St.

LEGALLY DESCRIBED AS:

DEDICATED BY: Dennis R. Niedens, Etux & John J. Baba, Etux
 AGENT: Dennis Niedens
 ADDRESS: 900 N. Tyler, Suite 8, Wichita 67212 PHONE _____
 PURPOSE OF DEDICATION:

II. SKETCH.

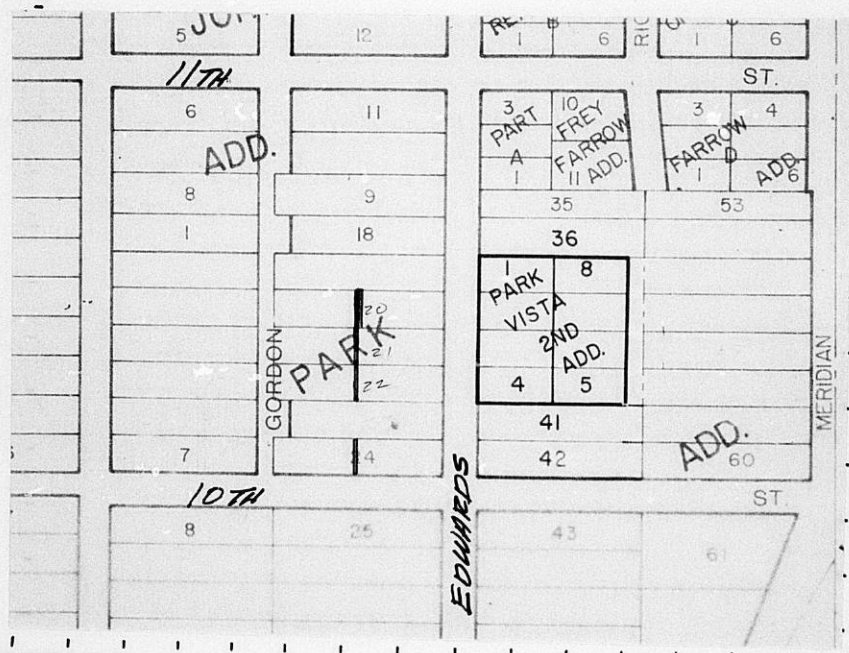

III. FILED 12-13-78
 POSTED TO ATLAS
 S/D COMM. ACTION 12-28-78 *accept*
 M.A.P.C. ACTION 1-4-79 *consent*
 B.C.C. ACTION 1-16-79 *Approved*
 PLACED ON RECORD
 CITY CLERKS No. _____

MAPC CASE NO.D-0863 Dedication of utility easements

Dedicated by: Dennis R. Niedens, etux and John J. Baba, etux

Generally located between Gordon and Edwards, in an area north of 10th Street

This dedication is given for the following reason: requirement of lot split approval.

ACTION: Accept the dedication and instruct the City Clerk to file with the Register of Deeds.

BILL RECORDING FEE TO: Dennis R. Niedens, 900 N. Tyler, Suite 8, 67212

Map 5248
13
27
1W

D-0863
Case 45-0378

EASEMENT

THIS EASEMENT made this 1st day of DECEMBER,
1978, by and between DENNIS R. AND ROSEMARY NIEDENS
of the first part and the City of Wichita, of the second part.

WITNESSETH: That the said first party, in consideration of the sum of One Dollar (\$1.00) and other valuable consideration, the receipt whereof is hereby acknowledged, does hereby grant and convey unto the said second party a perpetual right-of-way and easement for the purpose of constructing, maintaining, and repairing sewer and all other public utilities, over, along and under the following described real estate situated in Sedgwick County, Kansas, to wit:

- ✓ The west 4 feet of the east 152 feet of Lot 20, Park Vista Addition to Wichita, Kansas; and
- ✓ The east 2 feet of the west 150 feet of Lot 21, Park Vista Addition to Wichita, Kansas; and
- ✓ The east 2 feet of the west 150 feet of Lot 22, Park Vista Addition to Wichita, Kansas; and
- ✓ The east 2 feet of the west 150 feet of Lot 24, Park Vista Addition to Wichita, Kansas.

And said second party is hereby granted the right to enter upon said premises at any time for the purpose of constructing, operating, maintaining, and repairing such sewer and all other public utilities.

IN WITNESS WHEREOF: The said first party has signed these presents the day and year first written.

Dennis R. Niedens
Rosemary Niedens

STATE OF KANSAS)
SEDGWICK COUNTY) SS

Be it remembered that on this 1st day of December, 1978, before me, a notary public in and for said County and State, came Dennis R. Niedens and Rosemary Niedens to me personally known to be the same person(s) who executed the foregoing instrument of writing and duly acknowledged the execution of same. In testimony whereof I have hereunto set my hand and affixed my notarial seal the day and year above written.

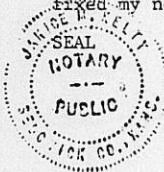

J. M. Kelly
Notary Public

My Commission expires: March 8, 1981

EASEMENT

THIS EASEMENT made this 30 day of November,
1978, by and between John J. + Nadine L. Baba
of the first part and the City of Wichita, of the second part.

WITNESSETH: That the said first party, in consideration of the sum of One Dollar (\$1.00) and other valuable consideration, the receipt whereof is hereby acknowledged, does hereby grant and convey unto the said second party a perpetual right-of-way and easement for the purpose of constructing, maintaining, and repairing sewer and all other public utilities, over, along and under the following described real estate situated in Sedgwick County, Kansas, to wit:

The west 2 feet of the east 150 feet of Lot 21, Park Vista Addition to Wichita, Kansas; and

The west 2 feet of the east 150 feet of Lot 22, Park Vista Addition to Wichita, Kansas; and

The west 2 feet of the east 150 feet of Lot 24, Park Vista Addition to Wichita, Kansas.

And said second party is hereby granted the right to enter upon said premises at any time for the purpose of constructing, operating, maintaining, and repairing such sewer and all other public utilities.

IN WITNESS WHEREOF: The said first party has signed these presents the day and year first written.

John J. Baba
Nadine L. Baba

STATE OF KANSAS)
SEDGWICK COUNTY) SS

Be it remembered that on this 30th day of November,
1978, before me, a notary public in and for said County and State,
came John J. Baba and Nadine L. Baba
to me personally known to be the same person(s) who executed the
foregoing instrument of writing and duly acknowledged the execution
of same. In testimony whereof I have hereunto set my hand and af-
fixed my notarial seal the day and year above written.

James C. Odum
Notary Public



My Commission expires: Sept. 5, 1982