

D-0893 - Harvey D. Ellis, M.D.;
Etux. Grants Utility Easement -
South of Central, in an area east
of Woodlawn.

POSTED
6-18-79

ACTION

DATE:

6-28-79

S/D COMMITTEE

accept

M.A.P.C.

7-5-79

Accepted

B.C.C./B.-CO. C.

7-17-79

Accepted

DEDICATION REPORT AND PROGRESS

MAP No. 5947
 SEC. No. 19
 TWP. No. 27
 RANGE 2E

CASE No. D - 0893
 (Associated case L/S-0414)

I. OFFER TO ~~Beatrix~~ Grant: Utility Easement
 GENERALLY LOCATED: South of Central, in an area east of Woodlawn.

LEGALLY DESCRIBED AS:

DEDICATED BY: Harvey D. Ellis, M.D. and Alain Ellis; 6611 E. Central, 67206
 AGENT: _____
 ADDRESS: _____ PHONE _____
 PURPOSE OF DEDICATION: _____

II. SKETCH.

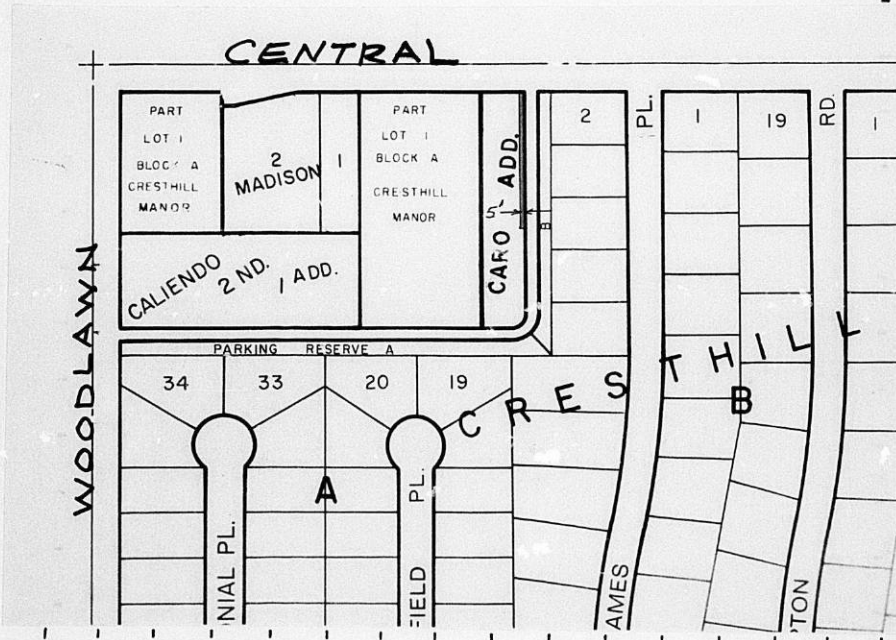

III. FILED 6-6-79
 POSTED TO ATLAS
 S/D COMM. ACTION 6-28-79 *scop*
 M.A.P.C. ACTION 7-5-79 *scop*
 B.C.C. ACTION 7-17-79 *scop*
 PLACED ON RECORD
 CITY CLERKS No. _____

MAPC CASE NO. D-0893 Dedication of a utility easement

Dedicated by: Harvey D. Ellis, M.D.

Generally located on the south side of Central in an area east of Woodlawn.

This dedication is given for the following reason:

Requirement of approval of lot split case L/S-0414

ACTION: Accept the dedication and instruct the City Clerk to
file with the Register of Deeds.

BILL RECORDING FEE TO: Harvey D. Ellis, M.D., 6611 E. Central, 67206

*Set up D file
for 6-28-79*

*Harvey D. Ellis, M.D.
~~Dedicates~~ utility easement
granted
south of Central in an area east of Woodlawn
Map 5947 17-27-2E
received 6-6-79
Assoc. with 45-0414
Address: 6611 E. Central 67206*

5947
19
27
28

EASEMENT

D-0893
assn. 4/S-0414

THIS EASEMENT made this 4th day of June,
19 79, by and between Harvey D. Ellis, M.D. and Alain Ellis
of the first part and the City of Wichita, of the second part.

WITNESSETH: That the said first party, in consideration of the sum of One Dollar (\$1.00) and other valuable consideration, the receipt whereof is hereby acknowledged, does hereby grant and convey unto the said second party a perpetual right-of-way and easement for the purpose of constructing, maintaining, and repairing sewer and all other public utilities, over, along and under the following described real estate situated in Sedgwick County, Kansas, to wit:

the east 5 feet of the north 240 feet
of Lot 1, Caro Addition, Wichita,
Sedgwick County, Kansas.

And said second party is hereby granted the right to enter upon said premises at any time for the purpose of constructing, operating, maintaining, and repairing such sewer and all other public utilities.

IN WITNESS WHEREOF: The said first party has signed these presents the day and year first written.

Harvey D. Ellis, M.D.
Harvey D. Ellis

Alain Ellis
Alain Ellis

STATE OF KANSAS)
SEDGWICK COUNTY) SS

Be it remembered that on this 4th day of June,
1979, before me, a notary public in and for said County and State,
came Harvey D. Ellis, M.D. and Alain Ellis, his wife
to me personally known to be the same person(s) who executed the
foregoing instrument of writing and duly acknowledged the execution
of same. In testimony whereof I have hereunto set my hand and af-
fixed my notarial seal the day and year above written.

SEAL

Mark A. Javoy
Notary Public

My Commission expires: 4/14/80

