

D-0917 - Ronald F. Hall, et al  
grants a 20 Foot Utility Easement-  
generally located at the southwest  
corner of Maple and Tyler.

POSTED  
10-5-79

|                | DATE     |
|----------------|----------|
| S/D COMMITTEE  | 10-18-79 |
| M.A.P.C.       | 10-25-79 |
| B.C.C./B-60-C. | 11-6-79  |

ACTION

accept  
accept  
Accept

DEDICATION REPORT AND PROGRESS

MAP No. 4846  
SEC. No. 29  
TWP. No. 27S  
RANGE 1W

CASE No. D - 0917

ASSOCIATED CASE NO. L/S-0422

I. OFFER TO DEDICATE: 20 foot utility easement on Block Z, Callahan Add.  
GENERALLY LOCATED: southwest corner of Maple and Tyler

LEGALLY DESCRIBED AS:

DEDICATED BY: Ronald F. Hall, et al  
AGENT: \_\_\_\_\_  
ADDRESS: 133 J. Oakwood 67218 PHONE \_\_\_\_\_  
PURPOSE OF DEDICATION: Lot split requirement

II. SKETCH.

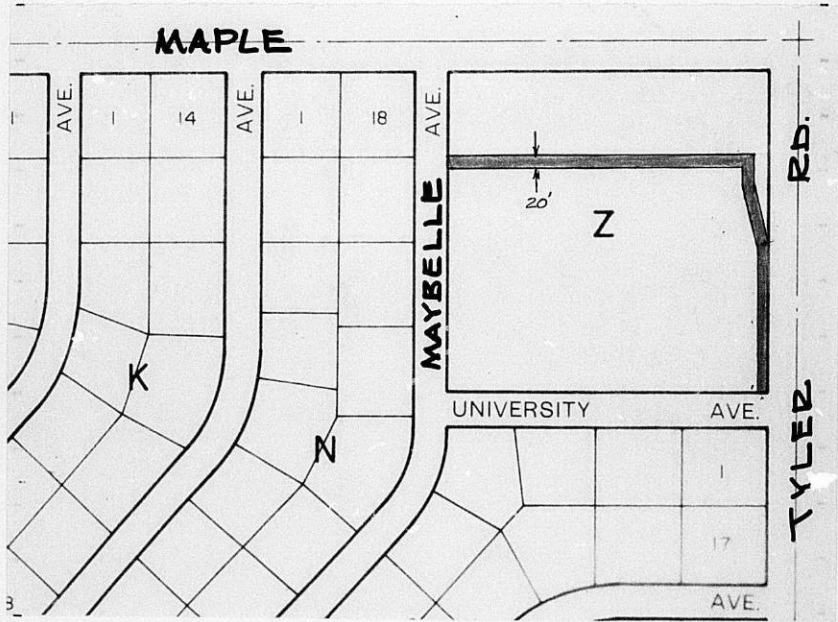

III. FILED 10-1-79  
POSTED TO ATLAS \_\_\_\_\_  
S/D COMM. ACTION 10-18-79 *accept*  
M.A.P.C. ACTION 10-25-79

B.C.C. ACTION 11-6-79 *Accept*  
PLACED ON RECORD \_\_\_\_\_  
CITY CLERKS No. \_\_\_\_\_

MAPC CASE NO. D-0917      Dedication of utility easement

Dedicated by: Ronald F. Hall, et. al.

Generally      Located southwest of Maple and Tyler in Block Z, Callahan Addition

This dedication is given for the following reason: Requirement of  
lot split and community unit plan

**ACTION:**      Accept the dedication and instruct the City Clerk to  
file with the Register of Deeds.

**BILL RECORDING FEE TO:**      Ronald F. Hall, 133 S. Oakwood, 67218

4846  
29  
275  
1W

EASEMENT

D-0917

(Assoc. L/S-042)

THIS EASEMENT made this 31st day of July,  
1927, by and between Ronald F. Hall, Shirley J. Hall, Milton L. McClay, Nettie McClay  
of the first part and the City of Wichita, of the second part.

WITNESSETH: That the said first party, in consideration of the sum of One Dollar (\$1.00) and other valuable consideration, the receipt whereof is hereby acknowledged, does hereby grant and convey unto the said second party a perpetual right-of-way and easement for the purpose of constructing, maintaining, and repairing sewer and all other public utilities, over, along and under the following described real estate situated in Sedgwick County, Kansas, to wit:

A strip of land 20 feet in width lying left of and adjacent to the following described line: Beginning at the S.E. Corner, of Block 2, Callahan Addition, Sedgwick County, Kansas; thence north along the east line of said block, 270 feet to a point 300 feet south of the N.E. Corner of said block; thence northwesterly 103.3 feet to a point 200 feet south and 25 feet west of the N.E. Corner of said block; thence north parallel with east line of said block, 55 feet; thence west parallel with the north line of said block, to the west line of said block.

And said second party is hereby granted the right to enter upon said premises at any time for the purpose of constructing, operating, maintaining, and repairing such sewer and all other public utilities.

IN WITNESS WHEREOF: The said first party has signed these presents the day and year first written.

Ronald F. Hall  
Ronald F. Hall  
Shirley J. Hall  
Shirley J. Hall  
Milton L. McClay  
Milton L. McClay  
Nettie McClay  
Nettie McClay

STATE OF KANSAS)  
SEDGWICK COUNTY) SS

Be it remembered that on this 31st day of July, 1927, before me, a notary public in and for said County and State, came Ronald F. Hall, Shirley J. Hall, Milton L. McClay, Nettie McClay to me personally known to be the same person(s) who executed the foregoing instrument of writing and duly acknowledged the execution of same. In testimony whereof I have hereunto set my hand and affixed my notarial seal the day and year above written.



Bruce D. Fitts  
Notary Public  
BRUCE D. FITTS

Commission expires: January 4, 1931