

Donald C. Flower - Dedicates
Street, Avigational & Covenant Easements
at the northwest corner of Harry St. &
Yucca Place.

Smead
No 2-153C

HASTINGS, MN
LOS ANGELES, CHICAGO, LOS AN, OH
MEXICO, TX, LOCUST GROVE, GA
U.S.A.

D-0929 - Donald C. Flower - Dedicates Street, Avigational & Covenant Easements at the northwest corner of Harry St. & Yucca Place.

*1-15-80
DF*

ACTION

DATE

S/D COMMITTEE _____

M.A.P.C. _____

B.C.C./~~B.C.C.~~ *Receipt* _____ 1-15-80

DEDICATION REPORT AND PROGRESS

MAP No. 5046
 SEC. No. 27
 TWP. No. 27S
 RANGE 1W

CASE No. D - 0929

ASSOCIATED CASE Z-2202

I. OFFER TO DEDICATE: Street, Avigational & Covenant Easements
 GENERALLY LOCATED: Northwest corner of Harry St. & Yucca Place

LEGALLY DESCRIBED AS: _____

DEDICATED BY: Donald C. Flower % Don Flower Assoc. Inc. -Mid-Continent Airport
 AGENT: P.O. Box 9210, 67277 (943-9331)
 ADDRESS: _____ PHONE _____
 PURPOSE OF DEDICATION: Requirement of the Zone case.

II. SKETCH.

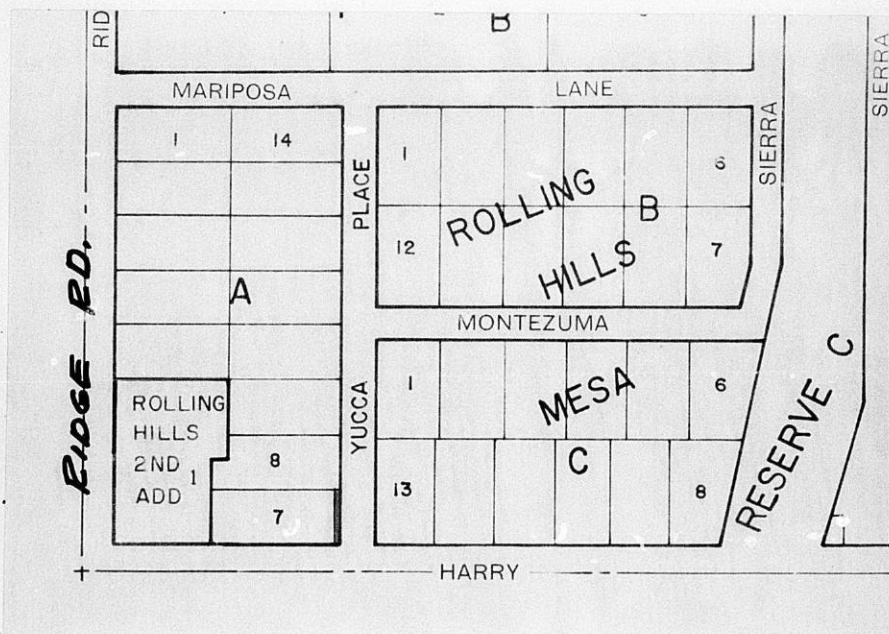

III. FILED 1-15-80
 POSTED TO ATLAS _____
 S/D COMM. ACTION _____
 M.A.P.C. ACTION _____

B.C.C. ACTION 1-15-80 Accept.
 PLACED ON RECORD _____
 CITY CLERKS No. _____

Map. 5046
27
275
1W

DEDICATION

D-0929

KNOW ALL MEN BY THESE PRESENTS:

(Case 2-2202)

That for and in consideration of the sum of One Dollar (\$1.00) and other good and valuable considerations, the receipt of which is hereby acknowledged, the undersigned, Donald C. Flower

being the owner of the following described real estate in Sedgwick County, Kansas, to wit:

East 5' of Lot 7, Block A, Rollings Hills Mesa
Addition to Sedgwick County, Kansas

do hereby dedicate the above described real estate to the public for street purposes.

Executed this 18 day of Dec 1979.

Donald C. Flower
Donald C. Flower

FLORIDA
STATE OF KANSAS)
~~SEDCWICK COUNTY~~) ss

BE IT REMEMBERED, that on this 18 day of December 1979 came Donald C. Flower

to me personally known to be the same person who executed the foregoing instrument and duly acknowledged the execution of the same.

IN WITNESS WHEREOF, I have hereunto subscribed my name and affixed my official seal, the day and year last above written.

Submitted to the Wichita-Sedgwick County Metropolitan Area Planning Commission and the Board of Commissioners of the City of Wichita, Kansas, and approved by said Board of Commissioners of the City of Wichita, Kansas,

this _____

City Clerk

Lisa J. Spears
Notary Public

My Commission Expires: _____
Notary Public, State of Florida att(10)
My Commission Expires Dec. 19, 1982

Map. 5046
27
27S
1W

D E D I C A T I O N

D-0929

KNOW ALL MEN BY THESE PRESENTS:

(Assoc 2-2202)

That for and in consideration of the sum of One Dollar (\$1.00) and other good and valuable considerations, the receipt of which is hereby

acknowledged, the undersigned, Donald C. Flower

being the owner of the following described real estate in Sedgwick County, Kansas, to wit:

East 5' of Lot 7, Block A, Rollings Hills Mesa
Addition to Sedgwick County, Kansas

do hereby dedicate the above described real estate to the public for _____ street _____ purposes.

Executed this _____ day of Dec 18 1979.

Donald C. Flower
Donald C. Flower

FLORIDA
STATE OF KANSAS)
~~SEDDWICK COUNTY~~) ss

BE IT REMEMBERED, that on this 18 day of December 1979
came Donald C. Flower

to me personally known to be the same person who executed the foregoing instrument and duly acknowledged the execution of the same.

IN WITNESS WHEREOF, I have hereunto subscribed my name and affixed my official seal, the day and year last above written.

Submitted to the Wichita-Sedgwick County Metropolitan Area Planning Commission and the Board of Commissioners of the City of Wichita, Kansas, and approved by said Board of Commissioners of the City of Wichita, Kansas,

this _____

City Clerk

Rosa G. Spears
Notary Public

My Commission Expires:
Notary Public, State of Florida at large
My Commission Expires Dec. 19, 1982

20

RESTRICTIVE COVENANT

RESTRICTIVE COVENANT AFFECTING Rolling Hills Mesa ADDITION

THIS DECLARATION made this 18th day of December, 1979 by
Donald C. Flower, hereinafter called the Grantor.

WITNESSETH

WHEREAS, Grantor is owner of Lot 7, Block A, Rolling Hills
Mesa Addition to Sedgwick County, Kansas, which property
is located near Mid-Continent Airport and is accordingly
subject to considerable noise from the operation of aircraft, and

WHEREAS, the City of Wichita in connection with approval of
the plat of said addition considers it to be in the public interest
to require any buildings constructed on said addition to be designed
and constructed giving proper consideration to noise pollution in
the area:

NOW THEREFORE, Grantor, hereby declares that Lot 7, Block A,
Rolling Hills Mesa Addition, shall be and the same is subjected to the following
restrictive covenant, to-wit:

Any building constructed on the premises
shall be so designed and constructed as to
minimize noise pollution in any such struc-
ture, giving due consideration to the use
for which such structure is designed and
built. This covenant is for the benefit of
said property and shall run with the land
and shall inure to the benefit of and pass
with said property and shall apply to and
bind the successors in interest and any owner
thereof.

EXECUTED the day and year first above written.

Donald C. Flower
Donald C. Flower

FLORIDA
STATE OF ~~KANSAS~~
~~SEDGWICK COUNTY~~ SS

Personally appeared before me a notary public in and for the
~~County~~ State aforesaid Donald C. Flower

to me personally known to be the same person who executed the
foregoing instrument of writing and said person duly acknowledged
the execution thereof.

ST. PETE, FL
Dated at ~~Wichita, Kansas~~ this 18 day of December, 1979.

Lisa M. Spruce
Notary Public

(My Commission expires My Commission Expires Dec. 19, 1982)