

Closed - associated plat
closed.

Instrument returned to
School Bd.

D-0940 - USD No. 259 dedicates
Right-of-way for drainage purposes
South of 45th St. approx. 1/4
mile east of Meridian.

ACTION

POSTED
3-27-80
F. J. H.

	DATE
S/D COMMITTEE	3-20-80
M.A.P.C.	3-27-80
B.C.C./B.C.C.C.	

Closed - associated plot
closed.

Instrument returned to
School Bd.

DEDICATION REPORT AND PROGRESS

CASE No. D - 0940

MAP No. 5342
SEC. No. 18
TWP. No. 28
RANGE 1E

ASSOCIATED CASE: S/D 78-103

I. OFFER TO DEDICATE: Right-of-way for drainage purposes
GENERALLY LOCATED: South of 45th St approx 1/4 mile east of Meridian.

LEGALLY DESCRIBED AS:

DEDICATED BY: Unified School District No. 259

AGENT: _____
ADDRESS: _____ PHONE _____
PURPOSE OF DEDICATION: _____

CHURCH ADD

ADD.

FORTY FIFTH ST SO.

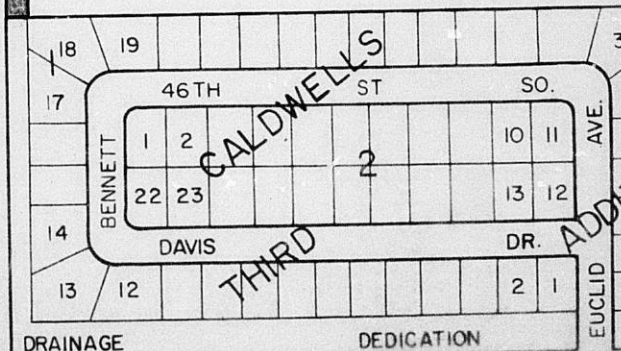

47TH

ST. SO.

II. FILED 2-22-80
POSTED TO ATLAS
S/D COMM. ACTION 3-20-80 accept
M.A.P.C. ACTION 3-27-80 accept

B.C.C. ACTION _____
PLACED ON RECORD _____
CITY CLERKS No. _____

March 25, 1983

Wichita Public Schools
Schweiter School Building
Attention: Richard L. Holstead
1400 George Washington Drive
Wichita, Kansas 67211

Re: Dedication of drainage right-of-way off of Cessna
School Property. Located south of 45th Street South,
approximately 1/4 mile east of Meridian. (D-0940)

Dear Mr. Holstead:

Attached please find an original instrument dedicating School Board property for drainage purposes. As you may remember, this dedication was submitted in 1979, in conjunction with the proposed platting of Campus Valley Addition. The associated plat has remained inactive since March of 1980, and the applicant has expressed no interest in completing the subdivision application. We are, therefore, returning the drainage right-of-way instrument as the associated plat file has been marked "closed."

Should you have any questions about this matter, please call me at 268-4421.

Sincerely,

Forrest L. Nagley
Junior Planner

FLN:bh

Attach.

5347

DEDICATION

cedna

KNOW ALL MEN BY THESE PRESENTS:

D-0940

Assoc S/078-103

That for and in consideration of the sum of One Dollar (\$1.00) and other good and valuable considerations, the receipt of which is hereby acknowledged, the undersigned, Unified School District No. 259

being the owner of the following described real estate in Sedgwick County, Kansas, to wit:

The west 40 feet of the N $\frac{1}{2}$ of the SE $\frac{1}{4}$ of the SW $\frac{1}{4}$ of Sec. 18, Twp. 28-S, R-1-E of the 6th P.M., Sedgwick County, Kansas.

do es hereby dedicate the above described real estate to the public for Drainage purposes.

Executed this 9th day of January 19 79.

Attest:

Unified School District No. 259

Martin Hartley
Clerk of the Board

By Kenneth R. Kimbell
Kenneth R. Kimbell, President

STATE OF KANSAS)
SEDGWICK COUNTY) ss

BE IT REMEMBERED, that on this 9th day of January, 1979,

came Kenneth R. Kimbell, President, and Martin Hartley, Clerk of the Board,
Unified School District No. 259, Sedgwick County, Kansas

to me personally known to be the same persons who executed the foregoing instrument and duly acknowledged the execution of the same.

IN WITNESS WHEREOF, I have hereunto subscribed my name and affixed my official seal, the day and year last above written.

Submitted to the Wichita-Sedgwick County Metropolitan Area Planning Commission and the Board of Commissioners of the City of Wichita, Kansas, and approved by said Board of Commissioners of the City of Wichita, Kansas,

this _____

City Clerk

L. Gene Carter
Notary Public

My Commission Expires:



110 received 3 7 79

WICHITA PUBLIC SCHOOLS
SCHWEITER SCHOOL BUILDING
1400 George Washington Drive
WICHITA, KANSAS 67211



Division of School Plant Planning
and Operation Services

November 1, 1978

Ms. Louise Olivarez
Junior Planner
Metropolitan Area Planning Department
455 North Main
Wichita, Kansas 67202

Dear Ms. Olivarez:

I have checked with the principal of Cessna Elementary School concerning your request for dedication of a drainage easement from the west side of the property. It appears that it would be in our interest to make such a dedication.

I presume that the open channel you mention in your letter would direct water south from 45th Street to 47th Street. The principal informs me that at the present time, water goes east along 45th Street to Clarence and then south where it causes a problem. If this Clarence Street drainage problem is going to be aided by the Board of Education's dedication of a drainage easement, I would see no reason why the dedication should not be made.

Please provide me with a legal description and the appropriate dedicatory documents. I will take the item to the Board of Education. Of course, it goes without saying that our dedication would be contingent on the plat being completed and the owner of the plat proceeding with his part of the drainage construction.

Sincerely,

Richard L. Holstead

Richard L. Holstead
Director
School Plant Planning and Operation Services

RLH:vc