

D-0952 - USD #259 Dedicates ROW
for Funston. Generally located
east of Cypress, in an area south
of Harry.

POSTED
5-29-80
Z-1

ACTION

ST	COMMITTEE	DATE
	<u>Receipt</u>	<u>6-12-80</u>
	<u>M.A.P.C.</u>	<u>6-19-80</u>
	<u>B.C.C./B.C.O.C.</u>	<u>7-1-80</u>

DEDICATION REPORT AND PROGRESS

MAP No. 6045
 SEC. No. 32
 TWP. No. 27S
 RANGE 2E

CASE No. D - 0952

ASSOCIATED CASE NO. _____

I. OFFER TO DEDICATE: right-of-way for Funston
 GENERALLY LOCATED: east of Cypress, in an area south of Harry.

LEGALLY DESCRIBED AS: _____

DEDICATED BY: USD #259, Sedgwick County, Kansas

AGENT: _____

ADDRESS: _____ PHONE _____

PURPOSE OF DEDICATION: _____

II. SKETCH.

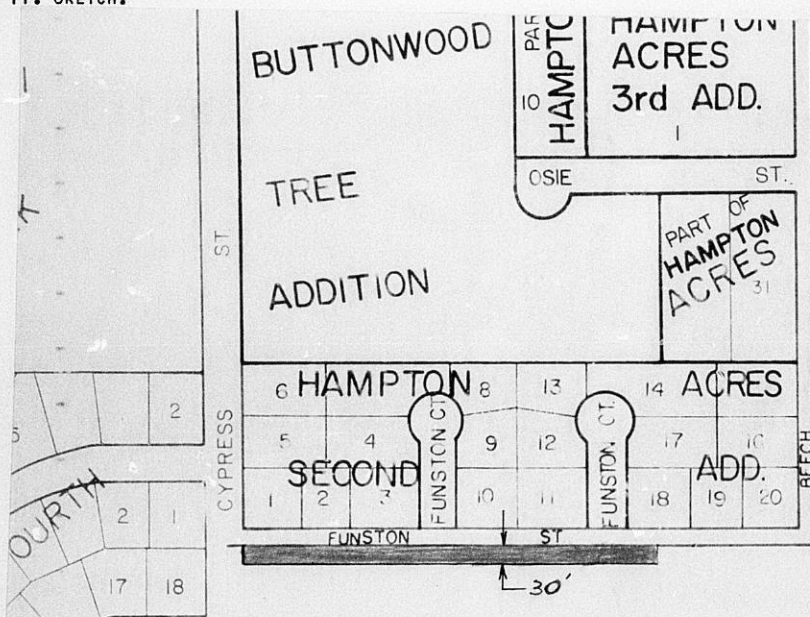

III. FILED 5-28-80

POSTED TO ATLAS _____

S/D COMM. ACTION 6-12-80 *accept*

M.A.P.C. ACTION 6-19-80 *Accepted*

B.C.C. ACTION 7-1-80 *Accepted*

PLACED ON RECORD _____

CITY CLERKS No. _____

MAPC CASE NO. D-0952 Dedication of right-of-way for Funston

Dedicated by: U.S.D. 259

Generally located: east of Cypress in an area south of Harry

This dedication is given for the following reason:
needed for road improvements

ACTION: Accept the dedication and instruct the City Clerk to
file with the Register of Deeds.

BILL RECORDING FEE TO: Project No. 472-76-245-80-887-000-000-001

6045A

32
275
2E

DEDICATION

D-0952

KNOW ALL MEN BY THESE PRESENTS:

That for and in consideration of the sum of One Dollar (\$1.00) and other good and valuable considerations, the receipt of which is hereby acknowledged,

the undersigned, U.S.D. 259
Sedgwick County, Kansas

being the owner of the following described real estate in Sedgwick County, Kansas, to wit:

A tract of land in the Northeast Quarter, Section 32, Township 27 South, Range 2 East of the 6th P.M., more fully described as: beginning at a point thirty-two (32) feet South of the Southwest Corner of Lot 1, Hampton Acres Second Addition; Thence South parallel to the West line of Cypress for a distance of thirty-two (32) feet; thence East parallel to the South line of Hampton Acres 2nd Addition for a distance of seven hundred thirty (730) feet; thence North parallel to the West line of Cypress for a distance of thirty-two (32) feet; thence West parallel to the South line of Hampton Acres 2nd Addition for a distance of seven hundred thirty (730) feet to the point of beginning.

does hereby dedicate the above described real estate to the public for street purposes.

Executed this 19th day of May, 1980.

UNIFIED SCHOOL DISTRICT NO. 259

Jo Ann Pottorff
Jo Ann Pottorff, President
Martin Hartley
Martin Hartley, Clerk

STATE OF KANSAS)
SEDGWICK COUNTY) SS

BE IT REMEMBERED, that on this 19th day of May, 1980, before me a Notary Public in and for the said County and State came

Jo Ann Pottorff, President, and Martin Hartley, Clerk of the Board of Education,
Unified School District No. 259, Sedgwick County, Kansas

to me personally known to be the same persons who executed the foregoing instrument and duly acknowledged the execution of the same.

IN WITNESS WHEREOF, I have hereunto subscribed my name and affixed my official seal, the day and year last above written.

Kathy Zeiner
Notary Public

My Commission expires 10-10-81.

N

Scale 1" = 200'

Tract to be Dedicated

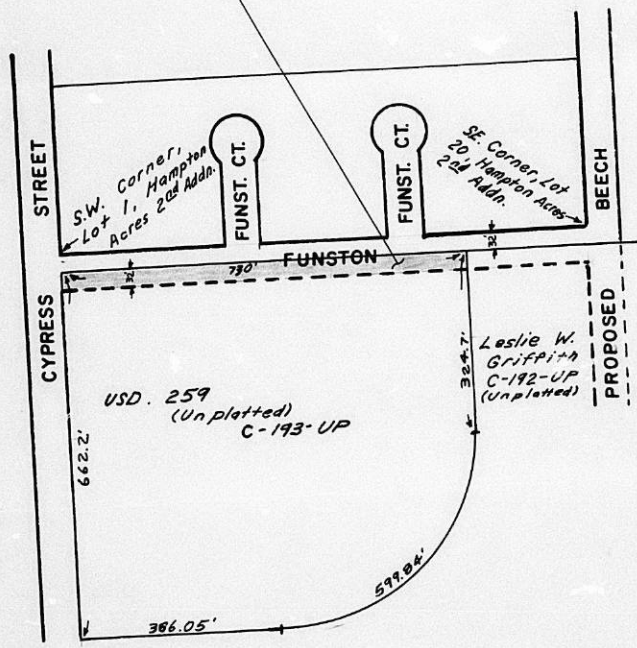

THE CITY OF WICHITA

OFFICE OF PUBLIC WORKS ENGINEERING

DATE May 22, 1980

RECEIVED

MAY 26 1980

TO Louise Olivarez, Planning

METROPOLITAN PLANNING

FROM Bob Harrington, Civil Engineer I

ROUTE

SUBJECT Street Dedication for Funston
Street, from E.L. Cypress
to W.L. Beech

Enclosed please find an executed copy of said Dedication.
Please forward it for approval by the Subdivision Committee.

Bob Harrington
Bob Harrington
Civil Engineer I

BH:md

Enclosure