

D-0959 - Jesse Graham, et al  
grant Easement for Drainage Pur-  
poses in a portion of vacated  
Harry Drive R.O.W. adjacent to  
Golf Park Addition. Generally  
located  $1\frac{1}{2}$  blocks east of Woodlawn  
on the south side of Harry.

*Smead*  
No. 2-153C

HASTINGS, MN  
LOS ANGELES, CHICAGO, LOS AN, OH  
McGREGOR, TX, LOCUST GROVE, GA  
U.S.A.

D-0959 - Jesse Graham, et al  
grant Easement for Drainage Pur-  
poses in a portion of vacated  
Harry Drive R.O.W. adjacent to  
Golf Park Addition. Generally  
located 1/2 blocks east of Woodlawn

*POSTED*  
*7-15-80*

**ACTION**

DATE

*7-21-80*

SPD COMMITTEE *accept*

*7-31-80*

M.A.P.C. *accept*

*8-12-80*

B.C.C./B.-CO.-C. *Accept*

DEDICATION REPORT AND PROGRESS

MAP No. 5945  
 SEC. No. 31  
 TWP. No. 27  
 RANGE 2E

CASE No. D - 0959

ASSOCIATED CASE NO. \_\_\_\_\_

I. OFFER TO DEDICATE: Easement for Drainage purposes in a portion of vacated Harry Drive R.O.W. adjacent to Golf Park Addition  
 GENERALLY LOCATED: 1 1/2 blocks east of Woodlawn on the south side of Harry.

LEGALLY DESCRIBED AS:

DEDICATED BY: Jesse Graham, et al  
 AGENT: \_\_\_\_\_  
 ADDRESS: \_\_\_\_\_ PHONE \_\_\_\_\_  
 PURPOSE OF DEDICATION: Needed for public works project

II. SKETCH.

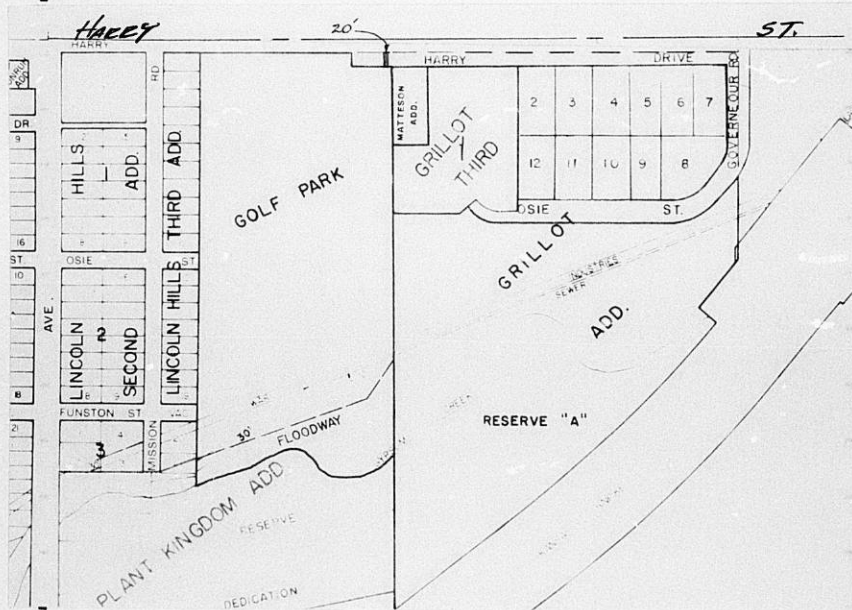

III. FILED 7-9-80  
 POSTED TO ATLAS \_\_\_\_\_  
 S/D COMM. ACTION 7-24-80 accept  
 M.A.P.C. ACTION 7-31-80 accept

B.C.C. ACTION 8-12-80 Accept  
 PLACED ON RECORD \_\_\_\_\_  
 CITY CLERKS No. \_\_\_\_\_

MAPC CASE NO. D-0959      Dedication of drainage easement

Dedicated by:      Jesse Graham, et. al.

Generally located: on the south side of Harry in an area east of Woodlawn

This dedication is given for the following reason:  
needed for Public Works project

ACTION:      Accept the dedication and instruct the City Clerk to  
file with the Register of Deeds.

BILL RECORDING FEE TO:      S.W.S. No. 175  
#468-76-245-80883-000-000-001

5945  
31  
27  
26

DRAINAGE EASEMENT

S.W.S. No. 175  
#468 76 245 80883 000 000 001  
D-0959

THIS EASEMENT made this 3rd day of July, 19 80  
by and between Jesse L. Graham & Ina L. Graham, his wife  
Luis A. Casado & Vera J. Casado, his wife of the first part  
and the City of Wichita on the second part.

WITNESSETH: That the said first parties, in consideration of the sum of One Dollar (\$1.00) and other valuable consideration, the receipt whereof is hereby acknowledged, do hereby grant and convey unto the said second party a perpetual right-of-way and easement for the purpose of constructing, maintaining, and repairing a drainage system, over, along and under the following described real estate situated in Sedgwick County, Kansas; to wit:

A Drainage Easement described as the West twenty (20) feet of the East thirty (30) feet of vacated Harry Drive right of way adjacent to and on the North side of the Golf Park Addition.

And said second party is hereby granted the right to enter upon said premises at any time for the purpose of constructing, operating, maintaining, and repairing such drainage system.

IN WITNESS WHEREOF: The said first parties have signed these presents the day and year first written.

Jesse L. Graham  
Ina L. Graham  
Luis A. Casado  
Vera J. Casado

STATE OF KANSAS)  
SEDGWICK COUNTY) SS

Personally appeared before me, a notary public, in and for the County and State aforesaid Jesse L. Graham & Ina L. Graham, his wife  
Luis A. Casado & Vera J. Casado, his wife  
to me personally known to be the same persons who executed the foregoing instrument of writing and said persons duly acknowledged the execution thereof.

Dated at Wichita, Kansas, this 3rd day of July, 19 80.

Ray A. Putnam  
Notary Public

My Commission Expires: August 29, 1981



**THE CITY OF WICHITA**

OFFICE OF PUBLIC WORKS ENGINEERING      DATE July 8, 1980

TO Louise Olivarez, Senior Planner

FROM Larry D. Henry, Right-of-Way & Estimating Engineer

SUBJECT Utility & Drainage Easements  
Golf Park Addition

Attached are executed easements for Utilities and Drainage across the vacated portion of Harry Drive adjacent on the North to Golf Park Addition. Please place these items on the agenda for Subdivision consideration. Upon approval, please forward to the City Clerk for recording. I would appreciate a copy of the recorded instruments being forwarded to this office. Any recording fees may be charged to the project number indicated at the upper right-hand corner of the forms.

*Larry D. Henry*  
Larry D. Henry  
R/W & Estimating Engineer

LDH:md

**RECEIVED**

JUL 8 1980

METROPOLITAN PLANNING  
ROUTE  *Louis*  
 \_\_\_\_\_