

S/D 0965 - Nora O. Wilson dedicates Right-of-Way for Gordon St., in an area south of 10th Street.

POSTED
8-6-80

ACTION

	DATE
S/D COMMITTEE	8-21-80 <i>accept</i>
M.A.P.C.	<i>accept</i> 8-28-80
B.C.C./B-CO-C.	<i>Accepted</i> 9-9-80

MAP No. 5248
SEC. No. 13
TWP. No. 27
RANGE 1W

DEDICATION REPORT AND PROGRESS

CASE No. D - 0965

ASSOCIATED CASE NO. _____

I. OFFER TO DEDICATE: Right-of-way for Gordon Street
GENERALLY LOCATED: in an area south of 10th Street.

LEGALLY DESCRIBED AS: _____

DEDICATED BY: Nora O. Wilson
AGENT: _____
ADDRESS: _____ PHONE _____
PURPOSE OF DEDICATION: _____

II. SKETCH.

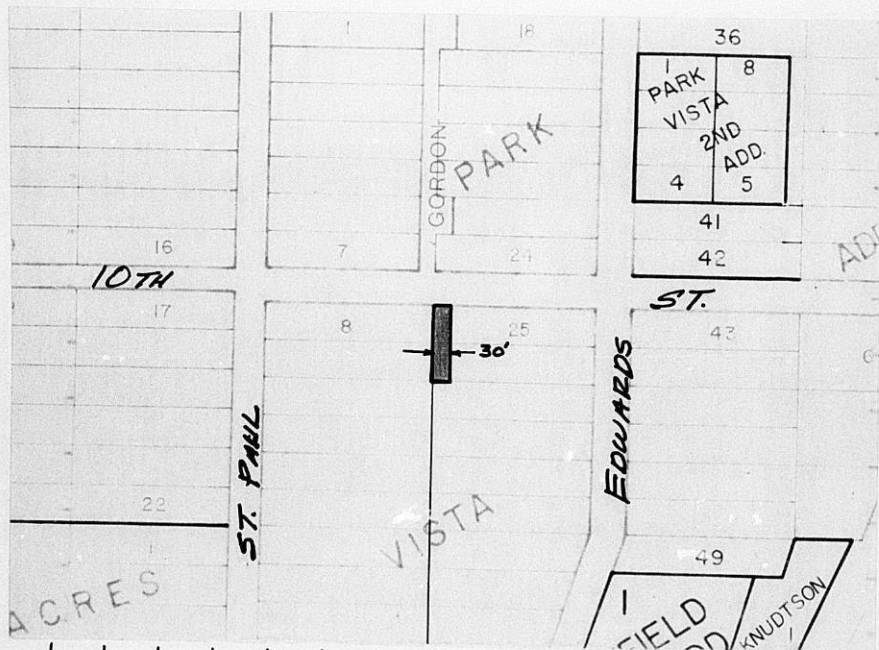

III. FILED 8-1-80
POSTED TO ATLAS
S/D COMM. ACTION 8-21-80 *accept*
M.A.P.C. ACTION 8-28-80 *accept*

B.C.C. ACTION 9-9-80 *Accepted*
PLACED ON RECORD _____
CITY CLERKS No. _____

MAPC CASE NO. D-0965 Dedication of right-of-way for Gordon Street

Dedicated by: Nora O. Wilson

Generally located: located south of 10th Street between Edwards and St. Paul

This dedication is given for the following reason:
lot split requirement

ACTION: Accept the dedication and instruct the City Clerk to
file with the Register of Deeds.

BILL RECORDING FEE TO:
Address:

Nora O. Wilson
537 N. Sheridan
Wichita, Ks. 67203

5248
13
97
1W

Magley

DEDICATION

D-0965

KNOW ALL MEN BY THESE PRESENTS:

That for and in consideration of the sum of One Dollar (\$1.00) and other good and valuable considerations, the receipt of which is hereby acknowledged, the undersigned, _____

being the owner of the following described real estate in Sedgwick County, Kansas, to wit:

The west 30 feet of Lots 25 and 26, Park Vista Addition to Wichita, Kansas.

do _____ hereby dedicate the above described real estate to the public for _____ street _____ purposes.

Executed this 30th day of July 19 80.

x Nora O. Wilson

STATE OF KANSAS)
SEDGWICK COUNTY) ss

BE IT REMEMBERED, that on this 30th day of July, 1980,
came Nora O. Wilson

to me personally known to be the same person who executed the foregoing instrument and duly acknowledged the execution of the same.

IN WITNESS WHEREOF, I have hereunto subscribed my name and affixed my official seal, the day and year last above written.

Submitted to the Wichita-Sedgwick County Metropolitan Area Planning Commission and the Board of Commissioners of the City of Wichita, Kansas, and approved by said Board of Commissioners of the City of Wichita, Kansas,
this _____

City Clerk

Betsy M. Peal
Notary Public

My Commission Expires: NOTARY PUBLIC
Sedgwick County, Kansas
My Appt. Exp. 11-17-82

RECEIVED
JUL 31 1980
METROPOLITAN AREA PLANNING COMMISSION