

D-0973 - Leslie W. Griffith dedicates R.O.W. for south 1/2 Funston in an area west of Beech.

POSTER
9-19-80
71

ACTION

| | DATE |
|---------------|----------------|
| S/D COMMITTEE | <u>9-18-80</u> |
| M.A.P.C. | <u>9-28-80</u> |
| B.C.C./B-60-C | <u>10-7-80</u> |

NE, 1/2

DEDICATION REPORT AND PROGRESS

MAP No. 6045
Sec. No. 32
TWP. No. 27S
RANGE 2E

CASE No. D - 0973

ASSOCIATED CASE NO. _____

I. OFFER TO DEDICATE: R.O.W.
GENERALLY LOCATED: for south 1/2 Funston, in an area west of Beech.

LEGALLY DESCRIBED AS: _____

DEDICATED BY: Leslie W. Griffith
AGENT: _____
ADDRESS: _____ PHONE _____
PURPOSE OF DEDICATION: _____

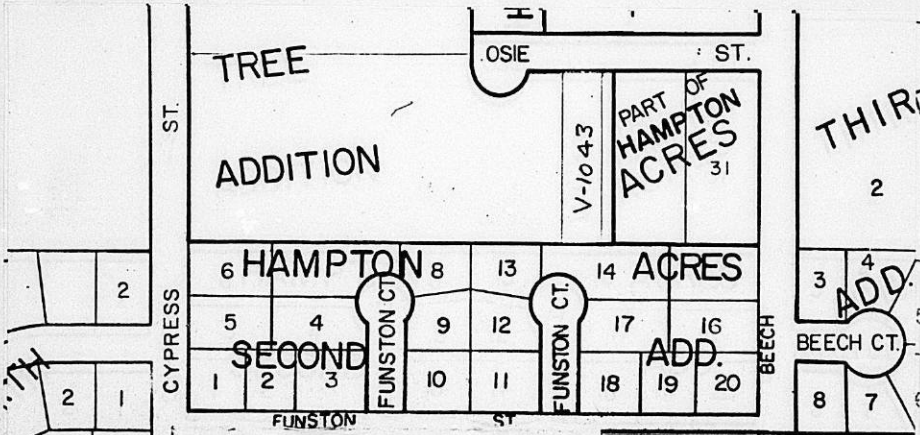

III. FILED 9-15-80
POSTED TO ATLAS
S/D COMM. ACTION 9-18-80 *approve*
M.A.P.C. ACTION 9-25-80

B.C.C. ACTION *Accepted 10-7-80*
PLACED ON RECORD
CITY CLERKS No. _____

MAPC CASE NO. D-0973 Dedication of street right-of-way for Funston

Dedicated by: Leslie W. Griffith

Generally located: on the south side of Funston in an area west of Beech

This dedication is given for the following reason:
needed for street paving project

ACTION: Accept the dedication and instruct the City Clerk to
file with the Register of Deeds.

BILL RECORDING FEE TO: Project #472-76-245-80887-000-000-001

Map 6045
32
27S
2E

D-0973

DEDICATION

KNOW ALL MEN BY THESE PRESENTS:

That for and in consideration of the sum of One Dollar (\$1.00) and other good and valuable considerations, the receipt of which is hereby acknowledged, the undersigned, Leslie W. Griffith

being the owner of the following described real estate in Sedgwick County, Kansas, to wit:

A tract of land in Northeast Quarter of Section 32, Township 27 South, Range 2 East of the 6th P.M., more fully described as follows:

The thirty-two (32) feet South of and adjacent to the following described line: beginning at a point thirty-two (32) feet South of and seven hundred thirty (730) feet East of the Southwest Corner of Lot 1, Hampton Acres 2nd Addition; thence East to a point thirty-two (32) feet South of the Southeast Corner of Lot 20, Hampton Acres 2nd Addition.

does hereby dedicate the above described real estate to the public for street purposes.

Executed this 15th day of September, 1980.

Leslie W. Griffith

STATE OF KANSAS)
SEDGWICK COUNTY) SS

BE IT REMEMBERED, that on this 15th day of September, 1980, before me a Notary Public in and for the said County and State came

Leslie W. Griffith

to me personally known to be the same person who executed the foregoing instrument and duly acknowledged the execution of the same.

IN WITNESS WHEREOF, I have hereunto subscribed my name and affixed my official seal, the day and year last above written.

RAMONA J. REIFF
STATE NOTARY PUBLIC
SEDGWICK COUNTY, KS.

Ramona J. Reiff
Notary Public

MY APPL. EXP. Oct. 24 1983
My Commission expires _____

THE CITY OF WICHITA
OFFICE OF DEPARTMENT OF ENGINEERING

DATE September 15, 1980

RECEIVED

SEP 16 1980

TO Louise Olivarez, Planning
FROM Larry D. Henry, Right-of-Way & Estimating Engineer

METROPOLITAN PLANNING
ROUTE Kansas

SUBJECT Street Dedication
South Half Funston, West of Beech

Attached is a dedication of Street Right-of-Way executed by Mr. Leslie Griffith, for consideration by the Subdivision Committee. Upon approval, please forward it to the City Clerk's office for recording. Any recording charges may be charged against project No. 472-76-245-80887-000-000-001 (Funston - Cypress to Beech). If you have any questions, please advise.

Larry D. Henry
Larry D. Henry
R/W & Estimating Engineer

LDH:md

Attachment

(S/D 78-75 1st Add. to Cedar Ridge)