

D-0982 - Mid Kansas Federal Savings & Loan dedicates additional R-0-W for Maple. Generally located on the north side of Maple, in an area east of Anna.

POSTED
11-11-80
2

ACTION

DATE

S/D COMMITTEE accept 11-24-80

M.A.P.C. accept 12-4-80

R.C.C./B.C.C. Accept 12-16-80

DEDICATION REPORT AND PROGRESS

MAP No. 5147
SEC. No. 23
TWP. No. 27
RANGE 1W

CASE No. D - 0982

ASSOCIATED CASE NO. _____

I. OFFER TO DEDICATE: Additional R-O-W for Maple
GENERALLY LOCATED: on the north side of Maple, in an area east of Anna.

LEGALLY DESCRIBED AS:

DEDICATED BY: Mid Kansas Federal Savings & Loan
AGENT: _____ PHONE _____
ADDRESS: _____
PURPOSE OF DEDICATION:

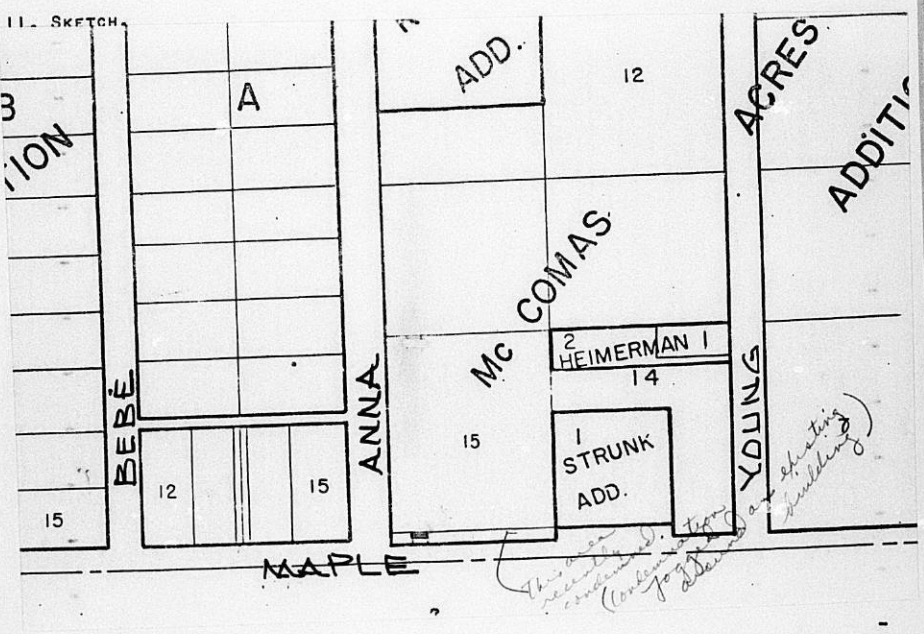

III. FILED 11-5-80 B.C.C. ACTION 12-16-80 accept
 POSTED TO ATLAS _____
 S/D COMM. ACTION 11-24-80 accept PLACED ON RECORD _____
 M.A.P.C. ACTION 12-4-80 accept CITY CLERKS No. _____

MAPC CASE NO. D-0982

Dedication of street right-of-way for Maple

Dedicated by: Mid-Kansas Federal Savings and Loan

Generally located: on the north side of Maple in an area east of Anna

This dedication is given for the following reason:

Building once located on this site has been removed and right-of way is needed for adequate "parking" area between the curb and property line.

ACTION: Accept the dedication and instruct the City Clerk to file with the Register of Deeds.

BILL RECORDING FEE TO: Mid-Kansas Federal Savings and Loan
Address: Attention: Lowell Richardson
230 S. Market, Wichita, Ks. 67202

Map 5147
23
27
1W

D-0982

DEDICATION

KNOW ALL MEN BY THESE PRESENTS:

That for and in consideration of the sum of One Dollar (\$1.00) and other good and valuable considerations, the receipt of which is hereby acknowledged, the undersigned, MID KANSAS FEDERAL SAVINGS AND LOAN ASSOCIATION IN WICHITA

being the owner of the following described real estate in Sedgwick County, Kansas, to wit:

A tract of land in Lot 15, McComas Acres more fully described as the North five (5) feet of the South twenty (20) feet of the East twenty-eight and fifty-five hundredths (28.55) feet of the West sixty-four and fifty-five hundredths (64.55) feet of said Lot 15.

do ES hereby dedicate the above described real estate to the public for street purposes.

Executed this 31st day of October, 1980.

Lowell E. Richardson
(Lowell E. Richardson, Vice President)

STATE OF KANSAS)
SEDGWICK COUNTY) SS

BE IT REMEMBERED, that on this 31st day of October, 1980, before me a Notary Public in and for the said County and State came

Lowell E. Richardson, Vice President of

MID KANSAS FEDERAL SAVINGS AND LOAN ASSOCIATION IN WICHITA

to me personally known to be the same person who executed the foregoing instrument and duly acknowledged the execution of the same.

IN WITNESS WHEREOF, I have hereunto subscribed my name and affixed my official seal, the day and year last above written.

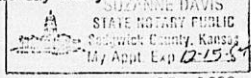

Suzanne Davis
Suzanne Davis, Notary Public

My Commission expires December 15, 1982

THE CITY OF WICHITA
OFFICE OF ENGINEERING

DATE NOVEMBER 4, 1980

TO LOUISE OLIVAREZ, CURRENT PLANS - PLANNING DEPARTMENT
FROM STEVE LACKEY, PAVEMENT DESIGN ENGINEER
SUBJECT DEDICATION

Please put the attached Dedication on the Planning Commission Agenda for approval.
After approval, please forward a copy to this office.

*at the time s.o.w. for Maple was condemned there
was a building at this location. It has since been
removed and Engineering asked MK to dedicate this
so the row for Maple
would be consistent.*

Steve Lackey
Steve Lackey, P.E.
Pavement Design Engineer

SL/dla

Attachment

RECEIVED

NOV 5 1980

METROPOLITAN PLANNING
ROUTE Louise

*Mid-Kansas Federal S&L dedicates additional right-
of-way for Maple*

*Map 5147 23-27-1W
North side of Maple in an area east
of Anna.*

(S/D meeting 11-24-80)