

D-0992 - L.C. Investment, Inc.
grants a Utility Easement legally
described as the south 25 feet of
Lots 1 & 2, Block A, Willo-Esque
Third Addition - Generally loca-

POSTED
1-25-81

ACTION

S/D COMMITTEE accept DATE 2-5-81

M.A.P.C. accept 2-12-81

B.C.C./B.C.C. Accepted 2-24-81

DEDICATION REPORT AND PROGRESS

MAP No. 5047C
 SEC. No. 22
 TWP. No. 27
 RANGE 1W

CASE No. D - 0992

ASSOCIATED CASE NO. _____

I. OFFER TO DEDICATE: Utility Easement
 GENERALLY LOCATED: on the north side of O'Neil, east of Ridge Road.

LEGALLY DESCRIBED AS: The South 25 feet of Lots 1 & 2, Block A, Willo-Esque Third Addition.

DEDICATED BY: L.C. Investment Inc
 AGENT: _____
 ADDRESS: _____ PHONE _____
 PURPOSE OF DEDICATION: _____

II. SKETCH

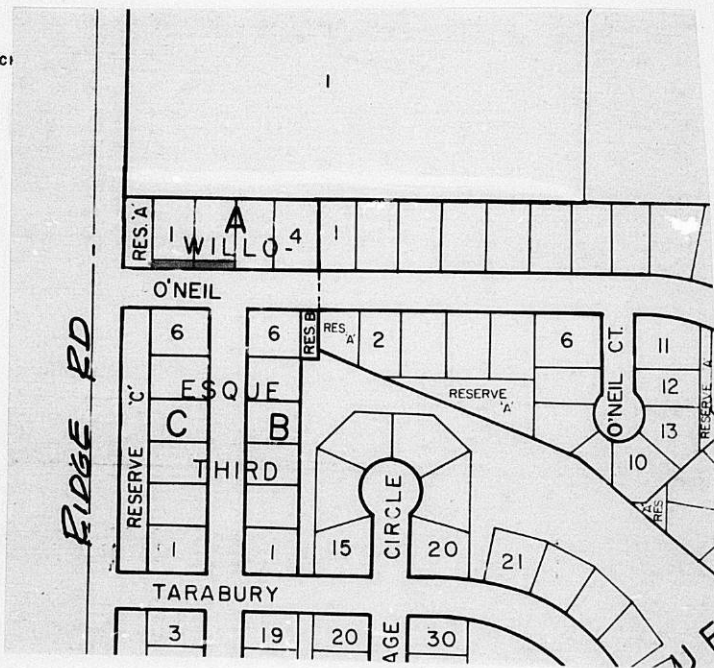

III. FILED 1-20-81
 POSTED TO ATLAS
 S/D COMM. ACTION 2-5-81 *accept*
 M.A.P.C. ACTION 2-12-81 *accept*

B.C.C. ACTION 2-24-81 *Accepted*
 PLACED ON RECORD _____
 CITY CLERKS No. _____

MAPC CASE NO. D-0992 Dedication of utility easement

Dedicated by: L.C. Investment, Inc.

Generally located: on the north side of O'Neil, east of Ridge Road.

This dedication is given for the following reason: Requested by City Engineering for sanitary sewer.

ACTION: Accept the dedication and instruct the City Clerk to file with the Register of Deeds.

BILL RECORDING FEE TO: Project # 468-76-245-80776-000-000-001
Lateral 4, Main 6, Southwest Interceptor Sewer.

(Bet. Ridge Rd. & 160' East of
Ridge Road North of Neil)

EASEMENT

Bonnie Lars
Permanent Utility Easement
Lat. Main 6, Southwest
Interceptor Sewer
#468 76 245 80776 000 000 001

THIS EASEMENT made this 9th day of January, 1981,

by and between L. C. Investment, Inc.

of the first part and the City of Wichita, of the second part.

D-0992

WITNESSETH: That the said first part y, in consideration of the sum of One Dollar (\$1.00) and other valuable consideration, the receipt whereof is hereby acknowledged, do hereby grant and convey unto the said second party a perpetual right of way and easement for the purpose of constructing, maintaining, and repairing sewer and all other public utilities, over, along and under the following described real estate situated in Sedgwick County, Kansas, to wit:

The South twenty-five (25) feet of Lots 1 and 2, Block A, Willo-Esque Third Addition, except existing platted utility easement.

And said second party is hereby granted the right to enter upon said premises at any time for the purpose of constructing, operating, maintaining, and repairing such sewer and all other public utilities.

IN WITNESS WHEREOF: The said first party y has signed these presents the day and year first written.

L. C. Investment, Inc.
Ronald F. Lane

STATE OF KANSAS)
SEDGWICK COUNTY) SS

Personally appeared before me a notary public in and for the County and State aforesaid Ronald F. Lane

to me personally known to be the same person who executed the foregoing instrument of writing and said person duly acknowledged the execution thereof.

Dated at Wichita, Kansas, this 9th day of January, 1981.

(My Commission expires Oct 16, 1983)

Larry D. Henry

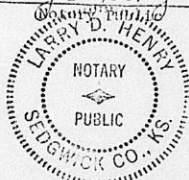

THE CITY OF WICHITA

OFFICE OF DEPARTMENT OF ENGINEERING **DATE** January 19, 1981

TO Louise Olivarez, Senior Planner
FROM Larry D. Henry, Right-of-Way & Estimating Engineer

SUBJECT Utility Easement -
L. C. INVESTMENT, INC.

Attached is subject instrument which has been executed by the owners, L. C. Investment, Inc. Please place on your agenda for Subdivision consideration. Upon approval, please forward to the City Clerk for filing and recording.

Larry D. Henry
Larry D. Henry
R/W & Estimating Engineer

LDH:md

Attachment

RECEIVED

JAN 19 1981

METROPOLITAN PLANNING
ROUTE Louise

STATEMENT OF OWNERSHIP

STATE OF KANSAS)
) SS:
SEDGWICK COUNTY)

The undersigned duly bonded and qualified abstractor within and for the County and State aforesaid, does hereby certify:

That we have examined the records in the office of the Register of Deeds of Sedgwick County, Kansas, with reference to the ownership of the following property in Sedgwick County, Kansas.

And from such examination find that the owners thereof are as set opposite the description of the property below, viz: (Addresses as given are furnished as a service and not certified.)

LOTS AND BLOCKS

ADDITION

OWNERS

Lots 1, 2, and
3, Block A,

WILLO-ESQUE
THIRD

L. C. Investment Inc.
2458 South Minneapolis
Wichita, Kansas 67216

Dated at Wichita, Kansas this 15th day of January, 1981
at 7:00 A.M.

FIDELITY TITLE COMPANY, INC.

By *V. E. Bull*
Vice President



Tracer No. 54350

