

D-0993 - Tyler Associates grant
Utility Easements in Jamesburg
Park Addition. Generally located
south of 21st Street and west of
Tyler.

POSTED

1-29-81

DATE

ACTION

S/P COMMITTEE

*accept sent to 2-5-81
for filing the plat of Jamesburg Park*

M.A.P.C.

accept subject to replan 2-12-81

B.C.C./B. GO. C.

Accepted 2-24-81

DEDICATION REPORT AND PROGRESS

MAP No. 4849A
SEC. No. 8
TWP. No. 27
RANGE 1W

CASE No. D - 0993

ASSOCIATED CASE NO. _____

I. OFFER TO DEDICATE: Utility Easements in Jamesburg Park Addition.
GENERALLY LOCATED: South of 21st Street and west of Tyler Road

LEGALLY DESCRIBED AS:

DEDICATED BY: Tyler Associates
AGENT: _____
ADDRESS: _____ PHONE _____
PURPOSE OF DEDICATION:

III. FILED 1-22-81
POSTED TO ATLAS
S/D COMM. ACTION 2-5-81 accept out.
to re-filing the plat in Jamesburg Park.
M.A.P.C. ACTION 2-12-81 accept
subject to replatting

B.C.C. ACTION 2-24-81 Accepted
PLACED ON RECORD
CITY CLERKS NO. _____

DEDICATED BY: Tyler Associates

AGENT: _____

ADDRESS: _____ PHONE _____

PURPOSE OF DEDICATION: _____

II. SKETCH.

TWENTY FIRST STREET

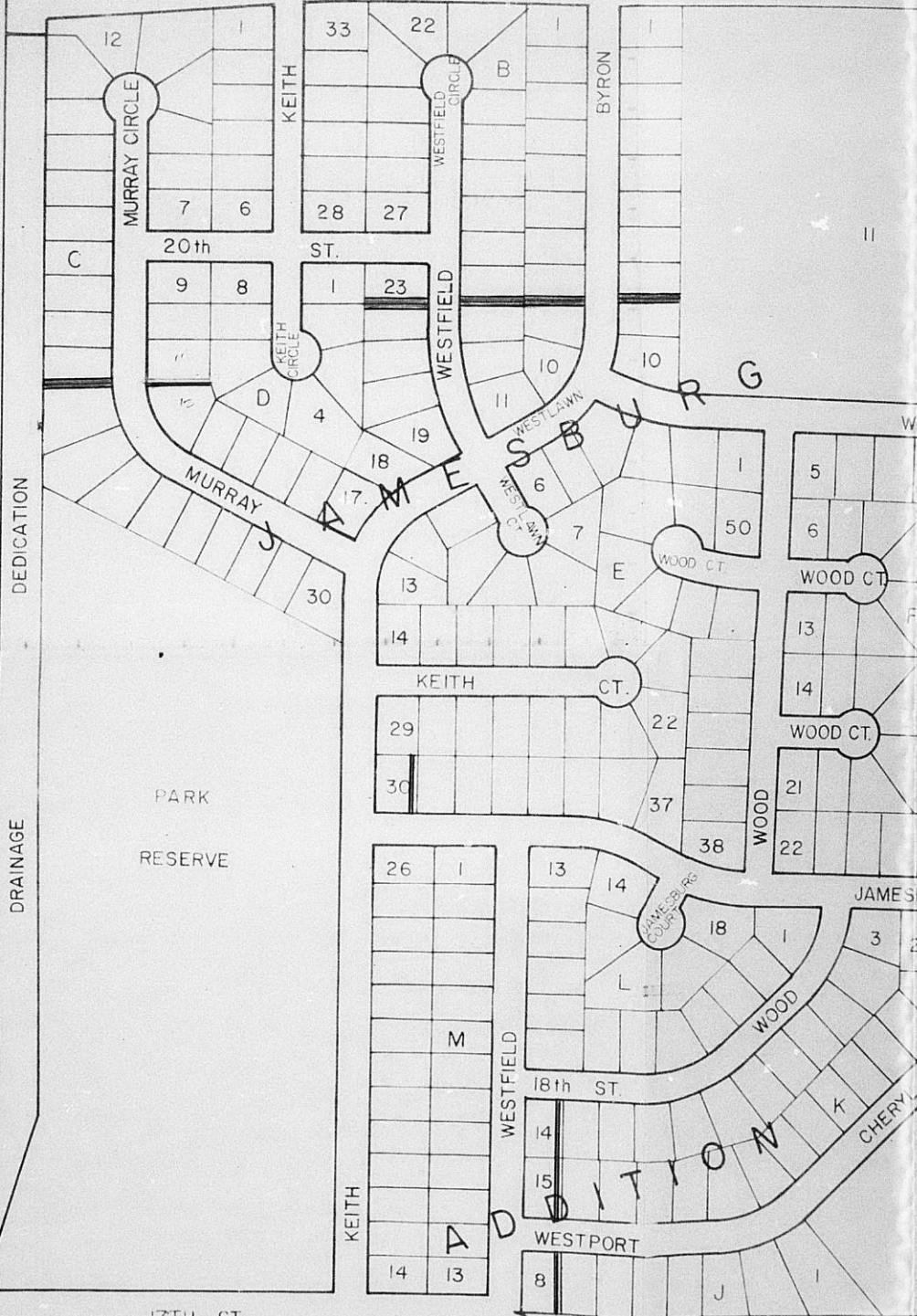

DEDICATION
DRAINAGE

PARK
RESERVE

III

17TH ST

18th ST

WESTPORT

ADDITION

JAMESBURG

CHERRY

Grant
Acquired
by located
d west of

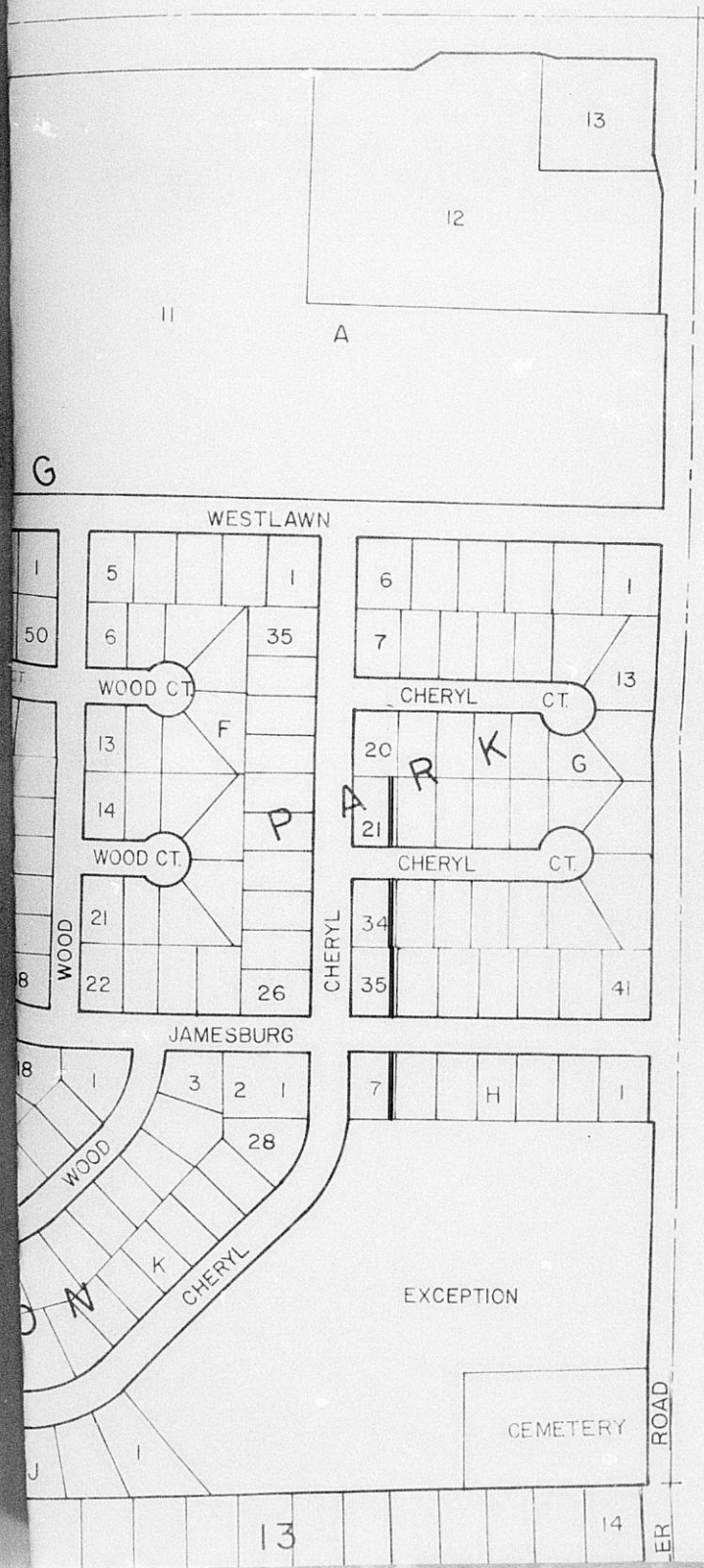

11

A

13

12

G

WESTLAWN

1

5

1

6

1

50

6

35

7

13

WOOD CT

CHERYL CT

13

F

20

P A R K

G

14

P

21

WOOD CT

CHERYL CT

8

21

CHERYL

34

41

22

26

35

JAMESBURG

8

3

2

1

7

H

1

WOOD

CHERYL

28

EXCEPTION

CEMETERY

ROAD

13

14

ER

March 5, 1981

Mr. Leonard Marotte
Tyler Associates
1861 S. Hydraulic
Wichita, Kansas 67211

Re: Refile of Jamesburg Park

Dear Mr. Marotte:

On February 24, 1981, the Board of City Commissioners accepted the dedication of additional utility easements in Jamesburg Park and instructed that the owners refile the plat to show the new easements. By this action, you have been authorized to refile the plat and by copy of this letter, we are notifying the Register of Deeds that a refile is permitted.

Very truly yours,

Robert A. Lakin
Director of Planning

RAL:LO:bh

cc: Bette McCart, Register of Deeds
Don Moehring, 433 S. Hydraulic, 67211

MAPC CASE NO. D-0993 Dedication of utility easements.

Dedicated by: Tyler Associates

Generally located: south of 21st and west of Tyler.

This dedication is given for the following reason:

Required for more economical sewer locations.

ACTION: Accept the dedication and instruct the City Clerk to file with the Register of Deeds, and instruct the owner to refile the plat with these easements shown.

BILL RECORDING FEE TO: Tyler Associates
Address: % Leonard Marotte
1861 S. Hydraulic, Wichita, 67211

February 6, 1981

Tyler Associates
c/o Leonard Marotte
1861 S. Hydraulic
Wichita, Kansas 67211

Re: D-0993 - dedication of additional utility easements in Jamesburg Park

Dear Mr. Marotte:

On February 5, 1981, the Subdivision Committee voted unanimously to recommend to the Planning Commission that the dedication of additional utility easements in Jamesburg Park be accepted subject to refiling the plat to show these easements after the City Commission accepts them. I will let you know when the City Commission has accepted these easements. Tentatively it will be on February 24, 1981.

Sincerely,

Louise Olivarez
Senior Planner

LO:bh

cc: Don Moehring, 433 S. Hydraulic, 67211

EASEMENT

Lateral 1, Main 4, Westlink Sewer
(Bet. 1st St. North & 20th Street
North from Keith to Tyler Road)
#468 76 245 80981 000 000 001

THIS EASEMENT made this 16th day of January, 19 81.

by and between TYLER ASSOCIATES

of the first part and the City of Wichita, of the second part.

D-0993

WITNESSETH: That the said first party _____, in consideration of the sum of One Dollar (\$1.00) and other valuable consideration, the receipt whereof is hereby acknowledged, do hereby grant and convey unto the said second party a perpetual right of way and easement for the purpose of constructing, maintaining, and repairing sewer and all other public utilities, over, along and under the following described real estate situated in Sedgwick County, Kansas, to wit:

(SEE EXHIBIT "A" ATTACHED)

And said second party is hereby granted the right to enter upon said premises at any time for the purpose of constructing, operating, maintaining, and repairing such sewer and all other public utilities.

IN WITNESS WHEREOF: The said first party has signed these presents the day and year first written.

TYLER ASSOCIATES

BY: LEONARD E. MAROTTE, GEN'L PTR.

Leonard E. Marotte, Gen'l P.

STATE OF KANSAS)
SEDGWICK COUNTY) SS

Personally appeared before me a notary public in and for the County and State

aforsaid LEONARD E. MAROTTE

to me personally known to be the same person who executed the foregoing instrument of writing and said person duly acknowledged the execution thereof.

Dated at Wichita, Kansas, this 16th day of January, 19 81.

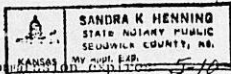
SANDRA K HENNING
STATE NOTARY PUBLIC
SEDGWICK COUNTY, KS.
MY COMM. EXPIRES 5-16-83

Sandra K. Henning
Notary Public

(My Commission Expires 5-16-83)

Permanent Utility Easement
Lateral 1, Main 4, Westlink
Sewer
(Bet. 17th St. North & 20th
St. North from Keith to
Tyler Road)
#468 76 245 80981 000 000 001

EXHIBIT "A"

The West five (5) feet of the East ten (10) feet of each said Lot:

Lot 30, Block E ✓
Lot 21, Block G ✓
Lot 34, Block G ✓
Lot 35, Block G ✓
Lot 7, Block H ✓
Lot 8, Block J ✓
Lot 14, Block K ✓
Lot 15, Block K ✓

all in Jamesburg Park Addition

Also:

The South ten (10) feet of Lot 21 and the North ten (10) feet of Lot 22,
Block C;

The South five (5) feet of the North ten (10) feet of Lot 12, Block D;

The South ten (10) feet of Lot 23 and the North ten (10) feet of Lot 22,
Block D;

The South ten (10) feet of Lot 14 and 8, and the North ten (10) feet of
Lot 13 and 9, Block B;

and the South ten (10) feet of Lot 8 and the North ten (10) feet of
Lot 9, Block A

all in Jamesburg Park Addition

THE CITY OF WICHITA

OFFICE OF DEPARTMENT OF ENGINEERING DATE January 21, 1981

TO Louise Olivarez, Senior Planner
FROM Larry D. Henry, Right-of-Way & Estimating Engineer
SUBJECT Utility Easements -
Jamesburg Park Addition

Attached is subject utility easement form, executed by Leonard Marotte for Tyler Associates. Please place on your agenda for Subdivision consideration. Upon approval, please forward to the City Clerk for filing and recording.

Larry D. Henry
Larry D. Henry
R/W & Estimating Engineer

LDH:md

cc: Don Schneider

RECEIVED

JAN 21 1981

METROPOLITAN PLANNING
ROUTE *Local*
