

ACTION

DATE

2-5-81

accept

SP COMMITTEE

8-12-81

accept

M.A.P.C.

7-7-81

Accepted

B.C.C./B.G.C.

*POSTED  
1-29-81  
JN*

D-0997 - R & S Investments & Amoco Oil Co. grant a Utility Easement. Generally located at the Northeast corner of Maize Road and 13th Street North.

DEDICATION REPORT AND PROGRESS

MAP No. 4849c  
SEC. No. 8  
TWP. No. 27  
RANGE 1W

CASE No. D - 0997

ASSOCIATED CASE NO. L/S-0408

I. OFFER TO DEDICATE: Utility Easement  
GENERALLY LOCATED: Northeast corner of Maize Road and 13th St. North

LEGALLY DESCRIBED AS:

DEDICATED BY: R & S Investments & Amoco Oil Co.  
AGENT: \_\_\_\_\_ PHONE \_\_\_\_\_  
ADDRESS: \_\_\_\_\_  
PURPOSE OF DEDICATION:

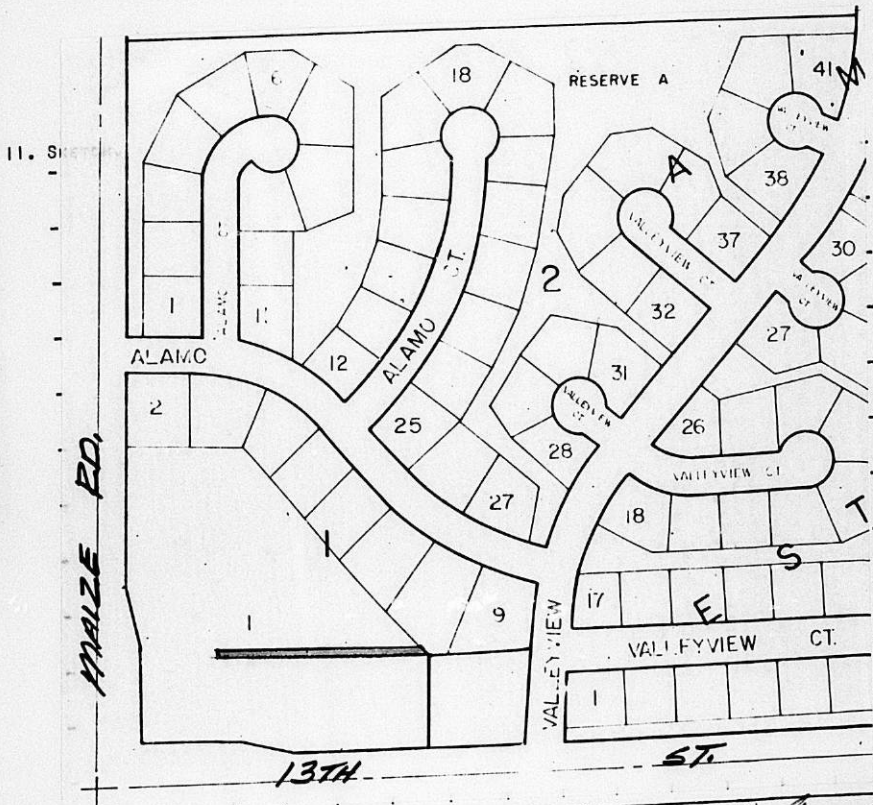

III. FILED 1-23-81 B.C.C. ACTION 4-7-81 *Accepted*  
 POSTED TO ATLAS  
 S/D COMM. ACTION 2-5-81 *accept* PLACED ON RECORD \_\_\_\_\_  
 M.A.P.C. ACTION 2-12-81 *accept* CITY CLERKS No. \_\_\_\_\_

MAPC CASE NO. D-0997 Dedication of utility easement

Dedicated by: R and S Investments and Amoco Oil Company

Generally located at the northeast corner of 13th and Maple Road

This dedication is given for the following reason:  
lot split requirement

**ACTION:** Accept the dedication and instruct the City Clerk to  
file with the Register of Deeds.

**BILL RECORDING FEE TO:**

R and S Investments  
200 W. Douglas, Suite 505  
Wichita, Ks. 67202

EASEMENT

THIS EASEMENT made this 3rd day of February, 1981,

by and between R&S Investments & Amoco Oil Company, a Maryland Corporation of the first part and the City of Wichita, of the second part.

WITNESSETH: That the said first part, in consideration of the sum of One Dollar (\$1.00) and other valuable consideration, the receipt whereof is hereby acknowledged, do hereby grant and convey unto the said second party a perpetual right of way and easement for the purpose of constructing, maintaining, and repairing all public utilities, over, along and under the following described real estate situated in Sedgwick County, Kansas, to wit:

A 20-FOOT UTILITY EASEMENT IN LOT 1, BLOCK 1, AMARADO ESTATES AN ADDITION TO WICHITA, SEDGWICK COUNTY, KANSAS DESCRIBED AS COMMENCING AT THE SOUTHWEST CORNER OF SAID LOT 1; THENCE ALONG THE WEST LINE OF SAID LOT 1 BEARING N 0° 00' E A DISTANCE OF 150 FEET; THENCE BEARING N 86° 34' 56" E A DISTANCE OF 130 FEET TO THE POINT OF BEGINNING; THENCE BEARING N 86° 34' 56" E A DISTANCE OF 378.91 FEET TO A POINT ON THE EASTERLY LINE OF SAID LOT 1; THENCE ALONG SAID EASTERLY LINE BEARING S 44° 15' 03" E A DISTANCE OF 22.94 FEET TO THE EAST-NORTHEAST CORNER OF SAID LOT 1; THENCE BEARING S 0° 00' E ALONG THE EAST LINE OF SAID LOT 1 A DISTANCE OF 3.57 FEET; THENCE BEARING S 86° 34' 56" W A DISTANCE OF 394.92 FEET; THENCE BEARING N 0° 00' E A DISTANCE OF 20.00 FEET TO THE POINT OF BEGINNING.

It is expressly understood and agreed that Amoco Oil Company joins in this Easement solely for the purpose of conveying to the City of Wichita an easement for sanitary sewer purposes along and under the West 20 feet of the above-described real estate, said real estate being the North 20 feet of the East 20 feet of the tract owned by said Amoco Oil Company.

And said second party is hereby granted the right to enter upon said premises at any time for the purpose of constructing, operating, maintaining, and repairing said public utilities.

IN WITNESS WHEREOF: The said first parties have signed these presents the day and year first written.

R&S Investments

By James O. Smith  
James O. Smith, General Partner  
Amoco Oil Company, A Maryland Company

STATE OF KANSAS)  
SS  
SEDGWICK COUNTY)

By Oz Deery

Personally appeared before me a notary public in and for the County and State aforesaid James O. Smith

to me personally known to be the same person who executed the foregoing instrument of writing and said person duly acknowledged the execution thereof.

Dated at Wichita, Kansas, this 3rd day of February, 1981.



Cynthia K. Morgan  
Notary Public

Commission expires Nov. 15, 1984

STATE OF )  
COUNTY OF ) ss:

Personally appeared before me a notary public in and for the County and State aforesaid O.L. Scott, Manager-Capital Investment of Amoco Oil Company, A Maryland Company, to me personally known to be the person who executed the foregoing instrument as Manager-Capital Investment of said corporation, and such person duly acknowledged the execution of same as Manager-Capital Investment for and on behalf of, and as the act and deed of said corporation.

DATED at Wichita, Kansas, this 5th day of February, 1981.

My appointment expires:

Richard L. Black  
Notary Public

May 15 1984

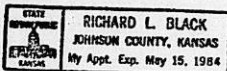

EASEMENT

Copy SUBMITTED FOR  
SCHEDULING PURPOSES.  
ORIGINAL WILL BE SUBMITTED  
SHORTLY

THIS EASEMENT made this \_\_\_\_\_ day of \_\_\_\_\_, 19\_\_\_\_, FUN  
1/25/81

by and between R&S Investments & Amoco Oil Company, a Maryland Corporation

of the first part and the City of Wichita, of the second part.

D-0997

WITNESSETH: That the said first part, in consideration of the sum of One Dollar (\$1.00) and other valuable consideration, the receipt whereof is hereby acknowledged, do hereby grant and convey unto the said second party a perpetual right of way and easement for the purpose of constructing, maintaining, and repairing all public utilities, over, along and under the following described real estate situated in Sedgwick County, Kansas, to wit:

A 20-FOOT UTILITY EASEMENT IN LOT 1, BLOCK 1, AMARADO ESTATES AN ADDITION TO WICHITA, SEDGWICK COUNTY, KANSAS DESCRIBED AS COMMENCING AT THE SOUTHWEST CORNER OF SAID LOT 1; THENCE ALONG THE WEST LINE OF SAID LOT 1 BEARING N 0° 00' E A DISTANCE OF 150 FEET; THENCE BEARING N 86° 34' 56" E A DISTANCE OF 130 FEET TO THE POINT OF BEGINNING; THENCE BEARING N 86° 34' 56" E A DISTANCE OF 378.91 FEET TO A POINT ON THE EASTERLY LINE OF SAID LOT 1; THENCE ALONG SAID EASTERLY LINE BEARING S 44° 15' 03" E A DISTANCE OF 22.94 FEET TO THE EAST-NORTHEAST CORNER OF SAID LOT 1; THENCE BEARING S 0° 00' E ALONG THE EAST LINE OF SAID LOT 1 A DISTANCE OF 3.57 FEET; THENCE BEARING S 86° 34' 56" W A DISTANCE OF 394.92 FEET; THENCE BEARING N 0° 00' E A DISTANCE OF 20.00 FEET TO THE POINT OF BEGINNING.

And said second party is hereby granted the right to enter upon said premises at any time for the purpose of constructing, operating, maintaining, and repairing said public utilities.

IN WITNESS WHEREOF: The said first part, ha signed these presents the day and year first written.

R&S Investments

By \_\_\_\_\_

Amoco Oil Company, A Maryland Company

By \_\_\_\_\_

STATE OF KANSAS)

SS

SEDGWICK COUNTY)

Personally appeared before me a notary public in and for the County and State aforesaid \_\_\_\_\_

to me personally known to be the same person who executed the foregoing instrument of writing and said person duly acknowledged the execution thereof.

Dated at Wichita, Kansas, this \_\_\_\_\_ day of \_\_\_\_\_, 19\_\_\_\_.

Notary Public \_\_\_\_\_

(My Commission expires \_\_\_\_\_)

