

D-1016 - The City of Wichita  
dedicates Alley right-of-way gen-  
erally located on the west side  
of Ohio, in an area south of 9th  
Street.

of  
*POSTED*  
4-23-81

### ACTION

	DATE
9/2 COMMITTEE	<u>4-30-81</u>
M.A.P.C.	<u>5-7-81</u>
R.C.C./B. GO. C.	<u>5-19-81</u>

DEDICATION REPORT AND PROGRESS

MAP No. 5549  
 SEC. No. 9  
 TWP. No. 27  
 RANGE 1E

CASE No. D - 1016  
 ASSOCIATED CASE NO. V-1016 <sup>0956</sup>

I. OFFER TO DEDICATE: Alley right-of-way  
 GENERALLY LOCATED: on the west side of Ohio in an area south of 19th Street

LEGALLY DESCRIBED AS:

DEDICATED BY: City of Wichita  
 AGENT: \_\_\_\_\_  
 ADDRESS: \_\_\_\_\_ PHONE \_\_\_\_\_  
 PURPOSE OF DEDICATION: Requirement of V-0956

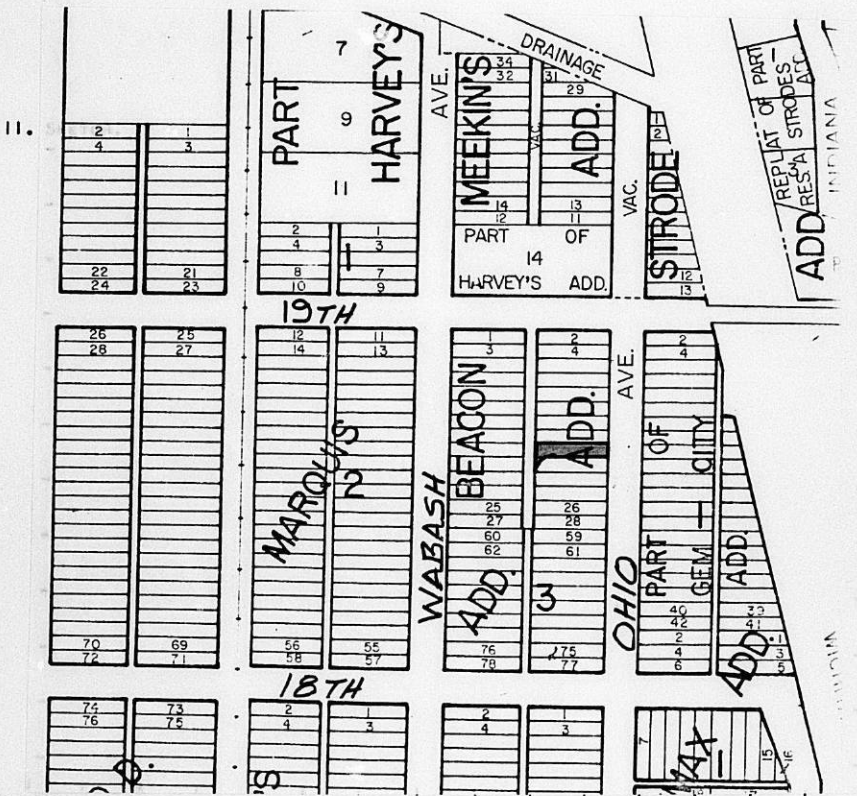

III. FILED 4-20-81  
 POSTED TO ATLAS \_\_\_\_\_  
 S/D COMM. ACTION 4-30-81 *accept*  
 M.A.P.C. ACTION 5-7-81 *accept*  
 B.C.C. ACTION 5-17-81 *Accepted*  
 PLACED ON RECORD \_\_\_\_\_  
 CITY CLERKS No. \_\_\_\_\_

5549  
9  
27  
IE

DEDICATION

D-1016

KNOW ALL MEN BY THESE PRESENTS:

That for and in consideration of the sum of One Dollar (\$1.00) and other good and valuable considerations, the receipt of which is hereby acknowledged, the undersigned, \_\_\_\_\_

City of Wichita

being the owner of the following described real estate in Sedgwick County, Kansas, to wit:

A tract of land in Lots 18 and 20, Beacon Addition to Wichita, Kansas, more fully described as follows:

Beginning at the Northeast Corner of said Lot 18; thence South along the East line of said Lot 18 for a distance of twenty (20) feet; thence West, parallel with the South line of said Lot 18 for a distance of one hundred (100) feet to the point of curvature of a curve to the left, said curve having a radius of thirty (30) feet; thence Southwesterly along said curve to the left to the Southwest Corner of Lot 20, Beacon Addition; thence North along the West line of said Lot 20, and the West line of Lot 18, Beacon Addition, to the Northwest Corner of said Lot 18; thence East along the North line of said Lot 18 to the point of beginning.

do hereby dedicate the above described real estate to the public for

\_\_\_\_\_ alley \_\_\_\_\_ purposes.

Executed this 14<sup>th</sup> day of April, 1981.

Donald C. Gisick  
Donald C. Gisick City Clerk

Robert G. Knight  
Robert G. Knight Mayor

STATE OF KANSAS )  
SEDGWICK COUNTY ) ss

BE IT REMEMBERED, that on this 14th day of April, 1981,  
came Robert G. Knight, Mayor and Donald C. Gisick, City Clerk

to me personally known to be the same persons who executed the foregoing instrument and duly acknowledged the execution of the same.

IN WITNESS WHEREOF, I have hereunto subscribed my name and affixed my official seal, the day and year last above written.

Submitted to the Wichita-Sedgwick County Metropolitan Area Planning Commission and the Board of Commissioners of the City of Wichita, Kansas, and approved by said Board of Commissioners of the City of Wichita, Kansas,

this \_\_\_\_\_

City Clerk

Debra D. Freking  
Notary Public

My Commission Expires: 3/20/84

DEBRA D. FREKING  
STATE NOTARY PUBLIC  
SEDGWICK COUNTY, KANSAS  
MY APPT. EXP. 3-20-84

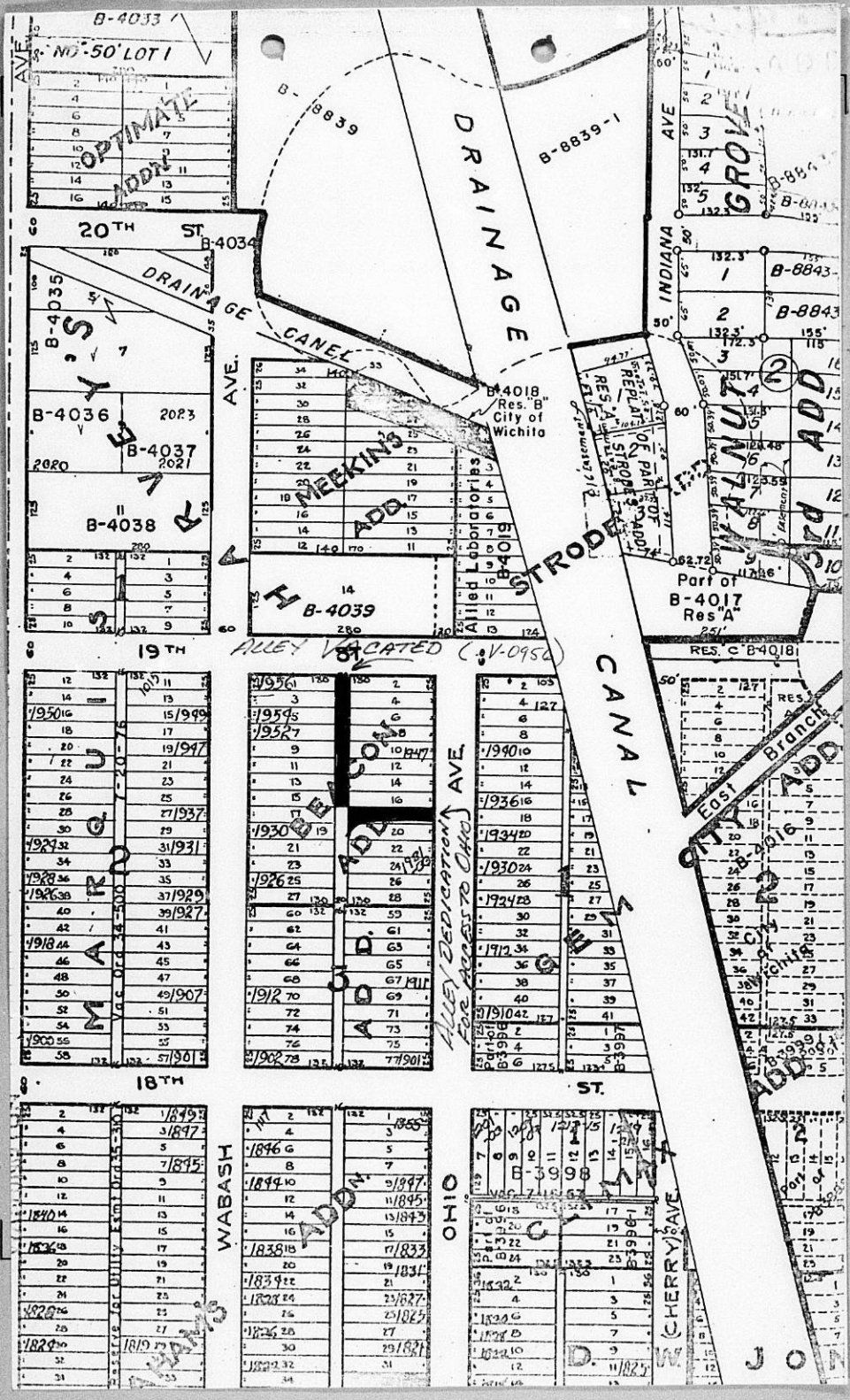

B-4033  
NO. 50' LOT 1

2	1
4	3
6	5
8	7
10	9
12	11
14	13
16	15

20TH ST

1	2
3	4
5	6
7	8
9	10
11	12
13	14
15	16
17	18
19	20
21	22
23	24
25	26
27	28
29	30
31	32
33	34
35	36
37	38
39	40
41	42
43	44
45	46
47	48
49	50
51	52
53	54
55	56
57	58
59	60

19TH ST

1	2
3	4
5	6
7	8
9	10
11	12
13	14
15	16
17	18
19	20
21	22
23	24
25	26
27	28
29	30
31	32
33	34
35	36
37	38
39	40
41	42
43	44
45	46
47	48
49	50
51	52
53	54
55	56
57	58
59	60

18TH ST

1	2
3	4
5	6
7	8
9	10
11	12
13	14
15	16
17	18
19	20
21	22
23	24
25	26
27	28
29	30
31	32
33	34
35	36
37	38
39	40
41	42
43	44
45	46
47	48
49	50
51	52
53	54
55	56
57	58
59	60

ALLEY DEDICATED (V-0950)

1	2
3	4
5	6
7	8
9	10
11	12
13	14
15	16
17	18
19	20
21	22
23	24
25	26
27	28
29	30
31	32
33	34
35	36
37	38
39	40
41	42
43	44
45	46
47	48
49	50
51	52
53	54
55	56
57	58
59	60

ALLEY DEDICATED (V-0950)

1	2
3	4
5	6
7	8
9	10
11	12
13	14
15	16
17	18
19	20
21	22
23	24
25	26
27	28
29	30
31	32
33	34
35	36
37	38
39	40
41	42
43	44
45	46
47	48
49	50
51	52
53	54
55	56
57	58
59	60

ALLEY DEDICATED (V-0950)

1	2
3	4
5	6
7	8
9	10
11	12
13	14
15	16
17	18
19	20
21	22
23	24
25	26
27	28
29	30
31	32
33	34
35	36
37	38
39	40
41	42
43	44
45	46
47	48
49	50
51	52
53	54
55	56
57	58
59	60

ALLEY DEDICATED (V-0950)

1	2
3	4
5	6
7	8
9	10
11	12
13	14
15	16
17	18
19	20
21	22
23	24
25	26
27	28
29	30
31	32
33	34
35	36
37	38
39	40
41	42
43	44
45	46
47	48
49	50
51	52
53	54
55	56
57	58
59	60

ALLEY DEDICATED (V-0950)

1	2
3	4
5	6
7	8
9	10
11	12
13	14
15	16
17	18
19	20
21	22
23	24
25	26
27	28
29	30
31	32
33	34
35	36
37	38
39	40
41	42
43	44
45	46
47	48
49	50
51	52
53	54
55	56
57	58
59	60

ALLEY DEDICATED (V-0950)

1	2
3	4
5	6
7	8
9	10
11	12
13	14
15	16
17	18
19	20
21	22
23	24
25	26
27	28
29	30
31	32
33	34
35	36
37	38
39	40
41	42
43	44
45	46
47	48
49	50
51	52
53	54
55	56
57	58
59	60

ALLEY DEDICATED (V-0950)

1	2
3	4
5	6
7	8
9	10
11	12
13	14
15	16
17	18
19	20
21	22
23	24
25	26
27	28
29	30
31	32
33	34
35	36
37	38
39	40
41	42
43	44
45	46
47	48
49	50
51	52
53	54
55	56
57	58
59	60

ALLEY DEDICATED (V-0950)

1	2
3	4
5	6
7	8
9	10
11	12
13	14
15	16
17	18
19	20
21	22
23	24
25	26
27	28
29	30
31	32
33	34
35	36
37	38
39	40
41	42
43	44
45	46
47	48
49	50
51	52
53	54
55	56
57	58
59	60

ALLEY DEDICATED (V-0950)

1	2
3	4
5	6
7	8
9	10
11	12
13	14
15	16
17	18
19	20
21	22
23	24
25	26
27	28
29	30
31	32
33	34
35	36
37	38
39	40
41	42
43	44
45	46
47	48
49	50
51	52
53	54
55	56
57	58
59	60