

9/ COMMITTEE approved DATE 2-28-85
M.A.P.C. approved 3-7-85
B.C.C./B. CO. C. accept 3-11-85

D-1285 - C.W. Larsen, et ux grants street
R.O.W. located at the northeast corner
of 30th Street South and Osage.

POSTED 2-21-85 (K)
OK 110

ACTION

	DATE
9/6 COMMITTEE	<u>approved</u> <u>2-22-85</u>
M.A.P.C.	<u>approved</u> <u>3-7-85</u>
B.C.C./B. CO. C.	<u>accept</u> <u>3-11-85</u>

D-1285 - C
R.O.W. 100
of 30th St

DEDICATION REPORT AND PROGRESS

MAP No. 5444 C
 SEC. No. 5
 TWP. No. 28 S
 RANGE 1 E

CASE No. D - 1285

ASSOCIATED CASE NO. L/S-0643

I. OFFER TO DEDICATE: Street Right-of-Way
 GENERALLY LOCATED: At the northeast corner of 30th St. South and Osage

LEGALLY DESCRIBED AS:

DEDICATED BY: C. W. and V. Maxine Larsen
 AGENT: _____
 ADDRESS: _____ PHONE _____
 PURPOSE OF DEDICATION: _____

II. SKETCH.

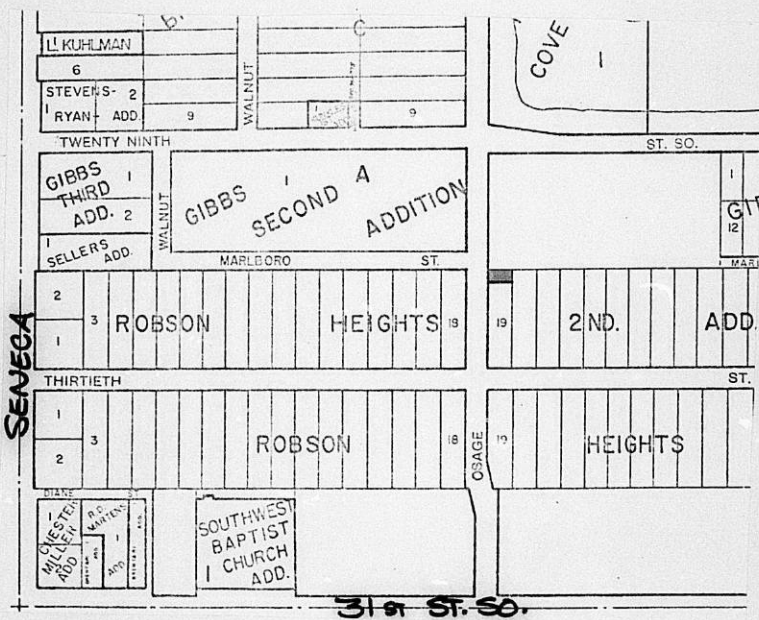

III. FILED 2-12-85
 POSTED TO ATLAS _____
 S/D COMM. ACTION 2-28-85 approved
 M.A.P.C. ACTION 3-7-85 approved
 B.C.C. ACTION 3-7-85 accept
 PLACED ON RECORD _____
 CITY CLERKS No. _____

PLANNING AGENDA

Date: March 19, 1985

MAPC CASE NO.: D-1285

Dedication of street right-of-way.

Dedicated by: C. W. and V. Maxine Larsen

Generally located at the northeast corner of 30th Street South and Osage.

This dedication is given for the following reason:

Associated with lot split case L/S-0643.

ACTION: Accept the dedication and instruct the City Clerk to file the document with the Register of Deeds.

BILL RECORDING FEE TO:

C. W. Larsen
5206 Kensington
Wichita, KS 67200

C/U: 0581/M

5444C

5
288
1E

Associated with 4s-0643

D-1285

DEDICATION

C. W. Larsen, etvx dedicates Street right-of-way located at the northeast corner of 30th Street South and Osage. KNOW ALL MEN BY THESE PRESENTS:

That for and in consideration of the sum of One Dollar (\$1.00) and other good and valuable considerations, the receipt of which is hereby acknowledged, the undersigned, C.W. Larsen and V. Maxine Larsen

being the owner_s of the following described real estate in Sedgwick County, Kansas, to wit:

The north 30 feet of Lot 19, Robson Heights 2nd., Sedgwick County, Kansas.

do hereby dedicate the above described real estate to the public for Street purposes.

Executed this 11th day of February 1985.

x C.W. Larsen
C.W. Larsen

x V. Maxine Larsen
V. Maxine Larsen

STATE OF KANSAS)
SEDGWICK COUNTY) ss

BE IT REMEMBERED, that on this 11th day of February, 1985,

came C.W. Larsen and V. Maxine Larsen, his wife

to me personally known to be the same person_s who executed the foregoing instrument and duly acknowledged the execution of the same.

IN WITNESS WHEREOF, I have hereunto subscribed my name and affixed my official seal, the day and year last above written.

Submitted to the Wichita-Sedgwick County Metropolitan Area Planning Commission and the Board of Commissioners of the City of Wichita, Kansas, and approved by said Board of Commissioners of the City of Wichita, Kansas,
this _____,
City Clerk

Mark A. Savoy
Notary Public
Mark A. Savoy

My Commission Expires: 12 May 1988

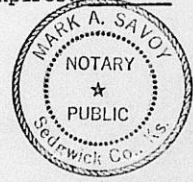

For 2/28/85 S/D Meeting