

POSTED 9-29-86 KCC

D-1402 - Sam Eberly, et ux grants a drainage easement, generally located in an area west of 119th Street West, approx. 1/4 mile north of 13th Street N.

ACTION

DATE

COMMITTEE

M.A.P.C.

B.C.C./B.C.C.C. *Conroy*

9-30-86

MAP NO. 4649 B
SEC. NO. 12
TWP. NO. 27S
RANGE 2W

DEDICATION REPORT AND PROGRESS

CASE NO.: D-1402

ASSOCIATED CASE: S/D 86-62

1. OFFER TO DEDICATE: Drainage easement.

GENERALLY LOCATED: In an area west of 119th Street West, approximately $\frac{1}{4}$ mile north of 13th Street North.

LEGALLY DESCRIBED AS:

Commencing at the northwest corner of Block 1, Autumn Ridge, an addition to Wichita, Sedgwick County, Kansas; thence south along the west line of said Block 1 a distance of 70' to the point of beginning; thence west a distance of 50'; thence south parallel to the west line of Block 1 a distance of 50'; thence east a distance of 50' to the west line of said Block 1; thence north 50' to the point of beginning.

DEDICATED BY: Sam Eberly, et ux

PURPOSE OF DEDICATION:

II. SKETCH.

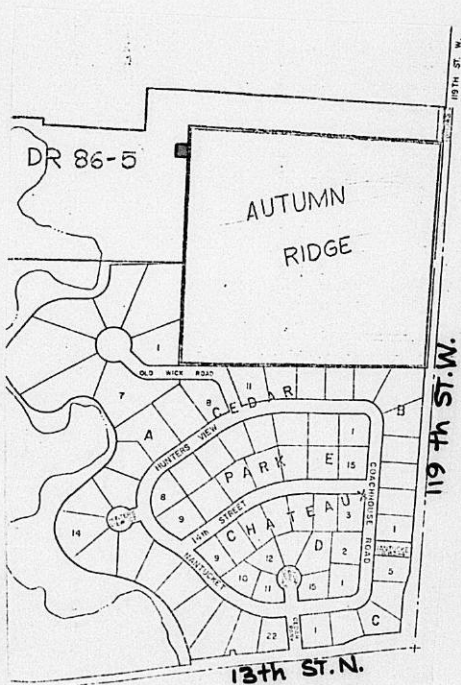

III. FILED _____ 9/19/86 _____
POSTED TO ATLAS _____
S/D COMM. ACTION _____
M.A.P.C. ACTION _____

B.C.C. ACTION 9-30-86 *Accept* _____
PLACED ON RECORD _____
CITY CLERKS NO. _____

SAM Eberly, et ux grants
a drainage easement. located
in an area west of 119th St.
west, approx. $\frac{1}{4}$ mile north
of 137th Street North.

For B.C.C. 9/30/86

Assoc with. SID 86-62

map # 4649 B

12
27S
2W

DRAINAGE EASEMENT

THIS EASEMENT made this 19th day of Sept, 1956,

by and between Sam O. & Judy R. Eberly
of the first part and the City of Wichita of the second part.

WITNESSETH: That the said first part, S, in consideration of the sum of One Dollar (\$1.00) and other valuable consideration, the receipt whereof is hereby acknowledged, do hereby grant and convey unto the said second party a perpetual right-of-way and easement for the purpose of surface drainage; over, along and under the following described real estate situated in Sedgwick County, Kansas, to-wit:

Commencing at the northwest corner of Block 1, Autumn Ridge, an addition to Wichita, Sedgwick County, Kansas; thence south along the west line of said Block 1 a distance of 70' to the point of beginning; thence west a distance of 50'; thence south parallel to the west line of Block 1 a distance of 50'; thence east a distance of 50' to the west line of said Block 1; thence north 50' to the point of beginning.

And said second party is hereby granted the right to enter upon said premises at any time for the purpose of maintaining such drainage easement.

IN WITNESS WHEREOF: The said first part, S, have signed these presents the day and year first written.

Sam O. Eberly
Judy R. Eberly
JUDY A. EBERLY

STATE OF KANSAS)
)SS
SEDGWICK COUNTY)

Personally appeared before me a Notary Public in and for the County and State aforesaid _____

Sam O. & Judy R. Eberly

to me personally known to be the same person, S, who executed the foregoing instrument of writing and said person, S, duly acknowledged the execution thereof.

Dated at Wichita, Kansas this 19th day of September 1956.



Marsha K. Morrow